

RECORD AND CERTIFICATION OF U.S.
PUBLIC LAND SURVEY CONTROL STATION

E-D-716-72

RECEIVED & FILED # L 397
State of Wisconsin / Department of Transportation
Oneida County Surveyor's Office
Date... JUN. 23. 1988
By... JHM
OCS Area #.....

District <u>7</u>	Project I. D. <u>1173-0-04</u>	Located by <u>Eugene Dahl, Survey Crew Chief</u>			
Corner <u>W. 1/4</u>	SECTION <u>1</u>	Township <u>36 N</u>	Range (E,W) <u>6E</u>	County <u>Oneida</u>	
Wisconsin Coordinates CORNER	East (X) <u>2,078,358.29</u>	North (Y) <u>171,268.60</u>	Elevation (Z)	Zone <u>N.</u>	
Control Station Name	East (X)	North (Y)	Elevation (Z)	Zone	
Horizontal — <u>NORTH AMERICAN, 1927</u>		CONTROL DATUM Vertical — <u>MEAN SEA LEVEL, 1929 ADJUSTMENT</u>			
Horizontal — <u>2ND</u> Order		SURVEY CONTROL Vertical — _____ Order			

SKETCH

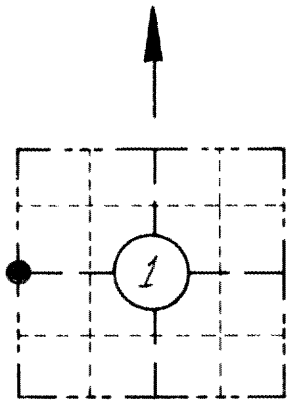

LOCATION SKETCH
(Location of landmark indicated by "X")

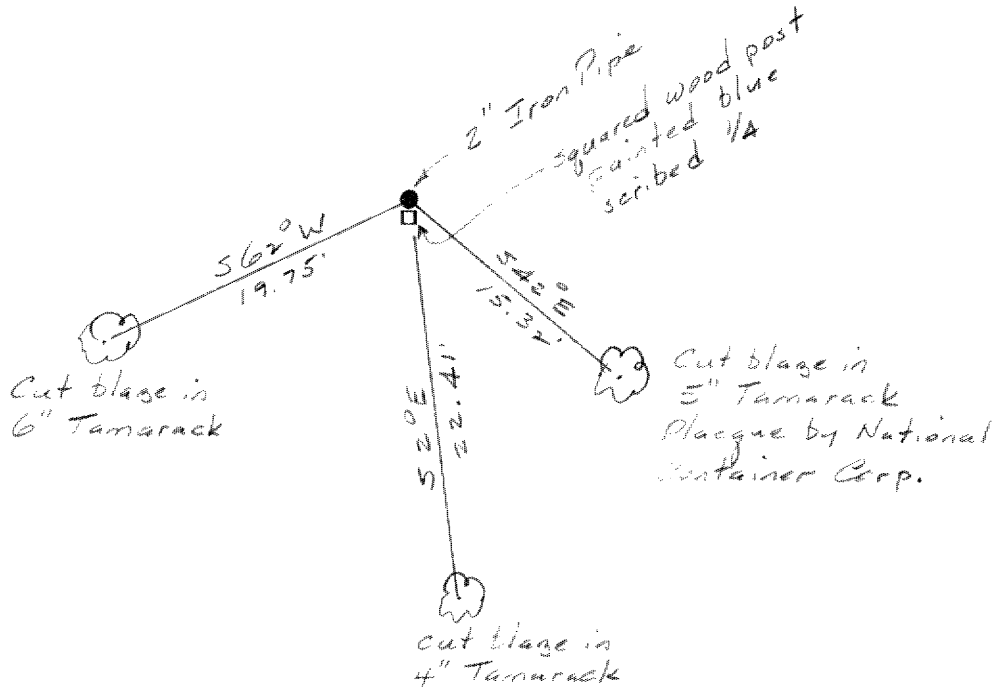

I hereby certify that on the 8 day of May 1974, that I did locate the above corner which was evidenced by a 2" Iron Pipe; I further certify that to perpetuate the location of such corner I did, at the exact location thereof, ~~place a permanent marker consisting of~~ leave the 2" Iron Pipe intact.; I further certify that I did establish 3 references ~~or witness monuments~~ consisting of a 6" Tamarack, a 4" Tamarack and a 5" Tamarack located as shown above:

Note: All work done by Eugene Dahl under the supervision of:

Signature Registered Land Surveyor <u>William H. Scherer</u>	Registration No. <u>S-866</u>	Title <u>Survey Supervisor</u>
---	----------------------------------	-----------------------------------

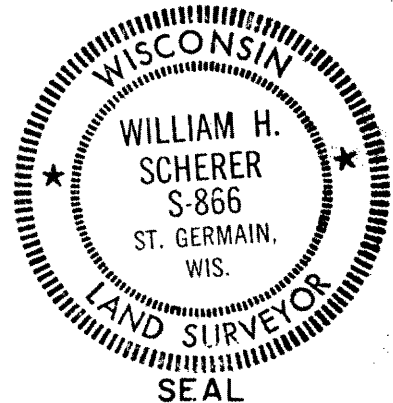

CORNER
W. 1/4
SECTION
1
TOWN
36N
RANGE
6E