

RECEIVED & FILED # 1421
 Oneida County Surveyor's Office
 Date May 16 1968
 By Jm **PAGE**
 OCS Area #.....

FORM NO. 710

PRESERVATION OF LANDMARKS

SECTION 59,635(7) WISCONSIN STATUTES
 COUNTY Oneida
 TOWN CRESCENT
 HIGHWAY C.T.H. K
 SECTION NO. 3
 T. 36 N., R. 8 E.
 TYPE OF LANDMARK 1/4 CORNER
 LOCATION INDICATED ON SKETCH X

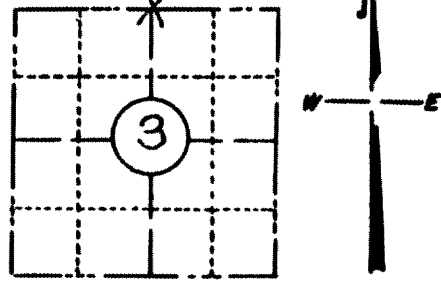

LOCATION SKETCH

BEARINGS ARE FROM THE
 REFERENCE TO THE LANDMARK

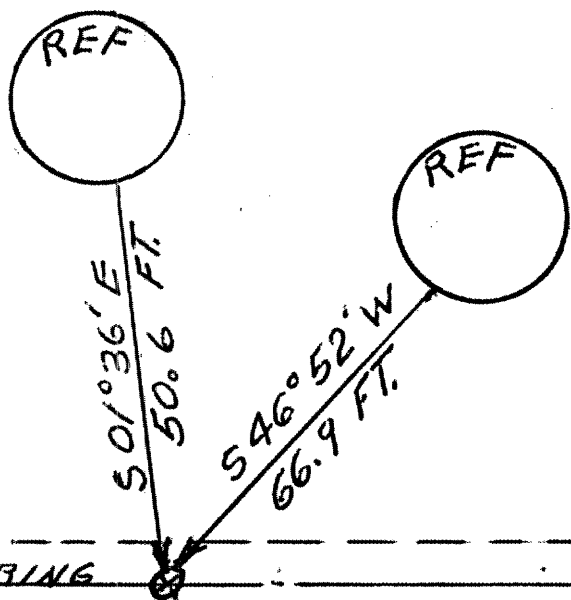

Reference Monuments are brass caps imbedded in concrete caps are stamped with the bearing and distances to the landmark.

This space for copy of field notes or ties to the above described landmarks

Field notes or records filed in book no. 8644
 at the Wis. Dept of Transportation, Division of Highways office.
 City of Rhinelander, Oneida County.
 Located or established by James Martinson, 1968
 Title Project Engineer

County Clerk's Office ONEIDA County, Wis. } ss
 Received for record May 16, 1968
Burleigh J. Verag
 County Clerk
 Copy sent to County Surveyor May 16, 1968