

RECORD AND CERTIFICATION OF U.S. PUBLIC LAND SURVEY CONTROL STATION

E-D-716-72

RECEIVED & FILED #...**4440**...

Oneida County Surveyor's Office
State of Wisconsin / Department of Transportation

Date... **JUN. 27. 1986**

By... **M**

District 7	Project I. D. 1593-0-00	Recovered Located by EUGENE DAHL			S.A.O.C. Area # NEW CHIEF... DIVISION OF HIGHWAYS	
Corner N. 1/4	7 SECTION	Township 36 N	Range (E,W) 9 E	County ONEIDA		
Wisconsin Coordinates CORNER		East (X) 2,148,518.64	North (Y) 169,365.21	Elevation (Z)	Zone N.	
Control Station Name		East (X)	North (Y)	Elevation (Z)	Zone	
Horizontal — NORTH AMERICAN, 1927			CONTROL DATUM	Vertical — MEAN SEA LEVEL, 1929 ADJUSTMENT		
Horizontal — 2ND Order			SURVEY CONTROL	Vertical — _____ Order		

SKETCH

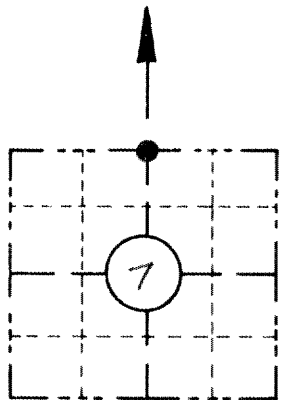

LOCATION SKETCH

(Location of landmark indicated by "X")

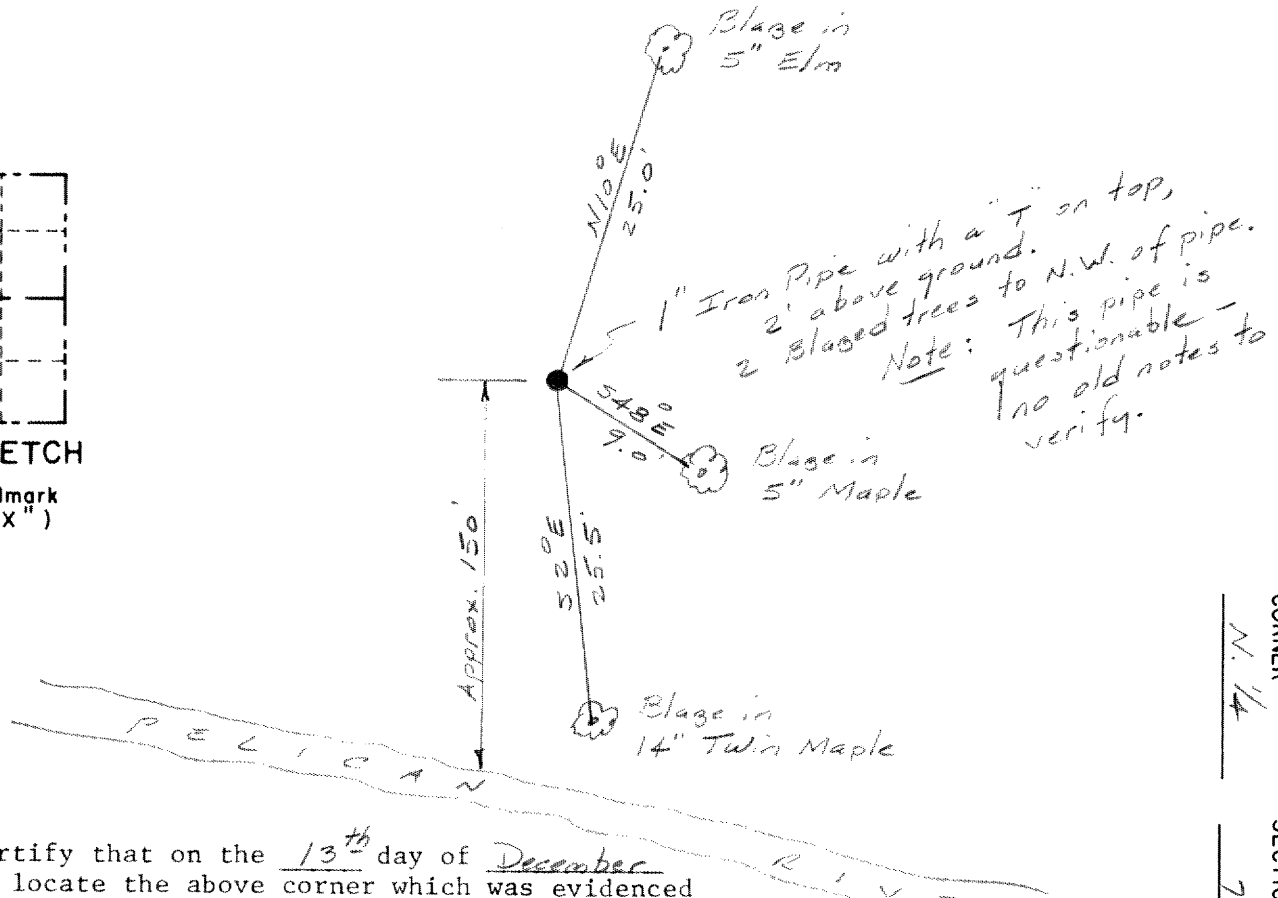

I hereby certify that on the 13th day of December 1973, that I did locate the above corner which was evidenced by a 1" Iron Pipe with a "T" on top, 2' above ground; I further certify that to perpetuate the location of such corner I did, at the exact location thereof, ~~place a permanent marker consisting of~~ leave the 1" Iron Pipe and "T" intact.; I further certify that I did establish 3 references ~~or witness monuments~~ consisting of a 5" Elm, a 5" Maple, and a 14" Twin Maple.

located as shown above:

Note: This work done by Eugene Dahl under the supervision of:

Signature Registered Land Surveyor William H. Scherer	Registration No. S--866	Title Survey Supervisor
---	-----------------------------------	-----------------------------------

CORNER
N. 1/4
SECTION
7
TOWN
36 N
RANGE
9 E