

**RECORD AND CERTIFICATION OF U.S. PUBLIC LAND SURVEY CONTROL STATION**

E-D-716-72

State of Wisconsin / Department of Transportation

RECEIVED & FILED # **444B**  
 Oneida County Surveyor's Office  
 Date: **JUN 27 1986**  
 By: **M**

District <b>7</b>	Project I. D. <b>1593-0-00</b>	Recovered Located by <b>EUGENE DAHL</b>			SURVEY CREW CHIEF DIVISION OF HIGHWAYS	
Corner <b>M.C. on E-W 1/4 line</b>	<b>8</b> SECTION	Township <b>36 N</b>	Range (E,W) <b>9 E</b>	County <b>ONEIDA</b>		
Wisconsin Coordinates CORNER	East (X) <b>2,157,013.97</b>	North (Y) <b>166,731.96</b>	Elevation (Z)	Zone <b>N.</b>		
Control Station Name	East (X)	North (Y)	Elevation (Z)	Zone		
Horizontal — <b>NORTH AMERICAN, 1927</b>		CONTROL DATUM		Vertical — <b>MEAN SEA LEVEL, 1929 ADJUSTMENT</b>		
Horizontal — <b>2<sup>ND</sup></b> Order		SURVEY CONTROL		Vertical — _____ Order		

**SKETCH**

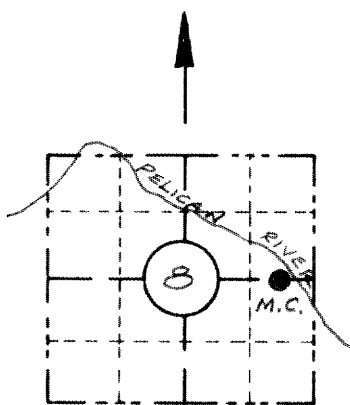

**LOCATION SKETCH**

(Location of landmark indicated by "X")

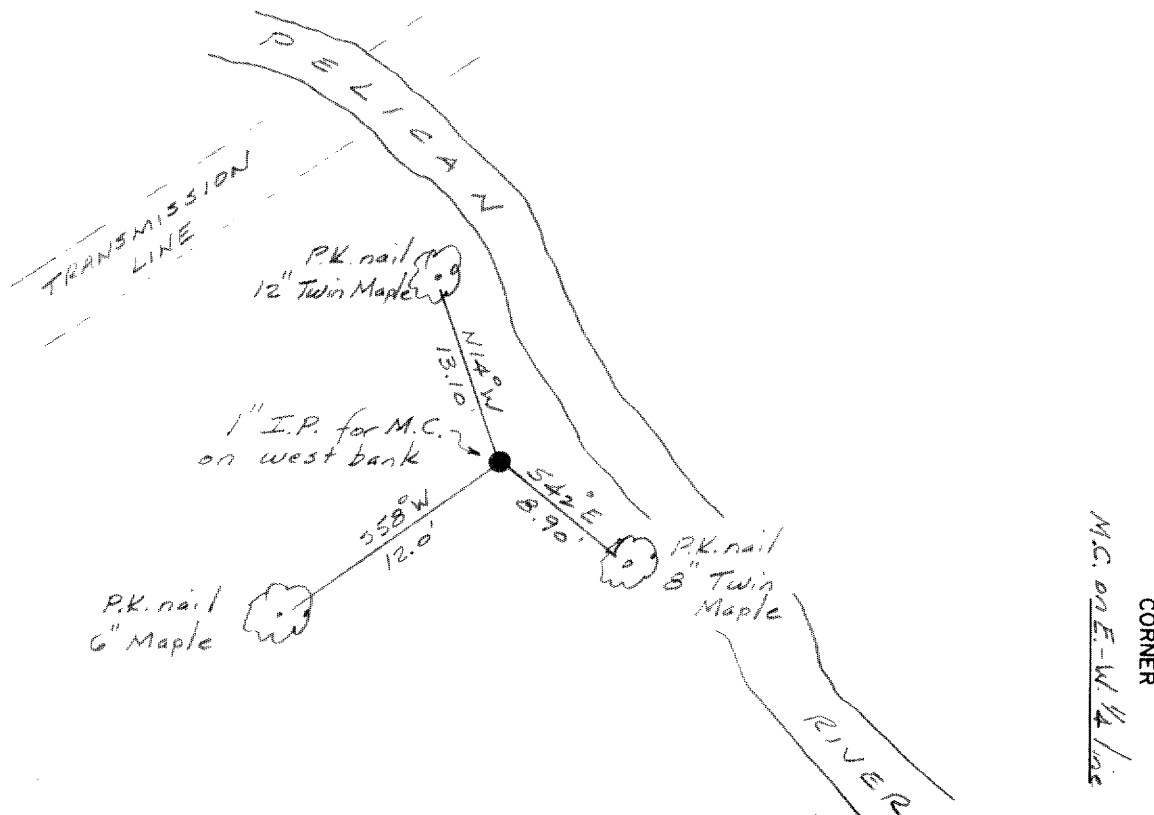

I hereby certify that <sup>in</sup> on the \_\_\_\_\_ day of December 1973, that I did locate the above corner which was evidenced by a 1" Iron Pipe; I further certify that to perpetuate the location of such corner I did, at the exact location thereof, ~~place a permanent marker consisting of~~ leave the 1" Iron Pipe intact.; I further certify that I did establish 3 references ~~or witness monuments~~ consisting of a 12" Twin Maple, a 6" Maple, and an 8" Twin Maple located as shown above:

Note: This work done by Eugene Dahl under the supervision of:

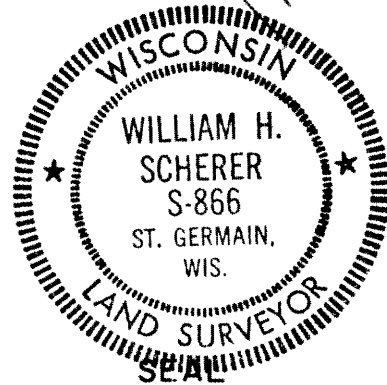

Signature Registered Land Surveyor <b>William H. Scherer</b>	Registration No. <b>S--866</b>	Title <b>Survey Supervisor</b>
---	-----------------------------------	-----------------------------------