

SEC. 15 T. 38 N. R. 7 E W.

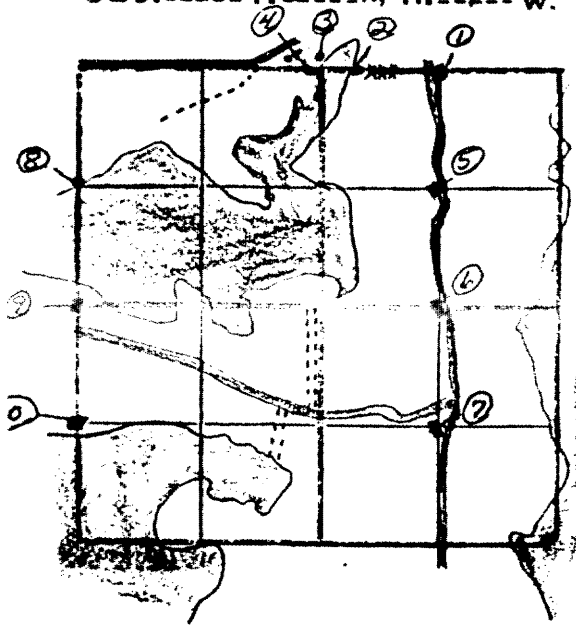

① N 1/4 NE 1/4. I.P. + S.P. B.T.'s - 09", 011"  
(Hall 1929)

② MC east shore N. Two Lakes, I.P. + W.P. B.T.'s -  
Or 7" S40E 9.9 ; Or 7" S19W 8.1. (Hall 1929)

③ MC North Shore N. Two Lakes. I.P. + B.C. B.T.'s - Pine Str. N67W 13.6 ;  
Pn 13" N90W 42.2 ; Or 12" N63E 17.5. (Hall 1929)

RECEIVED & FILED #	4,807
Onrda County Surveyors Office	
Date	APR 22 1988
By	S. J. /
OCS Area #	

④ MC West Shore N. Two Lakes. I.P. B.T.'s - Or 8" S28E 5.5 ; Bw 9" S75W 29.7  
(Hall 1929)

L807

⑤

Center NE 1/4. I.P. + S.P. 9 1/2 paces west of road.

B.T.'s - Pw 8" S67E 18' ; Pw 10" S27W 20'. (Hall 1929)

⑥

N 1/4 Corner SE 1/4. I.P. + S.P. 15 paces West of road.

B.T.'s - 08" N86E 12.5' ; 07" S56W 8.5'. (Hall 1929)

⑦

Center SE 1/4. I.P. + S.P. 13 paces West of road.

B.T.'s - Pw 10" S27W 20'. (Hall 1929)

⑧

W 1/4 NW 1/4. GLO B.C. (Hall 1929)

9) W/4. B.T.'s - Pn 10" E 98.7 ; Pn 8" S 8 W 93.8 (Hall 1929)

10) W/4 SW/4. W.P. B.T.'s Pn 18" N 32 E 105 ; Pn 18" S 71 W 94 . (Hall 1929)

RECEIVED & FILED #	1807
Orinda County Surveyor	S. C.
Date	APR 22 1988
By	S. J.
OCS Area #	

1807

SEC. 15 T. 38 N. R. 7 E. W.

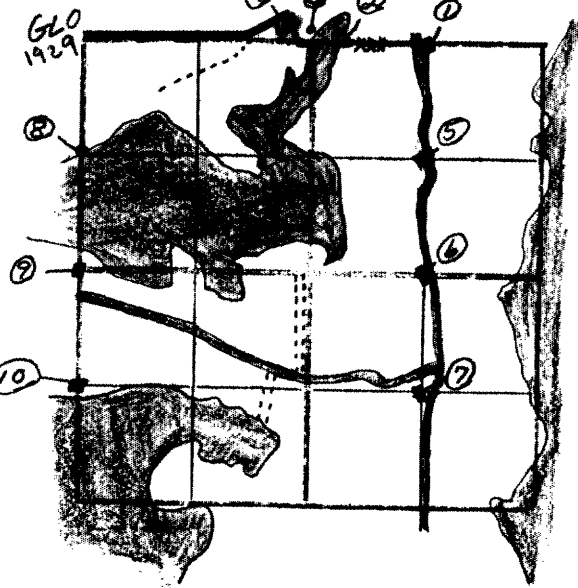

① N 1/4 NE 1/4. I.P. + S.P. B.T.'s - 09", 011"  
 (Hall 1929)

② MC east shore N. Two Lakes. I.P. + W.P. B.T.'s -  
 Or 7" S40E 9.9 ; Or 7" S19W 8.1. (Hall 1929)

③ MC North Shore N. Two Lakes. I.P. + B.C. B.T.'s - Pine St. N67W 13.6 ;  
 Or 13" N90W 42.2 ; Or 12" N63E 17.5. (Hall 1929)

④ MC West Shore N. Two Lakes. I.P. B.T.'s - Or 8" S28E 5.5 ; Bw 9" S75W 29.7.  
 (Hall 1929) found in 1987, Seymour

⑤

Center NE 1/4. I.P. + S.P. 9 1/2 paces west of road.

B.T.'s - Pw 8" S67E 18' ; Pw 10" S27W 20'. (Hall 1929)

⑥

N 1/4 Corner SE 1/4. I.P. + S.P. 15 paces West of road.

B.T.'s - 08" N86E 12.5' ; 07" S56W 8.5'. (Hall 1929)

⑦

Center SE 1/4. I.P. + S.P. 13 paces West of road.

B.T. - Bw 7" S16W 33.4' (Hall 1929)

⑧

W 1/4 NW 1/4. 920 B.C. (Hall 1929)

⑨ W/4. B.T.'s - Pn 10" E 98.7; Pn 8" S 8 W 93.8 (Hall 1929)  
Maine 1938 tracing

⑩ W/4 SW/4. W.P. B.T.'s Pn 18" N 32 E 105; Pn 18" S 71 W 94. (Hall 1929)  
Maine 1938 tracing  
See McMullen or Northwood's Surveyor Map  
McMullen's erroneous Co. Mon is 100 some ft. east.