

Sec 32 T. 38 N. R. 2 W. ^E

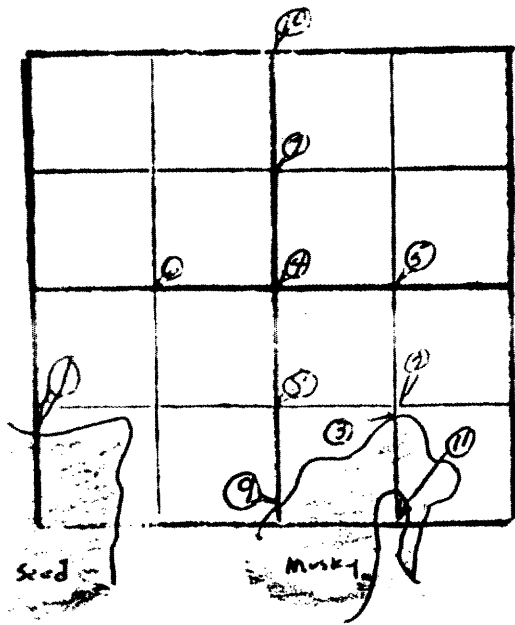

Set between Secs 31-32

① M.C. North Seed lake. From Hassler's T stub 4" N 7° E 15' 1KS, Found 1 downed SB. Bt., Hassler recorded T as N 07° W but Bt faces SW and S 32 is sealed on Bt. indicating it must have been N 07° E a six legged Beetle. faces corner. New Bts. P.W. 16" N 10° W 77 1KS, C 8" N 23° E 104 1KS. (Berndt Mentz 1961)

② Set 1/16 Center of SE 1/4 Bts. O.R. 8" S 66° W 71 1KS, B.W. 9" S 15° W 44 1/2 1KS (Berndt, Mentz, Rhinemann 1961)

③ Set M.C. 2.100 chains south of 1/16, Bts. O.R. 9" S 64° W 49 1/2 1KS, M.S. 8" S 57° E 37 1KS. (Berndt, Mentz, Rhinemann 1961) (clump of 3)

RECEIVED & FILED	APR 22 1988
On file only See also 9-0100	
Date	APR 22 1988
By	S. J. H.
OCS Area #	

④ Set center of Sec. 32-38-7 Bts. O.R. 6" S 21° E 26 1KS, O.R. 8" S 66° W 21 1/2 1KS. (Berndt Mentz, Rhinemann 1961)

828

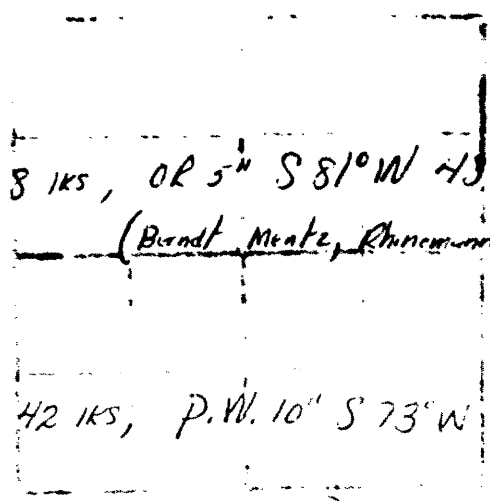

⑤ Set $\frac{1}{16}$ East of center Bts OJ 11" N10°W 8 IKS, OR 5" S 81°W 4 1/2 IKS
 (Berndt, Mentz, Rhinemann 1961)

⑥ Set $\frac{1}{16}$ West of center, Bts T 3" S 61°W 42 IKS, P.W. 10" S 73°W
 80 1/2 IKS, BY 15" N 82°W 89 IKS
 (Berndt, Mentz, Rhinemann 1961)

⑦ Set $\frac{1}{16}$ North of center, Bts. SW 7" N 55°E 85 IKS, O.R. 4" S 47°W 53 IKS.
 (Berndt, Mentz, Rhinemann 1961)

⑨ Set n.e. North side Musky lake, Bts. B.W. 4" S 87°W 7 1/2 IKS,
 O.R. 9" N 17°E 27 IKS
 (Berndt 1961)

⑩ Set N 1/4 32-38-7, Bts. BW 6" S 20°W 41KS, F4° N 63°W
57 1/2 KS

(Permit 1961)
~~Edwards~~

⑪ Set E 1/4 South line, Bts. OR 11" North 33 1/2 KS,
P.W. 18" N 74°W 8 KS

RECEIVED & FILED	4823
On file (containing) 30 1/2 1/2 1/2 1/2 1/2	
Date	APR 22 1988
By	<i>S. J.</i>
OCS Area	

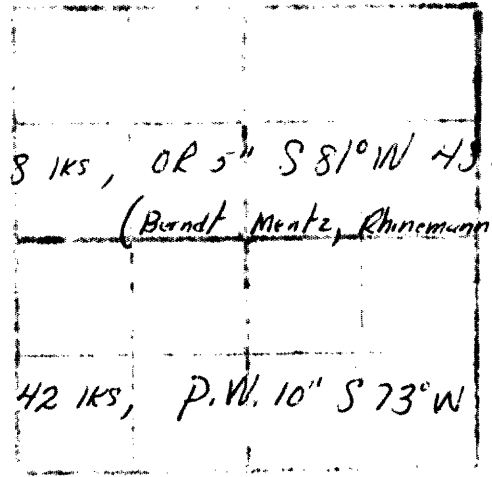

⑤ Set $\frac{1}{16}$ East of center Bts OJ 11" N10°W 8 IKS, OR 5" S 81°W 4 1/2 IKS
(Berndt, Mentz, Rhinemann 1961)

⑥ Set $\frac{1}{16}$ West of center, Bts T 3" S 61°W 4 1/2 IKS, P.W. 10" S 73°W
80 1/2 IKS, BY 15" N 82°W 89 IKS
(Berndt, Mentz, Rhinemann 1961)

⑦ Set $\frac{1}{16}$ North of center, Bts. SW 7" N 55°E 85 IKS, O.R. 4" S 47°W 53 IKS,
(Berndt, Mentz, Rhinemann 1961)

⑧ Set $\frac{1}{16}$ South of center, Bts. P.W. 11" S 73°W 20 IKS,
P.W. 8" S 37°E 6 IKS
(Berndt, Mentz, Rhinemann 1961)

⑨ Set M.C. North side Musky lake, Bts. B.W. 4" S 87°W 7 1/2 IKS,
O.R. 9" N 17°E 27 IKS
(Berndt 1961)

32-38-7

⑩ Set N $\frac{1}{4}$ 32-38-7, Bts. BW 6" S 20° W 41 KS, F4" N 63° W
57 $\frac{1}{2}$ KS

(Berndt 1961)
~~Eber~~

⑪ Set E $\frac{1}{16}$ South line, Bts. OR 11" North 33 $\frac{1}{2}$ KS,
P.W. 18" N 74° W 8 KS

⑫ W $\frac{1}{4}$ 32 - found WCD b.c. with scribed cedar post
C 16" N 67° E 1.9', C 10" S 15° W 28.2', C 10" N 24° W 27.0' Rein 1976

⑬ NW 32 - found 2" i.p. w/b.c. and scribed cedar post.
BT^s C 7" N 40° W 24.6', C 9" S 40° W 16.4', Spruce 9" S 63° E 29.3'
(J. Rein 1976)