

INDEX OF SHEETS

- SHEET NO. 1 TITLE
- SHEET NO. 2 TYPICAL CROSS SECTIONS
- SHEET NO. 2 ESTIMATE OF QUANTITIES
- SHEET NO. — MISCELLANEOUS QUANTITIES
- SHEET NO. — RIGHT OF WAY PLAT
- SHEET NO. 3 PLAN AND PROFILE STA. 238+73.5 TO STA. 239+26.50
- SHEET NO. — STANDARD DETAILS
- SHEET NO. 4-6 DRAINAGE STRUCTURES
- SHEET NO. — CROSS SECTIONS



STATE OF WISCONSIN  
STATE HIGHWAY COMMISSION OF WISCONSIN

PLAN AND PROFILE OF PROPOSED  
**RHINELANDER-GAGEN ROAD**  
**NORTH PELICAN RIVER BRIDGE**  
C.T.H. "C" — ONEIDA COUNTY  
PROJECT S0706 (4)

COUNTY AND HIGHWAY	ROUTE AND SECTION	CLASS AND AGREEMENT		FEDERAL DIVISION OFFICE	SHEET NUMBER	TOTAL SHEETS
		STATE	FEDERAL			
43.6	706.0		11.4	WIS. 4	1	6

SCALES { PLAN 1 IN. = 100 FT.  
PROFILE HOR. 1 IN. = 100 FT. VERT. 1 IN. = 10 FT.  
CROSS SECTIONS HOR. 1 IN. = 5 FT. VERT. 1 IN. = 5 FT.

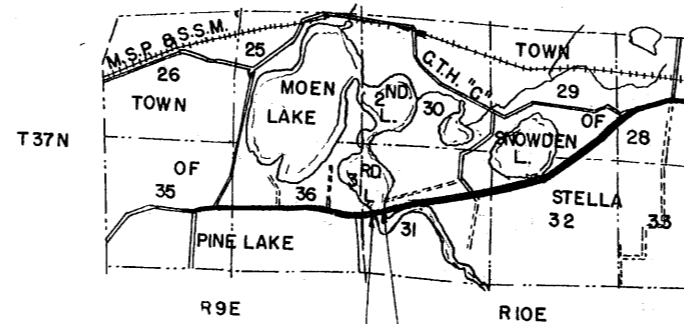

STA. 239+26.5 END OF PROJ. S 0706(4)  
=STA. 239+26.5 PROJ. S 0706(3)  
2085 FEET NORTH & 735 FEET EAST  
OF THE S.W. CORNER OF SEC. 31, T37N, R10 E.

STA. 238+73.5 BEGINNING OF PROJ. S 0706(4)  
=STA. 238+73.5 PROJ. S 0706(3)  
2055 FEET NORTH & 690 FEET EAST  
OF THE S.W. COR. OF SEC. 31, T37 N., R 10 E.

CONVENTIONAL SIGNS

STATE LINE		CULVERTS IN PLACE	
COUNTY LINE		CULVERTS REQUIRED	
TOWNSHIP OR RANGE LINE		DROP INLET	
SECTION LINE		POWER POLE	
NEW RIGHT OF WAY LINE		TELEPHONE OR TELEGRAPH POLE	
PRESENT RIGHT OF WAY LINE		RIGHT OF WAY MARKERS	
WIRE FENCE { WOVEN		REFERENCE STAKE FOR HUBS ONLY	
{ BARBED		MARSH	
LOT LINE		HEDGE	
CORPORATE OR CITY LIMITS		TREES	
PROPERTY LINE			
TRAVELED WAY OR P.E.			
RAILROADS			
BASE OR SURVEY LINE			

LAYOUT

SCALE

TOTAL NET LENGTH OF CENTERLINE = 0.010 MI.

STATE HIGHWAY  
COMMISSION OF WISCONSIN  
MADISON, WIS.

SURVEYOR J. KAY NOTE BOOK IRM  
DIVISION COMPUTER L.M.P. M. O. CHECKER  
DISTRICT CHECKER H.V.D. CORRECT.

CORRECT:  
DATE 3/9/60 Max Juttel  
DISTRICT ENGINEER

RECOMMENDED FOR APPROVAL:  
DATE 3/22/60 J. J. Pelly  
ENGINEER OF DESIGN

APPROVED:  
DATE 3/24/60 E.C. Rostrom  
STATE HIGHWAY ENGINEER

DEPARTMENT OF COMMERCE  
BUREAU OF PUBLIC ROADS

APPROVED: \_\_\_\_\_ DATE \_\_\_\_\_  
DISTRICT ENGINEER

S0706(4)