

PROJECT I.D. 9449 - 1 - 70	SHEET NUMBER 8	TOTAL SHEETS 58
FEDERAL PROJECT DESIGNATION S 0706 (7)		
Plan & Profile Sta. 430+00 - Sta. 447+00 For Oneida County		
C.T.H. "C"		

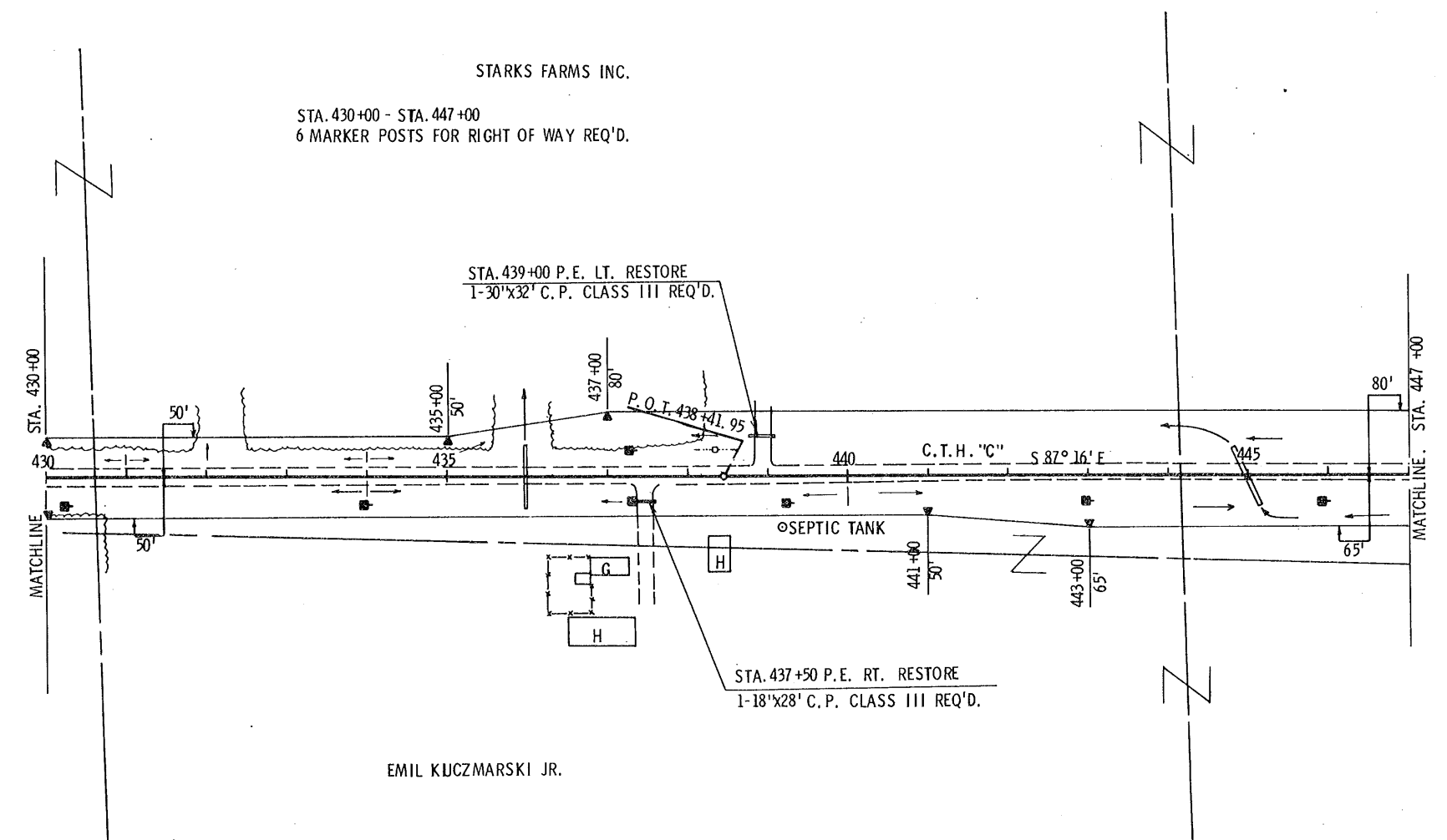

BENCH MARKS			
NO.	STATION	DESCRIPTION	ELEV.
8	433+95	P.K. NAIL IN POWER POLE 35' RT.	1623.43
9	442+95	P.K. NAIL IN POWER POLE 36' RT.	1627.28

NET CENTERLINE LENGTH STA. 430+00 - STA. 447+00 = 1,700.00 LIN. FT.

