

STA. 461+00 - STA. 467+00 LT.
600 LIN. FT. CURB & GUTTER
30" TYPE "D" REQ'D.

STA. 463+40 LT.
1-CATCH BASIN TYPE 2A REQ'D.
GRATE FLOWLINE ELEV. 1630.15
DISCHARGE ELEV. 1625.89
1-18"x40" R.C.C.P. CLASS III S.S. REQ'D.
PIPE INLET ELEV. 1625.89
PIPE DISCHARGE ELEV. 1625.77

PROJECT I.D. 9449 - 1 - 70	SHEET NUMBER 12	TOTAL SHEETS 58
FEDERAL PROJECT DESIGNATION S 706(7)		
Plan & Profile Sta. 461+00 - Sta. 467+00 For Oneida County		
C.T.H. "C"		

STA. 466+75 LT.
1-CATCH BASIN TYPE 2A REQ'D.
GRATE FLOWLINE ELEV. 1631.15
DISCHARGE ELEV. 1626.90
1-18"x40" R.C.C.P. CLASS III S.S. REQ'D.
PIPE INLET ELEV. 1626.90
PIPE DISCHARGE ELEV. 1626.78

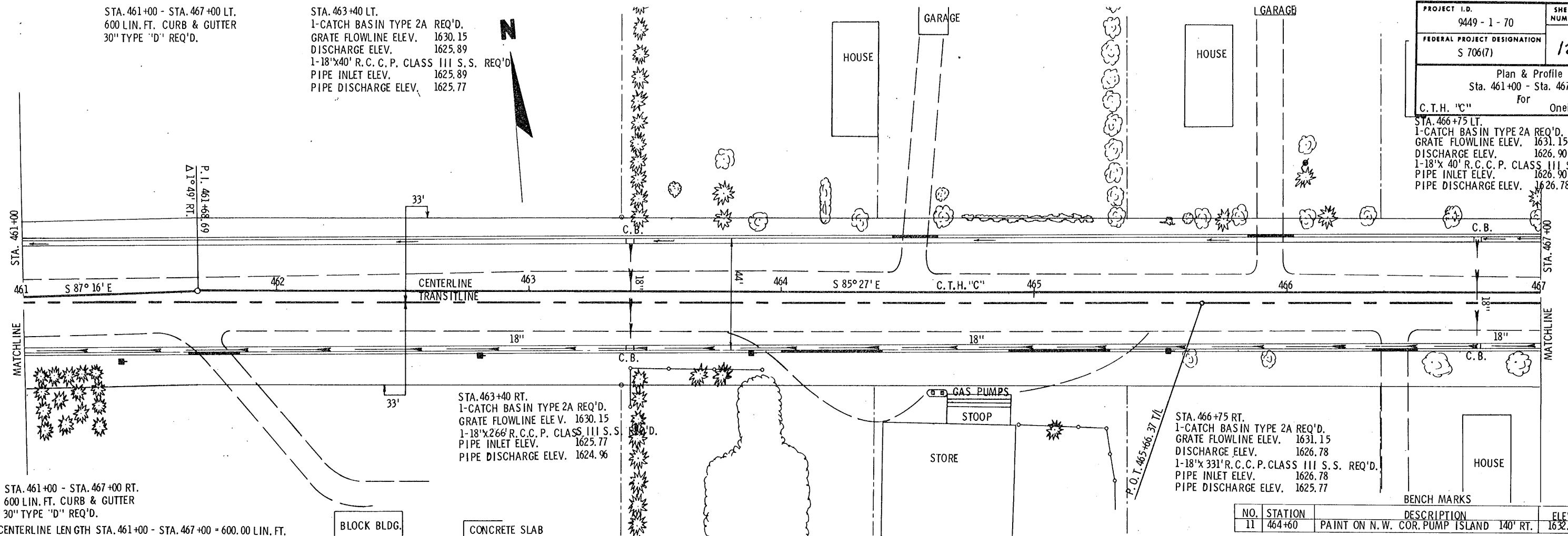

STA. 461+00 - STA. 467+00 RT.
600 LIN. FT. CURB & GUTTER
30" TYPE "D" REQ'D.

STA. 463+40 RT.
1-CATCH BASIN TYPE 2A REQ'D.
GRATE FLOWLINE ELEV. 1630.15
DISCHARGE ELEV. 1625.77
1-18"x26" R.C.C.P. CLASS III S.S. REQ'D.
PIPE INLET ELEV. 1625.77
PIPE DISCHARGE ELEV. 1624.96

STA. 466+75 RT.
1-CATCH BASIN TYPE 2A REQ'D.
GRATE FLOWLINE ELEV. 1631.15
DISCHARGE ELEV. 1626.78
1-18"x33" R.C.C.P. CLASS III S.S. REQ'D.
PIPE INLET ELEV. 1626.78
PIPE DISCHARGE ELEV. 1625.77

NO.	STATION	DESCRIPTION	ELEV.
11	464+60	PAINT ON N.W. COR. PUMP ISLAND 140' RT.	1632.36

NET CENTERLINE LENGTH STA. 461+00 - STA. 467+00 = 600.00 LIN. FT.

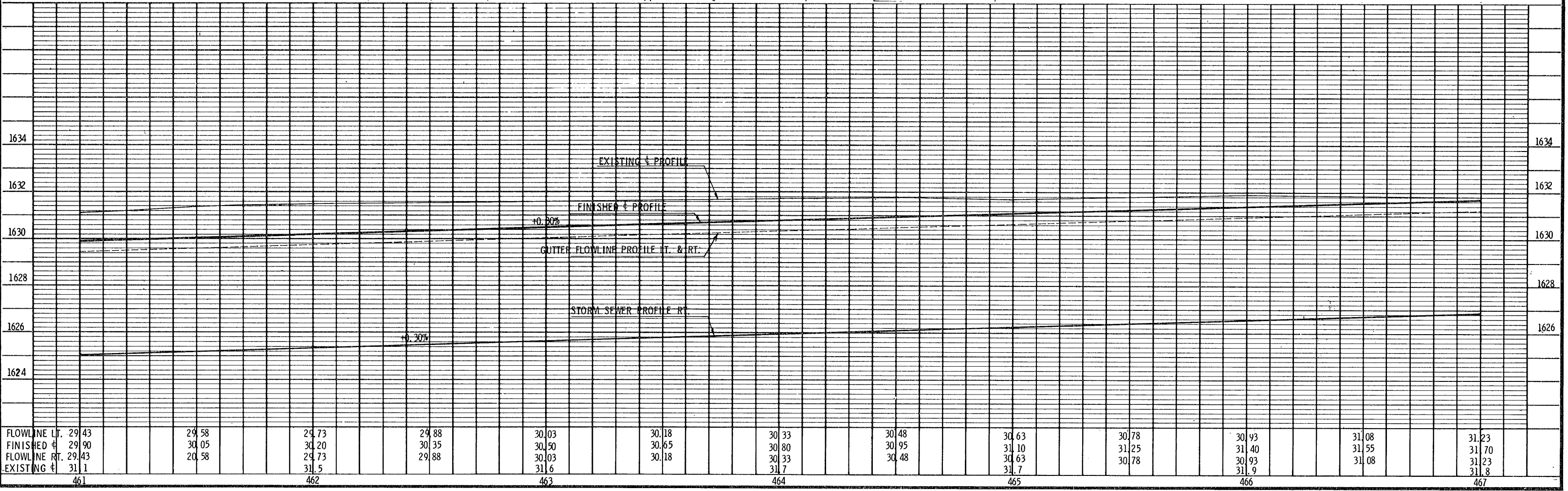

FLOWLINE LT.	29.43	29.58	29.73	29.88	30.03	30.18	30.33	30.48	30.63	30.78	30.93	31.08	31.23
FINISHED	29.90	30.05	30.20	30.35	30.50	30.65	30.80	30.95	31.10	31.25	31.40	31.55	31.70
FLOWLINE RT.	29.43	29.58	29.73	29.88	30.03	30.18	30.33	30.48	30.63	30.78	30.93	31.08	31.23
EXISTING	31.1	31.5	31.6	31.7	31.7	31.7	31.7	31.7	31.7	31.7	31.9	31.8	31.8
	461	462	463	464	465	466	467						