

PROJECT I.D. 9449 - 1 - 70	SHEET NUMBER 16	TOTAL SHEETS 58
FEDERAL PROJECT DESIGNATION S 0706(7)		
Plan & Profile Sta. 507+00 - Sta. 525+00 For Oneida County		
C.T.H. "C"		

MILES A. LEAVITT

DELORES BAILEY DRISCOLL

JEROME E. KUCZMARSKI

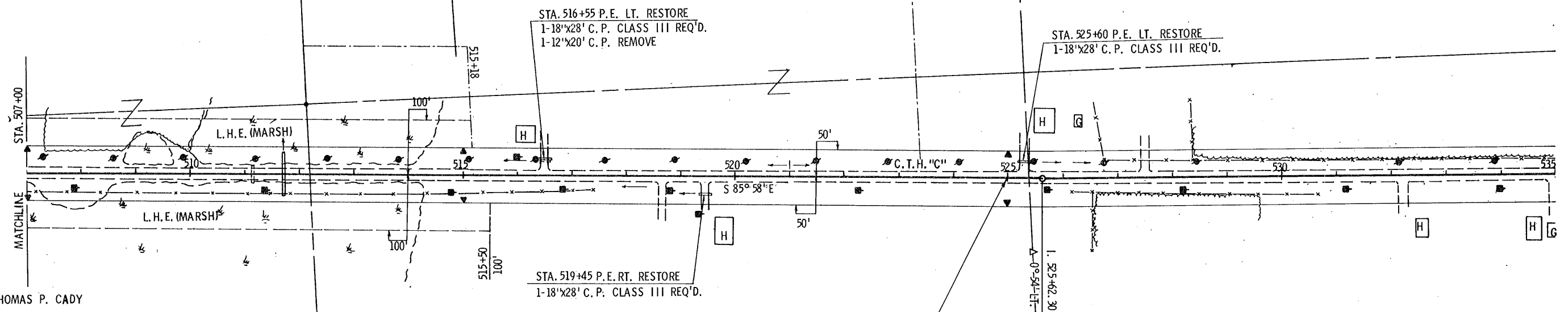

THOMAS P. CADY
STA. 507+00 - STA. 525+00
6 MARKER POSTS FOR RIGHT OF WAY REQ'D.

STA. 516+55 P.E. LT. RESTORE
1-18"x28" C.P. CLASS III REQ'D.
1-12"x20" C.P. REMOVE

STA. 525+60 P.E. LT. RESTORE
1-18"x28" C.P. CLASS III REQ'D.

STA. 519+45 P.E. RT. RESTORE
1-18"x28" C.P. CLASS III REQ'D.

END PROJECT S 0706(7) / 9449-1-70
STA. 525+00

BENCH MARKS			
NO.	STATION	DESCRIPTION	ELEV.
15	504+40	P.K. NAIL IN POWER POLE	30' RT, 1643.19
16	514+85	P.K. NAIL IN POWER POLE	30' RT, 1641.49
17	525+75	P.K. NAIL IN POWER POLE	30' RT, 1645.78
18	534+00	P.K. NAIL IN POWER POLE	30' RT, 1640.00

NET CENTERLINE LENGTH STA. 507+00 - STA. 525+00 = 1,800.00 LIN. FT.

UNCL.	6,445 CU. YDS
FILL	12,232 CU. YDS
SHG.	25%
MARSH	5,117 CU. YDS
BORROW	8,819 CU. YDS

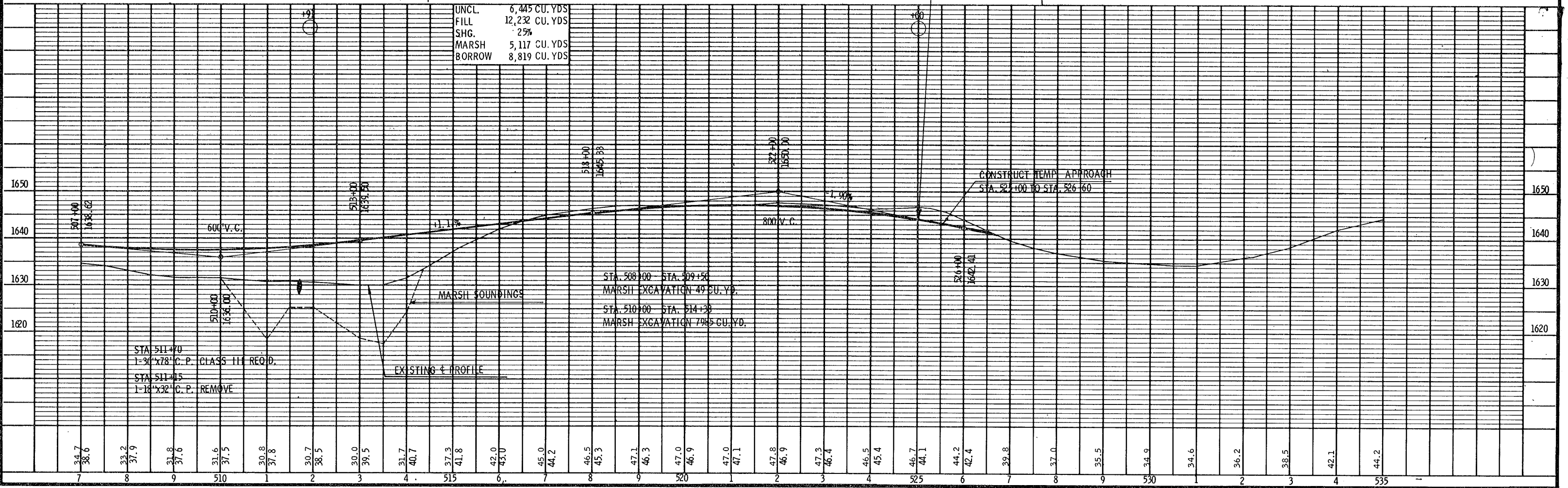

STA. 511+70
1-30"x78" C.P. CLASS III REQ'D.
STA. 511+45
1-18"x32" C.P. REMOVE

EXISTING & PROFILE

STA. 508+00 - STA. 509+50
MARSH EXCAVATION 49 CU. YD.

STA. 510+00 - STA. 514+30
MARSH EXCAVATION 795 CU. YD.

CONSTRUCT TEMP. APPROACH
STA. 521+00 TO STA. 526+60

7 34.7 38.6 8 33.2 37.9 9 31.8 37.0 510 31.6 37.5 1 30.8 37.8 2 30.7 38.5 3 30.0 39.5 4 31.7 40.7 515 37.3 41.8 6 42.0 43.0 7 45.0 44.2 8 46.5 45.3 9 47.1 46.3 520 47.0 46.9 1 47.0 47.1 2 47.8 46.9 3 47.3 46.4 4 46.5 45.4 525 46.7 44.1 6 44.2 42.4 7 39.8 8 37.0 9 35.5 530 34.9 34.6 2 36.2 3 38.5 4 42.1 535 44.2