

PEN TABLE = #Plot+LASER+my80pp.tbl
 DATE OF PLOT = 7/17/02
 DESIGN FILE IS L:\440307\#DGN#040409.LP.dgn
 DGN LEVELS ON = 1-63

LEVELS ON = 1, 2, 3, 4, 5, 6, 7, 8, 9, 10, 11, 12, 13, 14, 15, 16, 17, 18, 19, 20, 21, 22, 23, 24, 25, 26, 27, 28, 29, 30, 31, 32, 33, 34, 35, 36, 37, 38, 39, 40, 41, 42, 43, 44, 45, 46, 47, 48, 49, 50, 51, 52, 53, 54, 55, 56, 57, 58, 59, 60, 61, 62, 63

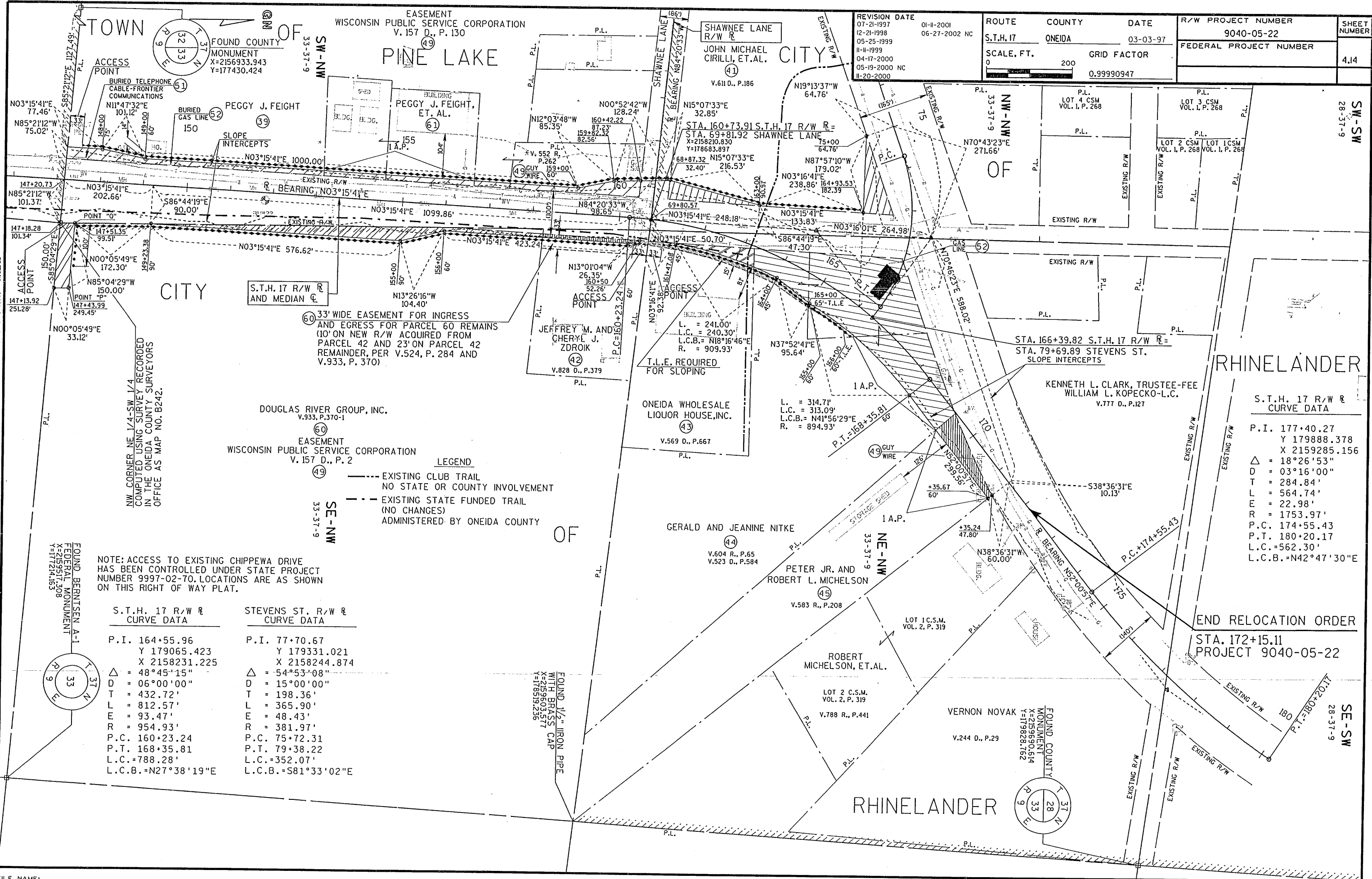

REVISION DATE	01-11-2001	ROUTE	COUNTY	DATE	R/W PROJECT NUMBER	SHEET NUMBER
07-21-1997	06-27-2002 NC	S.T.H. 17	ONEIDA	03-03-97	9040-05-22	4.14
12-21-1998		SCALE, FT.	GRID FACTOR		FEDERAL PROJECT NUMBER	
05-25-1999		0	0.99990947			
11-11-1999						
04-17-2000						
05-19-2000 NC						
11-20-2000						

NOTE: ACCESS TO EXISTING CHIPPEWA DRIVE HAS BEEN CONTROLLED UNDER STATE PROJECT NUMBER 9997-02-70. LOCATIONS ARE AS SHOWN ON THIS RIGHT OF WAY PLAT.

S.T.H. 17 R/W R CURVE DATA	STEVENS ST. R/W R CURVE DATA
P.I. 164+55.96	P.I. 77+70.67
Y 179065.423	Y 179331.021
X 2158231.225	X 2158244.874
Δ = 48°45'15"	Δ = 54°53'08"
D = 06°00'00"	D = 15°00'00"
T = 432.72'	T = 198.36'
L = 812.57'	L = 365.90'
E = 93.47'	E = 48.43'
R = 954.93'	R = 381.97'
P.C. 160+23.24	P.C. 75+72.31
P.T. 168+35.81	P.T. 79+38.22
L.C.B. = 788.28'	L.C.B. = 352.07'
L.C.B. = N27°38'19"E	L.C.B. = S81°33'02"E

S.T.H. 17 R/W R CURVE DATA

P.I. 177+40.27	Y 179888.378
X 2159285.156	Δ = 18°26'53"
D = 03°16'00"	T = 284.84'
L = 564.74'	E = 564.74'
R = 1753.97'	P.C. 174+55.43
P.T. 180+20.17	P.T. 180+20.17
L.C.B. = 562.30'	L.C.B. = N42°47'30"E

END RELOCATION ORDER
 STA. 172+15.11
 PROJECT 9040-05-22

