

To the Town Board of the Town of Lynne:-

Gentlemen:-

We the undersigned tax payers and free holders petition your body to lay out a public highway three rods wide, the same to start about the center of the South Line of the Southwest Quarter of the Southwest Quarter of Section 33, Township 36 N. of Range 4 East, thence going North Eighty rods, thence direct NorthWest to the Intersection Quarter post of Sections 32 and 33, Township Thirtysix N., of Range 4 E.

Or if the board should deem it advisable that these roads be laid out at Right Angles; then from the above named point which is 80 rods North of the of the Center of the South Line, thence forty rods West to the one eighth post, thence 80 rods North to the Intersection quarter post of Sections 32 and 33, Township 36N. or Range 4 East.

#####

Louis M. Kurylo

Stan. Dzwonkowski

J. A. Krasnowski

Frank Dzwonkowski

Mestorichals

Al Dzwonkowski

Andrew Skutlaba

Anton Mautyla

Alex Gaski

RUTH
ROAD
LYNN

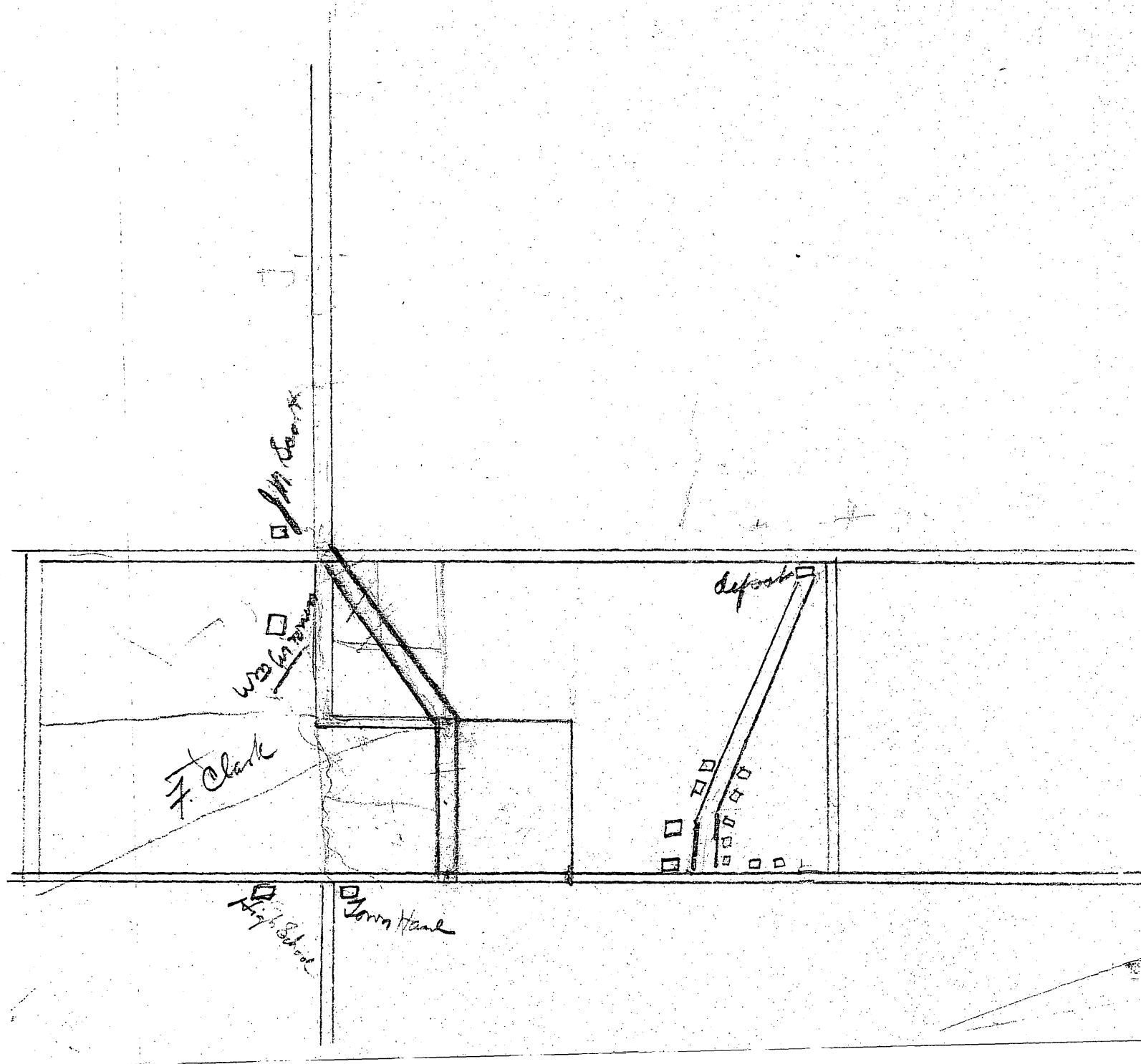

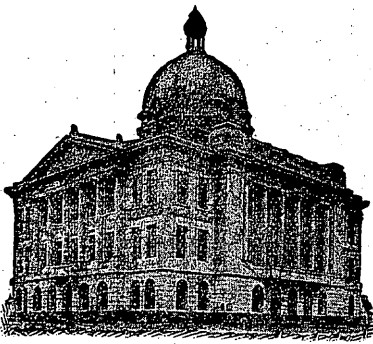

A. J. LeCLAIRE
CHAIRMAN

AUGUST DREWS
SUPERVISOR

JOHN LAAKSONEN
SUPERVISOR

C. E. BISHOP
CLERK

FRANK ERICKSON
TREASURER

TOWN OF LYNNE

3

TRIPOLI, WIS.

Whereas, upon application duly made therefor, the town board of the town of Lynne have decided to lay out a highway in said town. Course described as follows: Commencing at a point on the South line of sec. 33, in township 36 North, Range 4 East and equidistant between Southwest corner and West $\frac{1}{8}$ post of said sec. 33, thence North, parallel with the West line of said sec. 33 to the North boundary line of the Southwest $\frac{1}{4}$ of the Southwest $\frac{1}{4}$ of said sec. 33, thence West on the $\frac{1}{8}$ line to the Northwest corner of said Southwest $\frac{1}{4}$ of Southwest $\frac{1}{4}$ of said sec. 33, thence North on the section line to the West $\frac{1}{4}$ post of said sec. 33.

Such proposed highway will pass along the boundary lines of the Northwest $\frac{1}{4}$ of the SW $\frac{1}{4}$ of sec. 33 of which I am the owner.

Now, therefore, know all men by these presents, that I, John D. Baynes for, a valuable consideration by me received, have released and do hereby release to said town, all claim for damages sustained or to be sustained by me by reason of the laying out of said highway through my lands.

In witness whereof, I have hereunto set my hand and seal this 8 day of Sept, 1916.

Signed, sealed, and delivered in presence of:

John D. Baynes
Mary S. Baynes

COMMISSIONERS

J. A. HAZELWOOD, Chairman
Jefferson
W. O. HOTCHKISS, Secretary
Madison
F. E. TURNEAURE
Madison
JOHN S. OWEN
Eau Claire
J. H. VAN DOREN
Biramwood

WISCONSIN
HIGHWAY COMMISSION

MADISON, WISCONSIN

A. R. HIRST
State Highway Engineer
M. W. TORKELOSON
Bridge Engineer
H. S. ROCKWOOD
Chief, Clerk

Feb. 26, 1917.

Mr. C. E. Bishop,

CITY CLERK
VILLAGE CLERK
TOWN CLERK
COUNTY HIGHWAY COMMISSIONER

Tripoli,

WISCONSIN

Dear Sir: This is to certify that on Oct. 14, _____, 1915, a representative of the Wisconsin Highway Commission inspected the state aid road (County Line _____
App. 6188 _____, 1915.) constructed in 1915 in the town _____ of Lynne _____,
Oneida County, which road commences at the 1/4 post on the s. side of sec.
32-36-4E _____
and extends 8021 feet westerly to the s. w. corner of sec. 31 in said town

and found that it had been completed in accordance with the plans and specifications approved by the Wisconsin Highway Commission.

The road is ~~surfaced with~~ graded _____ approved by the Commission, and will be maintained in the future by said county as provided by sections 1317m—1 to 1317m—15 inclusive of the Wisconsin Statutes.

Yours respectfully,

WISCONSIN HIGHWAY COMMISSION,

By A. R. Hirst
State Highway Engineer.

Whereas, Upon application duly made therefor, the Supervisors of the town of Lynne Oneida County, Wis have duly decided to construct ----- a highway in said town described as follows:

Commencing at an Iron Monument (2 X 2 X 18") which stands on the South line of Section 33 in Township 36 North of Range 4 East, and 7.68 chains west of the South 1/4 Section Post of said Section 33, thence north 15° east, var. 4° east " Magnetic Course" 4.24 chains thence north 48 1/2° east, var. 4° east " " 30.81 chains to the right-of-way of the Minneapolis St. Paul & Sault St. Marie Ry. Co., being the depot grounds at Tripoli, Wis.

DEPOT ROAD

which said highway will pass through the following described lands of which ~~we~~ ^{we are} the owner, to-wit: The Southeast Quarter (SE 1/4) of the Southwest Quarter (SW 1/4) of Section Thirty-three (33) Township Thirty-six (36) North of Range Four (4) East.

Now, Therefore, Know all men by these presents that ~~we~~ ^{we} The Stolle Lumber Co. ----- for a valuable consideration by ~~us~~ ^{us} received, have released and do hereby release to said town all claims for damages sustained, or to be sustained by ~~us~~ ^{us} by reason of the construction ----- of said highway through ~~my~~ ^{our} said lands.

In Witness whereof, ~~we~~ ^{we} have hereunto set ~~my~~ ^{our} hand and seal this 30th ----- day of June 1914. 190

Signed, sealed and delivered in presence of A. L. MacLennan Wm J. Winters

STOLLE LUMBER CO., By H. H. Stolle, Pres. [SEAL]

STATE OF WISCONSIN, County of Oneida } ss day of June 1914. A. D. 190

Personally came before me this 30th ----- the above named H. H. Stolle

----- to me known to be the person who executed the foregoing instrument and acknowledged the same.

A. J. Clair, Notary Public. Com expires Aug 19, 1917.

COMMISSIONERS

J. A. HAZELWOOD, Chairman
Jefferson
W. O. HOTCHKISS, Secretary
Madison
F. E. TURNEAURE
Madison
JOHN S. OWEN
Eau Claire
J. H. VAN DOREN
Birmamwood

WISCONSIN
HIGHWAY COMMISSION

MADISON, WISCONSIN

A. R. HIRST
State Highway Engineer
M. W. TORKELSON
Bridge Engineer
H. S. ROCKWOOD
Chief Clerk

Feb. 26, 1917.

Mr. C. E. Bishop,

CITY CLERK
VILLAGE CLERK
TOWN CLERK
COUNTY HIGHWAY COMMISSIONER

Tripoli,

WISCONSIN

Dear Sir: This is to certify that on Nov. 2, 1916, a representative of the Wisconsin Highway Commission inspected the state aid road (Tripoli Willow Lake App. 922, 1916) constructed in 1916 in the town of Lynne, Oneida County, which road commences at the east 1/8 stk. on the S. side sec. 33-36-4E, thence N. to the 1/4 line, thence E to the 1/4 line and extends feet cor. sec. 33 & 34, thence northerly

and found that it had been completed in accordance with the plans and specifications approved by the Wisconsin Highway Commission.

The road is ~~ungraded~~ graded approved by the Commission, and will be maintained in the future by said county as provided by sections 1317m-1 to 1317m-15 inclusive of the Wisconsin Statutes.

Yours respectfully,

WISCONSIN HIGHWAY COMMISSION,

By A. R. Hirst
State Highway Engineer.

DEPOT
ROAD
T/LYNN

Whereas, Upon application duly made therefor, the Supervisors of the town of

Rumme
established

have duly decided to

lay out and

a highway in said town described as follows:

*"West Street" as laid out on plat of Stolle's
West lots filed in Register of Deeds Office
at Rhineland, Wisconsin*

which said highway will pass through the following described lands of which I am the owner, to-wit:

Now, Therefore, Know all men by these presents that I

H. H. Stolle

for a valuable consideration by me received, have released and do hereby release to said town all claims for damages sustained, or to be sustained by me by reason of the ~~said highway passing through~~ *West Street* through my said lands.

In Witness whereof, I have hereunto set my hand and seal this

15th

day of

September 190*9*

Signed, sealed and delivered in presence of

H. H. Stolle

[SEAL]

STATE OF WISCONSIN,

County of *Oneida* }
day of *September* } ss

Personally came before me this *15th*

A. D. 190*9*, the above named *H. H. Stolle*

to me known to be the person who executed the foregoing instrument and acknowledged the same.

C. Bishop
Town Clerk

Duplicate

Paul Lyne

~~COPIES ORIGINAL ON FILE IN CLERKS OFFICE TOWN OF KNOX~~

HIGHWAY ORDER.—For Town Line Road.

5-11-0

Printed and for sale by R. H. GILE, Milwaukee, Wis.

(Section 1273, W. S. 1898.)

8

Price County, }
Town of Knox } ss.

Whereas, Upon application of 7

freeholders and applicants for and occupiers of homesteads under the laws of the United States, residing in the Town of Knox, in the County of Price and of 6 freeholders, and applicants for and occupiers of homesteads under the laws of the United States, residing in the Town of Lynn, in the County of Oneida, for the laying out of a highway, which said highway is described in said application as follows: Beginning at

the quarter post between Section 36, Township 36 North of Range 3 East and Section 31, Township 36 North of Range 4 East, thence North on the County Line of Price and Oneida Counties to the South (1/8) post between Section 25 Township 36 North of Range 3 East and Section 30 Township 36 North of Range 4 East. Being a distance of three quarters of a mile, more or less:

We, the undersigned, Supervisors of said Towns, did on the 22 day of May 19 14 make out and sign a notice, and fix therein a time and place at which we would meet and decide upon such application, and did meet on the 15 day of June 19 14, at 9 o'clock in the fore-noon of said day at residence of Frank Saari, it being the time and place fixed by us in said notice; and having been first satisfied by due proof that the notice aforesaid had been duly given five days previous to the time of our said meeting, to all the occupants of the lands in each town through which said highway may pass, and had also been posted up in three public places in each of said towns ten days before the time of our said meeting, we, the undersigned Supervisors of each of said towns, Knox and Lynn acting together, did proceed to examine personally such highway, and having heard all reasons which were offered for or against laying out the same, and the said meeting having been duly adjourned by us to the day of 19 14 at 10 o'clock in the fore-noon of said day, at the time and place of which adjournment when made, public notice was duly given by us, and notice thereof was forthwith filed in the office of the Town Clerk of each of said Towns, the undersigned, Supervisors of each of said towns, did again meet at the said adjourned time and place, and having together made further examination in the premises, and heard all further reasons that were offered for or against said application, did, so acting together, decide upon such application; and deeming it necessary, did then and there determine to lay out such highway as hereinafter described.

Now, Therefore, Pursuant to application, we, the undersigned Supervisors of each of said towns of Knox & Lynn acting together, do hereby order and determine that a highway be and the same is hereby laid out as follows to wit:- Beginning at the quarter(1/4) post between Section (36) Township (36) North of Range (3) East and Section(31) Township (36) North of Range (4) East, thence North on the County line of Price and Oneida Counties to the South (1/8) post between Section (25) Township (36) North of Range (3) East and Section (30) Township (36) North of Range (4) East. Being three quarters (3/4) of a mile, more or less:

the same being an accurate survey thereof, caused by us to be made, and the said highway, being upon the town line between said towns, or as near thereto as the situation of the ground will admit. The line of said survey is the center of said highway, and the same is laid out of the width of four rods.

And we do further order and determine that the following part of said highway, to-wit:

∴ The first 200 rods to the center of the North description
∴ To be cleared and stumped

shall be made and kept in repair by the town of Knox, and the residue thereof by the town of Lynn, and that the damages awarded to or agreed upon with the owners

of the following described lands, to-wit:

SE 1/4 NE 1/4 Section 36 township 36, Range 3 East:
NE 1/4 NE 1/4 Section 36 township 36, Range 3 East:
SE 1/4 SE 1/4 Section 35 township 36, Range 3 East.

shall be paid by the said town of KNOX, and that the damages awarded to or agreed upon with the owners of the following described lands, to-wit:

SW 1/4 NW 1/4 Section 31 township 36, Range 4 East:
NW 1/4 NW 1/4 Section 31 township 36, Range 4 East:
SW 1/4 SW 1/4 Section 30 township 36, Range 4 East.

shall be paid by the said town of Lynn

Made and signed by us at Clifford this 15 th

day of June 19 14.

Alex Sandquist
John Kerkinen
Mike Norma

Supervisors of the town of KNOX

J.P. Kavanagh
August Jensen
Erst Steffen

Supervisors of the town of Lynn

PLACED
CLIFFORD
ROAD

Highway Order.

Town Line Highway between Town of

Knox, Pine Co.

and Town of:

Lynn, Onida Co.

Town..... Range.....

Made....., 19.....

Filed..... June 29, 1914

J. LeClair

Town Clerk,

Town of Lynn