

Three Lakes 18-20
 TOWN PLAT RECORD-WISCONSIN HIGHWAY COMMISSION
 TOWN OF THREE LAKES - COUNTY OF ONEIDA

TABLE OF MILEAGES

| Date of Last Cor. | Fed. For. Dev. Rds. | State Park Rds. | State Fire Lanes | State Trunks | County Trunks | Local Roads |
|-------------------|---------------------|-----------------|------------------|--------------|---------------|-------------|
| 11-19-46 | | | | 7.33 | 7.47 | 12.27 |
| 11-15-49 | | | | 7.33 | 7.47 | 12.27 |
| 9-17-47 | | | | 7.33 | 7.47 | 12.27 |
| 10-26-48 | | | | 7.33 | 7.47 | 12.27 |
| 11-5-45 | | | | 7.33 | 7.47 | 12.27 |
| 9-24-46 | | | | 7.33 | 7.47 | 12.27 |
| 9-18-47 | | | | 7.33 | 7.47 | 12.27 |

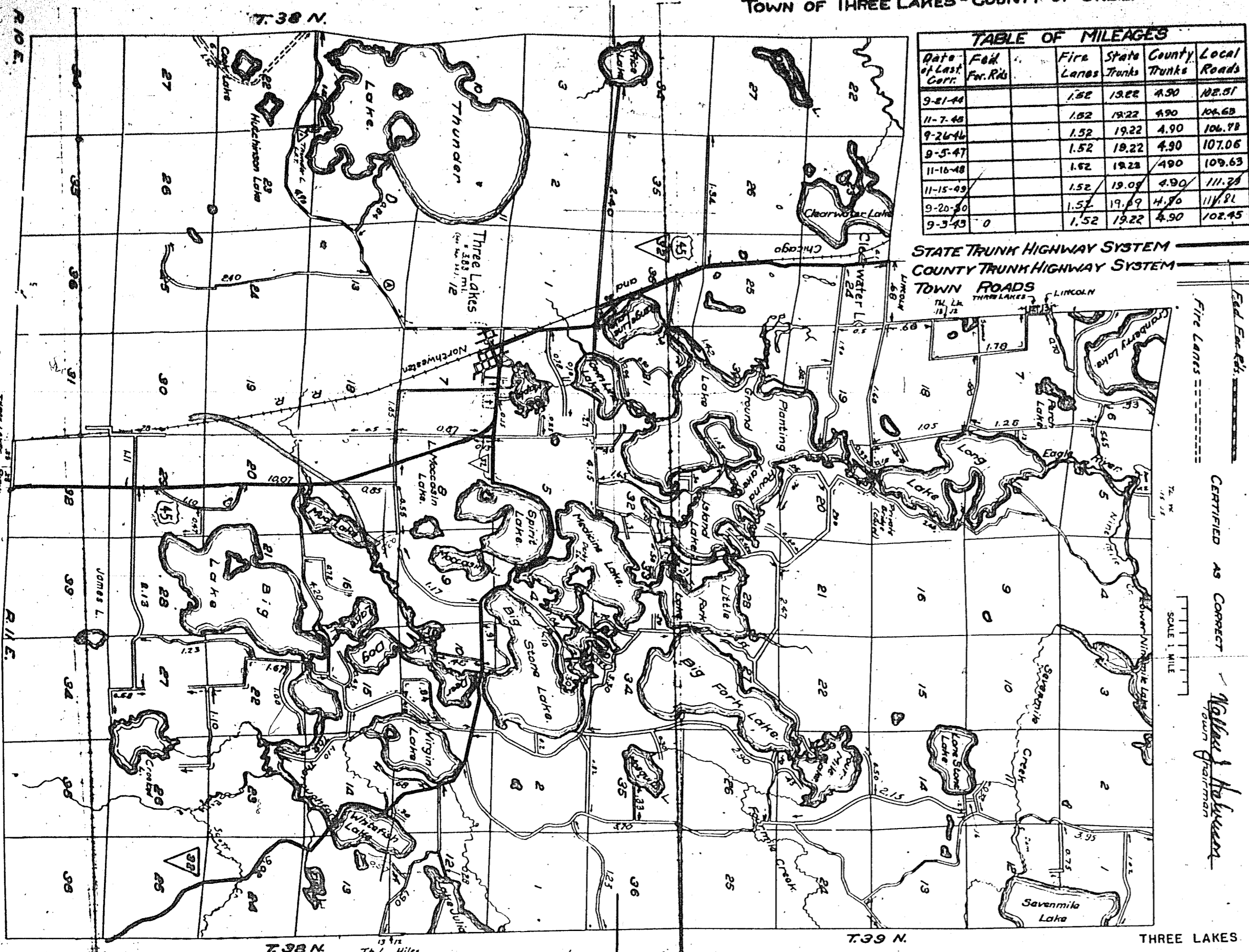

CERTIFIED AS CORRECT
 Walter Halverson
 Town Chairman

STATE HIGHWAY COMM. OF WISCONSIN
 TOWN PLAT RECORD

Town WOODBORO County ONEIDA

| Date of Last Cor. | Fed. For. Dev. Rds. | State Park Rds. | State Fire Lanes | State Trunks | County Trunks | Local Roads | Symbols |
|-------------------|---------------------|-----------------|------------------|--------------|---------------|-------------|----------|
| 11-19-46 | | | | 7.33 | 7.47 | 12.27 | Sch. 4 |
| 11-15-49 | | | | 7.33 | 7.47 | 12.27 | Cem. 11 |
| 10-26-48 | | | | 7.33 | 7.47 | 12.27 | Tower 11 |
| 11-5-45 | | | | 7.33 | 7.47 | 12.27 | Gate 11 |
| 9-24-46 | | | | 7.33 | 7.47 | 12.27 | |
| 9-18-47 | | | | 7.33 | 7.47 | 12.27 | |

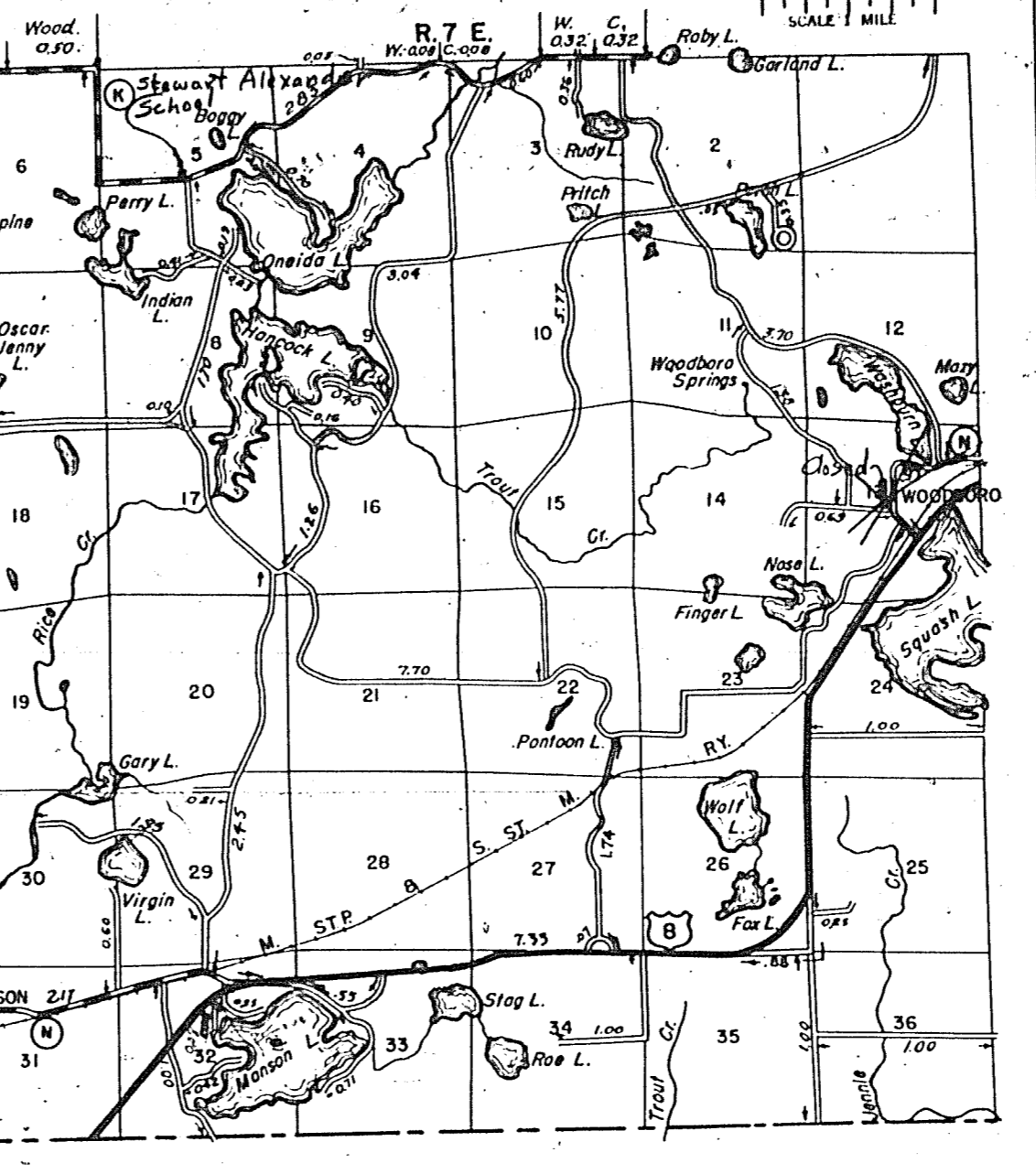

CERTIFIED AS CORRECT
 Walter Halverson
 Town Chairman

STATE HIGHWAY COMMISSION OF WISCONSIN
 TOWN PLAT RECORD

Town of WOODRUFF County of ONEIDA

| Date of Last Cor. | Fed. For. Dev. Rds. | State Park Rds. | State Fire Lanes | State Trunks | County Trunks | Local Roads |
|-------------------|---------------------|-----------------|------------------|--------------|---------------|-------------|
| 10-30-42 | | | | 4.32 | 8.62 | 11.02 |
| 10-21-43 | | | | 4.32 | 8.62 | 11.02 |
| 10-26-48 | | | | 4.32 | 8.62 | 11.02 |
| 11-5-45 | | | | 4.32 | 8.62 | 11.02 |
| 11-15-46 | | | | 4.32 | 8.62 | 11.02 |
| 9-17-47 | | | | 3.78 | 7.30 | 11.02 |
| 10-22-49 | | | | 3.78 | 7.30 | 11.90 |
| 10-25-49 | | | | 3.78 | 7.30 | 10.65 |
| 10-18-50 | | | | 3.78 | 7.30 | 10.69 |

CERTIFIED AS CORRECT
 Walter Halverson
 Town Chairman

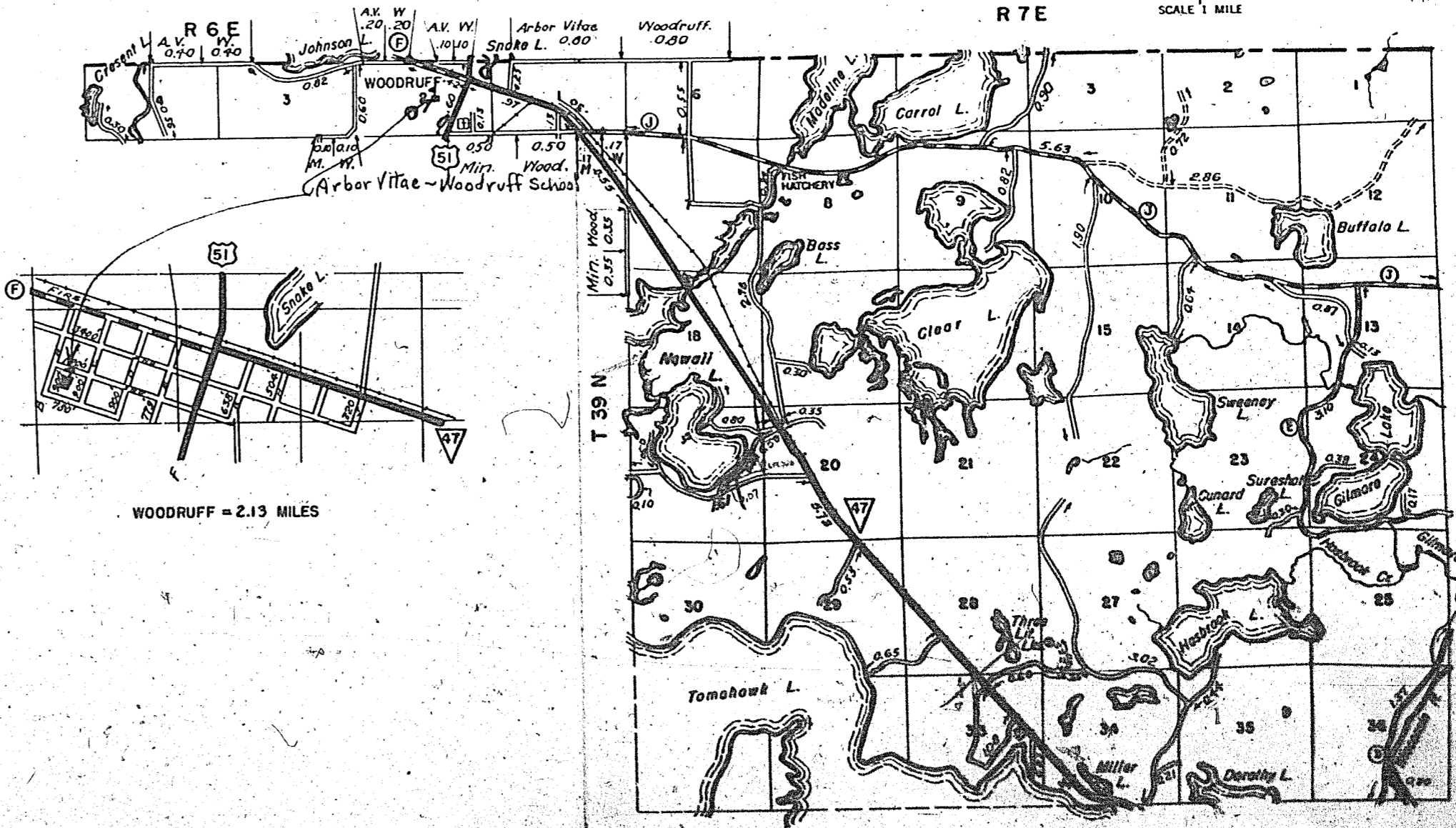

CERTIFIED AS CORRECT
 Walter Halverson
 Town Chairman

VILLAGE
 THREE LAKES
 TOWN: THREE LAKES
 COUNTY: ONEIDA
 UNINCORPORATED

| DATE OF LAST COR. | STATE TRUNKS | COUNTY TRUNKS | LOCAL STREETS |
|-------------------|--------------|---------------|---------------|
| 1-1-48 | | | 3.83 |
| 11-16-48 | | | 3.83 |
| 11-15-49 | | | 3.83 |
| 9-20-51 | | | 3.83 |

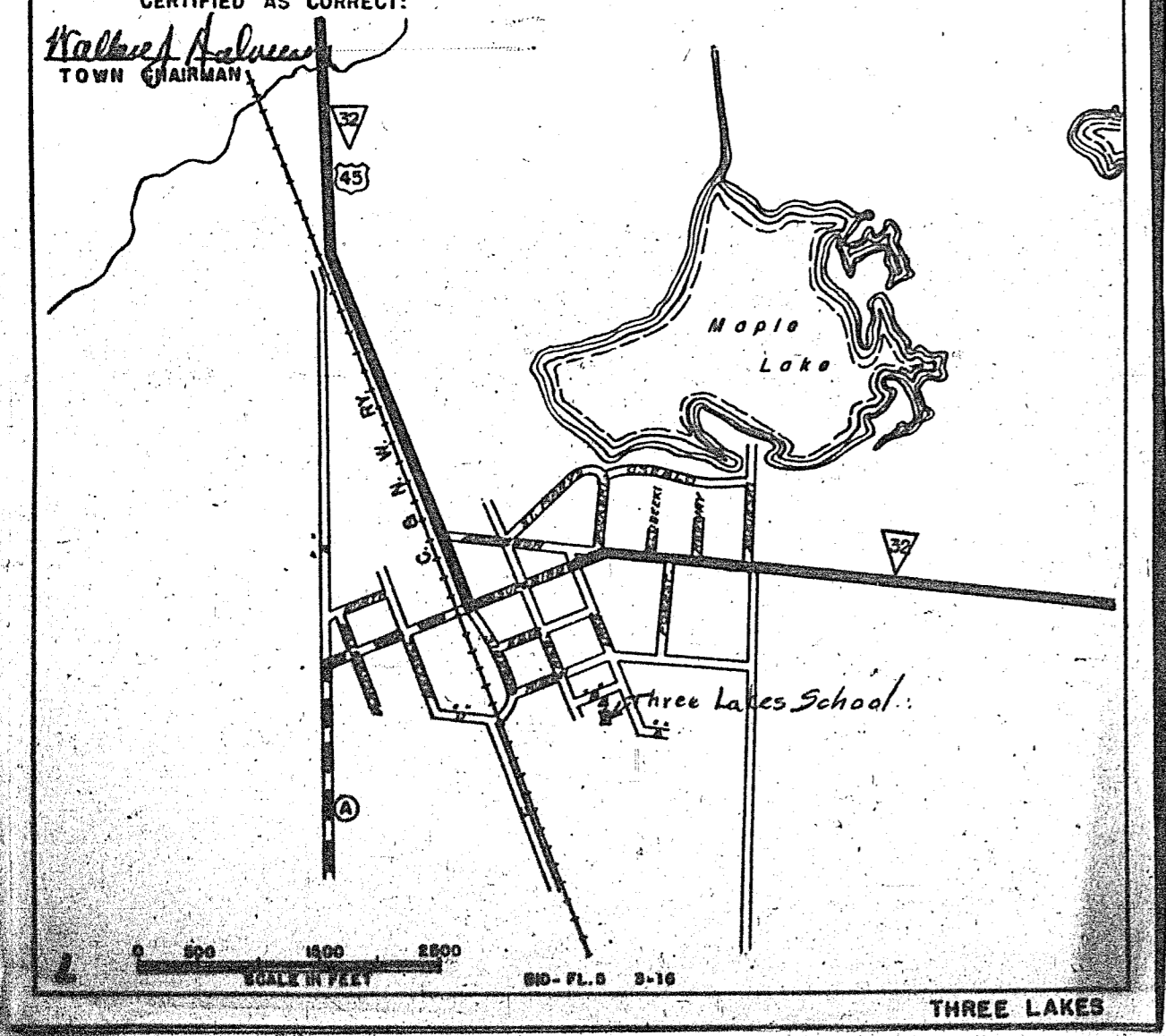

Town of Three Lakes County Oneida

| Name of Street | Gross Length | Inter. Street | Feet | Net Length | State Trunk | County Trunk | Local Street |
|--------------------|--------------|---------------|------|------------|-------------|--------------|--------------|
| Anderson | 127 | | | | | | 127 |
| North | 425 | | | | | | 425 |
| Erle | 780 | | | | | | 780 |
| Huron | 1900 | | | | | | 1900 |
| "B" | 360 | | | | | | 360 |
| "D" | 546 | | | | | | 546 |
| "A" | 245 | | | | | | 245 |
| "G" | 3168 | 1 | 60 | 3168 | | | 3168 |
| Blackington Avenue | 895 | 2 | 120 | 636 | | | 685 |
| Russell Ave. | 1146 | 2 | 120 | 1028 | | | 1028 |
| "G" | 1644 | 1 | 60 | 1654 | | | 1654 |
| Gogebic | 906 | 2 | 120 | 786 | | | 786 |
| Michigan | 1720 | 4 | 240 | 1640 | | | 1640 |
| St. Marys | 850 | 1 | 60 | 890 | | | 890 |
| Osawato | 1282 | 2 | 120 | 1162 | | | 1162 |
| Lake | 1684 | 2 | 120 | 1464 | | | 1464 |
| Pulaski Ave. | 760 | 1 | 60 | 700 | | | 700 |
| Forest Ave. | 900 | 2 | 120 | 780 | | | 780 |
| Hedway Ave. | 280 | 1 | 60 | 200 | | | 200 |
| Slusbeckst | 210 | 1 | 60 | 150 | | | 150 |
| Sobieski Ave. | 641 | 1 | 60 | 581 | | | 581 |

Total Feet 30211
 Total Miles 3.85

CERTIFIED AS CORRECT
 Walter Halverson
 Town Clerk