

STATE HIGHWAY COMMISSION OF WISCONSIN
TOWN PLAT RECORD

Town of NEWBOLD						County of ONEIDA		
Date of Last Corr.	Fed. For. Dev. Rds.	State Park Rds.	State Fire Lane	State Trunks	County Trunks	Local Roads	--LEGEND--	
10-10-51				11.10	14.56	85.89	State Trunk Highway Sys	
12-8-52				11.10	14.56	83.68	County Trunk Highway Sys	
9-25-53				11.10	16.98	86.15	Local Roads	
12-14-54				11.10	16.98	85.85	Fed. Forest Dev. Roads	
9-28-55				11.10	16.98	85.35	State Park Roads	
10-1-56				11.10	16.98	86.40	State Fire Lane	
3-1-57				11.10	16.98	86.47	Certified as Correct	
11-15-49				11.10	14.56	85.08	Town Chairman	
10-31-50				11.10	14.56	85.08		

MILES SHOWN ARE NET

SCALE 1 MILE

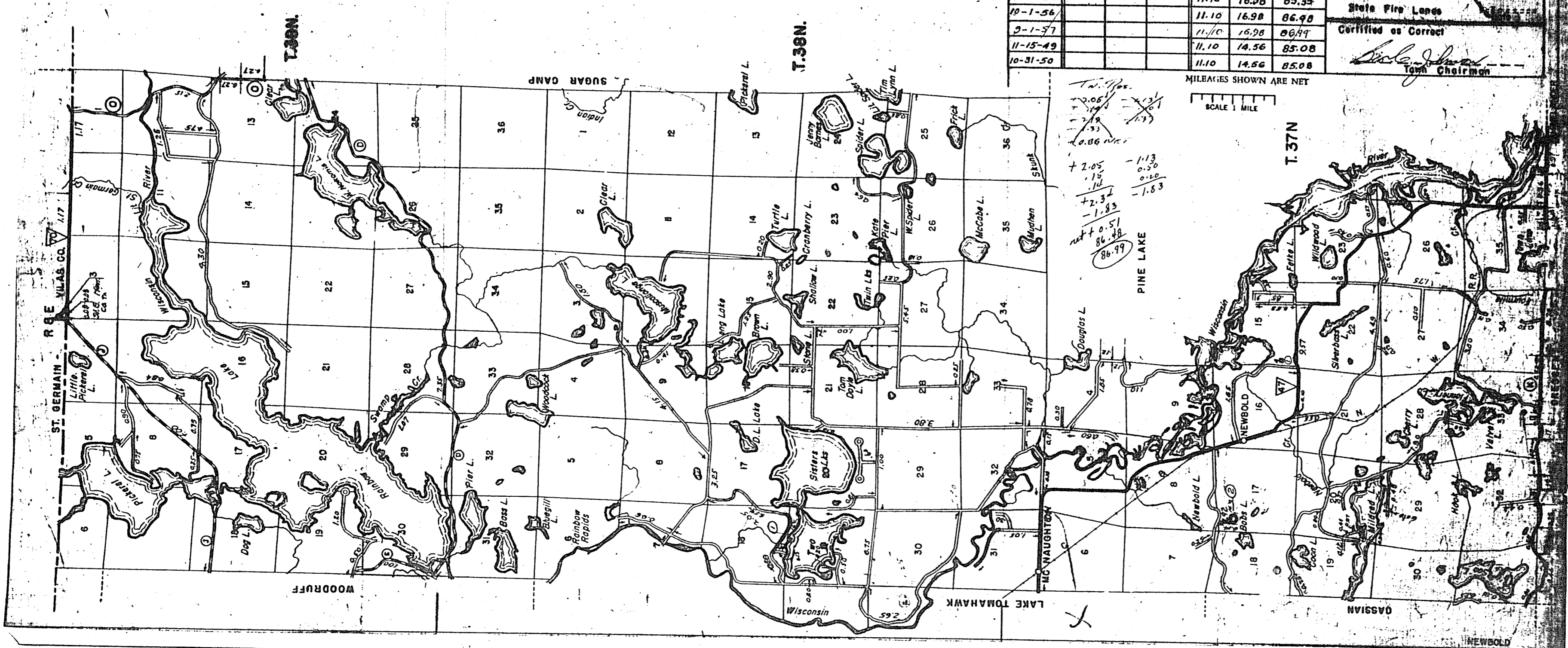

STATE HIGHWAY COMM. OF WISCONSIN
TOWN PLAT RECORD

Town... NOKOMIS		County... ONEIDA					Symb-ols
Date of Last Corr.	Fed. For. Dev. Rds.	State Park Rds.	State Fire Lane	State Trunks	County Trunks	Local Roads	
12-20-54				6.61	7.23	43.77	Sch. 4
10-3-55				6.61	7.23	43.83	Cem. 11
9-11-56				6.61	7.23	43.83	Tower 11
3-9-57				6.61	7.23	43.83	Gate 11
11-13-52				6.61	7.23	43.20	
9-24-53				6.61	7.23	43.75	

Certified as Correct By Town Chairman: *George White*

