

STATE HIGHWAY COMM. OF WISCONSIN
TOWN PLAT RECORD

Town, HAZELHURST County, ONEIDA (43-004A)

| Date of Last Corr. | State Trunks | County Trunks | Local Roads | Symbols |
|--------------------|--------------|---------------|-------------|---------|
| 1-1-58 | 6.41 | 6.00 | 37.59 | Sch. 4 |
| 1-1-59 | 6.41 | 6.07 | 36.31 | Cem. II |
| 1-1-60 | 6.41 | 6.08 | 36.52 | Tower |

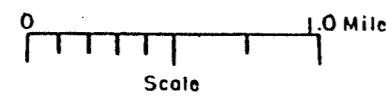

36.52-23-36.29

Certified as Correct By Town Chairman: *John Madelon*

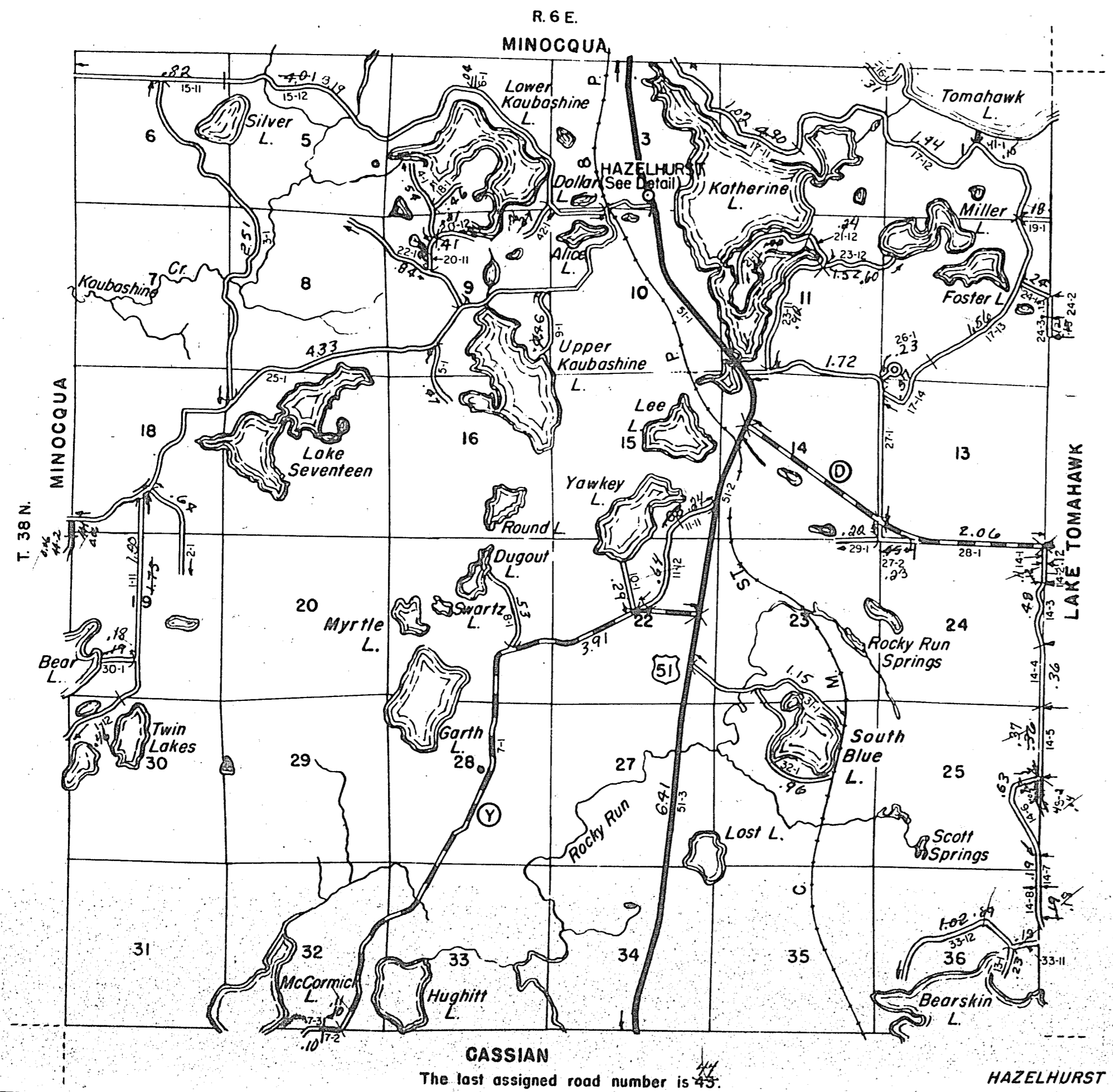

CASSIAN
The last assigned road number is 45.

HAZELHURST

STATE HIGHWAY COMM. OF WISCONSIN
TOWN PLAT RECORD

HAZELHURST - UNINCORPORATED (43-004B)

| Date of Last Corr. | State Trunks | County Trunks | Local Roads | Symbols |
|--------------------|--------------|---------------|-------------|---------|
| 1-1-58 | 0 | 0 | 2.09 | Sch. 4 |
| 1-1-59 | 0 | 0 | 1.97 | Cem. II |
| 1-1-60 | 0 | 0 | 1.61 | Tower |

Certified as Correct By Town Chairman: *John Madelon*

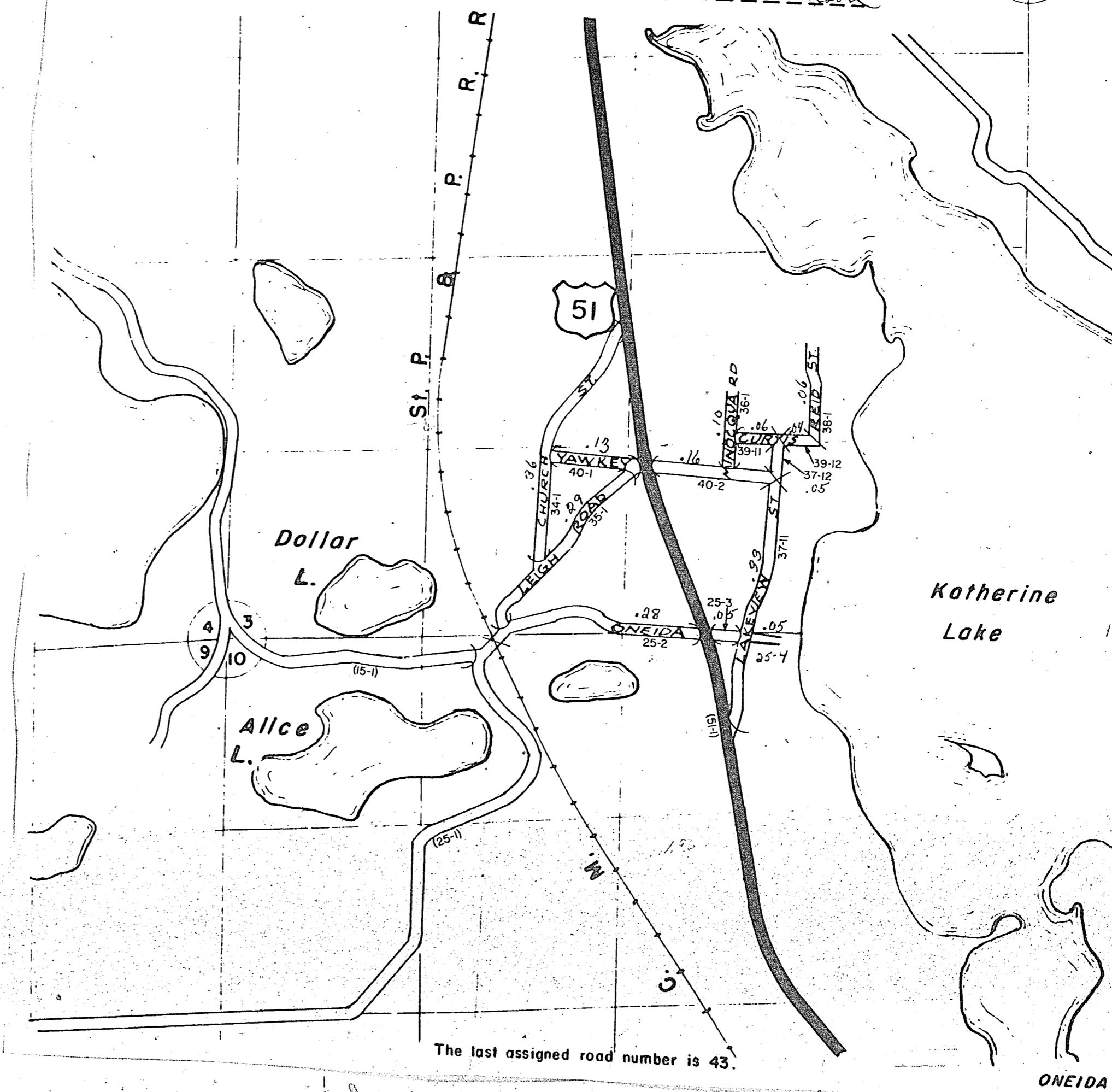

The last assigned road number is 43.

ONEIDA

34 35
3 2