

STATE HIGHWAY COMM. OF WISCONSIN
TOWN PLAT RECORD

Town - PINE LAKE County - ONEIDA (43-014)

| Date of Last Corr. | State Trunks | County Trunks | Local Roads | Symbols |
|--------------------|--------------|---------------|-------------|---------|
| 1-1-58 | 6.51 | 6.44 | 56.13 | Sch. 4 |
| 1-1-59 | 6.51 | 6.48 | 53.48 | Cem. II |
| 1-12-60 | 6.38 | 4.48 | 53.44 | Tower |

53.44 - 40 = 53.04
Certified as Correct By Town Chairman: *John J. Heenan*

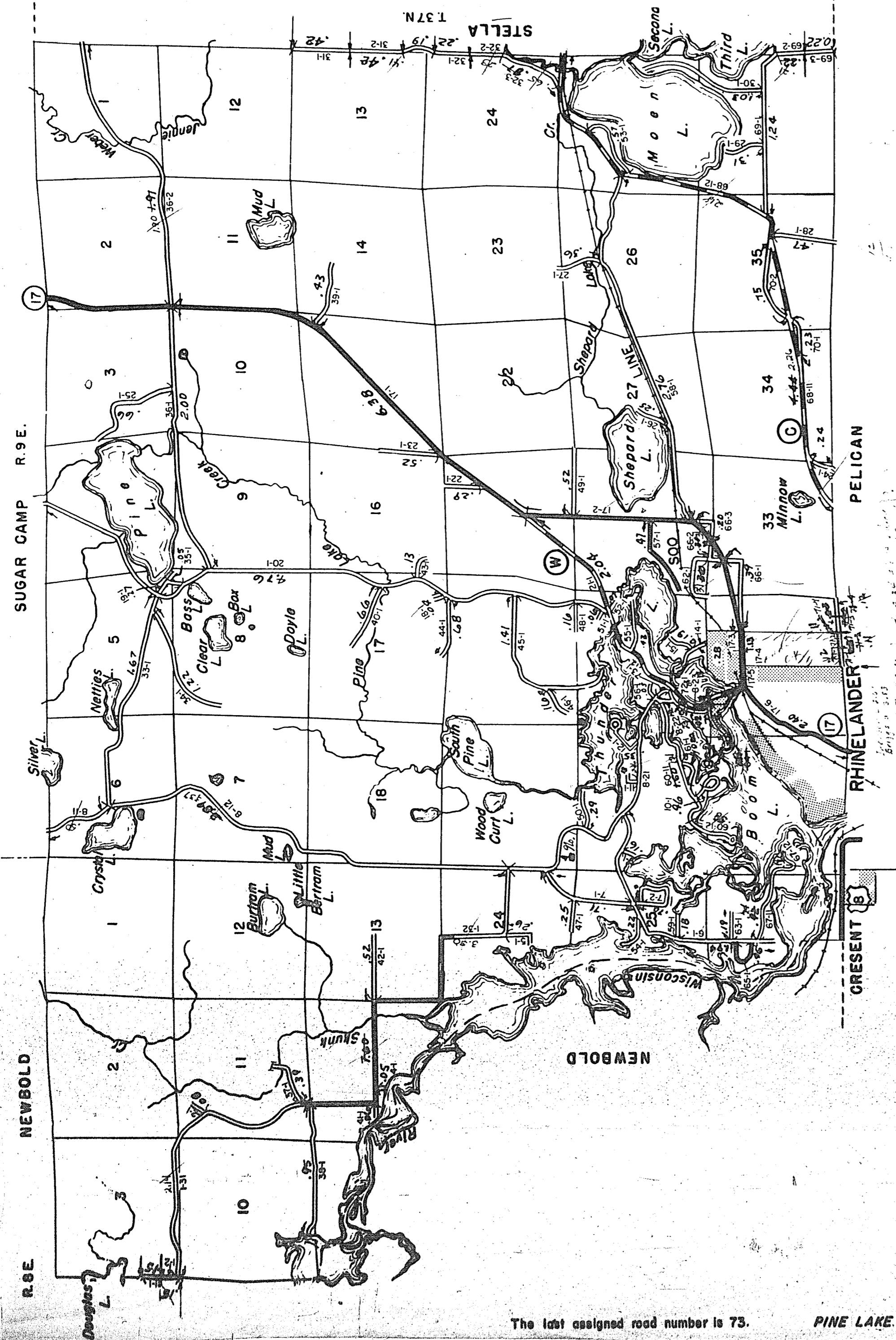
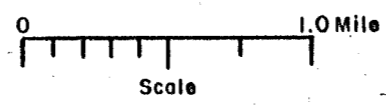

The last assigned road number is 73. PINE LAKE.

STATE HIGHWAY COMM. OF WISCONSIN
TOWN PLAT RECORD

Town - SCHOEPKE County - ONEIDA (43-015)

| Date of Last Corr. | State Trunks | County Trunks | Local Roads | Symbols |
|--------------------|--------------|---------------|-------------|---------|
| 1-1-58 | 4.59 | 16.75 | 34.47 | Sch. 4 |
| 1-1-59 | 4.59 | 16.15 | 35.34 | Cem. II |
| 1-12-60 | 4.59 | 16.14 | 34.97 | Tower |

34.87 - 21 = 34.66

Certified as Correct By Town Chairman: *John J. Heenan*

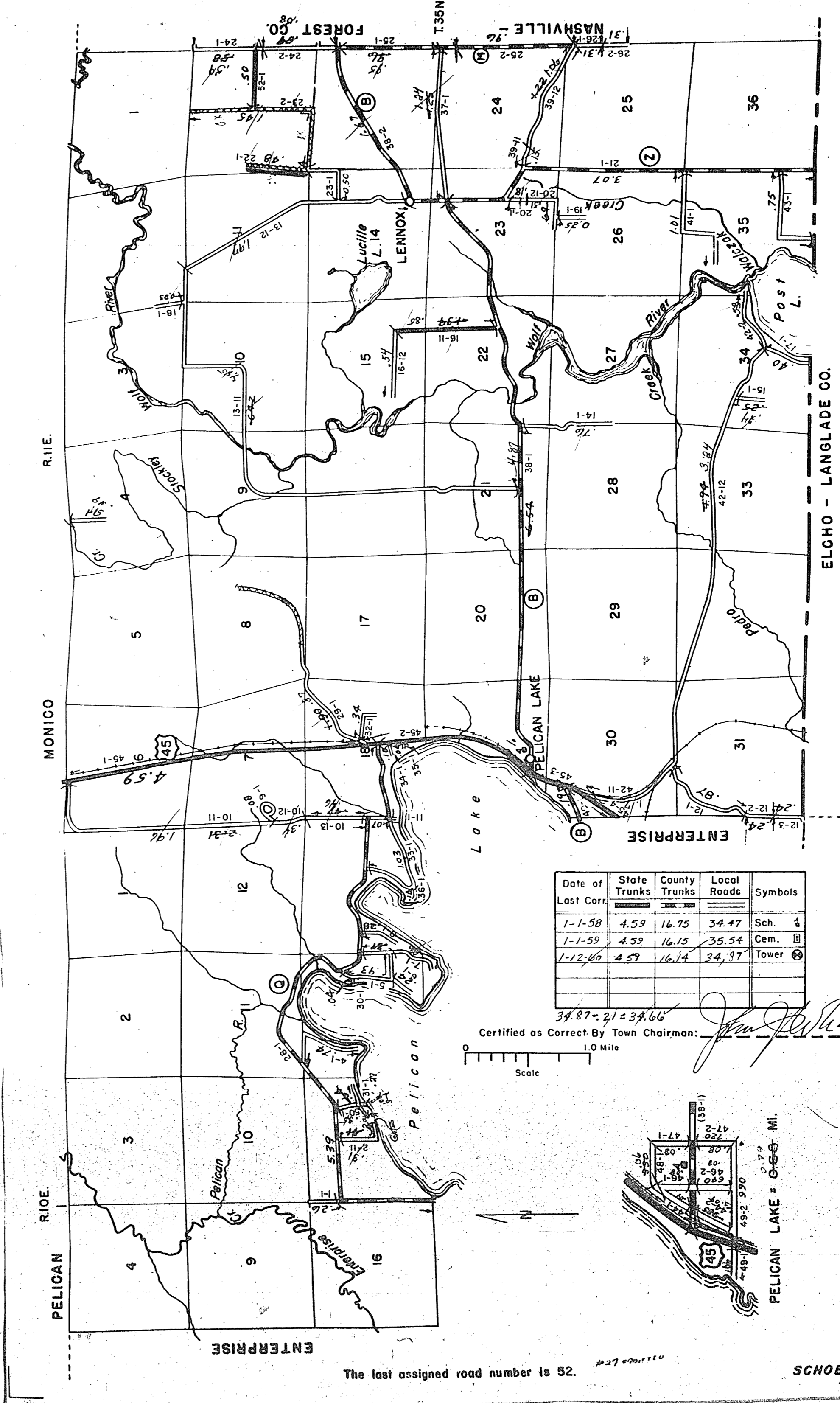
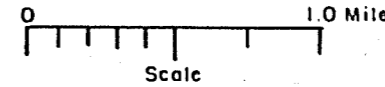

The last assigned road number is 52.

SCHOEPKE

