

STATE HIGHWAY COMM. OF WISCONSIN  
TOWN PLAT RECORD

Town HAZELHURST County ONEIDA (43-004A)

Date of Last Corr.	State Trunks	County Trunks	Local Roads	Symbols
1-1-58	6.41	6.08	37.39	Sch. 4
1-1-59	6.41	6.07	36.31	Cem. II
1-1-60	6.41	6.08	36.52	Tower ②
1-1-61	6.41	6.08	37.25	

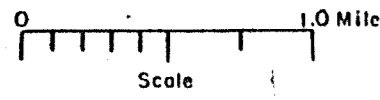

Certified as Correct By Town Chairman: *Peter Michelson*

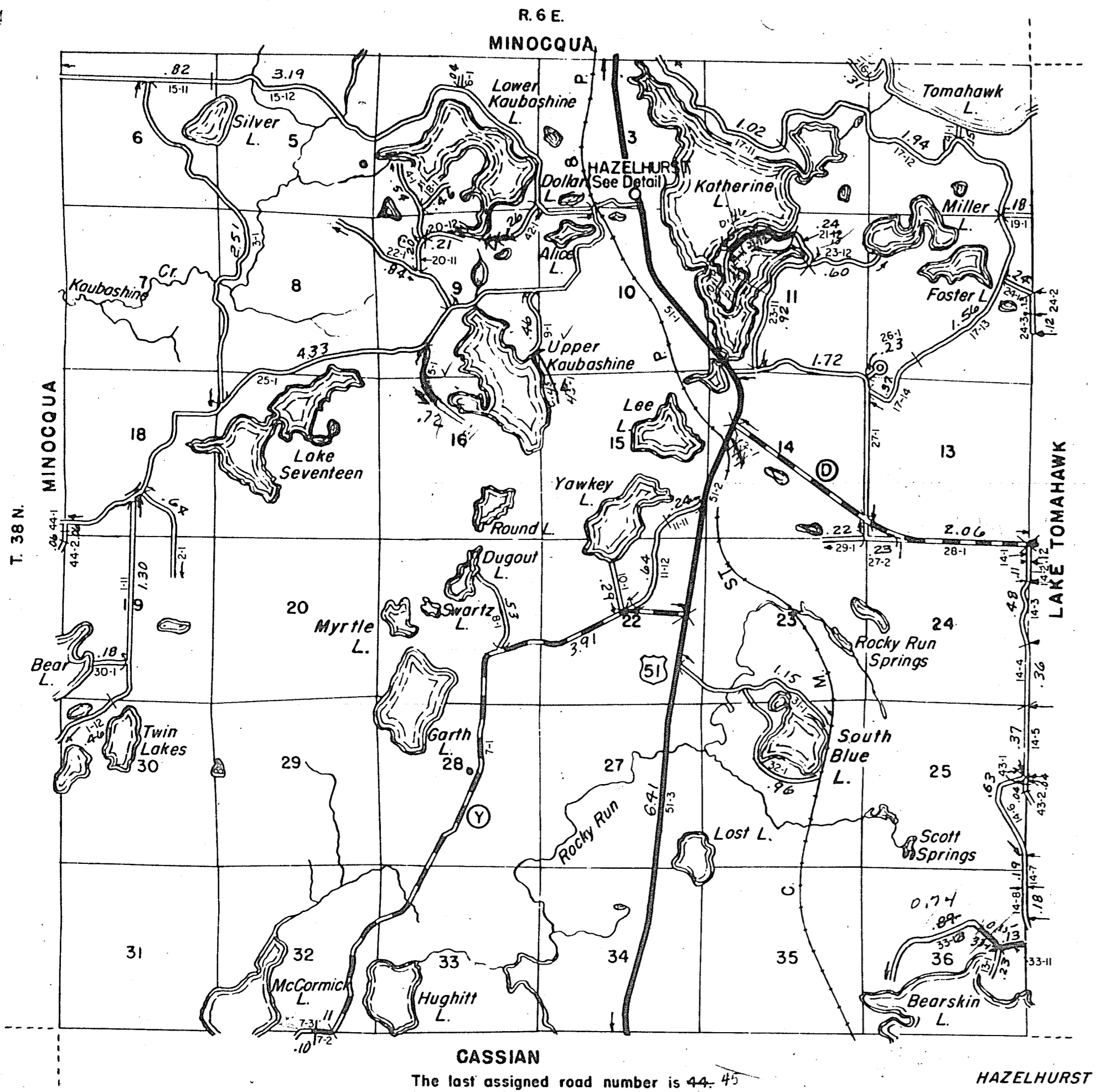

STATE HIGHWAY COMM. OF WISCONSIN  
TOWN PLAT RECORD

HAZELHURST - UNINCORPORATED (43-004B)

Date of Last Corr.	State Trunks	County Trunks	Local Roads	Symbols
1-1-58	0	0	2.09	Sch. 4
1-1-59	0	0	1.97	Cem. II
1-1-60	0	0	1.96	Tower ②
1-1-61	0	0	1.89	

Certified as Correct By Town Chairman: *Peter Michelson*

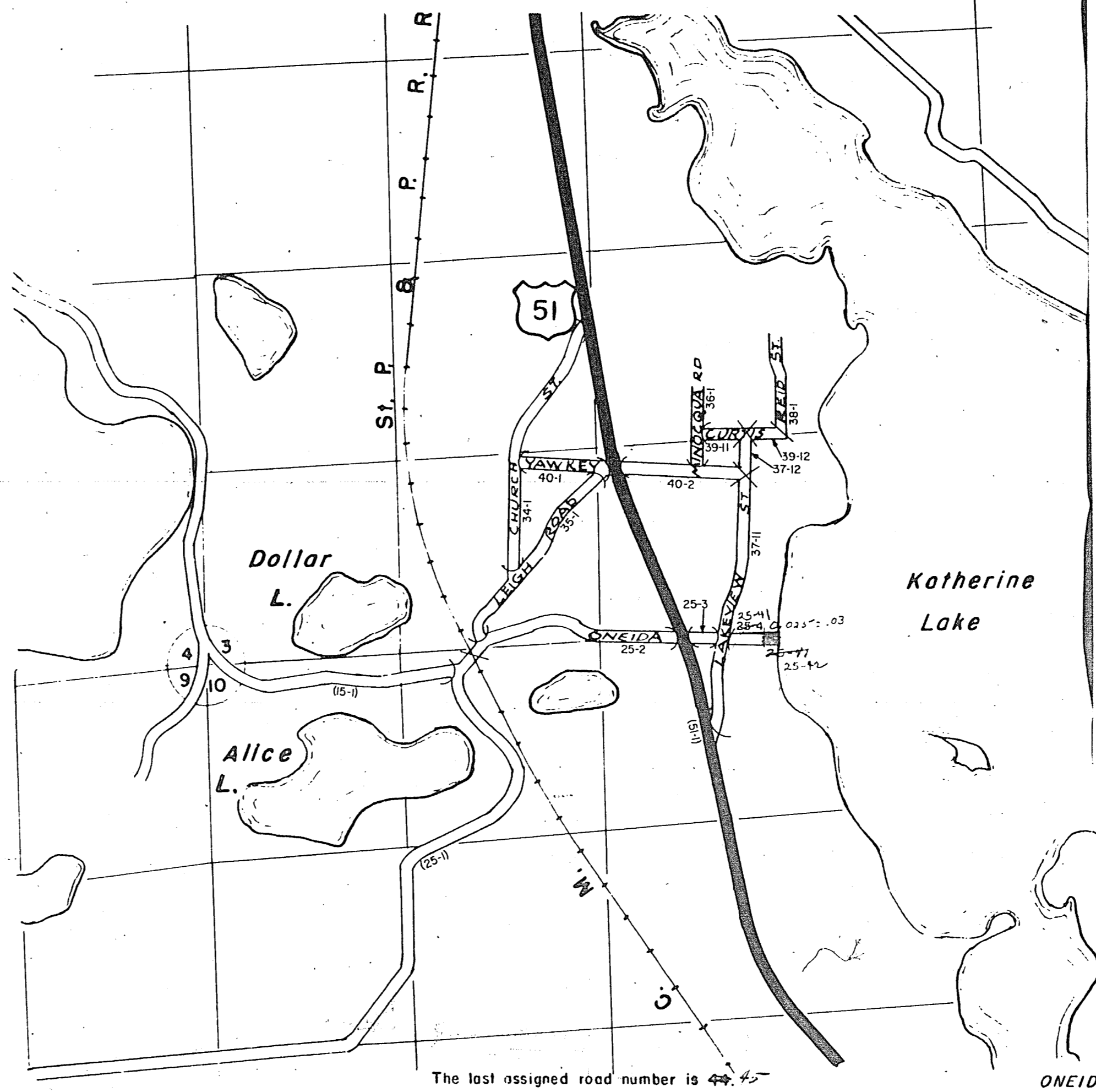

34 35  
3 2

State Highway Commission of Wisconsin  
MURAL PLATTED AREA - LOCAL ROAD STREET LISTS  
Town Hazelhurst Community (43-004B) County Oneida

Road No.	Street Name	Gross Length		Intersections No. Ft. Dist.	Net Length (Feet)	P.A.
		Miles	Feet			
25-2	Oneida	0.28				
25-3	Oneida	0.05				
25-4	Oneida	0.05				
34-1	Church Street	0.36				
* 25-42	Oneida	0.03				
35-1	Leigh Rd.	0.29				
36-1	Minocqua Rd.	0.10				
37-11	Lakewood Street	0.33				
37-12	Lakewood Street	0.05				
38-1	Reid Street	0.06				
39-11	Curtis	0.06				
39-12	Curtis	0.04				
40-1	Yawkey	0.13				
40-2	Yawkey	0.16				
Totals		1.98				

Certified as Correct: *Peter Michelson* Pay Miles