

STATE HIGHWAY COMM. OF WISCONSIN  
TOWN PLAT RECORD

WOODRUFF - UNINCORPORATED (43-020B)

Date of Last Corr.	State Trunks	County Trunks	Local Roads	Symbols
1-1-58	1.48	0	4.66	Sch. 4
1-1-59	1.48	0	4.20	Com. II
1-1-60	1.48	0	5.81	
1-1-61	1.48	0	6.05	
1-1-62	1.48	0	6.05	

Certified as Correct By Town Chairman: *Samuel Clay* 9-14-61

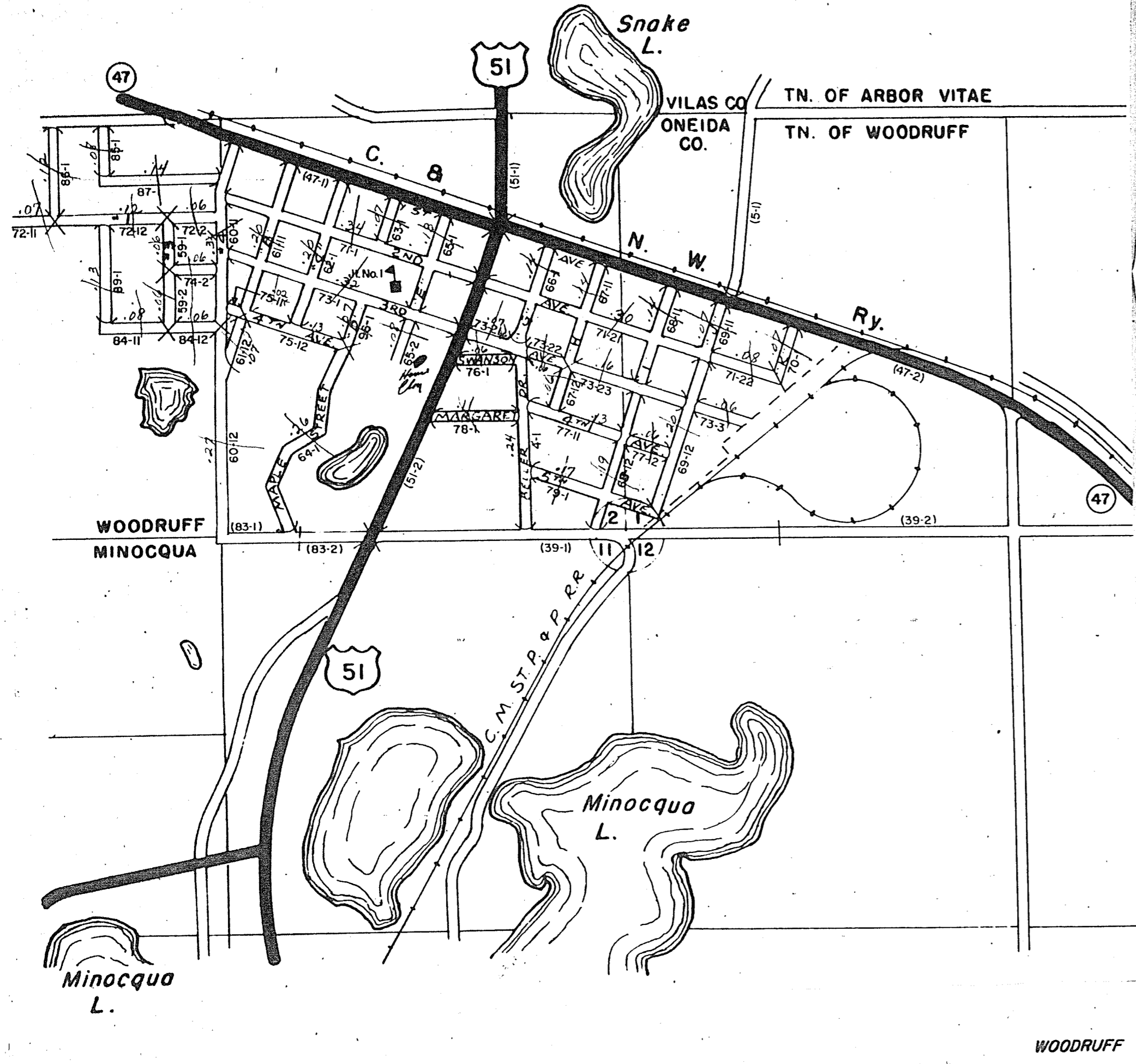

State Highway Commission of Wisconsin  
RURAL PLATTED AREA - LOCAL ROAD STREET LIST

Sheet 1 of 3  
Date: 7-27-60  
Plat No. 20A-20

Town: Woodruff  
Community: Woodruff (43-020B)  
County: Oneida

Road No.	Street Name	Gross Length		Intersections		Net Length (Feet)	C. Miles
		Miles	Feet	No.	Ft. Dist.		
48-1	Beller Drive	0.24					
59-1		0.06					
59-2		0.06					
60-11		0.34					
60-12		0.27					
61-11	"B" Street	0.20					
61-12	"B" Street	0.07					
62-1	"C" Street	0.20					
63-1	"C" Street	0.07					
64-1	Maple Street	0.26					
65-1	"D" Street	0.07					
65-2	"D" Street	0.13					
66-1	"E" Street	0.08					
66-2	"E" Street	0.11					
67-11	"F" Street	0.11					
67-12	"F" Street	0.06					
68-11	"G" Street	0.11					
68-12	"G" Street	0.13					
69-11	"H" Street	0.07					
69-12	"H" Street	0.20					
Totals		2.90					

Certified as Correct: *Samuel Clay* 9-14-61

State Highway Commission of Wisconsin  
RURAL PLATTED AREA - LOCAL ROAD STREET LIST

Sheet 2 of 3  
Date: 7-27-60  
Plat No. 20A-20

Town: Woodruff  
Community: Woodruff (43-020B)  
County: Oneida

Road No.	Street Name	Gross Length		Intersections		Net Length (Feet)	C. Miles
		Miles	Feet	No.	Ft. Dist.		
70-1	"I" Street	0.07					
71-1	2nd Avenue	0.34					
71-21	2nd Avenue	0.30					
71-22	2nd Avenue	0.08					
72-11		0.07					
72-12		0.12					
72-2		0.06					
73-1	3rd Avenue	0.32					
73-21	3rd Avenue	0.07					
73-22	3rd Avenue	0.06					
73-23	3rd Avenue	0.16					
73-3	3rd Avenue	0.06					
74-2		0.06					
75-11	4th Avenue	0.02					
75-12	4th Avenue	0.11					
76-1	Shannon	0.06					
77-11	4th Street	0.13					
77-12	4th Street	0.06					
78-1	Margaret	0.11					
Totals		2.28					

Certified as Correct: *Samuel Clay*

State Highway Commission of Wisconsin  
RURAL PLATTED AREA - LOCAL ROAD STREET LIST

Sheet 3 of 3  
Date: 7-27-60  
Plat No. 20A-20

Town: Woodruff  
Community: Woodruff (43-020B)  
County: Oneida

Road No.	Street Name	Gross Length		Intersections		Net Length (Feet)	C. Miles
		Miles	Feet	No.	Ft. Dist.		
79-1	5th Avenue	0.17					
80-11		0.08					
80-12		0.06					
85-1		0.08					
86-1		0.12					
87-1		0.11					
89-1		0.13					
Totals		0.78					
Totals		6.05		37			

Certified as Correct: *Samuel Clay* 9-14-61