

STATE HIGHWAY COMM. OF WISCONSIN
TOWN PLAT RECORD

Town - PINE LAKE County - ONEIDA (43-014)

Date of Last Corr.	State Trunks	County Trunks	Local Roads	Symbols
1-1-58	6.51	6.44	56.15	Sch. 4
1-1-59	6.51	6.48	53.68	Cem. II
1-1-60	6.38	6.48	53.44	
1-1-61	6.38	5.68	55.12	
1-1-62	6.33	5.68	55.08	
1-1-63	6.51	5.76	55.83	

W. H. C. COPY

Gross Mileage: 55.08
 Deduction for Intersections: 0.40
 Net Pay Mileage: 54.68

Gross Mileage: 55.83
 Deduction for Intersections: 0.41
 Net Pay Mileage: 55.42

Certified as Correct By Town Chairman: *Donald Steadman*

T. 37 N.
STELLA

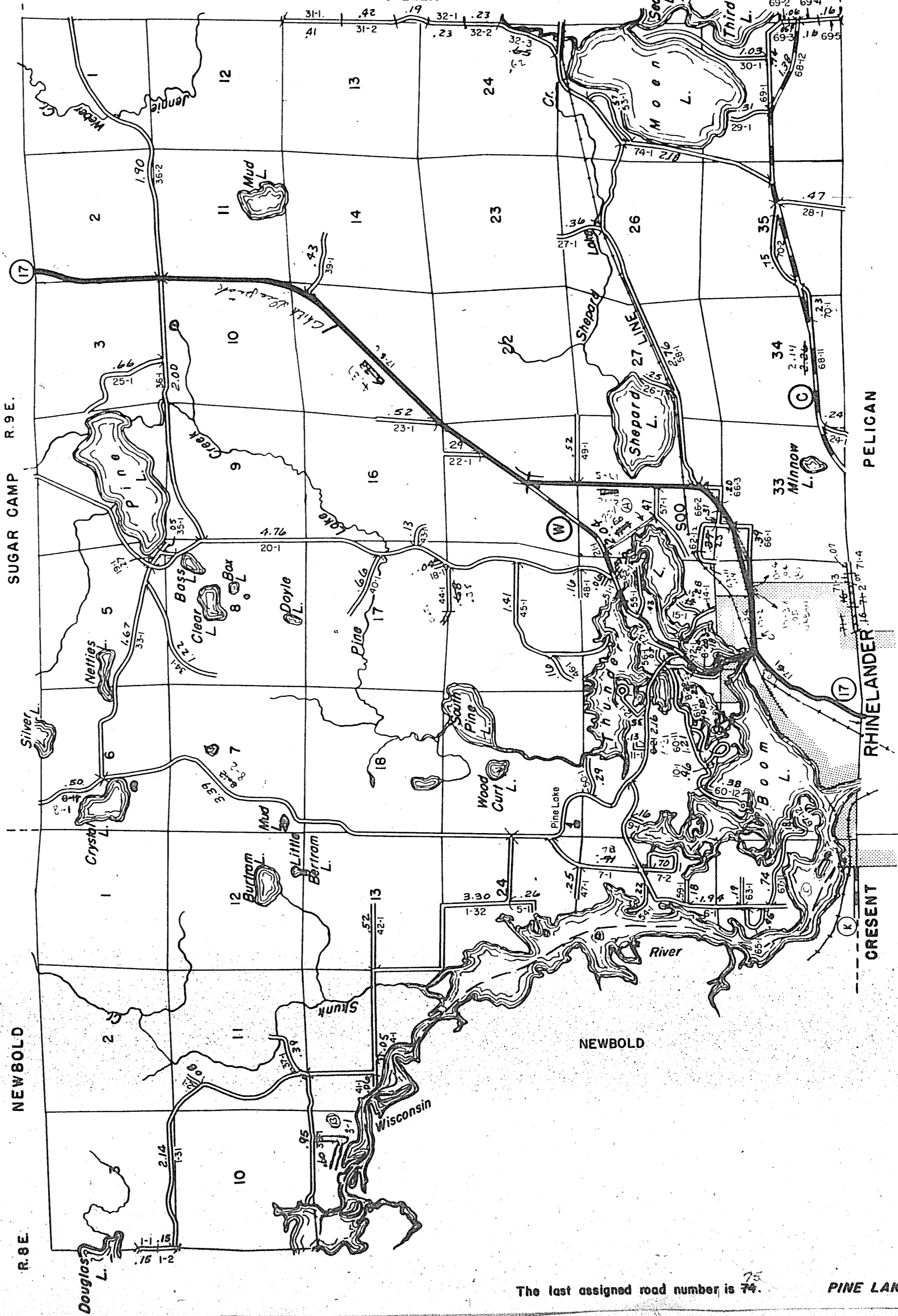

The last assigned road number is 74. PINE LAKE

STATE HIGHWAY COMM. OF WISCONSIN
TOWN PLAT RECORD

Town - PIEHL County - ONEIDA (43-013)

Date of Last Corr.	State Trunks	County Trunks	Local Roads	Symbols
1-1-59	6.55	2.85	13.01	Sch. 4
1-1-59	6.55	2.79	11.54	Cem. II
1-1-60	6.55	2.79	11.55	
1-1-61	6.55	2.79	11.55	
1-1-62	6.55	2.79	11.55	
1-1-63	6.60	2.79	11.61	

Gross Mileage: 11.55
 Deduction for Intersections: 0.08
 Net Pay Mileage: 11.47

Gross Mileage: 11.61
 Deduction for Intersections: 0.08
 Net Pay Mileage: 11.53

Certified as Correct By Town Chairman: *John P. Harkins*

R. 11 E.
THREE LAKES

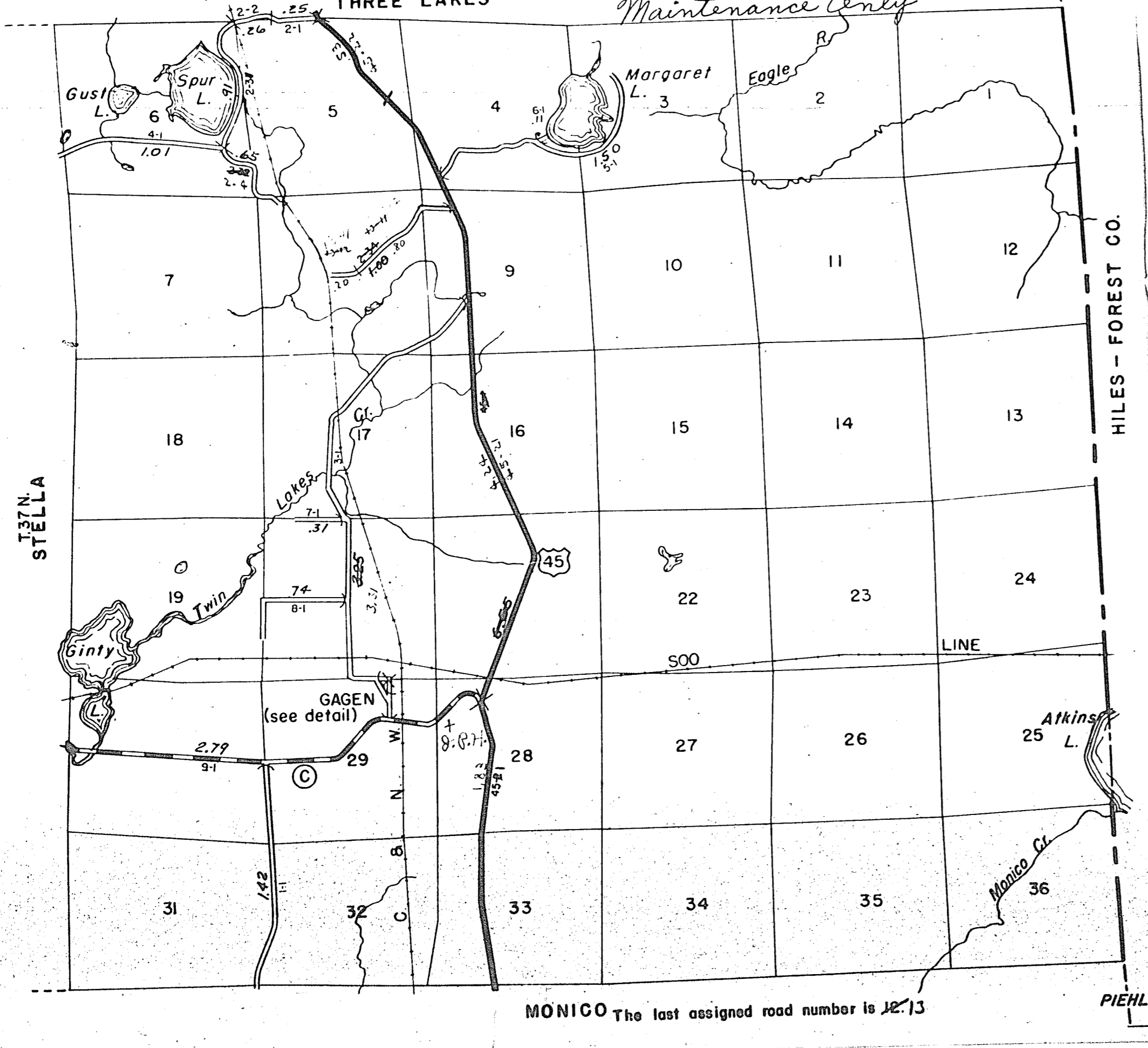

MONICO The last assigned road number is 1213