

STATE HIGHWAY COMM. OF WISCONSIN
TOWN PLAT RECORD
Town - MINOCQUA R.6E. County - ONEIDA (43-008A)
WOODRUFF

FLAMBEAU - VILAS CO.

R.4E.

70

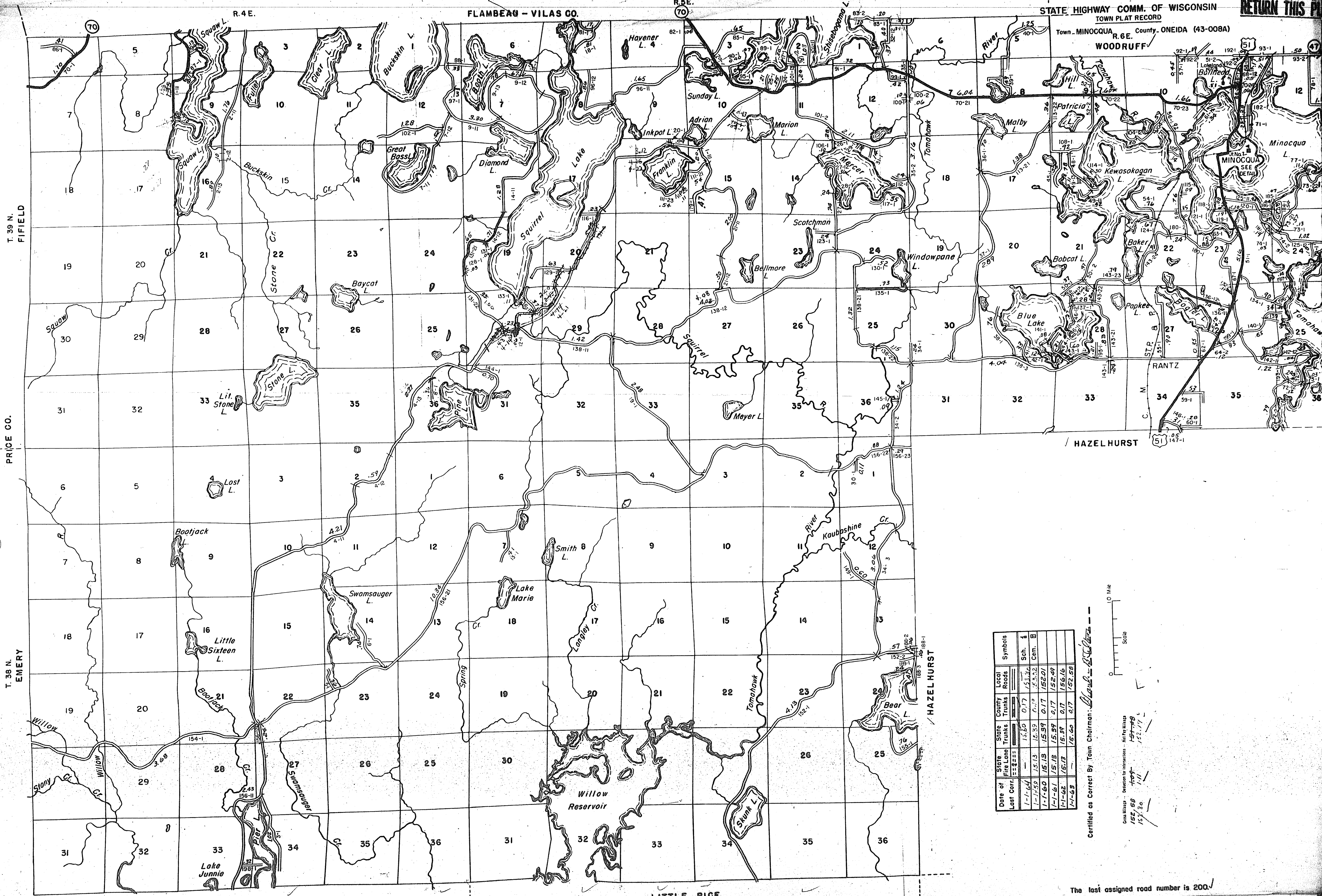

Date of Last Cont.	State Fire Lane	State Trunks	County Trunks	Local Roads	Symbols
1-1-64	15.60	0.17	15.43	Sch. 4	
1-1-59	15.13	12.39	0.17	15.43	Com. 8
1-1-60	15.13	15.37	0.17	15.20	
1-1-61	15.13	15.37	0.17	15.24	
1-1-62	15.13	15.37	0.17	15.66	
1-1-63	15.13	15.60	0.17	15.25	

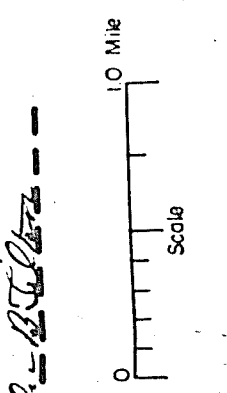

Certified as Correct By Town Chairman: *[Signature]*

The last assigned road number is 200.