

STATE HIGHWAY COMM. OF WISCONSIN
TOWN PLAT RECORD

RETURN THIS PLAT

Town - PINE LAKE		County - ONEIDA (43-014)		
Date of Last Corr.	State Trunks	County Trunks	Local Roads	Symbols
1-1-44	6.24	5.56	56.40	Sch. 4
1-1-65	4.24	5.36	56.40	Cem. 11
1-1-60	6.38	6.48	59.44	
1-1-61	6.38	5.68	55.12	
1-1-62	6.33	5.68	55.08	
1-1-65	6.51	5.56	55.83	

Gross Mileage - Deduction for Intersections - Net Pay Mileage
 56.40 0.41 55.99

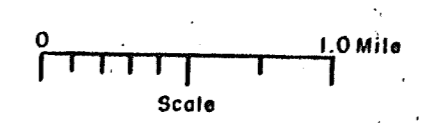

Certified as Correct By Town Chairman: *Leah J. Miller*
 T. 37 N.
 STELLA

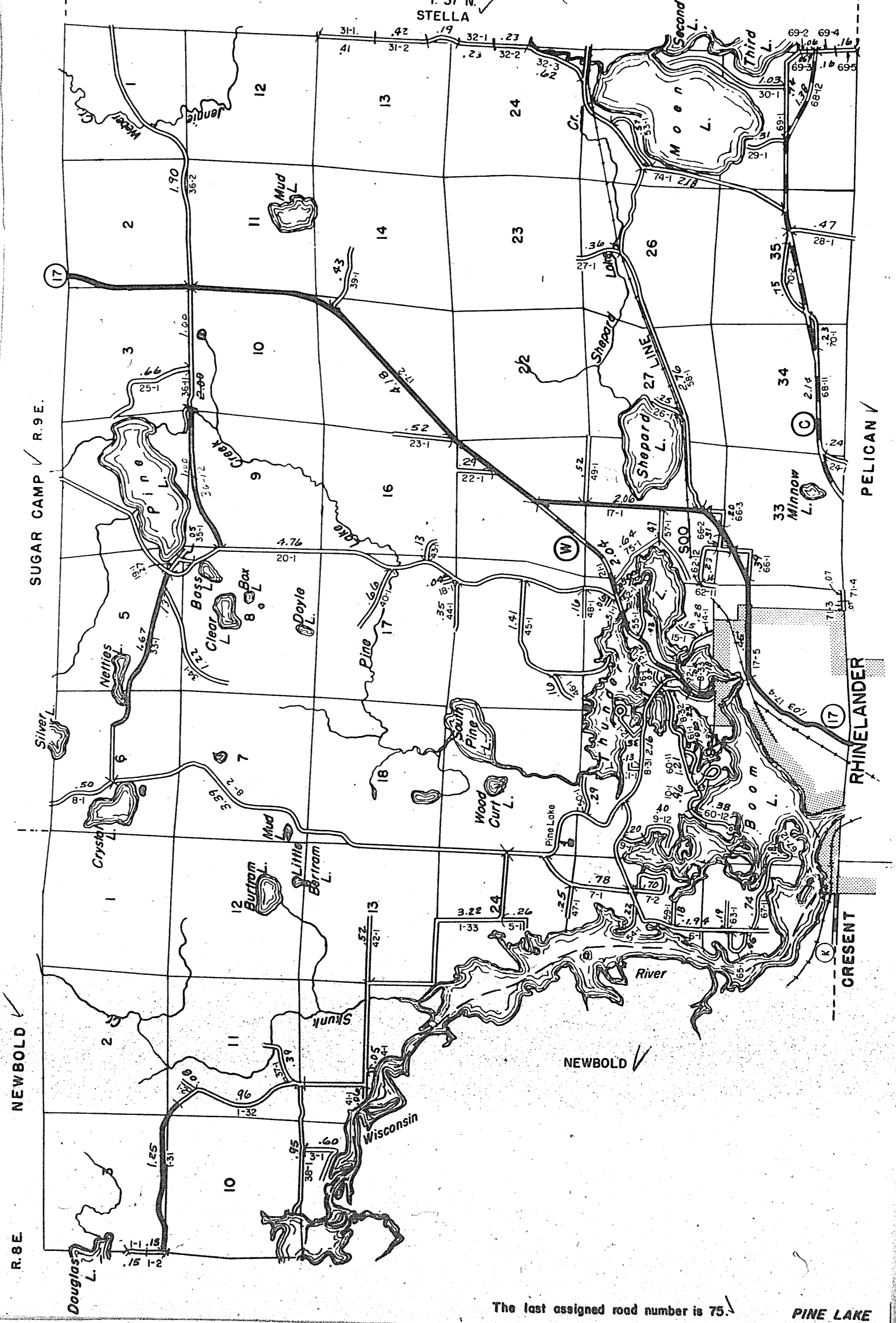

The last assigned road number is 75.

PINE LAKE

STATE HIGHWAY COMM. OF WISCONSIN
TOWN PLAT RECORD

RETURN THIS PLAT

Town - PIEHL		County - ONEIDA (43-013)		
Date of Last Corr.	State Trunks	County Trunks	Local Roads	Symbols
1-1-64	6.60	2.79	11.61	Sch. 4
1-1-65	6.60	2.79	11.61	Cem. 11
1-1-60	6.55	2.79	11.55	
1-1-61	6.55	2.79	11.55	
1-1-62	6.55	2.79	11.55	
1-1-62	6.60	2.79	11.61	

Gross Mileage - Deduction for Intersections - Net Pay Mileage
 11.61 0.08 11.53

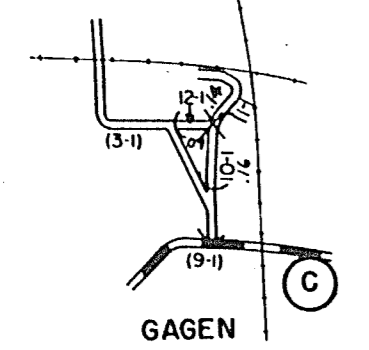

Certified as Correct By Town Chairman: *John P. Harkins*

THREE LAKES R.I.E.

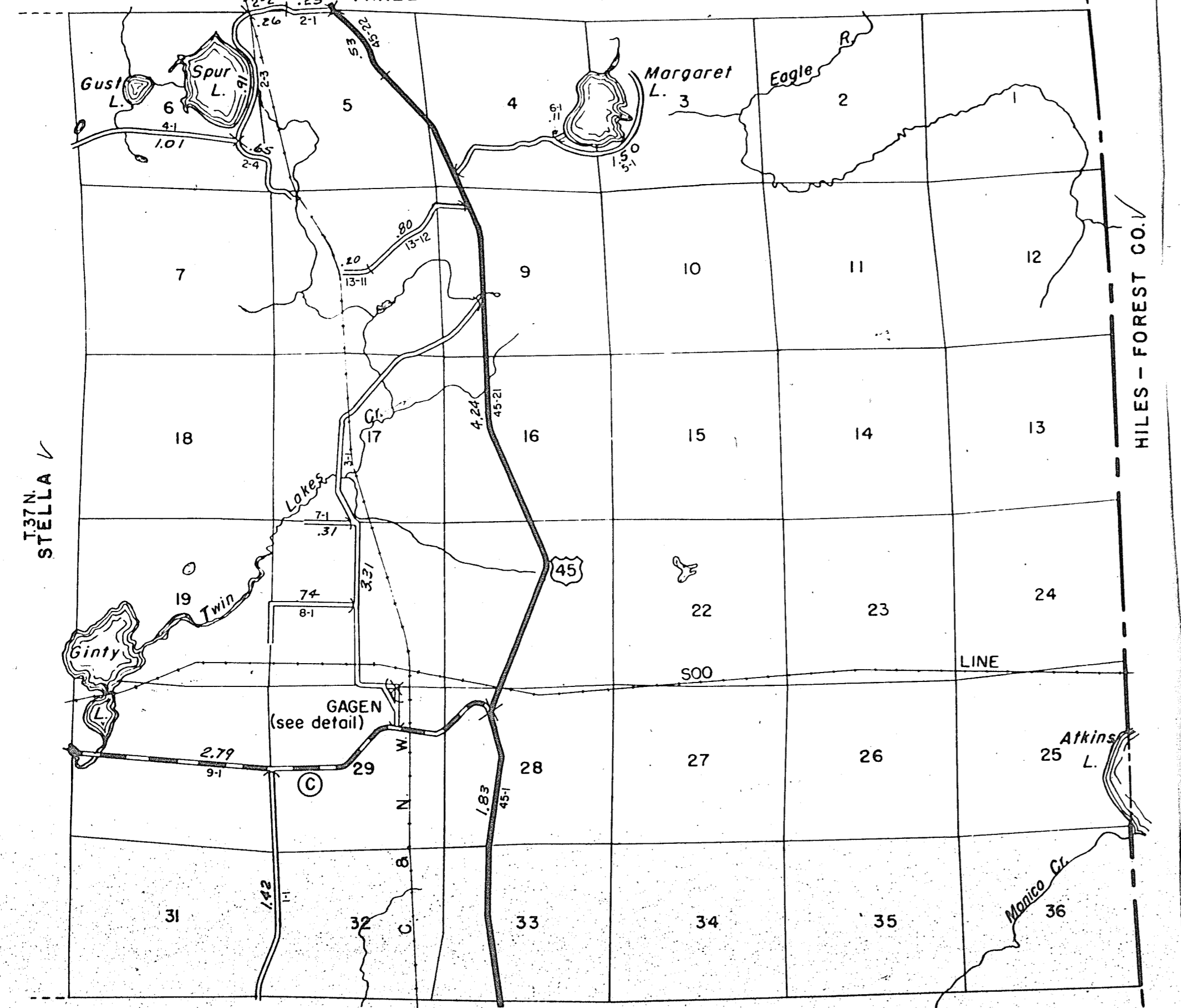

MONICO The last assigned road number is 13.