

RETURN THIS PLAT

STATE HIGHWAY COMM. OF WISCONSIN  
TOWN PLAT RECORD

Town - LAKE TOMAHAWK County - ONEIDA (43-005A)

Date of Last Corr.	State Fire Lane	State Trunks	County Trunks	Local Roads	Symbols	State Park Roads
1-1-64		7.47	7.41	50.27	Sch. 4	.53
1-1-65		7.47	7.41	50.27	Cem. 8	.53
1-1-66		7.47	7.41	51.24		.53
1-1-67		7.47	7.41	51.74		.53
1-1-62	3.76	7.29	7.39	48.97		.53
1-1-63		7.47	7.41	48.77		.53

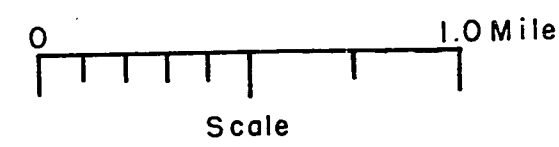

Gross Mileage -- Deduction for Intersections -- Net Pay Mileage  
 51.24      .54      50.70  
 51.74      .55      51.19

Certified as Correct By Town Chairman: *Kenneth J. Plone*  
 7/1/66

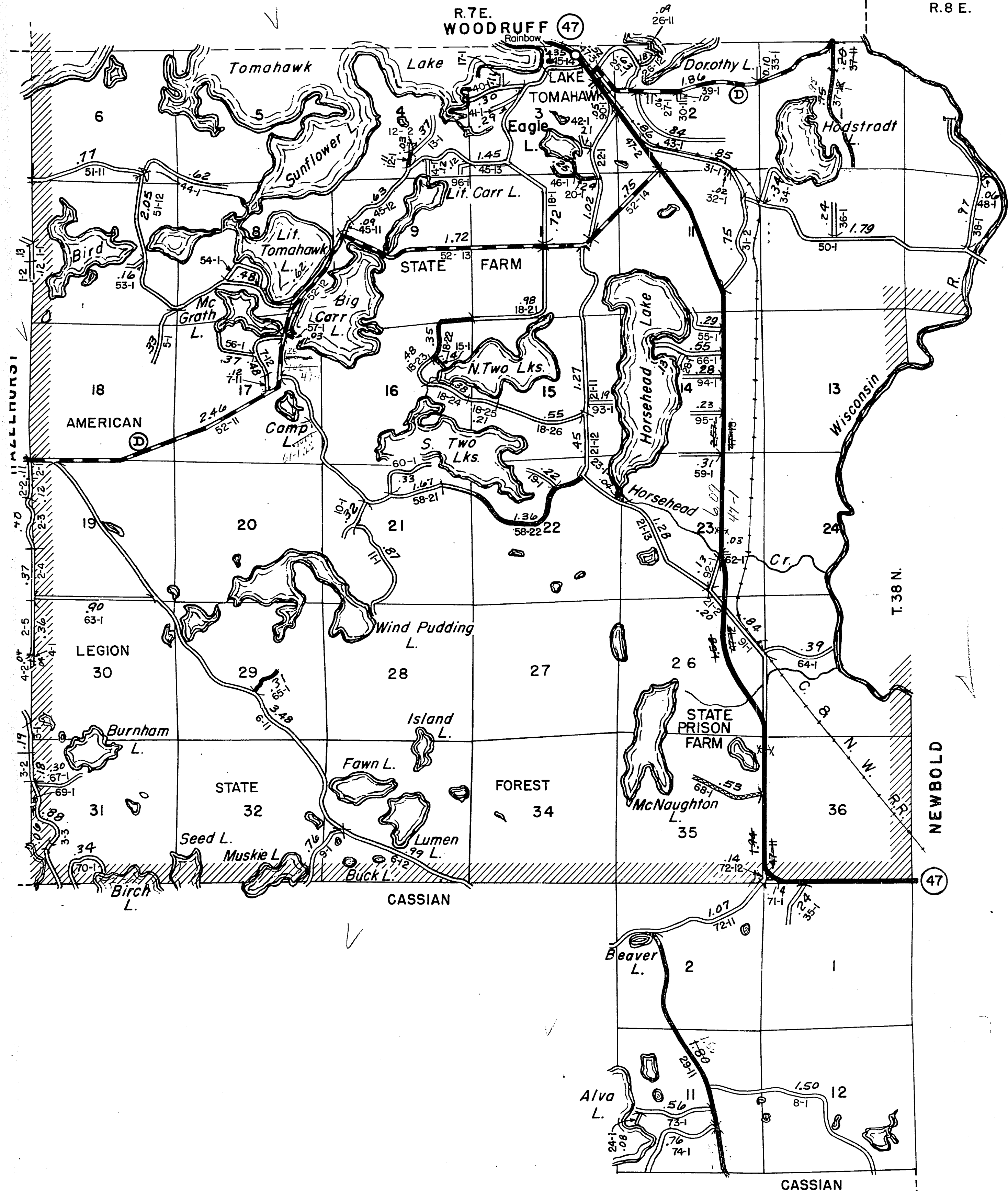

The last assigned road number is ~~100~~ 105 LAKE TOMAHAWK