

RETURN THIS PLAT

STATE HIGHWAY COMM. OF WISCONSIN  
TOWN PLAT RECORD

Town-STELLA County-ONEIDA (43-016)

Date of Last Corr.	State Fire Lane	State Trunks	County Trunks	Local Roads	Symbols
1-1-64			6.49	38.17	Sch. 1
1-1-65			6.49	38.17	Cem. 1
1-1-66			6.49	38.17	
1-1-67			6.49	38.17	
1-1-62	0.29		6.49	38.14	
1-1-63			6.49	38.17	

Gross Mileage .. Deduction for Intersections .. Net Pay Mileage  
38.17      0.16      38.01

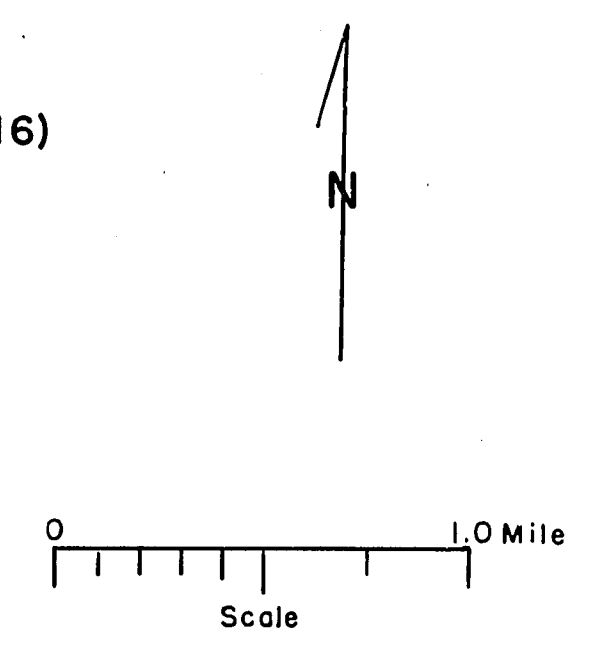

Certified as Correct By Town Chairman: *Bert Spafford*

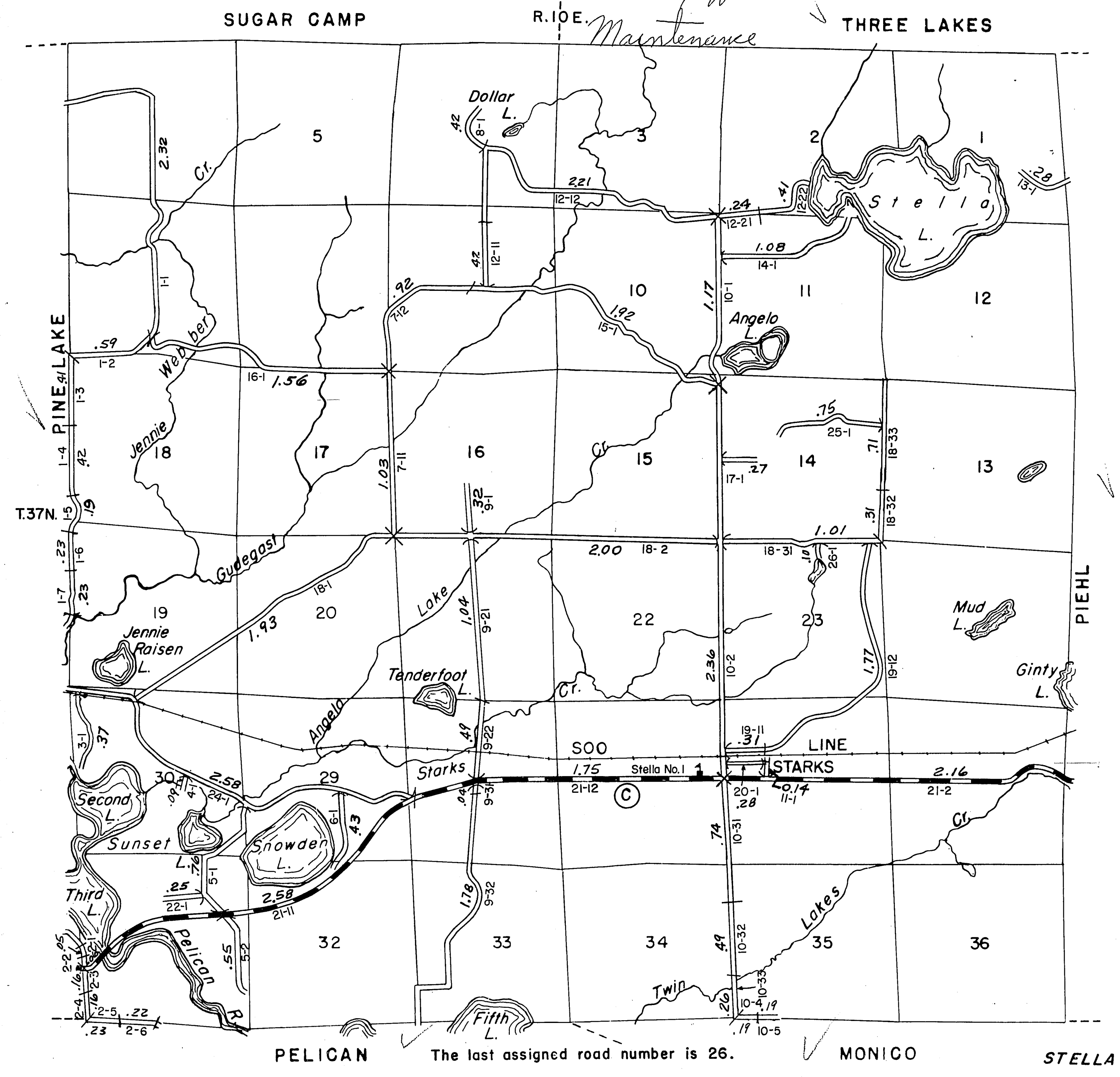

The last assigned road number is 26.