

Legend

Road Class	Section Lines
County	Section
County Forest	Township
Federal	WaterBody
Municipal	Railroads
Private	Municipal Boundary
State	
State Forest	
Town	

Scale: 1"=1000'

Uniform Rural Address System

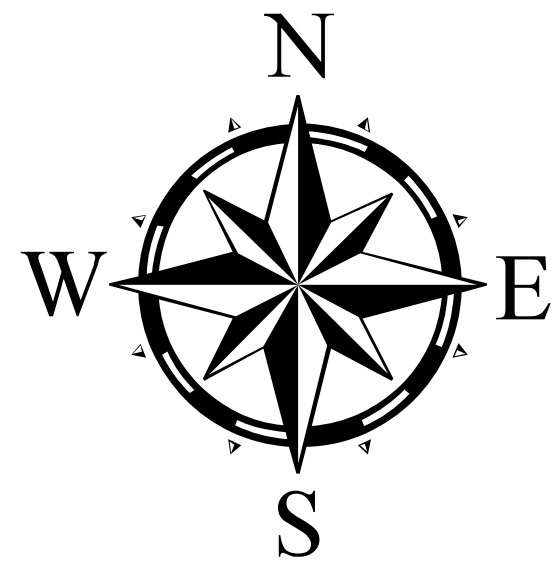

SOUTHEAST PART THREE LAKES

T38N, R11E

Data Sources and Disclaimers:

Information depicted on this map was interpreted from aerial photography and various other public land records. An attempt was made to accurately represent the information shown hereon, however, recent changes in the physical and cultural landscape may not be represented. Planimetric information shown hereon was generated from 1:20,000 scale photography taken in 1989 to meet National Map Accuracy Standards of 1"=400'. It is recommended that features and measurements be field verified. The addresses shown on this map are approximate and may not represent all current address numbers being used.

This map is intended for planning and general use only, please refer to the original source documents for detailed information. Please contact the Oneida County Land Information Office at 715-369-6179 if you discover any discrepancies on this map.

Index Map										
1	2	5	6	10	11	13	15			
3	4	7	8	9	12	14	16			
17	19	21	22	25	26	27	28			
18	20	23	24	29	30	31	32			
							33	34	35	

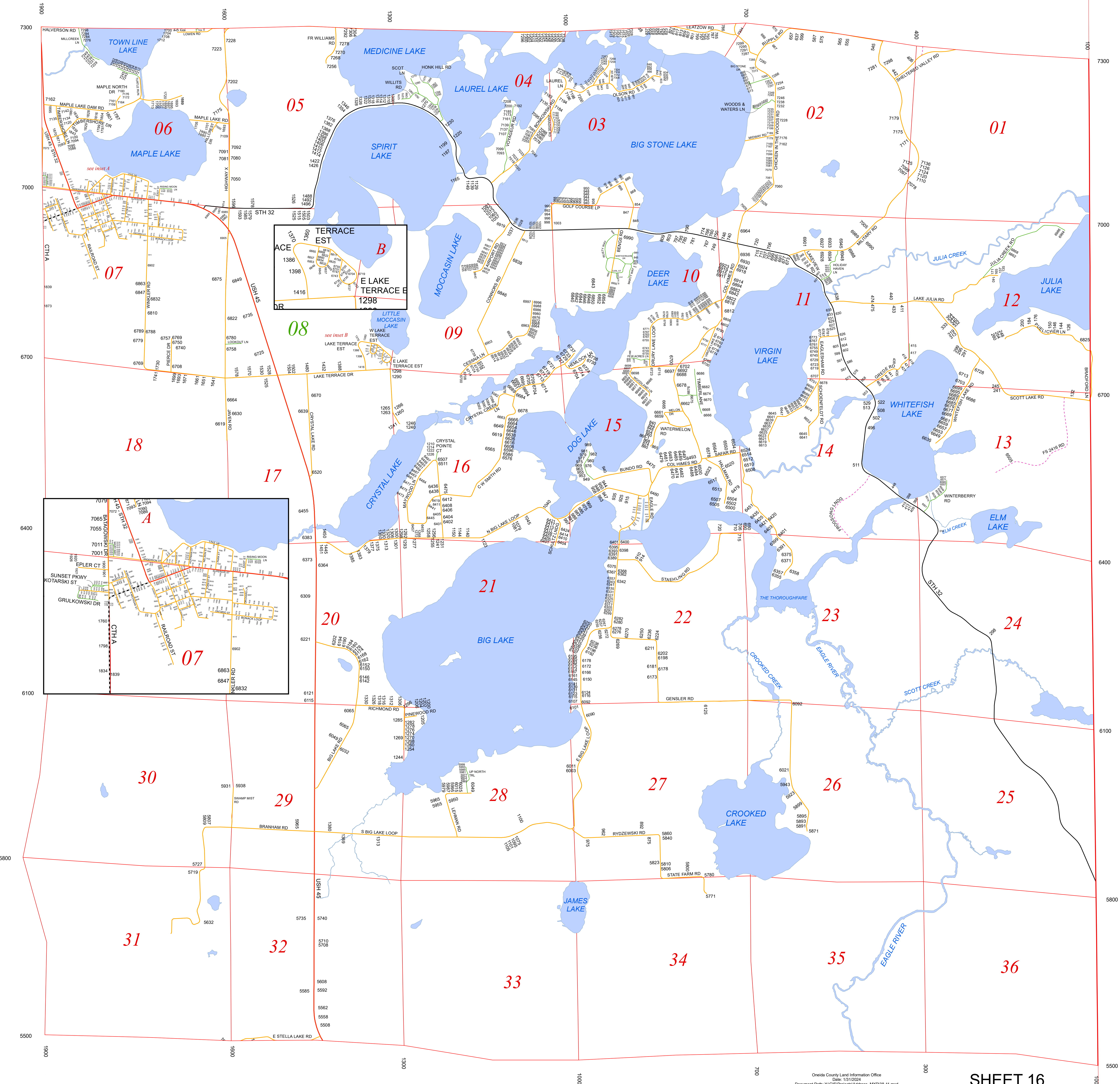

Inset A

TERRACE EST
ACE DR
1370
1386
1398
1416

Inset B

E LAKE TERRACE EST
1298

see inset A

see inset B

Inset C

SUNSET PKWY
KOTARSKI ST
GRULKOWSKI DR
RAILROAD ST
CTHA

7079
7066
7055
7011
7000
1760
1798
1834