

12  
D.H. VAUGHAN # 12 (DORR)

2  
FIELD BOOK

506

I THINK THIS IS Dorr's  
BOOK 4 AND COPIED IN  
THIS BOOK BY VAN GHAN.

M. Rompelt

Sec. 28  
P. 48

at 27  
Star Bank

amount on river  
Raffin

2000  
3805  
7900  
7900

7900  
275  
275

19.07  
23812 1/2

7625

2.75

7900

18

3610

290

3900

275

4100  
275

2/12

The Park 12572 E 31 1/2

amount 10-11-1915

9

10

11

Page Page Page

1 to 22 74

39

Page Page Page

1 to 22 75 to 84

38

Page Page Page

23 to 49 85 to 93

37

Page Page Page

50 to 67 94 to 99

36

Page Page Page

68 to 73 100 to

35

and sec 7 38-9 and sec 22-9  
 SEC 3, 38-9 Oct 14-1891  
 N 1/4 P S (5) <sup>6.05'</sup> 8483 <sup>4570' C420'</sup> W 909 U 3.35'

" " " W (5 1/2) 4082 U ar S 44 U 4 1/2  
 W 1/8 N Line Pine 12 S 27 1/4 W 14

W 1/4 P E (6) 3908 to E + W 1/4 Line U 5 3/4

1/8 bet W 1/4 N (1 1/4) 4597 U ar E 51 U 10 25'

W 1/4 P S <sup>+23'</sup> 3954 U ar W 183 U 6 16

no field for SW cor

= SEC 7 38-9 - Jan 20-1894

E 1/4 P W (5) 8803 U ar S 841

" " " N (5) 4004 U ar E 73 U 4 1/2

N 1/4 P S (5) <sup>3691'</sup> 8076 U ar E 84 U 4 05'

Cent of SEC Cedar 12 N 62 1/2 W 11 1/2

LBirch 12 N 59 E 19

1/8 bet N 1/4 marked stake in open Swamp

" " " E (1 1/2) 4014 U ar S 15 1/2 U 3 1/4

1/8 bet E 1/4 Birch 10 S 75 E 18 1/2

Can N E 1/4 S (5) 1930 U ar E 6

SEC 22-38-9 - - - - -

NE cor <sup>+1.04'</sup> (3/4) 3900 U ar W 72 1/2



SEC 8-38-9 Feb 14 1893

S 1/4 P N (4 1/2) <sup>+ 1/2</sup> 3981 <sup>C 4150'</sup> 7971 Van E 68 U 4 1/2E 1/4 P W (5 1/4) <sup>4060 C 5 1/4</sup> 8116 Van S 12 U 4 3/4

Cen SEC Pine 20 S 21 W 25 3/4

Hem 9 N 16 W 16

1/8 bet S 1/4 Cedar 12 N 88 1/2 W 8 1/2

" " E (5 1/4) 2044 Van N 2 U 4 1/4

1/8 bet E 1/4 Tam 11 N 3 E 17 3/4

" " " " N (4 1/4) 3968 Van W 42 1/2 U 4 1/2

N 1/4 P E (4 1/2) 4120 Van N 15 1/2 U 4

E 1/8 on N Line Hem 20 S 40 3/4 W 29

1/8 bet E 1/4 S (4 1/2) 3968 Van W 33 1/2 U 4 2/2

E 1/8 S Line Tam 5 N 59 1/2 E 14

W 1/8 <sup>S</sup> N (4 1/2) 3970 Van W 23 U 2 1/4

1/8 bet W 1/4 Hem 8 N 16 1/2 W 12 1/2

1/8 " S 1/4 W (5) 2050 Van S 8

= Jan 26 1894 =

1/8 bet E 1/4 N 3 3/5 3975 Van E 27 U 3

Cen NE 1/4 W (5 1/4) <sup>1,15'</sup> 2046 Van S 44 1/2SEC or W (5) <sup>+ 23'</sup> 4124 Van N 28 U 4 5/2S 1/4 P. W (5 1/4) <sup>47'</sup> 4147 Van S 56 1/2 U 5 2/3SEC or S (5) 150 <sup>(5,00)</sup> ch then E <sup>(5,0,5)</sup> 1282 Van S 36 U 5 1/2" " S (5) 149.64 Van W 1282 <sup>5,10'</sup> to 2046 <sup>19,120</sup> 2970

" " " (5) 7510 Van W 330 U 5 1/4

SEC or N (5) 3968 Van E 500 U 4 1/4

S 1/8 E Line Tam 10 East 2 1/2

SEC 9-38-9 Dec 6-1892

S 1/4 P N (5) <sup>- 1' 4055 R 4,40'</sup> 7960 Van W 137 1/2 U 4,50N 1/4 P W (4 1/2) <sup>+ 1,47'</sup> 4189 Van N 132 U 4 1/2W 1/4 P E (5 1/2) <sup>+ 2,0'</sup> 8567 Van S 200 U 5 5/2E 1/4 P S (5) <sup>+ 1'</sup> 3846 Van W 75 U 4 1/4

1/8 bet S 1/4 Tam 7 N 87 E 14 1/2

Cen SEC Pine 13 N 78 W 16 1/2

Hem 10 N 4 E 12 3/4

1/8 bet S 1/4 E (8 1/2) 4460 Van N 2 1/2 U 8 0 3/5

S 1/8 E Line Birch 11 N 24 1/4 E 35

1/8 bet W 1/4 Tam 6 S 48 23 1/2

" " N (3 1/4) 3918 Van Van E 18 U 3 3/4

W 1/8 N Line Birch 13 N 29 1/4 W 10

Cen NW 1/4 E (6 3/4) 2096 Van N 2 U 6,55

1/8 bet N 1/4 Pine sep 15 N 35 E 1 1/2

Cen SEC E (6 5/5) 4380 Van N 4 U 7 1/4

S 1/4 P W (6) 4061 Van S 1 1/2 U 5 3 5/5

W 1/8 S Line cedar 7 N 29 1/2 E 17 1/2

" " " N (5) 4017 Van E 1 1/2 U 4 1/2

Cen NW 1/4 cedar 10 N 63 1/2 W 13

" " " W (6,40) 2100 U 6 3/4



## SECS 10 and 12

S 1/4 P N (5 1/4) <sup>+1.52'</sup> 7550 <sup>3817</sup> Var E 24 5 1/2 U 4 3/4  
 " " " E (6 1/4) <sup>1.21'</sup> 4110 Var N 14 U 6 3/4  
 SE COR N (7) <sup>+6'</sup> 7618 Var E 13 U 6 1/2  
 E 1/4 P Hem 10 N 74 1/2 E 21  
 " " " 8 S 50 W 4 1/2  
 " " W (6 1/2) <sup>-22</sup> 880 to Lake  
 " " W (6 1/2) <sup>-32'</sup> 8152 <sup>4099</sup> Var S 51 U 7  
 W 1/4 P SEC 10 E (6 1/2) <sup>+2.24'</sup> 8058 <sup>3904</sup> Var S 33 8 U 6  
 S " " " N (7) <sup>5150 to Lake 10750 to Lake</sup> 7738 Var E 2 U 7 20  
 Cen sec 11 Spruce 3 S 69 1/2 W 24  
 " " " 3 S 9 1/2 W 19 1/2  
 S 1/8. E Line sec 10 Birch 20 S 40 W 73/4  
 Cent sec 10 Pine 30 N 22 1/2 E 13 1/2  
 " " " 10 Hem 8 N 68 1/2 W 21 1/4  
 1/8 bet E 1/4 Birch 12 S 7 1/2 W 9  
 " " " 10 S 800 to Lake 3813 Var E 6 U 7  
 E 1/8. S Line sec 10 Tam 12 S 3 W 15 1/2  
 1/8 bet S 1/4 10 Birch 16 N 9 1/2 W 21 1/2  
 " " " E (5 1/2) <sup>+1 1/2</sup> 4107 Var S 34 U 5 1/2  
 Cent sec 1/4 10 Birch 15 S 19 W 14  
 N 1/8 W line 11 Cedar 10 N 60 W 12  
 " " WE (10) 3030 to worthless Swamp  
 SE COR 8 N (5) 3968 Var E 50 U 4 1/4  
 S 1/8. E line 8 Tam 10 East 2 1/2  
 SE COR 12 38-9 W <sup>-2.11"</sup> 5 1/2 4075 Var N 24 1/2 U 43/4

## SEC 15-389- DEC 12-1892

NW COR S (5 1/2) 3810 Var W 18 U 5 3/5  
 W 1/4 PE <sup>+1/4</sup> 4352 <sup>R 5"</sup> 8266 Var S 36 U 5 10  
 N 1/4 PS (5 1/2) <sup>3 1/2</sup> 7650 <sup>890 1535</sup> - 37 Var W 470 U  
 Cen sec Tam 13 N 84 1/4 W 18 11 1/2 W 5 1/2  
 " " " 12 N 84 1/4 W 18  
 1/8 bet N 1/4 Birch 11 N 26 W 11 1/2  
 " " " W (5) 4247 Var N 29  
 N 1/8 W Line Hem 18 S 86 W 27  
 = Jan 16 1894 =  
 S 1/4 P W (5) <sup>-2.10'</sup> 4430 Var N 168 U 4 40'  
 " " " N (7 1/4) 3744 Var E 63 U 7.25  
 Cent sec N (8 20) 1950 Var W 1 1/2 U 8 1/4  
 S 1/4 PE (5) <sup>-1 1/2</sup> 3800 Var 101 U 4 20  
 E 1/8. S line Bash 6 S 10 E 5 3/4 U  
 1/8 bet E 1/4 S (7 1/2) 3794 Var W 41 U 7 1/2  
 SW COR N (6 3/4) 3854 Var W 72 U 6 1/2  
 S 1/8 W Line Fir 12 N 6 1/2 E 11 1/4  
 " " " E (6) 4382 Var N 12 1/2 U 6  
 1/8 bet S 1/4 Tam 14 N 83 1/2 W 23  
 1/8 bet E 1/4 Hem 8 S 24 1/2 E 29  
 Cen sec 1/4 W (5 1/2) 1939 Var E 35

and 8-19-30

SEC 17-38-9 DEC 22-1892

E 1/4 30 W (7) <sup>-42</sup> 9698 <sup>4390</sup> var S 118 <sup>70</sup> U 8.5

NE COR N (5) <sup>30 + 8 1/2</sup> 7370 var E 112 U 5 1/2

SE COR 8 W (5) <sup>+23'</sup> 4124 var N 28 U 4.50

S 1/4 P 8 W <sup>-47'</sup> 5 1/4 4147 var S 56 1/2 U 5 23'

NW 17 S (5) <sup>center</sup> 4010 var W 84 U 5 35'

W 1/4 P 17 S (6 1/2) 3730 var E 65 U 6'

W 1/8 S Line 8 Sugar 10 S 19 W 16 1/4

S 1/4 P 19 N 8000 + left it

NW COR 19 E (6) <sup>57'</sup> 5800 var N 428 U 5 0.5

W 1/4 P 17 E (5) <sup>+2 1/2</sup> <sup>4183</sup> <sup>4035</sup> 8354 var S 360 U 4.20

SEC COR 8 S (5) 14964 var W 1282 U 5 10

" " " S (5) 7510 var W 330 U 5 1/2

SEC COR 17 Tam 6 N 6 1/2 E 14 1/2

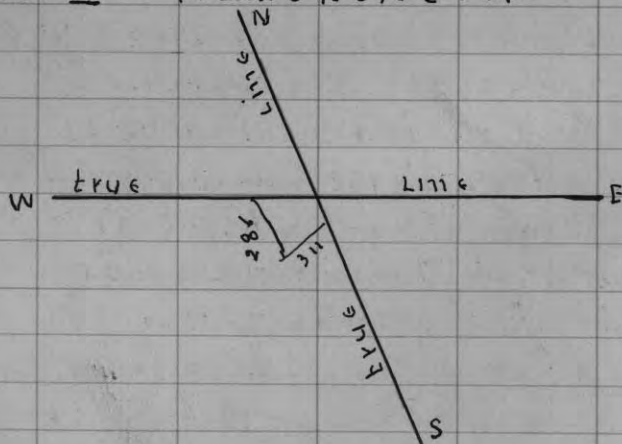

SEC-17 CONT exclusively

SW-COR 7 Pine 14 N 17 1/2 W 13 3/4

W " 16 S 26 E 22

N 1/4 PS (6) 7598 var W 121

E 1/4 P Spruce 6 S 80 3/4 W 12

fir 8 N 56 W 27 1/2

SE COR W (6) <sup>5 1/2</sup> 820 var N 84

S 1/8 W Line Tam 16 N 89 W 16 1/2

Can. Sec Spruce 4 S 17 E 14

Pine 5 N 19 E 18 1/2

1/8 bet N 1/4 " 12 S 11 1/2 E 20 1/2

" " W (6) 4154 var S 2 1/2 U 5 1/2

S 1/4 P Spruce 4 S 19 1/2 E 20

N 40 " 2 S 45 1/2 W 35

N 1/8 W Line Maple 6 N 77 1/2 E 21 1/4

1/8 bet N 1/4 E (5 1/2) 2060 to stake

1/8 " E 1/4 Pine 22 N 36 W 17

1/8 bet E 1/4 S (7) 3732 var W 6 1/2 U 6

E 1/8 S Line Tam 7 N 82 1/2 E 21 1/2

1/8 bet E 1/4 N (70.5) 1900 to stake

S 1/4 PS (10) 1860 then E (5 1/2) 1500

W 1/8 S Line (5) Pine 6 N 63 E 34 1/2

" " " (5 1/2) 1865 then W (6 20) 2117

var S 8 U 6.50

SEC 18 39-9 Jan 16 1894

NE COR W (5) 4078 var N 10 1/4 3/4

N 1/4 S (33/4) <sup>10'</sup> 7478 <sup>3597 R (3.40)</sup> var E 21 1/3 37

S 1/4 P { Spruce 6 N 81 W 27 1/3  
Tam 12 S 12 1/2 W 21 3/4

E 1/4 P W (0) <sup>4243 R-3/4</sup> 8814 var S 34 1/2 - 35'

W 1/4 P { fir SEP. map L standing

new Tam 4 N 73 1/2 E 22

Gen SEC Birch 10 N 44 3/4 E 30 2/3

Tam 15 S 61 E 33

1/8 6 E N 1/4 } Pine 12 N 64 1/2 W 18 1/2

" " " E (1° 50) 448 var N 6 1/2

Gen NE 1/4 E (5) 1902 var W 12 1/2 U 5°

E 1/8 N line } Pine 16 S 37 E 15 1/2

~~How?~~

and 21

SEC 19-38-9 SEC 22 1892

SE COR N (5) about 150 chains

moved this corner S 14 + W 14 LKS

SE COR W (5) 4080 var N 247 U 5 1/4

E 1/8 S line Tam 12 N 8 W 19

these notes were taken from notes from

SEC 17-8-19-30 SEC <sup>page</sup> 7 this book

= SEC 21 38.9. Dec 18. 1895 =

SW COR N (12 1/4) 7520 var W 36 1/2

W 1/4 P { Tam 24 N 5 W 17

" " " " " 12 S 39 1/2 E 19 1/2

" " " " " E (6 1/2) <sup>36 4168</sup> 8320 var N 86 U 6 1/2

NE COR W (6) 8542 var N 3 1/2 U 6.05

N 1/4 P { Birch 10 S 5 1/4 E 8 3/4

" " " " " 8 N 1 1/2 E 15 1/2

8 " " " S (10) <sup>3768 1/2</sup> 7556 var W 31 1/2 U 10

Gen SEC Pine 16 N 10 W 8 1/2

" 8 N 83 1/2 W 10 1/2

1/8 6 E S 1/4 Spruce 7 S 30 W 19

" " " " W (5 1/2) 4113 var S 10 1/2 5 1/2

S 1/8 W line Pine 8 1/2 S 33 E 32 1/2

1/8 bet S 1/4 E (5 1/2) 4089 var N 4 1/2 U 5 3/4

Gen SE 1/4 N (9 1/2) 1903 var W 2

1/8 bet E 1/4 17 Pine 10 N 85 E 16 1/2

" " " " N (9 1/2) 3782 var W 24 1/2 U 20

Gen NE 1/4 E (5 50) 2105 Hitie

= copied to this point down =



SEC 22-38-9 Jan 18-1892

SE COR W (5) 7673 Van S 83 1/2 U 4 1/4

S 1/4 P { Birch 20 S 73 E 11

" { Pine 8 S 11 W 126

" S (4) 1 mile. found nothing left it.

SE COR N (5) 3865 Van E 11 U 4 1/2

S 1/8. E Line { Tam 11 N 78 W 18 3/4

S 1/4 P N (5) 7778 Van W 42 U 4

E 1/4 P W (4) 8000 + Left it

E 1/8 S line { Pine 10 N 55 E 11 1/2

" " N (4 3/4) 3870 to Random line Van E 22

= 700171894 =

SW COR N (8 1/2) 7538 Van E 19 U 7 1/2

W 1/4 P { Pine 12 N 66 W 38

" 8 S 44 1/2 W 41

E 1/4 P W (4) 7950 Van N 136 U 3 1/2

S 1/4 P N (5) 7788 Van W 42. Page 48 book 3

Cent SEC { Pine 12 N 8 1/2 E 9 1/4

Spruce 7 S 43 1/2 E 7 1/4

1/8 bet S 1/4 { Pine 13 N 89 W 17 1/2

" " E (4 1/2) 3832 Van N 29 1/2 U 4 1/4

SEC 23-38-9 Jan 28-1892

W 1/4 PE <sup>+ 25' 40 85 R (6.25)'</sup> C 6 1/2 8150 Van N 60 U 6

S 1/4 PE <sup>+ 1 1/2</sup> C 7 1/2 4125 Van N 179 U 6.35

SE COR N (5) 7706 Van - 223 U 5.05

E 1/4 P 23 About 30 rods w of E. shore of Lost Lake

Cent of SEC { Hem 11 N 77 E 19 3/4

" " 12 S 31 W 20

1/8 bet N 1/4 { Birch 18 N 9 1/2 W 35 1/2

" " " " E (6 1/4) 1000 to Lake

E 1/8 S Line N (6 1/4) 1150 to Lake

" " " " { Maple 9 S 8 1/2 W 11 1/2

S 1/8 W Line E (7) 4135 Van N 1 U 7

1/8 bet S 1/4 { Pine 7 N 18 1/2 W 7

1/8 " W 1/4 { Hem 16 S 11 W 13 1/2

S 1/4 PE 4145 Van N 16 U 4 3/4

Cent S W 1/4 N (5) 1908 Van E 2 U 5

SE COR N (6 3/4) 1100 to Lake 1/2 miles E + W and 3/4 mile N + S in E 1/2 23 not plotted

SW COR E (4 1/2) 4158 Van 2.5 4 1/2 U

W 1/8 S Line { Birch 12 N 1 E 25 1/2

Mc. S side Lak N 4 1/2 1836 to me on N side then N 275 to 1/4 P.

me on N side (NEW) Pin 22 N 1 E 35

W 1/4 P of 26 E (6 1/2) 1500

" " " W (4 1/2) 3852 Van N 30 U 3 5/8

Used a Point 3900 S + 110 E of N 1/4 P for Cen of SEC Sect 23 over

N + S 1/4 line 23  
S 1/4 P N (4 1/2) 7562 Van E 116  
SEE SEC 26 at bottom of page 14

See 25-38-9

SEC 23-38-9 cont and-see 24

MC S. side LAKE S (4 1/2) 3570 var E 38 v 3 50'

SE cor 27 W (5) 7565 var N 152 v 4 1/2 to

McDonalds corner

E 1/8 on N line S (4) 3880 var W 104

SEC 25 38-9 Nov 20 1894

NE cor W (5) 6000-4 1/2 var S 350 v 4 1/2'

NW cor Birch 11 N 89 3/4 E 43

Hem 11 N ~~37~~<sup>75</sup> W 38 75 W 38

N 1/4 P Pine 20 S 246 35

maple 13 S 63 W 29 3/4

N 1/4 P S (3 1/2) 7907 var W 2 1/2 v 3 1/2

W 1/4 P see 24 E (2 3/4) 725 and 6282 = 7007 var S 19 v 30

E 1/4 P N (5) 2000 &amp; left it

W 1/4 P 25 E (1/2) 8069<sup>30 90</sup> var S 61 1/2 v -25'

NE cor 25 S (3 1/2) 4021 var E 24 v 3 1/4

E 1/4 P 25 Spruce 5 N 81 1/2 E 35 1/2

1/8 bet E 1/4 25 Pine 16 S 32 3/4 E 4

" " N (3 1/4) 3987<sup>1996</sup> var E 22 1/2 v 240

N 1/8. E Line Elder 9 S 64 1/2 E 7

CENT SEC 25 Tam 10 S 75 E 17

" 5 S 74 W 9

1/8 bet N 1/4 Spruce 10 N 29 1/2 E 5 1/2

" " E (1/2) 4000<sup>1993</sup> var S 10 1/2 var v 40

N 1/8. E Line Y Pine 18 S 17 3/4 E 21 N 88 W 78

SEC 26.38-9 DEC. 15 1892

W 1/4 P E (6 1/2) 8160<sup>4070 12 16.10</sup> var N 92 v 6.35'E 1/4 P N (5) 3915<sup>1.47</sup> var W 121 1/2 v 5 10'N 1/4 P S (4) 7940<sup>4017 3 50</sup> var W 15 1/2 v 4'MC E of S 1/4 P W (5) 1540<sup>1512 1000</sup> Hillie v 450'

CENT SEC 26 fir 8 N 74 1/2 E 15

" 8 S 49 1/2 W 19 1/2

1/8 bet N 1/4 maple 9 N 2 1/2 E 23 1/4

" " E (43/4) 4121 var S 15 1/2 v 5'

N 1/8 Line Pine 20 S 70 E 21

N 1/4 P N (4 1/2) 7562<sup>3748 4.10</sup> var E 166 v 4 1/2

SEC 27-38-9 NOV. 7-1894

N 1/4 PS (3/4) <sup>+18'</sup> 7832 <sup>3916</sup> var 179 U 250E 1/4 P W (4/2) <sup>+42'</sup> 7685 <sup>3862</sup> var N 95 U 335 OLD Rand

S 1/4 P Birch 5 N 4 1/2 E 29

Pine 12 S 6 3/4 E 36 1/3

Used old Random bor S line which is N line <sup>34</sup> <sub>OK</sub>

N 1/4 PS (3/4) 4942 to Lake

W 1/4 P new Tam 6 N 10 1/2 E 35 1/2

" 5 S 18 1/2 W 33

S 1/8 W line Pine 10 N 5 W 12 1/4

" " " E (4 3/4) <sup>+43'</sup> 3813 var S 47 1/2 U 350

SW cor N (5) 7950 var E 29 1/2 U 405

CENT SEC Birch 12 N 82 1/2 W 9

" " Pine 13 N 38 1/2 E 11 1/2

" " E (5) (4 1/2) 165 to Lake

SW cor Pine 6 S 26 W 25

" " 7 N 24 1/2 <sup>VV 13</sup> ~~13~~

SEC 28-38-9 NOV. 10-1894

E 1/4 P W (4 1/2) <sup>+58'</sup> 8117 <sup>4026</sup> R <sup>2 1/2</sup> var N 138 U 335NE cor W (4) <sup>+1.55'</sup> 8064 <sup>3940</sup> var 269 U 355N 1/4 PS (2 1/4) <sup>+49'</sup> 7840 <sup>R 3 3/4</sup> var N 111 1/2 U 3

N 1/4 P Pine 12 S 85 W 19 1/2

" 18 S 25 1/4 E 32

S 1/4 P W (4 1/2) <sup>+1 1/2</sup> 4134 var N 38 U 4

W 1/8 S line fir 8 S 69 1/2 E 5 1/2

NW cor S (5) <sup>50'</sup> 7818 <sup>R 4 3/4</sup> var E 113 U 410

W 1/4 P Tam 8 N 62 E 65 1/2

" 12 S 72 1/4 E 78

GEN SEC Cedar 8 S 4 1/2 W 21 1/4

Birch 11 S 37 1/2 E 24

1/8 bet W 1/4 Tam 10 S 60 W 4

" " S (4) 3908 var W 19 U 310

" " N (4 1/4) 3926 " E 13 U 3 3/4

W 1/8 N line Pine 12 N 87 E 7

GEN NW 1/4 " 10 S 24 E 7 1/4

" " W (5 1/4) 2026 var S 6 U 5

N 1/8 W line Willow 5 S 19 1/4 E 48

1/8 bet S 1/4 Pine 10 S 51 E 8

" " E (4 1/2) 4048 var S 45 U 4

CENT S 6 1/4 Pine 12 N 81 W 18 3/4

" " N (4 3/4) 3963 var W 6 1/4 U 4 1/2

1/8 bet E 1/4 Tam 5 S 12 3/4 W 25



## SEC 29-38-9 Dec 14-95

SECOR VII (4 1/2) <sup>+56'</sup> 4182 Van N 68 1/2 U 43 5'S 1/4 P N (3 1/2) <sup>3966</sup> 7928 Van E 64 U 340

" " Orig Pine sed new } Tam 4 S 63 1/2 E 57 1/2

NE COR W (5 1/2) 8392 Van S 172 Van 5 20'

N 1/4 P Tam 5 N 30 1/2 E 42 1/2

" 5 S 39 1/2 E 31 1/2

E 1/4 P W (4 3/4) <sup>+10'</sup> <sup>4196</sup> 8383 Van S 25 U 4 25'

Cen sec } Pine 18 N 44 1/2 W 23 1/2

} Spruce 7 N 33 E 20 1/2

E 1/8 S line } Pine 20 S 14 E 18 1/2

" " N (3 3/4) then timber

## SEC 30389

NE COR W (7) <sup>-42'</sup> <sup>4390</sup> <sup>-7'</sup> 9698 Van S 118 U 80 5'" " N (5) <sup>-8 1/2</sup> 7370 Van E 1112 U 5 1/2

1/86 CE E 1/4 N (13/4) 3918 Van 23 U 9 40'

N 1/8 E Line } Pine 13 South 1 1/2 dk

" " W (720) 1000 then Pine

N 1/4 P S (5) <sup>-52 0'</sup> <sup>3833</sup> <sup>43 3/4</sup> 7720 Van E 738 U 4 3/4SE COR W <sup>4748</sup> 9750 4 33 Van S 360 U 4 3/4

SW cor } Spruce 2 1/2 N 89 1/2 E 41 1/2

" 4 S 76 1/2 W 22

S 1/4 P } Cedar 8 N 71 W 15

" 12 S 4 3/4 W 26

Cen sec in Lake } Pine 30 N 89 1/2 E 276

" 7 S 89 1/4 E 18

N 1/8 E Line W 1/4 P } Spruce 2 1/2 89 1/2 E 41 1/2

N 1/8 A } " 4

1/86 CE E 1/4 } Pine 7 S 89 1/2 18

SEC 33-38-9 DEC 10 1895

E 1/4 P W (4) <sup>4031</sup> 8121 Van S 8 U 350

N 1/4 P S (-9) 8758 Van W 5 U 8 3/4

S 1/4 P Tam 7 S 9 3/4 W 33 NEW found 019 trees

NW COR S (8 3/4) 8624 Van W 106 U - 9

W 1/4 P { 4 Pine 6 S 89 E 21 1/2

angle 7805'

.. .. - S 53 1/2 W 8 1/4

N 1/8 W Line { Pine 10 S 82 W 7

.. .. E (355) 41.... Van S 58 U 410

1/8 bet N 1/4 { Pine 12 N 7 W 10 1/4

CENT SEC } .. 12 N 63 1/2 E 26

.. 12 N 74 W 16 1/2

SEC 34-389 DEC 5. 1895

NE COR S (5 3/4) 9156 Van W 32 U 6°

S 1/8 E line Tam 14 S 80 1/4 W 20 1/2

E 1/4 P W (4 1/2) <sup>383924</sup> 7837 Van S 87 U 4 1/4

NW COR S (-9) 8839 Van E 61 U - 9°

N 1/4 P S (-7) <sup>34445</sup> 8972 Van W 29 U - 735

W 1/4 P NEW { Hem 6 N 53 W 10

Birch 8 S 19 E 8 1/2

CENT SEC maple 7 N 55 E 14 1/2

Pine 14 S 69 E 9 3/4

1/8 bet N 1/4 { Pine 11 S 3 W 22

.. .. E (3 3/4) <sup>428</sup> 3862 Van S 32 U 410

N 1/8 on E line Tam 10 S 26 W 6 1/4

1/8 bet N 1/4 W (4.25) 3952 Van N 13 U 425

N 1/8 W Line Cedar 14 N 58 3/4 W 21 3/4

CENT NW 1/4 S (820) 2028 Van E 11 1/2

1/8 bet W 1/4 Pine 20 N 28 W 14

SEC-35-38-9 no date

SE COR W (7 1/2) 3913 Var S 18 1/2 U 7 1/2

S 1/4 P W (7 1/4) 3932 Var N 38 U 7

angle at SE cor 106 10'

W 1/8 S Line 1 Pin 6 S 15 1/2 W 9 1/3

SW COR N (5) 2126 + 17 = 2143 Var 1648

angle at SW cor 77 15'

E 1/4 P W (6 1/2) 3000 to Lake + set me ⊕

W 1/8 S Line N (6 1/2) 2180 SEE Stake marked 2180 <sup>Pine</sup>

⊕ me 1 Pin 20 N 30 E 8 1/4

after I had finished in 36, I found that in same way I had made a mistake of 10 links to much in the offset or variations & at the south end of E line of Oct 20 1894 found No E or W 1/4 Posts

N.B. After finishing 36, found that var at SW cor should be 88 LKS instead of 78 LKS. but thought best not to correct it now

SEC-36-38-9 Oct 12 1894

SW COR N (5) 12600 Var W 500 Paces

" " N (5) 8750 Var 2030 U 4 1/2

NW COR W (5) 3931 Var N 7 1/2 U 4 50'

NW COR S (850) 8966 Var W 78 U 9 25'

W 1/4 P } Pin 12 N 49 E 25 1/2

" " " " 13 S 60 E 20 1/2

" " " " E (1 1/2) 7002 Var S 198 U 1'

angle at NE cor 35 75 40'

NW COR 36 E (5) 6085 Var N 576

N 1/4 P } Tan 5 N 66 W 15

" " } Spruce - N 48 E 16

" " } S (1 1/2) 8390 Var E 192

cen sec } cedar 12 N 37 1/2 W 6 1/2

        } Birch 10 S 52 W 24 1/2

1/8 bet: W 1/4 marked a stake in open swamp

" " N (5 1/2) 4349 Var E 12 U 6'

W 1/8 N Line } Spruce 8 N 85 E 15 3/4

N 1/8 W " } Pin 7 N 85 1/4 E 22 1/2

" " " " E (1 1/2) 1625 Var S 3

Cent NW 1/4 } Pin 9 S 86 W 12

S 1/8 W Line E (6) 3734 Var N 43 U 5 1/2

" " " } Pin 7 N 6 1/2 W 6 1/2

1/8 bet S 1/4 } Pin 18 S 61 E 15

SE COR W (00) #3965 Var N 367 U 1/2

S E E opposite Paye at bottom



SECT 2 1+2 37.9. OCT 24-1894

NW COR 2 S (5 1/4) 7370 var W 96 U 5 1/4

SW .. 2 E (7) 15231 var N 30 U 5 1/2

NE .. 2 S (4 1/4)<sup>2 2 5'</sup> 230 68 var S 97 6 U 2 10

SE .. 1 S (4 1/4) Spruce 7 N 32 E 7 1/2

SW .. 2 E (7) 15231 var N 30 - U 5 1/2 REPAIRED

SW .. 1 Spruce 8 N 46 W 11 1/2

Tam 10 S 47 E 14 1/2

Tam 13 S 21 W 19

1/4 Post bet 1+2 Pine 6 S 25 W 15 1/2

Tam 10 S 11 1/4 E 23 1/4

N 1/8 E line 2 Pine 22 S 55 1/2 W 11 1/2

" " W (7) 7782 Hit it

W 1/4 P E (7) 7650 var N 138 U 6 1/4

" " N (3) 3658 var W 15

N 1/8 W line 3 Pine 12 N 64 1/2 W 73 1/4

Cent NW 1/4 2 N (5 1/2) 1612 var W 2

N 1/8 W line 1 E (6 1/4) 3892 var N 16

SEE 1 nov 30 1896

W 1/8 S line N (3) 3953 var N 16 U 3 1/4 to

1927 E of W 1/4 P on E + W 1/4 line

= DEC 30 1896 =

from 69 S of old random crossing the

Center of Section E 3836 var N 31 U 5 50

Cent Sec S (2 1/2) 3960 var <sup>W</sup> 29 ~~W~~

SEC 237-9. DEC 15 1896

S 1/8 W Line of SEC 2 remeasured and corrected errors

S 1/8 W line Tam 7 N 78 1/4 E 40

W 1/4 P Pine 18 N 77 1/2 E 4 1/2

Cedar 5 S 78 1/2 E 30

SW COR E GR 3834 to 1/4 P

S 1/4 P N (4 1/2)<sup>+40' 3 8 94</sup> 7480 var E 87 1/2 U 4 1/4

Cent SEC W Pine 11 S 37 W 5

" " 20 N 15 1/2 W 27 1/2

E 1/4 P W (6 1/2) 7786 var N 14 U 6 2 1/2

1/8 bet W 1/4 Pine 13 S 12 1/2 E 7 1/2

" " S (5 2 1/2) 3873 var W 29 U 5 1/2

W 1/8 S line Cedar 8 S 58 W 10

1894

SEE<sup>s</sup> 3 and 4. 37-9 Dec<sup>r</sup> 27 1893SW cor E (4<sup>3</sup>/<sub>4</sub>) 7650 var S 30 U 5<sup>1</sup>/<sub>2</sub>" " N (10)<sup>10 5'</sup> 7775 var W 145 U 10NW " E (5<sup>1</sup>/<sub>2</sub>)<sup>2 56'</sup> 8086 var N 415 U 5<sup>2</sup>/<sub>0</sub>N 1/4 P Tam 10 S 41<sup>1</sup>/<sub>2</sub> W 57<sup>1</sup>/<sub>4</sub>" " " 6 N 88<sup>1</sup>/<sub>4</sub> 61W 1/8 S line Pin 13 S 84 E 21<sup>1</sup>/<sub>4</sub>" " " N (8) 7696 var E 23<sup>1</sup>/<sub>4</sub> var 8<sup>1</sup>/<sub>10</sub>NW cor } Tam 7 N 32<sup>7</sup>/<sub>2</sub> E 42<sup>7</sup>/<sub>2</sub>  
" 6 S 54 E 57 } 0792W 1/8 N line Tam 7 S 45<sup>7</sup>/<sub>2</sub> E 20<sup>3</sup>/<sub>4</sub>

CEN NW 1/4 W (-) 1978 var N 85

N 1/8 W line Tam 4 N 20 W 12<sup>1</sup>/<sub>4</sub>W 1/4 P W Pin 9 N 73 E 38<sup>3</sup>/<sub>4</sub>" " 11 S 79<sup>1</sup>/<sub>2</sub> E 49<sup>1</sup>/<sub>2</sub>

S 1/8 W line O Pin 12 in diameter for Post

W 1/4 P E (5) 7906 var N 208 U 4<sup>2</sup>/<sub>0</sub>

= SEE 4 =

S 1/8 E Line W C 1/4 to Lake

SEC-6. 37-9 May 16<sup>r</sup> 1893N.E. S. side Lake E line (W 1/4<sup>0 44</sup>)<sup>To</sup> over Pond~~6100 to Lake 19 = 8000 var~~

me on S. side of Lake on E line

" " W (4) 8485 var N 6 U 4<sup>1</sup>/<sub>4</sub>E 1/4 P W (4) 8485 " S 14 U 4<sup>2</sup>/<sub>5</sub>

1/8 bet E 1/4 P line 20 S 9 E 52

" " " S (3) <sup>24'</sup> <sup>21 34</sup> 4294 var W 30 U 3<sup>1</sup>/<sub>4</sub>

E 1/8 S Line } Pin step 18 N 16 W 22

Cent of Sec 7 Pin 16 N 79<sup>1</sup>/<sub>2</sub> E 16W " 22 S 44 E 14<sup>3</sup>/<sub>4</sub>

1/8 bet S 1/4 } Pin step 20 N 37 W 42

" " E (3<sup>1</sup>/<sub>2</sub>) <sup>20 53</sup> 4128 var S 24 U 3<sup>1</sup>/<sub>0</sub>S 1/8 E Line } R OAK 8 S 32<sup>1</sup>/<sub>4</sub> W 51Cent S E 1/4 } Pin step 16 S 62<sup>1</sup>/<sub>2</sub> E 70

SEC 8-37-9 Jan 5" 1894

SE COR N<sup>32</sup>(2) 4256 var W 39 1/2 U 2 1/2

E 1/4 P W (4) 8000 + left it

SE COR W (4) 4000 " " "

NE COR W<sup>1/2</sup>(4) 8833 var N 235

N 1/4 P gone - new { Pine 11 N 74 1/2 E 17

" 14 S 87 W 27 1/2

N 1/4 P S (3) <sup>4124</sup> 8224 var E 218 U 2

SE COR W (4) 4300 var S 153 U 3 3/4

S 1/4 P ORGL steps

NW COR S (2 1/2) 8050 var N 194 U 2 1/2

SWE o trees down

E 1/4 P W (4) <sup>4132</sup> 8732 var N 61 1/2 U 3 3/4

W 1/4 P { } Pine step 12 N 6 E 27

" " " 12 S 85 E 30 1/2

Cent See { Pine 12 N 43 W 15 1/2

" 10 S 5 1/2 E 22

N 1/8 E line W (5) at about 2500 to Lake and  
established the distance at 4370 var S 8

118 bet N 1/4 { } Pine 13 S 68 1/2 E 19

cent NE 1/4 marked stake in swamp

" " " S (1/4) 2020 var W 1 1/2 U 7 0 5

118 bet E 1/4 { } Pine 8 N 83 1/2 E 34 3/4

S 1/8 E Line W (4) 4294 var S 48 U 3

118 bet S 1/4 { } Spru 11 S 50 E 23 3/4

SEC 9" 37-9 Dec 19-1893

NE COR W (1/2) 3683 var S 15 U 0

E 1/4 P W<sup>16'</sup>(4) <sup>3784</sup> 7866 var S 179 U 3 1/2

N 1/4 P S (6) 8000 var W (005') var N 326

S 1/4 P W (2) <sup>204</sup> 3885 var N 143 U 150NE COR S (11) <sup>20'</sup> 8120 var E 49 U 1/2

E 1/4 P { Pine step 15 S 46 E 38

" " " 18 N 6 1/2 E 5 3/4

W 1/4 P N (4) <sup>338'</sup> 4194 var W 266 U 4N 1/4 S (5) <sup>4228</sup> 8388 var W 13 U 1/2

cent see marked a stake in Chen Swamp

N 1/8 W Line { Pine 14 S 75 W 31

NW COR { } Pine 18 N 76 W 200 orig =

118 bet N 1/4 Pine 24 N 10 E 18 1/4

" " " W (3) 4969 var S 17 1/2 U 3 10

" " " E (2) 3730 " N 42 U 1 3/4

118 bet W 1/4 { Pine 12 S 68 E 13 3/3

N 1/8 E Line { cedar 10 N 19 W 20 1/2

E 1/8 N " { } Pine 14 N 71 W 32

" " S (0) 700 thro: Pine

SW COR N (2) 4256 var W 39 1/2 U 2 10

S 1/8 W line { Pine 12 S 35 W 14

118 bet S 1/4 { Pine 13 N 82 3/4 W 32 1/2

" " " E (3 1/2) <sup>25'</sup> 3830 var N 28 U 3 1/4

S 1/8 E line { Tam 14 S 47 1/2 E 9 1/2

E 1/4 P W on random 2000 to bally 4

118 bet E 1/4 cedar step 5 S 69 1/2 E 12

" " S (1) 4035 var E 29 U 40

Cent See. San Rand  
4163 to 1/4 P



SEC 10-37-9 Jan 1 1894

W 1/8 N line S (50') 7980 var E 62 1/2 U 10'

SW cor E (8) 3880 var S 47 1/2 U 8'

W 1/8 S line cedar 6 S 31 E 16

Cent NW 1/4 Pine 14 S-W 10

SEC 12 cont from Page 30

1/8 bet E 1/4 } Pin 20 S 46 1/2 E 19 1/2

" " N (1210') <sup>2007</sup> 4022 1/2 var W 1/2 Lk

1/8 bet S 1/4 W (320') 1924 var S 3/4 Lk

N 1/8 E line } Pin 17 N 25 1/2 W 38

" " W (41/4) <sup>1919</sup> 3838 var N 14 1/4

Cent NE 1/4 J. Pine sep 8 N 52 1/2 W 12

SEC 12-37-9 Nov 18-1896

SE cor W (3 1/2) <sup>+21</sup> 10226 <sup>26</sup> to Lake 10962 var Lake

" " " 15490 var N 95 U 3/4

NW S (50') <sup>25'</sup> 15672 var E 114 U - 45'

SW cor Pin 12 S 15 E 18 3/4

" " " 8 S 13 3/4 W 25 1/4

" " " 12 N 39 1/2 E 16 1/4

" " " S (420') 1963 var W 6 1/2

N 1/8 W line 13 Pine 12 N 68 E 21 1/4

S 1/4 P 12 marked stake in swamp

" " " N (3 1/4) <sup>+18'</sup> <sup>3968</sup> 7960 var E 43

E 1/4 P W (3 3/4) <sup>+20'</sup> <sup>3854</sup> 7687 var N 45 1/2 U 10'

W 1/4 P Tam 13 N 51 1/2 E 38 3/4

" " 8 N 58 E 42 1/2

N 1/8 W line } Tam 14 S 12 3/4 W 15 1/2

NW cor E true <sup>-32</sup> 7634 var N 71 1/2

E 1/8 N line spruce 7 S 16 W 16

N 1/4 P spruce 2 1/2 S 203/4 E 28

2 1/2 N 68 3/4 E #8 17

W 1/8 N line } Pin 12 N 2 1/2 E 43 1/4

Cent SEC } Pin 22 N 27 W 14 1/2

" " 15 S 32 W 24

1/8 bet E S 1/4 " " 12 S 12 3/4 E 6

" " E (3.20) 3857 var N 2 1/2 U 3 1/2

W 1/8 S line N (1) 3945 var E 18 U 1'

1/8 bet W 1/4 spruce 7 S 30 3/4 E 36

continued on Page 29

10962  
10026  
6.56

10126  
15490/77

10126  
15490  
9.10

120  
110  
13490  
7.57

15-16-21-22 &amp; c

SEC 15-37-9 Feb. 10-1891

SE CORN (4) <sup>+6° 05'</sup> 13750 Var S 270

" " W (4) 13682 Var N 1468

SW COR 16 E (735) 13770 Var S 270 U 8 1/2

SE COR 15 Tam step 9 S 64 1/2 E 23 1/2

" " " N (4 1/2) 22513.

SE " 21 N (5) 3 miles + 3525 Var W 2755

Supposed 1/4 P was in SWamp SEC 10

NE 1/4 37-9. continued may 12' E

N W cor 16 E 5 2 miles and left it

NE 1/4 37-9 continued may 12 E 3666 then

S 500 then E 4340 + 6924 Var N 142 =

East 30928 Var N 643

1/4 P 6 E 2 + 35-37 + 38 R 9 W (6) 3922 Var N 129<sup>66</sup>

SE COR 21 N (5) 31968 Var W 240

S 1/4 P 4 E (4) 3935 + 585 = 4520

me W of 1/4 P E (4) 1164 Var N 77 U 4

S 1/4 P. E (4) 26662 Var S 842 U 4

SE COR 15 N (4 1/2) 22510 Var W 1954

E 1/4 P 12 N (5) 4030 Var W 1460<sup>5</sup>

SE COR 16 } Pine step 20 N 25 E 14

W " " 12 N 55 1/2 W 21

S 1/4 P 15 } Tam 22 S 87 E 7

S 1/4 P 1 } Pine 12 N 53 1/2 W 17

S 1/4 P 16 } Spruce 7836 1/2 E 14 1/2

" 6 N 22 E 24 1/2

SEC 15 cont

NW COR 22 S (7 1/2) 4064 Var E 6 U 7 1/4

W 1/4 P 22 S (7 1/2) Pine 20 N 19 1/4 E 77 1/2

N 1/8 W Line 22 Pine 8 N 47 1/2 W 13 1/2

NE COR 15 } W P 12 N 37 W 18

" 14 N 34 E 15 1/2

" 12 S 27 W 20

NE COR 10 } Spruce 6 N 60 1/2 W 27

Tam 8 S 86 W 17 1/4

NW COR 10 } Pine 20 N 48 1/2 E 36 N 14 E 27

" " 12 S 23 1/2 E 31 1/4

" " 12 S 14 E 27 S 51 1/2 W 38 1/4

" W " 20 S 51 1/2 W 38 1/2

NW COR 15 Tam 8 N 16 1/4 W 55 1/2 W 19 3/4

" 7 S 16 1/2 W 24 3/4

" 8 S 37 1/2 E 24 1/2

S 1/4 P 16 N (2) 8194 Var W 135 Var 1-2'

N 1/4 16 } Tam 10 S 28 3/4 E 77 1/2

SE COR 16 W (150) 3452 Var N 41 U 4 1/2

S 1/4 P 15 N (-5 1/4) 7946 Var W 34

N 1/4 P 15 } Tam 12 N 81 W 24 3/4

" 13 S 73 E 15 3/4

W 1/4 P 15 } Pine step 16 S 19 E 15

Spruce 7 S 62 E 26

SEC 16-379 - Jan 2 1894

NW COR S(4) 4196 Van E 162 U 3.20

N 1/8 W line | Pine SEP 16 S 70 E 15 1/2

" " E (4 1/2) 1906 Van N 15

W 1/4 P E (4 1/2)  $\frac{3754}{7212}$  Van N 53 U 5 10

1/8 bet W 1/4 | Pine 9 N 58 E 12 1/2

" " " N (1) 4168 Van E 8 3/4

W 1/8 N line | Spruce 5 S 57 1/2 E 18 1/2

= OCT 10 - 1894 =

1/8 bet W 1/4 S (2 1/2) 4050 Van W 24 U 1 1/2

SW COR E (7 1/4) 3448 Van N 213 U 8 1/2

N.T.C. 06/77 TRUE DIST = 34.54

3032

= 2279.6'

SEC 19-379 Jan 10 1894

SE COR W (1)  $\frac{25'}{4163}$  Van S 30 U 7.35S 1/4 P W (8)  $\frac{4.20}{4458}$  Van S 33 U 6 1/2

SW COR N (4 1/2) 4104 Van W 12 U 2.50

S 1/4 P N (10)  $\frac{1.28'}{8166}$  Van 206 U 10

W 1/8 S line | Pine 13. N 57 1/2 E 42 1/2

" " N (5 3/4)  $\frac{2078}{4150}$  Van E 15 U 5 10

1/8 bet W 1/4 | Double Birch 11 N 57 E 9 1/2

MC FOR EEN SEC 100 S of cent

" Spruce 7 N 71 E 21 1/2

" " 6 S 60 1/2 W. 21

1/8 bet S 1/4 | Pine 18 N 21 1/2 E 5 1/4

" " W (5 10)  $\frac{2061}{4330}$  Van S 13 1/2 U 2.20

S 1/8 W line marked stake in marsh

Gen SW 1/4 | Pine 6 S 87 1/2 W 5 3/4



SEE 21<sup>22</sup>-37-9. Dec 28-1894

E 1/4 P W (3)<sup>+3.10'</sup> 7374 Var N 409 U 1/4

NW COR S (5) 7740 Var E 1524 Tam DIST 7880

N 1/4 P: Pine SEP 14 S 75 1/2 W 45

" " " 18 N 37 1/2 E 47 1/2

SEE 22-37-9. Dec 18-1894

W 1/4 P S (7 1/4) 4044 Var E 7 U 6 3/4

" " " " E (10) <sup>3359 R 9 3/4</sup>  
6780-2. Var S 476 U

S 1/8 W line: Cedar 14 S 68 E 35

E 1/4 P N (5)<sup>110'</sup> 4040 Var W 82 U 4 1/2

NE COR W (3 1/2) 3460 Var N 17 1/2 U 13 1/2

SW " EC (4) 6472 Var S 6 U 1/4

S 1/4 P N (5)<sup>-18'</sup> <sup>4055 R (540)</sup>  
8096 Var W 43

1/8 bet S 1/4: Tam 18 N 3 W 15 1/4

" " W (13 1/4)<sup>+20'</sup> <sup>33</sup>  
3006 Var N 19

1/8 bet E 1/4: Spruce 10 S 55 W 30

" " -N (5) 4044 Var W 6 1/2 U 405

1/8 bet N 1/4: Pine 8 S 6 3/4 E 11 1/4

" " E (14) <sup>1697</sup>  
3394 Var N 5 1/2 U 13 3/4

N 1/8 E line: Pine 9 S 53 W 6 3/4 U

E 1/8 N line: Tam 14 S 28 E 25

CG N NE 1/4: Pine 20 N 55 W 13 1/4

SEC 23-37-9 Nov 5 1895

S 1/4 P NEW Pine 15 S 3 1/4 W 34 3/4

" " N (3)<sup>+53</sup> <sup>4239 R 3 1/2</sup>  
8131 Var E 126 U 3 1/4

W 1/4 P. E (3 1/2)<sup>-1.39</sup> <sup>4190 R 24</sup> <sup>8585</sup>  
~~8229~~ 8529 Var N 246

E 1/4 P ORGE SEPS NEW: Cedar 7 S 8 E 37

OK CENT SEC: Tam 13 S 86 E 16 } Birch 14 N 58 3/4 W 18

NE COR W (1): " 13 N 7 W 17 } Maple 6 N 62 E 13 1/4

" " " 4144 Var S 81 U (5)

1/8 6 E N 1/4: Pine 12 S 87 W 9 3/4

" " W (1) 4170 Var S 7 1/2 U (10)

W 1/8 N line: Pine 13 S 9 1/2 W 19

1/8 bet W 1/4 " 14 N 85 1/2 W 22 1/2 OK

East from center Var 1° E

4395 fell 7 links North C. 82

2197 set 1/8 east of Center C. 82

{ W Pine 10 S 60 3/4 W 21

{ W Birch 12 N 56 1/2 W 10 1/2

Sec. 27-37-9 Dec 29 1894

me S side Shepard Lake Then N <sup>1282</sup> 3681

gout dist 3375 = 1282 to W 1/4 P.

W 1/4 P E (14) <sup>2836</sup> 6690 var S 8 1/2 U 15

N " " S (3) <sup>7.11'</sup> <sup>4360</sup> 7585 var 9 56 1/2 U 3 1/2

NE CORN S (1 1/2) <sup>+5\*42'</sup> 8397 var W 840 U 2

SE " W (4) <sup>3.47'</sup> 4246 var S 281 U 3/2

" " Y Pine 9 S 47 3/4 E 26

" " W " Stp 12 S 20 1/4 W 40

E 1/4 P Y " 18 N 23 E 19

" " 16 S 76 1/2 E 33

CEN SEC Herb N 31 W 11 1/2

" " 12 N 89 1/2 W 22 3/4

E 1/8 N line Y Pine Stp 18 N 3 1/2 <sup>W</sup> 8 1/4

" " S (-1/2) 4292 var W 60 1/2 U -1/2

1/8 bet E 1/4 Spruce 4 N 20 1/2 W 29

CENT NE 1/4 Y Pine Stp 20 S 56 W 20 1/2

" " W (14 1/2) 1777 var S 3 1/2

1/8 bet W 1/4 cedar 7 N 44 3/4 W 30 1/2

" " S (-1/2) <sup>2158</sup> 4338 var E 10 1/2 U -1 1/2

1900 E of W 1/4 P set me Y Pine Stp 20 N 25 E 18 1/2

= Jan 1895 =

CEN NW 1/4 S 1900 To Lake

SEC. 28-37-9 Aug 12 1891

SW COR N (4) <sup>445 = 45 1/2</sup> 1908 Lake Creek - 358

" " " " 7790 var W 670 U 3 1/2

MC on N side of creek Y Pine 8 N 63 E 9 1/4

W 1/4 P Pine 14 S 40 1/2 " " 11 N 54 W 14

" 20 N <sup>E 20 3/4</sup>

= Jan 7-1892 = <sup>W</sup> 40 1/4

S 1/4 P W (-2 1/2) <sup>-1.12'</sup> 4364 var S 92 U 2 1/2

" " " N (3) <sup>-58' 42 2 2</sup> 8377 var W 140 U 1 1/4

N 1/4 P W (1 1/4) <sup>+1 1/2</sup> 4275 var N 135 + 1/4 var 2 3/4

W 1/4 P E (1) <sup>4316</sup> 8578 var 223. U 1 1/2

SW COR N (4) 3890 var W 328 U 3 2 1/2

S 1/8 W line cedar 14 S 49 W 38

" " " E (-3) 4326 var S 20 U -2 1/2

1/8 bet W 1/4 Pine 10 S 36 W 13

" " " N (-1/2) 4017 var W 23

CEN SEC Sugar 6 N 3 E 16

" " " 7 S 50 1/2 E 22 1/2

1/8 bet N 1/4 Spruce 6 N 85 E 16

W 1/8 N line cedar 8 S 14 W 13

CENT SW 1/4 S (-1/2) 4033 var W 280 - 3/4

W 1/8 S line Pine 8 N 60 E 19

and 31

SEC 29-37-9 Sept 18-1894

SECOR NE 50' 1952 var W 9 - 3/4

" " W (3) 4150 var S 20 3'

" " J Pine SEP 24 N 60 1/4 E 20 3/4

NE COR W (00) 7880 var N 249 U - 2'

E on S Line

N 1/4 P New: fir 7 S 54 1/2 W 15

" " B ash - N 19 1/2 W 23 1/2

E 1/8 N line Pine SEP 18 N 52 1/2 W 3

E 1/8 S " N (-2 1/2) 2600 Lake creek Sures Tim

" " " " " 7870 var W 34 U - 1 1/2

" " " " " 2637 Lake creek and set Mc @

Mc @ J Pine 16 N 75 1/4 E 5 3/4

= SEC 31 Jun 14 1892 =

SW COR N TR (5 3/4) 8 12 2/3 to first offset.

offset W 50 lks then N 137 1/2 and offset W 225

" angle 7840 or N 1120 E dist 1122 1/2. then N

(5 3/4) 1900 then E (640) 22 VAR S 84

what dist 4057. var 3 1/4

SEC 4.36-9 DEC 2" 1889

E 1/4 PS (4) 4200 var W 1400 U 6'

S 1/4 P N (2) 8320 <sup>417' 4034 (205')</sup> var W # 114 U 2 3/4E 1/4 P W (4) 8084 <sup>46' 4096</sup> var N 38 U 2 3/4

SECOR (4 1/2) N. 19 1/2 W 4438 var W 83 W 3 5/8

W 1/4 P New - Pine 8 N 1/4 W 41

CENT SEC " 11 S 41 E 29

" 10 N 52 E 32 3/4

1/8 BEES 1/4 " Pine N 67 1/2 W 32

" " Tam<sup>12</sup> S 37 W 16

" " E (3) 4880 var N 27

W 1/4 P N (-1) 4202 var W 79

N 1/8 W line Pine 12 S 37 1/2 W 14 1/2

" " " " 13 N 72 E 8

1/8 W line E (4 1/2) 4019 var N 18 1/2 U 5 1/2

1/8 bet N 1/4 Pine 6 S 67 1/2 W 15 3/4

1/8 " W " J " 12 N 86 W 10 1/2

" " N (-1/4) 2055 var E 11

CENT NW 1/4 Pine 16 S 45 W 17 1/4

N 1/4 P NEW Tam 6 S 89 W 12 3/4

" " ORG Spruce 7 S 41 W 16

S 1/8 E line J Pine 6 N 76 E 44

" " SEP 10 WEST 50

CENT S E 1/4 Ham 8 S 74 3/4 W 21 1/2

CENT SEC SECS (1/4) 2014 var 35 1/2 E to 1/8 SEC

in 1889 continued S 2014 var 71

lks from S 1/4 P



SEC 4 369 cont.

S<sup>1</sup>/<sub>4</sub>P Pine Stb 11 S 36 W 20<sup>1</sup>/<sub>4</sub>" " 9 N 20 E 47<sup>1</sup>/<sub>2</sub>

= August 11 - 1896 =

Cent SEC E (4<sup>1</sup>/<sub>2</sub>) 4103 var N 66 U 4<sup>3</sup>/<sub>4</sub>1/8 bet E<sup>1</sup>/<sub>4</sub> SW edge Lang Pine Stb N 54<sup>1</sup>/<sub>2</sub> E 92<sup>1</sup>/<sub>2</sub>E<sup>1</sup>/<sub>4</sub>P N (3) <sup>34'</sup> 4260 var W 116<sup>1</sup>/<sub>2</sub> U 3<sup>1</sup>/<sub>2</sub>NE cor N (2<sup>1</sup>/<sub>2</sub>) 825 to Wadena road andSEE Post { Pine Stb 18 N 87<sup>3</sup>/<sub>4</sub> W <sup>26</sup> 55<sup>1</sup>/<sub>2</sub>" " 14 N 19<sup>1</sup>/<sub>2</sub> W 55<sup>1</sup>/<sub>2</sub>N<sup>1</sup>/<sub>8</sub>E Line marked stake in open SWamp

" " " W (4) 4090 vars ---

1/8 bet N<sup>1</sup>/<sub>4</sub> Pine Stb 12 S 8<sup>1</sup>/<sub>2</sub> E 19<sup>1</sup>/<sub>2</sub>Cent NE<sup>1</sup>/<sub>4</sub> S Lab side Pine Stb 22. N 7<sup>1</sup>/<sub>2</sub> E 31695 E of Cen NE<sup>1</sup>/<sub>4</sub> Wadena road X<sup>o</sup>B.T. Pine Stb 60 S 30<sup>1</sup>/<sub>2</sub> W 59<sup>1</sup>/<sub>3</sub>X<sup>o</sup> N 46 E 375. N 8<sup>3</sup>/<sub>4</sub> E 53. 630 Pine Stb 12 S 39<sup>3</sup>/<sub>4</sub> E 53N 33 E 10 B.T. Pine 6 S 82 E 28<sup>1</sup>/<sub>2</sub>N 18<sup>1</sup>/<sub>2</sub> E 200. North 300 N 11 E 400 N 52<sup>1</sup>/<sub>2</sub> E 602

To stake 825 N of NE cor of Sec 4

SEE 5 cont from Page 51

SW cor Pine 7 N 55<sup>1</sup>/<sub>2</sub> E 23SE cor " Stb 10 S 73<sup>1</sup>/<sub>4</sub> W 4<sup>3</sup>/<sub>4</sub>" " 121 N of E 6<sup>1</sup>/<sub>8</sub> S line. 5<sup>o</sup> 10<sup>o</sup> Fro center

394 (Short) 40.55' angle

SEC 5-369 NOV 27 1889

W<sup>1</sup>/<sub>4</sub>P E (5) <sup>11.09'</sup> 8226 <sup>4248-12</sup> var S 126 U<sup>1</sup>/<sub>2</sub>E<sup>1</sup>/<sub>4</sub>P SET with bearings of line to sec. cor, SouthE<sup>1</sup>/<sub>4</sub>P S (5) 4156 var W <sup>#2</sup> 1<sup>1</sup>/<sub>2</sub> U <sup>5</sup>/<sub>2</sub>SE cor W (4) <sup>59'</sup> 4252 var N 73 U 4.4<sup>o</sup>S<sup>1</sup>/<sub>4</sub>P N (4) <sup>-1.21' 4242-10'</sup> 8328 var W 196<sup>1</sup>/<sub>2</sub> U <sup>3</sup>/<sub>4</sub>CEN SEC Pine 6 S 89 E 14<sup>1</sup>/<sub>2</sub>" 9 N 23<sup>1</sup>/<sub>2</sub> W 26S<sup>1</sup>/<sub>8</sub> E Line " Stb 16 S 13<sup>1</sup>/<sub>2</sub> E 45E<sup>1</sup>/<sub>8</sub> S line Pine 10 N 6<sup>3</sup>/<sub>4</sub> W 13" " " " 11 N 87 W 20<sup>1</sup>/<sub>4</sub>" " " N (55) <sup>2094</sup> 4191 var W<sup>1</sup>/<sub>2</sub>1/8 bet E<sup>1</sup>/<sub>4</sub> Pine 18 N 63<sup>1</sup>/<sub>2</sub> E 45<sup>1</sup>/<sub>2</sub>S<sup>1</sup>/<sub>8</sub> E line W (3) 4109 var 20<sup>1</sup>/<sub>2</sub> U 5<sup>o</sup>1/8 bet S<sup>1</sup>/<sub>4</sub> Spruce 4 S 28<sup>1</sup>/<sub>2</sub> E 83<sup>1</sup>/<sub>2</sub>Tarn 4 S 15 W 88<sup>2</sup>/<sub>3</sub>CENT SE<sup>1</sup>/<sub>4</sub> Pine 14 N 84<sup>1</sup>/<sub>2</sub> E 18" " 12 S 24<sup>1</sup>/<sub>2</sub> W 32<sup>1</sup>/<sub>2</sub>S<sup>1</sup>/<sub>4</sub>P W (5) <sup>2271</sup> 2354 var S of me 43

MC ELM N 54 E 29 U 9

new Pine 16 N 65<sup>1</sup>/<sub>2</sub> E 54<sup>3</sup>/<sub>4</sub>S<sup>1</sup>/<sub>4</sub>P N (240) 2122 var W 21 55'CENT S<sup>1</sup>/<sub>4</sub> S (2<sup>1</sup>/<sub>2</sub>) 2095 var E 35 U 55' 1<sup>1</sup>/<sub>4</sub>

CENT of E end of road 780 S of NE cor

N line 2082 = 2100 S line 2118 = 2180

SW cor is 191 N of S<sup>1</sup>/<sub>4</sub>P 2 lks

SEE PAGE 51 at bottom

53 for Horrs add. SEE Shepard copy  
of horrs notes Page 83 + Horrs book no 3

Page 33  
SEC 6-36-9 Oct 18 1889

S 1/4 P Birch SEP 10 S 21 E 29 GOVERN 31 E

.. WPine 20 N 32 W 128

.. N (5/2) 1840 to RIVER 223 1/2 over RIVER

4550 1/2 Van E 12 U 9°

50 LKS E of <sup>53</sup> SE cor N (3/2) 4165 Van E 143 + 50

S 1/4 P N (5/2) <sup>4065</sup> 8171 Van E 12 U 9°

{ N 1/4 P Pine SEP (road) on SW cor ~~W~~ 223 019  
is N 80 W 23 } Book N 84 E 175 <sup>87 049.</sup>

SE cor Y Pine <sup>415</sup> 10 S 88 W 147

W " <sup>415</sup> 24 N 74 E 214

E 1/4 P \* Y Pine 10 S 71 W 168 or 2

@ other tree gone

E 1/4 P E (3/2) 130 + 66 E N 416 ft then W 130 ft

Then W (3/2) 3024 ch to NW end of bridge

E 1/4 P W (transit) 8200 Van S 178 W 41 1/2 - 114

.. " W 3968 + 2015 + 2217 = 8200

Cent SEC Pine SEP 12 S 52 1/2 E 48 3/4

" " 20 S 52 1/2 W 41 3/4

1/8 66 E W 1/4 " " 24 S 72 E 22 1/2

" " 16 S 87 E 26 3/4

W 1/4 P S (5) <sup>2038 + 1808 = 3846</sup> <sup>3846</sup> Van 234

me on W bank Pine 24 N 6 E 66 1/4 had to see this  
5 LKS E for N

.. S of center Pine 18 N 28 W 42 1/2

ELM 11 S 79 3/4 W 50 1/2

Cent SW 1/4 Pine 10 N 19 W 22 3/4

HEM 10 N 4 1/2 E 21

1/8 P W of cent in 2015 54

SEC 6 cont and SEC 8

at cen SEC ANGLE SEC is 90.18'

Cent SW 1/4 S (3) <sup>3</sup> E of R of way

" " " W 2171 to cor (3/2)

" " " E 590 to R of way + 1569 to RIVER

me Pine 16 S 46 1/2 W 27 1/2

.. SEP 16 N 50 1/2 W 45

S 1/8 W line Pine SEP 22 S 33 W 31 1/4

" 12 N 50 3/4 E 76 1/2

Cent SEC E to RIVER 875 ME; maple 11 S 62 3/4 W 86 1/2

SEC 8 = JULY 29 - 1892 = Elm 8 N 47 W 81

SW cor HEM 24 N 72 W 52 1/2

do 10 N 58 E 41

SWE <sup>-13'</sup> (5) 4614 Van N 17

S 1/4 P N (7 1/4) 4019 Van W 40 U 5 5/5

E 1/4 P W (5) 4450 to N + S 1/4 line run in 1889

Then same line W 4443 Van S 242 U 5 05

Cent SEC Y Pine 12 S <sup>86 3/4</sup> 44 1/2 W 26 1/2

" " " W " 8 S 44 1/2 W 26 1/2

1/8 66 E W 1/4 Birch 9 N 3 W 31

maple 12 S 88 1/2 E 29 1/4

SW cor (-) 4272 Van E 40

S 1/8 W line aspen SEP 10 S 56 1/2 W 15 1/2

" " 11 S 85 1/4 E 17

40 rods of above HEM 24 <sup>5</sup> 85 3/4 W 32 1/2  
<sup>75 E 63</sup>

Sugar 10 N 75 E 63

cont on next Page

and see 7

## SEC 8 cont JULY 29, 1892

W 1/8 S line Pine 14 S 12 1/2 W 12 3/4  
 1/8 bet S 1/4 SUGAR 9 N 7 1/2 E 18 1/4  
 S 1/8 on W line E. (TRF) <sup>2276</sup> 4528 var N 13 U 4 1/4  
 W 1/8 S line N (TRF) <sup>2070</sup> 4142 var E 3/4 LK  
 Cen SW 1/4 Sugar 7 S 5 1/2 W 10 1/2  
 40 rods of above { Birch 10 S 5 1 W 28  
 = Nov 25 1897 =

me on E side of YUGEN line then began  
 survey of Road. SEE Page 84 Shepards copy

SEE 7. 369 August 1<sup>st</sup> 1900

1/8 bet bet S 1/4 (4) 3100 to Lake + 1150  
<sup>2125</sup> 4250 var SE E Cent of SW 1/4  
 (center) SW 1/4 Hum 7 N 8 W 10  
 1/8 bet W 1/4 E (6) 1934 var N 87 U 7 3/4  
 1/8 " S " W (5) <sup>30'</sup> 1935 " S 28 U 3 1/2  
 Cent SW 1/4 W 15 25 to Lake Had very poor  
 help and there may be some mistake  
 = Sept 26 1903 =  
 E 1/4 P W (4) <sup>4</sup> 4128 var S 5 1/2 U 6 1/4  
 S 1/4 P E (4 1/4) <sup>17'</sup> 4195 var S 44 U 150  
 Cent of SEE S (5 3/4) 4282 var W 17 U 3 3/4  
 S 1/8 E Lin W (3 1/2) 4150 var N 10 <sup>45'</sup>  
 1/8 bet S 1/4 Maple 6 S W 6 1/2  
 40 rods N Tam 12 S 66 E. 15 1/2

## SEE 7 cont:

1/8 bet S 1/4 E (5 1/2) 4137 var S 30 1/2 <sup>4'</sup>  
 Cent SE 1/4 S (7 1/4) var E <sup>4'</sup>  
 S 1/8 E line N 2142 ÷ 2 = 1071 ~~at 11524 W 34~~  
 Ashen Sep 16 S 70 1/2 W 22 29  
 " " 14 S 24 1/2 E 24  
 The above 1/16 bet 1/8 & 1/4 P  
 E 1/8 S Lin Pine Sep 7 S 12 1/2 W 2 1/2  
 S E 6 11 - 1889  
 S 1/4 P N (5) <sup>27'</sup> <sup>4275</sup> 8215 var W 64 U 7 1/4  
 E 1/4 P W (5) <sup>4116 (5 3/4)</sup> 8176 var W 68 1/2  
 Cent SEC Cedar 10 S 69 W 22  
 Birch 10 S 60 E 7  
 1/8 bet E W 1/4 Tam 6 S 45 W 1 LK  
 " " " N (4 1/4) <sup>26'</sup> <sup>1980</sup> 3350 var W 15 to River 11 1/2 LK  
 NW Cor S (5 1/2) <sup>51'</sup> <sup>1985</sup> 3971 var E 59 var E 99  
 " " " (5 1/2) <sup>20'</sup> 5485 var E 32 <sup>2 1/2</sup>  
 N 1/8 on W line Pine Sep 24 N 13 W 49  
 1/8 bet N 1/4 Birch 8 N 71 E. 14 1/2  
 " " W 6 1/2 <sup>1930</sup> 4103 var N 11 <sup>3 1/4</sup>  
 at River on W 1/8 line me  
 Elm 11 S 5 W 22 3/4



17-28-33-19-29-20

FOYSEC: 21  
SEE PAGE 65

SEC 16-36-9-JULY 12 1894

SE COR 33 N(6/2) 19300 to Pelican river 15.0

Wide 235.00 to Pelican river again. 100 wide

28740 var W 2.62 var 73/4

SW COR 16 E(4) 8064 var S 25. Then E 8138 to

SE COR 15 CALCULATED

1/8 66 E S 1/4 P 17 Hem 8 N 55 E 4 1/2

Cent SW 1/4 17 " 13 S 47 E 50

" " " S 20 96. var S. 1 1/2 ks

SE COR 33 N(6/2) 24630. var W 108 var 4.35

SE " 28 Tam 12 N 6 1/2 E 16 1/2

" " " " 10 S 1/2 W 30 1/2

" " " W(3/2) 8000 U 2 1/2 Then W 6000. offset S 150

at 6400 to Lake. 8163 over Lake 82 offset

E 33 LKS. Then W at 8666 var N 513 U 2

SE COR 16 Pine 12 S 33 3/4 E 18

cedar 10 N 86 1/2 W 24 1/2

N 1/4 21 OR Pine 8 N 8 1/2 W 3 1/2

S 1/4 P 16 Birch 16 S 66 1/2 W 6 1/2

S 1/4 16 S(3/2) 8200 var W 73 U 2 1/2

W 1/4 P 21 E(4/2) 8100 var N 173 U 5 1/2

E 1/4 P 21 Pine 12 S 36 1/2 W 94

" " Birch 6 N 43 1/2 E 65

1/8 66 E S 1/4 21 as 2m 6 N 62 E 50 1/2

Cent of 21 " 5 N 47 E 37

Birch 7 N 61 3/4 W 57

21.28 N.  
20.85 E W

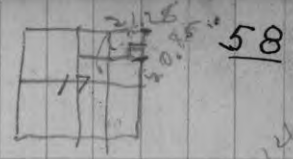

SECTIONS cont:

W 1/4 P 21 Boulder 5x5x 22x on top

" " " W(2/10) 4088 var S 2 1/2 U 250

Cent of SEC 20 Tam 4 S 42 E 52

" 4 N 47 1/2 E 43

SE COR 29 Hem 12 S 53 W 35 1/3

Birch 16 N 62 W 42 2/3

E 1/4 P 29 Hem 8 S 75 1/2 W 47 1/4

" " " E(2) 8180 var S 87 1/2 U 20

E 1/4 P 28 Tam 4 S 25 W 3 1/2

" 3 S 89 1/2 E 15

SEC 17. W 1/4 P W(7) 4095 var W 1 LK U 53 1/2

W 1/4 P .. WELL Pipe 3 ft Long filled with ashes

" " E(4/2) 4269 var N 32 U 350

CENTER SEC N(2 1/4) 4256 var W 50 U 2 1/2

1/8 66 E N 1/4 Birch 14 S 76 1/2 E 11 1/4

" " " W(4 3/4) 4452 var N 15 1/4 U 4 1/2

1/8 66 E W 1/4 + on boulder N 89 E 18 1/2

" " " N(5) 2082 var 25 1/2 U 255

C 672 NW 1/4. HEM 11 N 20 1/2 W 24 3/4

SE COR 33 N(6/2) SEE Top of Page 57 This book

SW COR 16

SEE PAGE " " "

E 1/4 P N(3) 4170 var W 236 U 3 1/2

" S(3) 4170 " " 1/2 LK

S 1/8. E Line Birch N 67 E 59

NE COR 20 S(3) 4056 var E 27 1/2 U 23 1/4

21.25  
26  
127.68  
127.65  
104.25

(17)

SEC 19<sup>20-2430</sup> - 36-9 JULY 1894

NE COR 28 W (2 1/2) 8190 var N 52 U 13/4

" " 29 W (2 1/2) 8246 " S 86 " 3 3/4

" " 30 W (6) <sup>4075</sup> 8790 " " 105

S 1/4 P 19<sup>19</sup> Pine 14 N 27 W 57

" " " 14 N 7 1/2 W 47 1/2

W 1/4 P 19 Pine 30 N 74 W 8 1/4

" " " 24 N 79 E E 27 1/2

" " 19 E (5 1/2) 8286 var S 14 1/2

" " " E " 3816 to Lake

S 1/4 P 19 N (4) 8196 var E 17 U 2 1/4

" " " at N side of Lake offset W 500 angle 73 1/2 dist 1687 1/2

E 1/4 P " Birch 6 S 13 E 29

SEC 19 " 4 S 6 1/2 E 24 1/4

" " } Pine stake and stones around it

NE COR 19 W (2 1/2) 8307 var N 94 U 3 1/4

" " 28 } Birch 5 N 62 1/2 E 36 1/2

SECS 19 & 20 } aspen 7 S 31 E 45

" " 28 & 30 N 1/4 P 19 aspen 3 N 80 E 47 3/4

N 1/8 on W line 19 } " Rock 6 S 41 1/2 W 52 1/2

" " " 19 } Elm 10 S 22 1/2 E 11

" " " E (5) <sup>110</sup> E 4245 var S 86 U 2

1/8 bet N 1/4 19 } Pine 13 N 67 E 22 1/2

S 1/8 on W line 19 } " 20 N 53 1/2 E 33

" " " E (6) 4256 var N 25 U 5.20

1/8 bet S 1/4 mark stake stones around it

SEC 19<sup>20-28-30 and</sup> - 20-21-29 Cont.

W 1/4 P 20 E (2 1/2) <sup>+1.36' 4120</sup> 8212 var S 225 U 35

SE COR 20 Spruce 6 S 22 11 1/2 (6 S 22 1/2 E 11 1/2)

" " 5 N 45 W 6 3/4

N 1/4 P 20 S (3) 7900 overlake + islands var W 85 U 210

S 1/4 P 20 Tam 18 N 45 W 11 K

" " 13 S 59 1/2 E 30

N 1/4 P 20 S <sup>(3) 4003</sup> 8097-33 = 8064 var W 85 U 210

SE COR 16 Pine 12 S 33 3/4 E 24 1/2

" cedar 10 N 86 1/2 W 3 1/2

N 1/4 P 21 } Pine 8 N <sup>8 1/2</sup> 86 1/2 W 24 3/2

" " } Birch 16 S 66 1/2 W 6 1/2

" " " S (3 1/2) <sup>+1 1/2 4108</sup> 8200 var W 73 U 2 1/2

W 1/4 P 21 } E (4 1/2) <sup>1 1/4 4063</sup> 8100 var N 173 U 5 1/2

E 1/4 P 21 Pine 12 S 36 1/2 W 94

" Birch 6 N 43 1/2 E 65

S 1/4 P 21 Tam 4 S 20 1/4 E 25

" " 6 N 33 W 49

1/8 bet S 1/4 21 aspen 6 N 62 E 50 1/2

CEN SEC 21 aspen 5 N 47 E 37

" Birch 7 N 61 3/4 W 57

W 1/4 P 21 Boulder 5 + 5 X 22 on top

CEN SEC 20 Tam 4 S 42 E 52

SE COR 29 } # " N 47 1/2 E 43

" " " } Hem 14 S 53 W 35 1/2

" " " } Birch 16 N 62 W 42 2/3

continued on next page

## SEC 5 19 to 36 continued and SECS

E 1/4 P 29 Hem 8 S 75 1/2 W 47 1/4

" " E (2) <sup>+37</sup> 8180 Var S 87 1/2 U 2"

E 1/4 Tam 4 S 25 W 3 1/2

" 3 S 89 1/2 E 15

N 1/4 P 19 aspen 3 N 80 E 47 3/4

Red oak 6 S 41 1/2 W 52 1/2

## SECS. 25-26-27-34-35 N 54 W 11 3/4

W 1/4 P 26 Spruce 5 N 54 1/2 W 11 3/4

" 6 S 71 1/4 E 23

NW cor 27 S 4100 Var E 17 1/2

N 1/8 W line <sup>27</sup> E (6 1/2) 4148 U N 66 U 8"

" " " " aspen S 31 3/4 W 56 1/4

N 1/4 P <sup>+38' 4215</sup> 27 S (3 1/2) 8420 Var W 96 U 4 1/2

S 1/4 P " Double Birch 12 N 54 1/2 W 39

cedar 8 N 20 48 3/4

center of 27 aspen 6 S 18 1/2 W 26

" 7 N 87 W 55

1/8 bet E 1/4 <sup>27</sup> Pine 18 N 24 W 52 1/4

" " N " " fir 14 S 50 W 69

SEC 31-36-9 = May 24 1895

E 1/8 N line W (6) <sup>12 2046 + 2041</sup> 6429 Var S 22 55'E 1/4 P W (5 3/4) <sup>47' 4067 R 620'</sup> 8393 Var S 115 U 55'

E 1/4 P. Elm 14 S 76 E 29 1/2

spruce 16 N 2 1/2 W 16

SEE next Page

## SEC 31-36-9 cont

S 1/4 P N (7) <sup>+26' 3941 R 7 1/4</sup> 7978 Var E <sup>5940</sup> 60 1/2 U 6 3/4CEN NE 1/4 W on Rand. <sup>2035 + 4070</sup> 6390 Var S 31 Var 540-11

" SEE Boulder S 51 1/4 E 46 3/4

1/8 bet S 1/4 + on Boulder N 66 W 63 1/2

= June 24 1895 =

1/8 bet W 1/4 fir 8 N 57 1/2 W 36 1/2

" " " N (7 1/4) <sup>1986</sup> 4034 Var W 15 1/2 U 6 1/2

N 1/4 P S (6) 8114 Var W 76 U 5"

S 1/4 P in open SWamp no bearing

" " new Spruce 6 N 62 W 11

" 4 S 74 1/4 W 13

SW cor 32 aspen 6 N <sup>41 E 9</sup> 55 1/2 W 7 1/2S E " " <sup>31</sup> 8 S 55 1/2 W 7 1/2" " " " N (5) <sup>53</sup> 24309 Var E 379 U 350'SW cor of 36-9. OK N (6 1/2) <sup>+56'</sup> 12395 Var <sup>U 650</sup> 418 E

" " 31. Birch 6 S 24 1/2 E 35 1/2

Elm 20 N 48 3/4 E 52 1/4

W 1/4 P 31 fir 6 N 24 1/4 W 29

spruce 7 S 74 1/4 W 46 1/2

SW cor 30 Gray Boulder 4 X 6 X 22 ton Top

NW " " and broken dishes under it.

S 1/8 on W line 30' sugar. 8 S 81 3/4 E 40 1/4

NW cor 19 S (3 3/4) 12446 Var W 179. U 2"

SW cor 19 on S end Gray boulder 2 X 5 ft

beans N 70 E 13 1/2

Cen



SEE 32 36-9 cont

W 1/4 P 19. Pine SEP 30 N 74 W 8 1/4

" " " " 24 N 79 E 27 1/2

" " " E (5 1/2) 8286 var 14 1/2 U 3"

SEE 27-36.96 June 1895

W 1/4 P 16 CEDAR 16 N 65 W 68 1/2

" " " E (4) <sup>+1.57' 4171</sup> 8308. var 5 28 U 5 1/2

= JUNE 22 1894 =

SE cor Spruce 12 S 45 W 25 } orig

" " Tam 20 N 58 E 40 }

" " " 20 S 80 E 17 }

" " N (3) 24360 ~~var~~ WH var E 7.50 <sup>U 55'</sup>

" " 17 The aspen is a Birch-maple, gone

" " " (3) <sup>W 1/4</sup> 8182 <sup>(4)</sup> var N 19 U 23/4

at SW cor 17. found norway SEPS orig

" " " } <sup>new</sup> Pine 10 N 52 1/2 E 36 1/3

SW cor N (4 1/2) 413 var W 6 links to me.

" " N whole distance 4160 U ARE 126 1/2 U 3.25

S 1/4 P 17 Hem 13 S 52 W 67

" " 17 Pine 30 N 41 1/2 W 73 1/2

W 1/8 S line 17 Pine SEP 14 S 9 E 10

W 1/4 P 17 E (3) <sup>+134' 4262 R 2"</sup> 8276 + 13 = 8289 var S 227 U 1.25

S 1/4 P 17 N (5) <sup>-1.25' 4206 R 3.3/4"</sup> 8450

S 1/8 W line 17 E (2 1/2) 4169 var S 31 U 3/4

CGN SEE " Sugar 8 S 13 1/2 E 21

" " 8 S 51 W 28

SEE 31 + 32 cont

S 1/4 P 32 Hem 12 N 13 W 12 } OR 9 L 2

" " " Aspen 13 S 16 W 12 }

" " " W (4) 8100 <sup>+142'</sup> - 42 = 8058 var S 91 U 4

" " 31 found OR 9 SEPS. Tam is SE instead of SW

" " " new Spruce 6 N 62 W 11

" " " 4 S 73 1/2 W 13

SW cor 32 aspen 6 N 4 E 9

" " " " 8 S 55 1/2 W 7 1/2

" " " N 160.00

$$\begin{array}{r} 4160 \\ -2080 \\ \hline 2080 \end{array}$$

$$\begin{array}{r} 4242 \\ -2131 \\ \hline 2111 \end{array}$$

$$\begin{array}{r} 8182 \\ -4091 \\ \hline 4091 \end{array}$$

$$\begin{array}{r} 4206 \\ -2103 \\ \hline 2103 \end{array}$$

$$\begin{array}{r} 8476 \\ -4206 \\ \hline 4270 \\ -2135 \\ \hline 2135 \end{array}$$

20-29 &gt; 16

SEC 21-36-9 JULY 1894

SE COR 16

Pine 12 S 33 E 18

cedar 10 N 86 1/2 W 24 1/2

N 1/4 P 21

Pine 8 N 8 1/2 W 3 1/2

" "

Birch 16 S 66 1/2 W 3 1/2

" " <sup>+ 0 1/2</sup> S (3 1/2) 8200 <sup>4108</sup> <sup>5100 to Pelrean River</sup> Var N 73 U (5 1/2)W 1/4 " 21 E (4 1/2) <sup>- 1 1/4</sup> 8100 <sup>4063</sup> Var N 173 U 5 1/2

E " " "

Pine 12 S 36 1/2 W 94

Birch 6 N 43 3/4 E 65

S 1/4 P 21

Tann 4 S 20 1/2 E 25

" 6 N 33 W 49

1/8 66 E S 1/4

<sup>aspens</sup> Spruce 6 N 62 E 50 1/2

CEN SEC 21

Birch 7 N 61 3/4 W 57

ashen 5 N 47 E 37

W 1/4 P 21

Boulder 5x5 x 22 + on top

" " " 21 (2.16) 4088 Var S' 2 1/2 U 250

E ENT SEC 20

Tann 4 S 42 E 52

" 4 N 47 1/4 E 43

SE COR 29

Hem 12 S 53 W 35 1/3

Birch 16 N 62 W 42 2/3

E 1/4 P 29

Hem 8 S 75 1/2 W 47 1/2

" " " E (2) <sup>+ 37</sup> 8180 Var S 87 1/2 U 2

Secs. 25, 26, 27, 34, 35

SEC. 27-36-9 - June 7 1895

W 1/4 P. cedar 16 N 65 W 68 1/2

" " " E (4) <sup>+ 1.57</sup> 8308 Var S 282 U 5 1/2

SW COR Tann 11 N 77 1/2 E 41 1/2

" " " 10 N 77 3/4 W 44 1/2

" " E (4) 250.74 Var S 101 U ~~2 3/4~~ 2 3/4

SE " 34 ROAK 10 S 29 1/2 E 27 3/4

" " N (6) 166.50 to P. River 2 1/2 wid

" " 172.88 Var E 178 U 3

NW <sup>CO</sup> 27 E (7) 8256 Var S 280 U 6 25

NE COR 27 Tann 5 N 59 W 28

" 8 N 15 1/4 W 51 1/2

Pine 6 S 54 E 75 3/4

SE COR 34 N (6) <sup>+ 35'</sup> 17288 Var E 178 U 3

N 1/4 P. 27 Spruce 6 N 86 E 37

Tann 5 N 46 3/4 W 70 1/2

SE COR 35 N (6) 17456 Var W 317 U 4 1/2

NE COR 26 Tann 18 S 60 E 51 1/2

Pine 10 N 24 3/4 E 38 3/4

SE COR 25 Spruce 4 S 86 E 27

" " 26 " 6 S 43 E 25 1/4

E 1/4 P. 26 " 8 N 43 1/4 W 49

" " " J Pine 5 10 S 65 1/2 E 190 1/2

" " " X on boulder N 31 1/2 E 106 1/2

SE COR 27 ASPEN 6 S 55 E 44

" 10 N 62 E 70

Gum

SEC 25-26-27-34-35 continued

S 1/8 W line 26 in barbed burned swamp

" " " E (3 1/2) 8408 var N 19 1/2 U 3 1/2

S 1/8 E line E. (3 1/2) Tam 8 S 59 W 30

" " " 6 N 22 1/2 E 55 1/2

cen S E 1/4 26 Pine 18 S 38 W 72

1/8 bet S 1/4 26 Ashen 5 S 38 E 41 1/3

" " " 6 N 8 1/2 W 45 1/3

cen SW 1/4 26 Pine 7 S 42 E 42 1/2

W 1/4 P 26 Spr 5 N 54 1/2 W 11 3/4

" " " 6 S 71 1/4 E 23

NW cor 27 S ( ) 4100 var E 17 1/2 U

N 1/8 W line 27 E (6 1/2) 4148 var N 66 U 8

" " " " Ashen 7 S 37 3/4 W 56 1/4

N 1/4 P 27 S. (3 1/2) <sup>+39' 4215'</sup> 8420 var W 96 U 4 1/2

S " " " { Birch Double 12 N 54 1/2 W 39

{ Cedar 8 N 20 W 48 3/4

cen sec 27 aspen 6 S 18 1/4 W 26

" " " 7 N 87 W 55

1/8 bet N 1/4 fir 14 S 50 W 69

S 1/4 P of 27 is N 1/4 P 34

{ Birch double 12 N 54 1/2 W 39

{ Cedar 8 N 20 W 48 3/4

SEC 9-35-9 Jan 24-1899

W 1/4 P Tam 7 N 55 W 5 019 L other gone

" " " E (4) <sup>-1 26'</sup> 3995 R (420) 8032 var S 154 U 4 3/4

" " " N (4 1/2) 3983 var W 93 U 4 05'

NW cor new maple double 16 N 47 W 7 3/4

" " " E (5) <sup>+25'</sup> 3976 var S 28 1/2 U 5 40

N 1/4 P S (4) <sup>-1.12' 4000' R 420'</sup> 8035 var E 168 U 5"

cen sec cedar 5 N 79 E 8 3/4

fir 5 N 50 W 8 1/2

W 1/8 N line Spruce 5 N 87 1/2 E 14

" " " " S (2 3/4) 3994 var W 40 U 2 1/4

1/8 bet W 1/4 Pine sep 24 N 9 1/2 W 17

N 1/4 P E (6) 3928 var S 7 1/2 U 6"

E 1/8 N line in creek 12 lks from nearest Point

" " " " S (3 1/2) 4008 var W 19 U 3 40

1/8 bet E 1/4 Pine 12 S 51 W 21

S 1/4 P N (4) 4000 + left it

1/8 bet W 1/4



and to - 15, 21  
 SEC 16 - 35 - 9 no date

SW COR N(5) 3845 var W 314 U 4<sup>1</sup>/<sub>2</sub>

W 1/4 P E(5) 39<sup>4</sup>/<sub>8</sub> to 1/4 line

S 1/4 P N(4) <sup>- 2<sup>1</sup>/<sub>4</sub> 3938</sup> 7778 var W 300 U (4)

1/8 bet W 1/4 S (1) 1950 left it.

= SEC 16 35 9 E =

E 1/4 P W(5) <sup>+ 1.12' 3950</sup> 7831. var N 165 U 4<sup>1</sup>/<sub>2</sub>

W " " W(5) 2000 left it

SEC COR W(5) 3953 var S 11 U 4<sup>1</sup>/<sub>2</sub>

S 1/4 P W(4 1/2) 3910 var N 41 U 4<sup>1</sup>/<sub>2</sub>

" " " N(5) <sup>5' 3838</sup> 7770 var W 116 U 4<sup>1</sup>/<sub>2</sub>

N 1/4 P W(5) 3933 var N 54 U 4<sup>1</sup>/<sub>2</sub>

SW COR N(4) 3738 var E 20 U 3<sup>1</sup>/<sub>2</sub>

" = SEC 15 =

S 1/8 W line W(5) 3975 to STAK X.

X<sup>o</sup> N(5) to CREEK bottom

= SEC 21 35 - 9 =

E 1/8 S line S(4 1/2) 2000 + left it

S 1/4 P S(4 1/2) 2000 + left it

= SEC 16 =

CEN SEC Birch 11 S 89 E 20 1/2

maple 8 S 40 E 23 1/2

1/8 bet S 1/4 W(5 3/4) 1955 to a STAK

W 1/8 S line N(4) 1910 to above STAK

SEC 17 - 35 9 - May 3 1894

S 1/4 P N(4) <sup>54' 3878</sup> 7765 var W 122 1/2 U 3 1/2

N 1/4 P NW tree is 27 instead of 30 links

SW COR N(3 1/2) tr lin <sup>1930</sup> 3930 to STAK

W 1/4 P E(5) <sup>4016 1/2</sup> 8156 var <sup>N</sup> 141 U 4 1/4

" " NE tree is N 12 E instead of N 22 E

E 1/4 P NW tree is 8 links instead of 10 links

CEN SEC Pine ST 20 N 1 3/4 E 20 3/4

" " " 20 S 70 3/4 E 23

1/8 bet S 1/4 Pine ST 24 N 36 1/2 E 20

" " " W(4) 4010 var N 32 U 3 25'

SW COR N 60 links to Dans random there

E cor. his random 3980. Dans 48

Dans 118 is 1990 measured not run.

Did not have field notes for SW cor:

afterwards learned that STAK was 15 links

to far south

SEC 19-35-9 NOV 29 1899

SW COR N(4) <sup>+2.32'</sup> 4572 VAR E 202 U 4 1/2

S 1/8 on W line Birch 12 N 24 W 25 2/3

SW COR E <sup>-1.21'</sup> (12) 3798 1/2 VAR N 90 U 12 2/5S 1/4 P E <sup>-1.29'</sup> (4 1/2) 3921 VAR E 101 U 5 5/5

E 1/8 S line Birch 22 N 82 1/2 E 24

W 1/4 P E (3) <sup>1822.3882 R 5.20'</sup> 7943 VAR N 117 U 4 0/5E 1/4 P S <sup>-2.26'</sup> (5) 3940 VAR 167S 1/4 P N (4) <sup>4004-5890 To Lake 6519 over Lake</sup> 8081 VAR E 149 U 5 1/6

N 1/4 P NEW SUGAR 8 N 10 1/2 W 17 3/4

CEN SEC B. Ash 10 S 33 1/2 E 18 1/2

Pine Stp - S 6 1/2 W 18

W 1/8 S line HGM 8 N 41 1/2 W 17 1/4

1/8 bet S 1/4 Spruce 4 N 36 E 29

" " W (6 3/4) 3927 VAR S 14 U 7

1/8 bet E 1/4 Cedar 12 S 7 1/2 W 27 1/2

W 1/8 S line N <sup>-3/4"</sup> (6) <sup>2142</sup> 4274 VAR E 54 1/2 U 5

1/8 bet W 1/4 HGM 12 S 54 1/2 E 10 1/2

CEN SW 1/4 Birch 8 S 71 E 22 1/2

S 1/8 on E Line Maple 10 S 84 1/4 E 15

SEC 16+21-35-9

CENT SEC Birch 11 S 89 E 20 1/2

Maple 8 S 40 E 23 1/2

1/8 bet S 1/4 W (5 3/4) 1955 to stake

W 1/8 S line N (4) 1910 to above stake

= SEC 21 =

E 1/8 S line - (4 1/2) 2000 left it

S 1/4 P S (4) 2000 " "

SEC 24-35-9 Dec 12 1904

S 1/4 P EXCS down new Hem 12 S 31 1/2 E -----

" " " N (4) <sup>417' 3890</sup> 7814 Var W 243 U 3.05

E 1/4 P Orig. steps new Bash 11 S 17 1/2 W 27 1/2

" " W (4) <sup>4488</sup> 8745 Var S 6 U 3 1/2

W 1/4 P SW TREE OK - NE TREE down

" " " NEW Tam 10 S 38 W 2

" " " 7 N 78 E 8

NE cor Two Birch ok

" " W (4) <sup>8838</sup> 8838 Var N 176 U 350

N 1/4 P gone, new Tam 4 N 84 1/2 W 17 1/2

Spruce 3 N 89 E 15

CEN' SEC Sugar 10 N 56 1/2 E 29 3/4

Birch 8 S 15 3/4 W 3.3/4

S 1/4 P W (4) 4202 Var N <sup>12</sup> 12 1/2 U 335

SW cor SW tree dead. NEW Tam 3 S 26 W 28

W 1/8 S line sugar 8 S 28 W 19

" " N (4 1/2) <sup>1.35'</sup> 3892 Var W 108 U 425

1/8 66 E S 1/4 SUGAR 7 S 23 E 18 1/2

SEC <sup>x19+25</sup> 1-39-10 Oct 18-1886

MC on S side of Lake

" " " W (4) 3750. then N 750 then ~~W~~

W (4) 4250 found nothing

SEC 19 Jan 31-1894

W 1/4 E (4 1/2) <sup>-1.40'</sup> 4176 R (4 1/2) 8133 Var N 233 1/2 U 420SW COR E (3 1/2) <sup>3978 1/2 + 2012</sup> 7912 Var S 6 U 255

S 1/4 P Cedar 7 N 75 1/2 E 19

Bash 10 S 12 1/4 W 17

S 1/4 P N (5) <sup>3966</sup> 7664 R<sup>5</sup> Var W 263 1/2 U 455

CEN SEC ASPEN 5 N 44 E 30 1/2

1/8 66 E N 1/4. 5 N 64 W 12 1/2

" " " " Pine SE P 18 N 68 1/2 E 66 1/2

" " W (1) 4993 Var N 263/4

N 1/8 W Line Spruce 7 N 83 1/2 E 21

1/8 66 E W 1/4 Pine SE 6 40 N 25 1/2 W 73/4

W 1/8 S line Hem 10 S 55 E 23 1/4

= SEC 25-39-10 =

SE cor SET TREE OK - NEW Boulders N 61 1/2 E 14 1/2

" " " center of " S 12 E 6 1/2

" " " N (5) 4021 Var W 153. U 5 1/2

S 1/4 P N (5) to Lak

" E (5) 1.50. angle N 1435 dist = 577

" N (5) 7616. Var E 700 U 425

E 1/4 P W (6) 3000 to N + S 1/4 line



SEC 15-38-10 Jan 5 1904 ✓  
 SW cor ~~N~~ Hem 20 N 20 1/2 E 10 1/2  
 " " Cedar 12 S 14 1/2 W 23  
 " " N (3 1/2) 8360 Van E 52 U 5 1/2  
 S 1/4 P 15 Hem 6 S 80 1/2 W 21 1/2  
 " " 8 S 27 E 19 3/4  
 NE cor 23 W (1 1/2) <sup>-55'</sup> 3526 Van S 56 U 2  
 N 1/4 P 23 S (16) <sup>-42' 4260</sup> 8277 Van E 100 U 16 3/4  
 S 1/4 P 23 org steps - NEW Tam 11 N 75 1/2 E 20  
 Cent. Sec 23 Spruce 6 N 77 1/2 E 21  
 Tam 3 N 8 1/4 E 18  
 1/8 bet W <sup>23</sup> marked stake in Swamp  
 " " S. Cedar 11 N 13 E 27  
 " " E. Pine 30 N 60 1/2 W 19 3/4  
 E 1/8. N line <sup>23</sup> 16 N 62 W 32 1/2  
 Mc 1000 S of N 1/4 P Hem 11 N 43 1/2 E 20  
 1/8 bet N 1/4 23 Birch 12 N 51 W 40  
 Hem 12 S 81 U 52  
 NW cor 23 15 SEE on straight line bet  
 Mc E of Lak and NW cor of 21

SEC 17-38-10 Jan 15 1908  
 Cen Sec Sec by <sup>map</sup> in Jan 1896  
 " " W (1/4) 4133 Van N 50 U 1  
 " " E (1) Van N 8 U 1/2  
 E 1/4 P Old fir steps there no marks  
 " " found old stake where fir <sup>indicated</sup>  
 " " Birch 18 S 3 E 37 1/2  
 " " Tam 18 N 28 1/2 E 47 1/2  
 1/8 bet E 1/4 Birch 7 S 55 1/2 W 24  
 " " Hem 12 N 55 1/2 E 24  
 " " S (2 1/2) 3926 Van W 30 U 1  
 W 1/4 P Stub 7 ft high org U #1 1 1/2  
 " " Birch 12 N 85 W 17 } org L  
 Elm 14 N 67 E 7 }  
 SEC cor org L: steps  
 " " Sugar 7 S 13 E 14 3/4 new U 1/2  
 " " W (1 1/2) 4309 Van S 22 1/2 U 1 1/2  
 S 1/4 P New Sugar 8 N 35 1/2 W 26 3/4  
 " " org <sup>4</sup> steps  
 E 1/8 S Line Birch 14 S 76 1/2 W 27  
 " 4 S 17 1/2 W 16 1/2  
 JUNE 10 1896  
 S 1/4 P N (5) <sup>-3.41' 3928</sup> 8706 Van W 56 1/2 U 6  
 SW cor N (3 1/2) 3836 1/2 Van W 4 U 3 1/2  
 W 1/4 P N (3 1/2) 4793 Van W 188 U 3  
 NW cor Stub org steps + Stub  
 cant on next Page

## SEE 17 cont

NW CORNER CEDAR 15 S 49 1/2 E 21 1/2

W 1/4 P E (4) <sup>4117</sup> 8302 VAN N 488 U 420

N 1/8 W line Hem 6 N 88 E 20 3/4

CEN SEC Birch 24 S 24 E 33 1/4

" 22 S 42 3/4 W 24

N 1/8 W line E (1/2) 4108 VAN S 1 1/2 U 40'

~~N 1/8 W 1/8.6 E N 1/4 Hem 14 N 61 E 30~~

SEC 19 - 38 - 10 DEC 31 1895

NE COR S (5) 8575 VAN E 290 U 505

S 1/4 P N (3) <sup>2500</sup> 8600 VAN E 7 1/2 U 255'

X E 1/4 P did not find it

" " Hem 12 S 19 W 16 1/2

" " Sugar 12 N + 9 W + 6 1/2 13 W 12 1/4

" " W ~~8050 + VAN~~ <sup>50</sup> 8100 VAN

" " W 8100 VAN S 958 U 4 3/4

S 1/4 P E (1/2) 4072 VAN N 31

CEN SEC TAMM 13 N 37 E 23

spruce 6 S 38 E 11

X E W (5) <sup>4043</sup> 8044 VAN S 958 VAN U 4 3/4

1/8 6 E N 1/4 Pine 20 S 51 E 40

" " E (1 1/2) 4050 VAN S 78 1/2 VAN 2

N 1/8 E Line Sugar 13 N 31 1/2 E 25

S 1/8 " " TAMM 4 N 44 1/2 W 25 1/4

SEE 20-38-10. Jan 6 1896

W 1/4 P E (3) <sup>+1/2</sup> 8252 <sup>4038 R 2 1/2</sup> Uan S 72 3/4 U 2.30

N 1/4 P S (3) <sup>+1 1/2</sup> 8190 <sup>3985 1/2 R 3</sup> Uan W 170 U 2.40

SW COR E (3) <sup>+1 1/2</sup> 8686 Uan S 2 15 1/2

SE " Hem. asp. Pine lying down

" " NEW Pine 13 N 88 E 47 1/2

S 1/4 P Did not find it

" " NEW Tam 8 S 80 W 19

Spruce 6 S 24 W 17

CEN SEE Birch 11 N 73 E 20

" 11 S 60 1/2 - 10

118 bet W 1/4 Spruce 10 N 33 E 58 1/2

" " N 1/4 Cedar 13 N 53 1/2 W 73/4

SEE 21-38-10- Jan 17-1907

NW COR E (2) 7293. Uan N 6.62 U 3 1/2

" " E (310) 7328 Uan S 31 U 2 1/2

N 1/4 P NEW Birch 15 N 73/4 W 173/4

" " " Hem 9 S 9 W 36

" " " S (4 1/2) 8369 Uan W 90 U 5"

S 1/4 " " Spruce 6 S 60 W 14 } ORGL

" " Tam 5 N 15 E 15 }

E 1/4 " Tam 6 N 42 W 43 } ORGL

" " " 5 N 59 E 35 }

" " W (43/4) <sup>40 75</sup> 7906 Uan S 11 U 4 1/2

W 1/4 P ORGL trees dead, we cut them down

CEN SEE Birch 11 N 10 1/2 E 29

" 15 S 83 W 32 1/2

118 bet E 1/4 Spruce 7 N 26 E 20 1/2

E 1/4 P N (11) 4230 Uan W 57 U 11 20

118 bet N 1/4 Hem 9 N 30 3/4 E 31 1/2

" " " " 12 S 26 3/4 W 14

" " " " E (3 1/2) 3871 Uan N 28 U - 3

N 1/8 E Line Sugar 15 N 78 W 39



SEC 22-15-21-22-38-10 Dec 18-1903

me on E side of Lake W(2) 19218 Uan S 160 U-7

W 1/4 P 22 N (3) 12500 Uan W 200 U 40

me W of NW cor 15 Tam N 8 1/2 W 53 <sup>4#</sup> ~~found or 91~~

... found or 9 sds .. 15 W 52 1/2 <sup>New</sup>

SW cor 23 N (14 1/2) 8578 Uan E 166 U 1305

NW .. 23 Sugar 7 N 25 W 30

Hem 7 S 47 1/2 W 22 1/2

N 1/8 line Sugar 8 S 30 E 14 3/4

W 1/4 P Tam 6 S 12 E 30 1/2 <sup>3 W 41 1/2</sup>

" 4 N 12 E 30 1/2

E 1/4 P 23 W (-1 1/2) <sup>+ 2.33'</sup> 4334 R O' 80017 Uan N 357 U 5

S 1/8 W line Hem 10 S 12 1/2 E 11

NE cor 23 W (1 1/2) <sup>55'</sup> 3536 1/2 Uan S 56 U 2

EE 11 sec 23 Spruce 6 N 77 1/2 E 21

Tam 3 N 8 1/4 E 18

1/8 bet W 1/4 marked stakes in swamp

1/8 bet S 1/4 Cedar 11 N 13 E 27

1/8 " E 1/4 Pine 30 N 60 1/2 W 19 3/4

E 1/8 on N line Sugar 16 N 62 W 32 1/2 ✓

me 1000 S of N 1/4 P Hem 11 N 43 1/2 E 20 1/3 ✓

1/8 bet N 1/4 Birch 12 N 51 W 40

Hem 12 S 81 W 52 ✓

NW cor 23 is set on straight line 66

me on E side of lake and NW cor

SEC 24-38-10- OCT 11 1902

DORA'S notes of Sec 24 38-10

~~SW cor N (4) 8048 W W 118 SW  
SW cor E (3) 52135  
N 1/4 P (5) 83 full 78 E  
DEC 6/87~~

SEC 24 38-10-11 OCT 11 1902

5  
8  
39 1/4

8

and 23

SEE 24<sup>40</sup> 38-11 152 E 6/87

SW cor N (6) 80 48 S W 17 8 N of 1/4 P

" " E (5) 40 8 f e e 27 4 N of 1/4 P

N 1/4 P S (.5<sup>1/2</sup>) 83.00 f e e 7 8 E of S 1/4 P

SE cor N (5) 39 40 f e e 23 S of 1/4 P

S 1/4 P { Birch 20 N 8 1/2 E 33

          { make 8 S 4 8 W 26

E 1/4 P west (13 1/4) 81 33 f e e 7 N

W 7/4 P Hens 24 N 29 3/4 E 26

          " 24 83 1/4 E 26 1/2

N 1/8 on west line { Hem 6 N 69 E 31 1/2

& center of S.E. { f e e 10 N 68 W 30

                          { Birch 11 N 68 W 30

1/8 bet N 1/4 Birch 12 N 51 W 40

          Hem 12 S 81 W 52

\* NW cor 23 is set on straight line 66'

me on E side of lake and NW cor

Oct 11 1902

S 1/8 on E line (Suegar) 18 N 42 1/2 W 34

" " " W (25) 40 61 f e e 5 1/2 S.

" " " W 1/4 P { Cedar 11 N 53 E 34

" " " " N (3) 42 22 f e e 44 W

N 1/8 P on west line (15) 20 60 f e e 16 S

M 1/8 N. line { Birch 11 S 68 1/4 E 17

                  { Pms 10 N 36 1/2 W 20 1/2

T Center of this section should be

3/2 links farther North

Mistake in my copy of the goat:

Field notes

~~SW cor N (4) 80 48 S W 17 8 N of 1/4 P~~

~~SW cor E (3) 40 8 f e e 27 4 N of 1/4 P~~

~~N 1/4 P S (5) 83.00 f e e 7 8 E of S 1/4 P~~

D.S.C. 6/87

SW cor 1 Nov 39 1902 Rev. 33

and 23

Sec. 24-38-10-0ct 11 1902

m

w

m

su

nu

n

w

e

s

n

e

1/8

1/8

1/8

e

m

1/8 bet 14 511 n 1 - N 51 W 40

Hem 12 S 81 W 52

NW cor 23 is set on straight line & 66'

me on E side of lake and NW cor

18/9234  
11-8-11002-8

Sec. 24-38-10-0ct 11 1902

SW cor new Hem 8 S 4 W 21 1/2

" " " N(4) 31985 Var E 19 U 4 1/2

NE cor W (2) 12294 Var S 47 1/2 U 2 3/5 of

me on E side of lake Pin 13 N 68 1/2 E 18  
" " " 13 S 37 1/2 E 39 1/4

NE cor W (2) 12794 Var S 43 1/2 U m

" " W (COURT) 7982 + 3034 = 11084 U - 68

SW cor N (GOUR) 2407 7569 = 31569

" " " + 10' 20' (4) 8106 Var E 14 7/8 U 4 1/2

NE cor W (4) 9270 Var S 309 U 3 1/2

NW cor Hem 12 S 60 1/2 W 27 1/2

" " " 14 S 29 1/2 E 23 1/2

W 1/8 N line Tam 6 S 23 W 30 1/2

N 1/4 P Birch 12 N 16 E 2 3/4

Hem 11 S 64 1/2 E 31 1/2

SW cor (+ 18') (1420) 8245 Var E 44 1/2 U 14

S 1/8 W line Hem 5 S 49 1/2 W 15

W 1/4 P Spruce 3 N 88 1/2 E 36 1/4

N 1/8 " 3 north 22

N 1/8 W line Spruce 4 N 66 1/2 W 3 3/4

SW cor N (4) 8048 S 20 W 17 1/2 SW

SW cor E (3) 82 135

N 1/4 P S (5) 82 78 E

D.S.C. 6/87

18/9234  
11-8-11002-8  
D.S.C. 6/87  
Sec 24-38-10-0ct 11 1902  
Pin 13 N 68 1/2 E 18  
Pin 13 S 37 1/2 E 39 1/4  
Pin 13 S 37 1/2 E 39 1/4  
Pin 13 S 37 1/2 E 39 1/4



SEC 31-38-10 DEC 17-1896

SWCOR E<sup>3.45'</sup>(4) 8227 Uas N 537 U 3 1/2

.. .. set red is a y Pine instead of Birch

.. .. J. Pine S 13 E instead of 3 E

W 1/4 P E<sup>+2.54</sup>(1) <sup>4082</sup>8141 Uas N 407 U

S 1/4 P Spruce 6 N 22 3/4 W 17

.. .. 6 S 20 1/2 W 19 1/2

.. .. N(5) <sup>3827 1/2 R</sup>7426 <sup>43/4</sup> Uas W 138 U 2 1/4

CEN SEC Pine 12 S 23 3/4 W 30

Spruce 8 N 3 1/2 W 19 3/4

1/8 bet W 1/4 Pine 13 S 56 1/2 E 22 1/2

.. .. S (3 3/4) 3887 Uas E 3 U 2 5/5

W 1/8 S line Pine 18 S 4 1/2 W 18 1/4

CEN SW 1/4 E (-105) 2027 Uas S 19

1/8 bet S 1/4 TAM 8 N 48 1/2 E 10

W 1/4 P N(4) 4010 Uas W 38 U 3 1/4

N 1/8 W line Pine 9 S 11 W 12 1/2

.. .. E (-5) 41 Uas S 28 1/2 U 5 1/6

1/8 bet E N 1/4 Pine 12 N 87 E 29

DEC 31 1898

1/8 bet W 1/4 E (1 1/4) 4054 Uas N 68 U <sup>13/4</sup>13 3/4

SEC 32-38-10 DEC 22/98

W 1/4 P E (1/2) <sup>4146 R 1 1/2</sup>8161 Uas 203 U 1 1/2.. .. S (4) <sup>7 1/2</sup>3676 Uas W 33 U 4 3/4

S 1/8 W line Pine 10 N 78 E 17 1/2

W 1/4 P N (4 1/4) <sup>1.20</sup>3988 Uas W 96 U 5 1/4

N 1/8 W line Pine 18 N 70 1/2 W 27

S 1/4 P N (4) <sup>3784 R 5 1/4</sup>7790 Uas W 189 U 5 3/4

CEN SEC TAM 14 N 15 E 40

.. .. 14 N 84 1/2 W 51 1/4

E 1/4 P N (3) <sup>3 1/4</sup>3994 Uas W 52 U 3 3/4

N 1/8 E line Spruce 7 S 79 1/2 W 28

Pine 12 N 22 E 30

1/8 bet N 1/4 Pine 8 S 1 W 16

S 1/8 W line E (1 1/2) 4103 Uas N 35 U 2

1/8 bet S 1/4 Pine 22 N 69 W 26

.. .. (1 1/4) 3980 Uas S 52 U 1 1/2

E 1/4 P S (2 1/2) 3926 Uas E 2 1/2 U 3 1/4

S 1/8 E line Tam 10 S 25 W 38 3/4

CEN S E 1/4 Tam 6 N 86 3/4 E 21

.. .. N (2 1/2) 1922 Uas E 16 U 3 1/6

1/8 bet E 1/4 N (3 1/6) 1980 Uas W 7 U 3 1/2

1/8 .. N 1/4 E (2 1/2) 4040 Uas N 14 U 3

SEC. 5. 37-10. Jan 11 1898

W 1/4 P E (0) <sup>+23</sup> 3820 R<sup>10'</sup> 7183 Var S 174 0 1'

S 1/4 P gone new Pine 8 S 86 4 1/2

" 20 N 18 1/2 E 10 3/4

S 1/4 P N (0) <sup>4060 R<sup>0</sup></sup> 7976 Var W 31 0 8

SW Cor E (1) 7171 Var N 67 0 1.40

SE " aspen gone. Birch, a. stub 5 ft high

Cen Sec Pine 20 N 34 1/2 W 11 3/4

Maple 9 S 26 1/2 E 22 3/4

E 1/4 P N E 8 1/2 3912 Var W 4 3/4 0 8 3/4

1/8 bet W 1/4 Pine 12 N 83 3/4 W 28 1/2

" " S (1/4) 4035 Hit it 0 1.40

W 1/8 S line 9 Pine 18 S 63 3/4 W 13 2/3

Cen S W 1/4 E (1) 1803 Var N 1.2K 0 1 1/4

1/8 bet S 1/4 Spruce 9 N 67 3/4 W 29 1/4

E 1/8 S line Tam 10 S 45 1/2 W 4 1/4

1/8 bet N 1/4 Pine 22 S 77 E 35 1/2

" " E (1/2) <sup>35'</sup> 3692 Var N 42 0 2N 1/8 on E Line ~~6~~ 6 N 26 E 30 3/4Not given  
DHU7976  
4060  
3916

SEC 6-37-10 - Jan 10 1898

N 1/4 P S (4) <sup>-1.48' 3844 R<sup>4</sup></sup> 7850 - 18 = <sup>7832</sup> 7832 Var E 247 0 4'

NW Cor S (2) 3710 Var 150 102 0 1.50

" " E (1/4) <sup>+1/2</sup> 2088 Var N 17 1/2 0 1/2W 1/4 P E (2) <sup>+4.10' 4248 R<sup>2.40'</sup></sup> 8350 + 27 = 8377 Var N 609

Cen Sec Pine 13 S 6 W 13

" 14 S 52 1/2 E 17 2/3

1/8 bet N 1/4 Pine 12 S 80 1/2 E 27

" " W (3/4) <sup>26' 2078</sup> 4182 1/2 Var E 9 1/4 0 1 2 5

1/8 bet W 1/4 Spruce 8 S 78 1/2 E 17

N 1/8 W line Stake in small round marsh

Cen NW 1/4 Hgn 12 S 88 W 8 3/4

" Sec E (-1 1/2) <sup>34'</sup> 4148 Var N 41 0 1 3/4

E 1/4 P N (3) 3984 Var W 2 1Ks 0 2.50

NE Cor W (-1/2) <sup>+1/4</sup> 4090 Var N 19 0 - 1/21/8 bet N 1/4 E (-1.20) <sup>2060</sup> 4189 Var S 1 1/2 0 - 1

1/8 " E " Pine 20 S 14 1/2 W 5 1/2 1K

1/8 " " N (2 1/2) <sup>2064</sup> 3914 Var W 45 1/2 2 3/4

E 1/8 N line Pine 20 N 51 E 17

N 1/8 E " Spruce 5 S 42 W 17 1/3

Cen N 1/4 Pine 10 S 63 1/2 W 41 3/4

3844  
7832

012

7832

3844

3988

7832  
3844  
3988  
10  
71

SECT. 37-10 OCT. 28-1895

NW COR E (4) <sup>209'</sup> 4214 8450 - 6 = 8444 VAN 6  
 W 1/4 P. ORG TREES down NEW Spruce 6 S 79 E 30 1/2  
 " " E (2) <sup>-39'</sup> 4293 - <sup>-25'</sup> 8534 <sup>R 2.16'</sup> VAN N 97 1/2 U 210  
 S 1/4 P N (4 1/2) <sup>-50'</sup> 4335 R. 410' 8423 VAN W 123 U 4 1/4

N 1/4 P (Not found new) Spruce 10 N 21 E 13 3/4  
 " " 10 N 67 E 15 3/4

W 1/8 N line Pine 10 N 53 E 25 3/4  
 Cen SEC } Pine 20 S 59 1/2 W 43  
 } Sir 8 S 13 1/4 E 37

1/8 66 E W 1/4 Pine 11 S 27 E 3 3/4  
 " " N (3) 4070 VAN E 25 U 3"

SW COR N (2 1/2) 4032 VAN W 47 U 2 1/2

W 1/4 P N (3) 4048 VAN W 48 U 2 3/4

N 1/8 W line Y Pine 14 S 86 1/2 W 3 1/2

S 1/8 " " Pine 18 N 24 3/4 W 46

N 1/4 P W (2) 2112 VAN N 11 1/2 U 2 1/4 DEC 11-1898

E 1/4 P S (3) 4032 VAN W 9 U 3 5 1/2

SE COR W (3) 4204 " S 164 U 3 1/2

E 1/8 S line N (4 1/2) 4168 VAN 34 1/2 U 2 1/2

" " " J Pine 15 S 5 1/2 W 11

S 1/8 E " " 22 N 22 3/4 E 16

CEN SEC E <sup>-1.3 1/4</sup> (1 1/2) 4231 VAN N 131 U - 40'

SECT. cont.

1/8 66 E E 1/4 Y Pine 20 S 27 W 24 1/2

CEN SEC N (3 20) 4086 VAN W 44 U 4 1/2

N 1/4 E (2) 4220 VAN N 6 U - 2

E 1/8 N Line maple 7 S 60 E 17 1/2

" " S (4) 4112 VAN E 92 1/2 U 5

CEN NE 1/4 W (-2 1/2) 2107 VAN S 13 1/2 U 2 1/2

1/8 66 E N 1/4 Tam 14 N 23 1/2 W 21

Did not have very good crew

4492  
421  
28.8

8423  
4335  
40.88

41293  
21.96



SEC. 17-37-10 Jcm 12" 1899

NW cor S (-4 1/2) 4005 var 24 U-4  
 W 1/4 P E (-1 1/4) <sup>4130 R 3.05</sup> 7650 - 9 = 7649 var S 187 U 3 1/4  
 N 1/4 P S (4) 8108 var E 338 U 2.25  
 N 1/8 W line Pine 28 N 8 1/4 W 80  
 SW cor E (0) 12000 found nothing  
 E 1/4 P S (2 3/4) 8106 var W 86 U 3 5/8  
 " " " " 4082 var W 48 U 3 10  
 SW cor E (0) 8244 " S 72 U 0  
 SE cor J Pine 14 S 51 W 107  
 W " 12 N 8 3/4 W 108

with field notes

SE E SE cor from 2 down trees that agreed

S 1/4 P Spruce 5 S 28 E 25  
 " 6 S 8 1/2 W 10 1/4  
 1/8 bet N 1/4 fir 6 S 4 1/2 E 21  
 " " W (1/4) 4178 var S 4 1/2 U 1 1/4  
 Cen NW 1/4 S (-3 1/2) 2038 var E 59 1/2 U 3  
 1/8 bet W 1/4 Pine 20 S 53 E 8  
 Had miserable help. maybe a bend in  
 E & W 1/4 line

SEC 18-37-10 - OCT 22 - 1895

W 1/4 P E (-3) <sup>+57' 3989 R 3.25'</sup> 8167 var S 135 U 3 1/2  
 " " N (5) <sup>-2.35'</sup> 4062 var W 182 U 4.40  
 SE cor N (4) 7972 var W 11.19 U 3 1/2  
 N 1/4 P S (-4 1/2) <sup>37 54 R 4 1/2</sup> 8038 var S 53  
 E 1/4 P new W Pine 10 S 1 1/2 W 25 1/2  
 did not find it " 6 S 6 1/2 E 26 3/4  
 Cen SEC marked stake in marsh  
 1/8 bet W 1/4 J Pine 10 S 27 1/2 W 32  
 " " N (-4 0) <sup>+3.18' 1948</sup> 3894 var E 224 U 4.26  
 N 1/4 P W (-6) <sup>2.18 1/2</sup> 4441 var S 5 U 6 1/4  
 N 1/8 W line J Pine 11 N 16 W 13 1/2  
 W 1/8 N line W " Sep 14 N 55 E 5  
 " " E (-4 1/4) <sup>23' 2145</sup> 4212 var N 26 U - 4 0 5  
 1/8 bet N 1/4 J Pine 10 N 58 E 14 3/4  
 E 6 11 NW 1/4 Pine 12 N 5 W 35

SEC 20-37-10 SEPT 29 1889

S $\frac{1}{4}$ P N (4 $\frac{1}{2}$ ) 8102 Uan W 75 U 4 $\frac{1}{2}$  <sup>SEP of NEW</sup>

SWCOR E (2) <sup>1.12</sup> 8291 Uan N 173 of cor

.. NE tree broken off. found org Post and <sup>SEP of NEW</sup>

S $\frac{1}{4}$ P gone NEW. OAK 6 N 74 $\frac{1}{4}$  W 15 $\frac{3}{4}$

y Pine SEP 20 S 73 $\frac{1}{2}$  W 44

W $\frac{1}{8}$ S line J. Pine 9 84 W 31

.. N 4108 - - - -

E $\frac{1}{4}$ P W (1) 6773 to a stake in swamp

2<sup>nd</sup> part of water. concluded W $\frac{1}{4}$ P could not be found, and run the on the theory that the west line of section was straight

SEC 21-37-10 SEPT 28-1899

S $\frac{1}{4}$ P N (3 $\frac{1}{2}$ ) <sup>+1.50' 4086</sup> 7991 Uan E 258 U 2 $\frac{1}{4}$

NWCOR E (0) 7475 .. N. 11 U 2 $\frac{1}{4}$

S $\frac{1}{4}$ P moved 2 lks E & 1 lks N

NWCOR org tree down

N $\frac{1}{4}$ P new } Pine stub 9 N 62 W 32 $\frac{1}{2}$

OCT 3 1899

S $\frac{1}{4}$ P E (-9 $\frac{1}{2}$ ) #3090 Uan 516 made mistake in setting verner called 80 $\frac{1}{2}$  90 $\frac{1}{2}$

SEC cor W (1 $\frac{1}{4}$ ) 3136 Uan S 16 U 50

E $\frac{1}{8}$ S line J Pine 7 N 72 $\frac{3}{4}$  W 73 $\frac{1}{4}$

SEC cor N (-10) <sup>+2.94</sup> 4022 Uan E 188

E $\frac{1}{4}$ P NEW J Pine 13 S 45 $\frac{1}{2}$  W 31

.. W (-3 $\frac{1}{4}$ ) <sup>3376</sup> 7254 Uan N 87 U 50

CEN SEC J. Pine 8 S 81 $\frac{1}{2}$  W 49 $\frac{1}{4}$

y .. 13 S 57 $\frac{1}{4}$  W 54 $\frac{3}{4}$

E $\frac{1}{8}$ S line N (4) <sup>114</sup> 4064 Uan W 18 U 43 $\frac{1}{5}$

1186 at E $\frac{1}{4}$  J Pine 7 N 54 $\frac{1}{2}$  E 20 $\frac{3}{4}$

93

and 22

SEC 28 37-10 Oct 5 1899

NW COR S (4) 8145 VAN E 148 U 4.25'

" " S (4) 4094 VAN E 17 U 43/4

Earl found ORGL STEPS + Post

W 1/4 P NEW SPRUCE 5 N 53 W 243/4

" " E (1/2) <sup>+ 31'</sup> 7137 VAN S 44 U 1/2

N 1/4 P S (3) 8022 VAN 9 22 E U (4)

S 1/4 P N 8137 <sup>4107 R 2</sup> VAN W 87 U 2 1/2

CET SEC J Pine stub 9 S 74 1/2 W 33 1/2

" " " " 9 N 44 1/2 E 33 1/4

N 1/8 W line Tam 6 N 78 7/2 E 19

" " E (-1/4) 3677 VAN S 11 U 35'

1/8 66 E N 1/4 Pine stub 12 N 4 1/2 W 50 1/4

1/8 66 E W 1/4 " " 16 S 5 E 39 1/2

" " N (23/4 to S Swamp

SEC 22

W 1/4 P. ORG Trees BTR ok other a stump

" " " E (1/2) <sup>212'</sup> 89 VAN S 264 U 3 3/4

E 1/4 P S (4) 8000 left it

" " S (4) 4074 VAN W 99

N " S (5) 8000 + left it

SEC 28 - A - D - L - E

NW COR S (4) <sup>- 5 1/2</sup> 3997 VAN E 380 U 5 1/4

" " " E (5) VAN N about 150

W 1/4 P E (5) 8000 +

This is 37-11

NE 1/4 of 36-10 94

SEC 27-10-12-13-24-36-10 DEC. 1888<sup>19</sup>

NE COR 13 W (-1 3/4) 21464 VAN S 4.08 U 205

SW " 24 N <sup>+ 35'</sup> (8 1/2) 29642 VAN E 304 U 650

SE " 1 W (-3 1/2) 21660 " N 394 " 6 1/2

SW " 23 <sup>+ 1.26</sup> N (7 1/2) 29940 " E 750 " 440

NE " 11 Birch 10 S 9 E 17 3/4

" " fir 10 N 266 243/4

NW COR 11 Tam 8 S 40647

" " " " 8 N 47630

" " " X on opposite side BTRs

SW " 11 Double ASPEN 7 N 12 3/4 W 32

" " " Jack Pine 6 S 65 E 26 3/4

" " " X on opposite side BTRs

SE " 11 W Pine 14 N 38 W 43/4

" " " " 11 N 246 13

NW COR 12 (540) 1811 VAN S 9

W 1/8 N line 12 cedar 12 S 81 E 21 1/4

NW COR 12 N (854) 1854 calculated

S 1/8 W line 1 cedar 12 N 48 W 15 1/2

NW COR 12 W (710) 1820

E 1/8 N line 11 Pine 8 N 16 E 9 3/4

N 1/8 E " " Tam 12 S 42 1/2 E 24 1/2

SEC 1. 36-10 DEC 19 1888

commenced 1/2 mile W of SE cor.

Then N (4) 7182 VAN W 218



SEC 10 36-10 March 25 1902  
 SE COR W (-10)<sup>+2.08'</sup> 7076 Van N 265  
 SW " N (3)<sup>+1.14'</sup> 4233 Van W 95 1/2 U 2 50'  
 S 1/8 W line J Pine S 73 1/2 E 21  
 " " " Boulder 12 x 18 S 3 LKS  
 W 1/8 S line J Pine 10 S 84 3/4 E 30  
 " " " " 6 N 22 E 7  
 S 1/4 P Tam 10 S 23 E 99  
 S 1/8 E line W (-9 3/4) 7163 Van N 4 U-10'  
 CENT SW 1/4 Tam 12 S 33 3/4 W 41 1/4  
 " " " S (1 3/4) 2054 Van W 7. U 140'  
 " " " may be off to far E or W  
 Did not run N & S 1/4 line

Between 8 & 17-36-10 on mile long

" 9 & 16 " " " " "

SE COR of 9 is 35 rods S of SW COR. BENNETT

SECS 2 & 11 36-10 DEC 31, 1897  
 SW COR 2 N (3 3/4) 7606 Hill U 3 1/2  
 W 1/4 P { Tam 6 S out 8  
 " " 5 N 30 1/2 E 34  
 S 1/8 W line Tam 10 N 72 W 24 3/4  
 SEC 11 =  
 SW COR N (4) 7478<sup>+2 = 7480</sup> Van W 229 U 2 1/2  
 " " " J. Pine S 65 E 27  
 " " " " 5 S 65 E 27  
 NW COR Tam 10 N 58 1/2 W 8  
 " " " 12 S 38 1/4 E 47 1/2  
 S 1/8 W line J Pine 7 S 30 1/2 E 17 3/4  
 W " S 6 12 N 34 W 13 3/4  
 " " dead 20 N 14 1/2 W 30  
 N 1/8 W line W " 18 S 20 E 4 1/2  
 S 1/4 P Tam 6 S 44 3/4 W 42 1/2  
 " " 6 S 62 W 50  
 W 8 S line Spruce 6 S 46 1/2 W 6 1/2  
 W 1/4 P W (-6)<sup>+5.47'</sup> 7196 Van S 728 U-550

SEC 19-36-10 DEC 11" 1903  
 and 20

SEC COR N (3)<sup>1.03</sup> 8182 Uan W 150 U 3"

" " Both org trees

NE COR original trees down

E 1/4 P J. Pine 4 N 6 1/2 W 48

" " Stb 20 S 13 W 57

N 1/8 E line marked staks in wet land

" " " W (3) 2000 + left it

S 1/8 " " Tam 8 N 6 1/2 W 22 3/4

" " " W (3) 2000 left it

SEC 20-36-10 DEC 14 1903

SW COR E (3) 4002 Uan S 72 U 255

S 1/4 P Pine 18 N 2 W 13 1/2 } Vaughans  
 " " " 6 S 14 W 19 1/2 }

" " " E on (4) 4202 Uan S 29

SW COR E (3)<sup>+109'</sup> 8402 Uan S 168 U 2 1/4

SE " TRGE Stb 45 feet high

" " " " 8 " "

" " NEW Spruce 6 S 16 E 34

" " Y Pine 7 N 1 W 30

" " N (2 1/2)<sup>+3.25'</sup> 3878 Uan E 228 U 150'

S 1/8 W line E (3)<sup>+21'</sup> 8284 Uan S 50 U 1 1/2

" " E " Tam 10 N 87 W 50 1/2

E 1/8 S " " 10 S 33 3/4 W 5 1/2

" " " N (5 1/4) 1938 Uan W 18 U 5"

SEE 20 36-10 cont

S 1/4 P Pine 18 N 47 W 3

15 S 13 W 3 1/2

W 1/8 S line Tam 7 S 51 W 25

" " N (2 3/4) 2009 Uan E 26 U 2"

## SEC 28 and 35-36-10

SEC 28. N 1/4 P S (4) <sup>1.04'</sup> 8400 Var E 263 U 3.05E 1/4 P S (2) <sup>2.40'</sup> 4186 Var E 195SE cor W (4) <sup>4' 8 1/2 (18)</sup> 8170 Var N 204 U 3

S 1/4 P J Pine 18 N 26 W 32

NEW " " 18 N 17 W 14 3/4

E 1/8 S line Pine 13 S 69 W 13 U 3

" " N (1) 2070 to stake X

S 1/8. E line ash 7 S 50 E 8

" " " W (6) 2050 to stake X

## SEC 35 36 10 JULY 21-1896

N 1/4 P S 6 E With Vernier on 3 1/2

" " " S (7) <sup>4130</sup> 9959

SE cor oak + Pine lying down

" " NEW Pine 7 N 8 1/2 E 7

E 1/4 P W (4) <sup>3 1/4</sup> <sup>3633</sup> 8054 Var N 252 U 3 1/2

Cent sec Pine 28 S 6 1/2 E 24

" 16 N 82 E 39

E 1/4 P E (9) 500

for balance

## S 4-35-10 - Feb 18-1889

S 1/4 P N (4) <sup>4039</sup> 7770 Var W 14 1/2 U 3.20SE cor N (3 1/2) <sup>1.05</sup> 3959 Var W 76 U 3.20E 1/4 W (5 1/2) <sup>40'</sup> <sup>4013</sup> 8228 Var S 97 U 5.20NW E (1 1/4) <sup>2.50'</sup> <sup>R. 85'</sup> 8054 Var S 396 U 2

Began 10 1/2 N of NW cor on above line.

Trees ALL gone at N cor EXCEPT Pine stp

N 1/4 P gone. NEW Tam 12 N 37 W 18 LKs

1/8 66 E S 1/4 " 12 S 10 1/2 E 14 1/2 "

" " " " " 14 S 36 1/4 E 6 "

" " " (5 1/4) 3976 Var N 23 U 6

S 1/8. E line Pine 10 N 97 2 9 1/2 W 2 3/4

7770  
4639

3731



and 7  
SEC 6 3510-G DEC 20 1899

S 1/4 P W (3) 4298 var S 242 U 2.35  
 " " " fir broken off, in upper notch  
 " " " 27 instead of 33 lks. other trees ok  
 " " " W (8 1/2) 4479 var N 13 U 8 1/4  
 SW COR N (4) 4000. found nothing

SEC 7-35-10. Feb 14 1899  
 E 1/4 P W (3) <sup>+23'</sup> 8330 <sup>R 255'</sup> var N 35 U 2  
 W 1/4 P N (4) 3918 var E 33 U 4.10  
 N 1/4 P S (4) 3445 to E + W 1/4 line  
 60 lks E of 4000 ch midway from  
 NW 1/4 P to E + W 1/4 line, W) - 5 3/4) 4434  
 var N 40 1/2 U 5 3/4  
 N 1/8 W line Tam 12 S 13 1/2 W 2 1/2

and 19  
SEC 12-35-10-Sept 4-1907  
 E 1/4 P SW COR N (3 1/2) 3945 var W 29 U 2 1/2  
 SW CO Birch 8 N 65 W 13 } org trees  
 " " 7 N 15 E 20 }

W 1/4 P Birch ok Sugar and maple gone  
 " " new Pine 15 N 15 E 34  
 " " E (3) <sup>+2.25'</sup> 8356 var N 348 U  
 E 1/4 P maple SEP 9 64 W 14 original other gone  
 new fir 8 S 57 1/2 E 45 U 5°

S 1/8 W line Spruce 8 S 67 1/2 E 18 1/3  
 fir 6 N 63 1/2 E ~~18 3/4~~ 28 3/4  
 these bearing trees marked by Sam on

SEC 19 35-10 DEC 13 1898  
 SW COR N (5) 4000 var W 392 U 5 1/2  
 " " E (1 3/4) <sup>4230</sup> 4858 <sup>2561-2297</sup> var N 40 (1.10)  
 S 1/4 N (5) 7672 var W 129 U 6.35'  
 W 1/8 S line N (2) 2000 to old pencil corner  
 Did not have field notes until I  
 was nearly done  
 center of 17 Pencil corner S (5) 3900 var E 140

103

end a little in 25

SEC 23 35.10. August 21 1900  
SURVEY of Crescent Island in Pelican Lake  
April 10<sup>th</sup> 1901

from W Point of Chicago Point plat  
N 57 E to MC on main land

MC } Birch 6 N 43 3/4 W 28 1/2  
      } Oak 18 S 41 1/2 E 50 1/2

800 to narrow ridge and thence  
S 80 W 1050 to ISLAND, and set me Post  
me E L m 6 S 85 3/4 W 43 1/2 U 5<sup>th</sup>

thence S 85 1/2 W 225

" N 80 W 300

" N 71 W 350 to end of house

this last course cuts off about 200 rods of  
Chicago Point at their house

Thence N 41 W 450 to W end of island

" S 60 E 300

" S 54 1/2 E 400

" S 79 E 569 to beginning

SEC 25-35-10. MC at NE cor Kaukauna

Lime stone 4x6x20x on top from  
which an E L m 12 S 3 E 42 1/2 feet

MC S (3 1/4) 2921 U or W 68 1/2 U 3 10

SE cor of Plat } Hem 5 S 6 E 39

SW " " " " 9 N 46 1/2 E 44 1/2

104

SEC 2<sup>000</sup> 35-10 <sup>Sept 3</sup> April 10 1907  
NW cor Brake rod set by Vanham  
His B.T.s are: Hem 28 S 17 W 121  
Sugar 11 N 67 1/2 W 127 3/4

this makes the cor 5 1/2 LKS SE. of Point  
indicated by roots of NW BT.

NW cor E (3) 3966 U or N 44 U 205' to  
Stake hole 50 LKS N of NE cor of Ed Keeler's  
field. Thence ~~(6 1/2)~~ 4250 U or S 5 1/2 U 6 1/4  
to Brake rod said by Geo. Keeler to NE cor  
Sleigh shoe for Sugar N 33 W 20  
N 114 P. Boulder 8x10x24x on top and  
bottle under it

George Keeler says he followed  
Govt blazes from NE cor of 28 west to  
the 114 P. & found two small Hemms  
marked for 114 P. Bfs in 188 saw them later

SE 26 &amp; 35-10 SEPT 7-1901

SE COR N (4) <sup>+1/4</sup> 2200 VAN E 11 FOUND NOTHING  
 BUT WOODMAN'S MARKS

FOR MC HEM 4 N 51 E 16 1/4

SE COR W (4) <sup>+3/4</sup> 4150 + 25 = 4175 VAN N 220 1/2SE " W (4) 8224 VAN N 266 U <sup>5/8</sup>SW COR N (5) <sup>+1/2</sup> 3923 VAN E 35" " N (5) 6774 " W 94 U <sup>5/8</sup>

SET MC ONE FOOT TO FAR SOUTH

E 1/8 S LINE SUGAR 5 N 8 1/4 W 13 1/2

" " " N (3/4) 2900 TO ROAD 3740 TO LAKE

AND 3050 RR TRACK

SE COR W (7) 2089 HIT IT VAN <sup>6 3/4</sup>

ANGLE AT SE COR IS 89 45'

" " " E 1/8 S LINE IS 90°

MC AT NW COR LOT 5 HEM 4 S 83 1/2 E 14

6774	6774	
COR 3250	3923	2851
<u>      </u>	<u>      </u>	<u>      </u>
3481	2851	2450
		<u>      </u>
		2401

8224

4150

4074

2037

SECS 32<sup>nd</sup> 33-35-10 AUG 25<sup>th</sup> 1896S 1/4 P 33 W (4) 4102 VAN S 154 U <sup>3</sup>

SW COR 33 NEW SUGAR 9 N 28 1/2 E 31 1/2

" " " N (4) <sup>+1.09'</sup> 3969 VAN W 79 1/2 U <sup>3 3/4</sup>S 1/4 P " N (3 1/4) <sup>+1.25'</sup> 3986 8017 VAN E 198 U <sup>2 3/4</sup>SE COR 32 W (3) 4125 VAN N 26 1/2 U <sup>2 3/4</sup>NE " " W (3) 3952 VAN N 51 U <sup>3 1/4</sup>NW " 33 W (4) 3998 " N 102 U <sup>3 1/2</sup>S 1/4 P 32 N (3) <sup>+1.11'</sup> 3831 7882 VAN W 129 U <sup>3 25'</sup>W " " 33 E (2 1/2) <sup>-1.35'</sup> 3992 8108 VAN N 172 U <sup>2 3/4</sup>" " " 33 W (3) <sup>+1.35'</sup> 8025 VAN N 222 U <sup>2 50'</sup>

W 1/4 P 32 NEW SUGAR 9 S 59 1/4 W 45 1/2

CEN SEC 32 SPRUCE 8 N 46 E 37

" " " 7 N 79 W 17 1/2

1/8 BET E 1/4 32 PINE 12 N 7 1/4 W 40 1/2

S 1/8 E LINE " SUGAR 12 N 21 W 8

CEN SEC 33 HEM 8 S 67 W 15 1/2

" " " BIRCH 14 S 19 3/4 W 28

1/8 BET W 1/4 33 HEM 9 S 12 1/4 W 18 1/2

" " " " S (3/4) 3977 VAN W 26 U <sup>3</sup>

W 1/8 S LINE 33 HEM 7 S 82 1/2 E 17

1/8 BET W 1/4 N (4/4) 4012 VAN E 30 U <sup>3.50</sup>

W 1/8 N LINE TAMM 11 N 11 W 19

CEN N W 1/4 E (1) 20.00 VAN S 25 U <sup>1</sup>

CONT: ON NEXT PAGE



## SECS 32 + 33. 35-10 cont

- 1/8 6 E N 1/4 <sup>33</sup> Cedar 10 S 12 W 36  
 1/8 .. E 1/4 32 S (2 3/4, 3903 Van E 11 U 2 5/8  
 E 1/8. S line .. Pm step 22 S 8 1/2 W 22 3/4  
 1/8 6 E. 1/4 N <sup>32</sup> (3 3/4) 4020 Van W 16 U 5 1/2  
 W 1/8. N line Pm 12 N 5 3/4 E 16  
 Cent S E 1/4 32 E (3 1/4) 2055 Van S 2 1/2

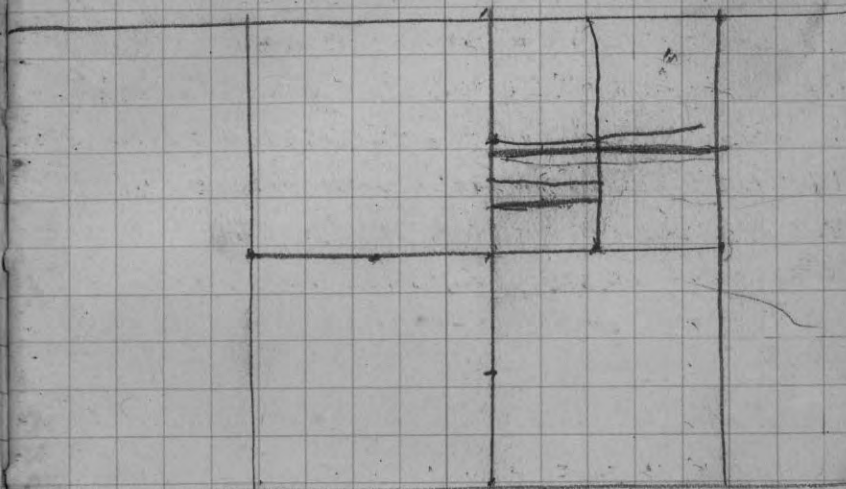

8224 )

$$\begin{array}{r}
 573 \\
 \underline{266} \\
 3438 \\
 3438 \\
 \underline{1146} \\
 152418 \\
 \underline{82244} \\
 70178 \\
 \underline{65732} \\
 43360 \\
 \underline{41120} \\
 22400
 \end{array}$$

40  
150  
5.50

(1,852  
6  
249.12

Change 1.50

Rem E on 530