

A. J. LYTLE
Rhineland, Wisconsin.

19

A. J. LYTLE # 19

1.
Land Examinations for Quincy County

Date July 24 - 1928

Examiner A. J. LITTLE

Sec. 23 Tp. 36 N R. 8 E

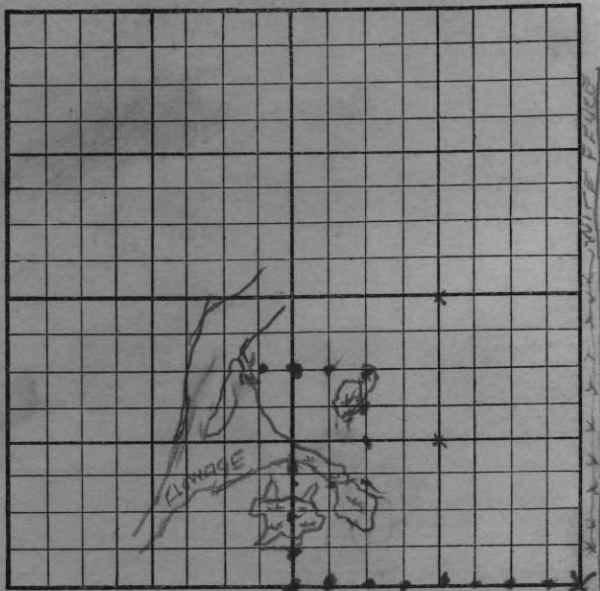

FORM 12 R

H. NIEDECKEN COMPANY, MFG. STATIONERS, MILWAUKEE

By order of the District Attorney

3

Land Examinations -----

Date Oct-14-1928 -----

Examiner A. S. LYTHE -----

Sec. 25-30 Tp. 37 R. 9 & 10

FORM 12 R

H. NIEDECKEN COMPANY, MFG. STATIONERS, MILWAUKEE

Got - lot 7 - sec 25 - 37 - 9 - 15 acre
" - " 5 - " 30 - 37 - 10 - 9 1/100 "

3677 @ 500 per 18,385
696 " 200 " 1,392
500
20,277.00

Bldgs = 10,000
30,277

1100

290	290	4
337.5	50	
50	337	1100
677.5	577	577
1100		1677
<u>1777</u>		

1777
1900
<u>3677</u>
500
18,385.00
1,392
<u>19,777</u>
500
<u>20,277</u>

242
200
250
<u>1100</u>
1792
1400

696
2
1392

2/1100

1777	-	500	-	696	=	2
1900	@	500				
<u>20777</u>						
5						
<u>103895</u>						

Lot 7 B. Boardbury
1001 - East Jefferson St
Detroit, Mich

Land Examinations Mrs. Sumner

Date 11-26-1927

Examiner A. J. Little

Sec. 12 Tp. 38 R. 5 E

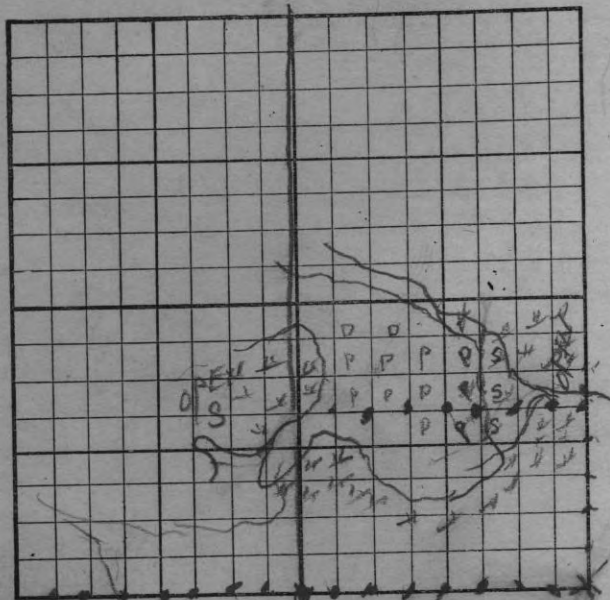

FORM 12 R

H. NIEDECKEN COMPANY, MFG. STATIONERS, MILWAUKEE

Land Examinations

John Owens

Date

June 14 - 1929

Examiner

A. F. Lytle Jr

Sec.

11

Tp.

36

R.

9E

2624

3° W

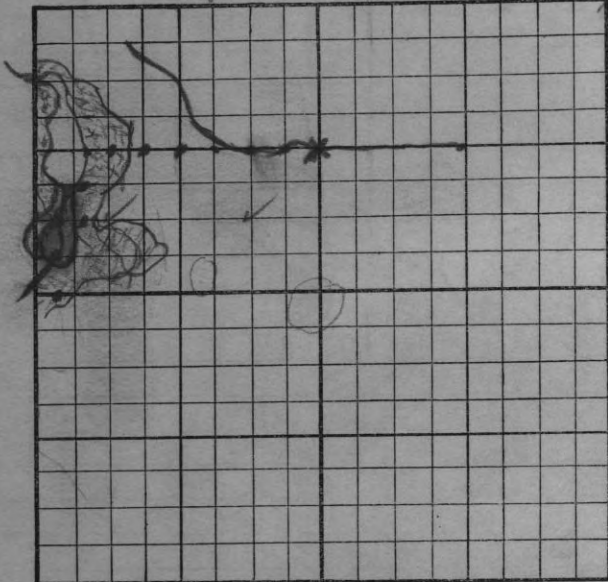

FORM 12 R

H. NIEDECKEN COMPANY, MFG. STATIONERS, MILWAUKEE

Land Examinations

Date Sept. 17-192

Examiner _____

Sec. _____ Tp. _____ R. _____

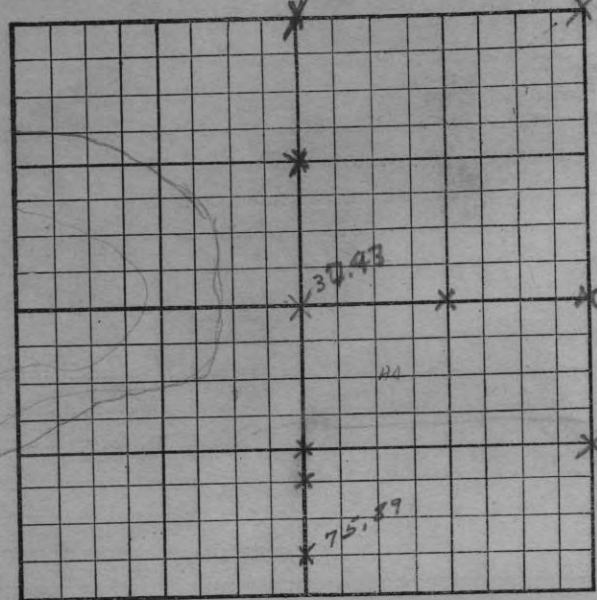

FORM 12 R

H. NIEDECKEN COMPANY, MFG. STATIONERS, MILWAUKEE

~~5° 30' North~~

$\frac{1}{4}$ Post - 4° S. ON $\frac{1}{4}$ LINE - 75.85

$\frac{1}{4}$ Post - $3\frac{1}{2}^\circ$ W. ON $\frac{1}{4}$ LINE - 36.47

$\frac{1}{4}$ Post - 3° S ON Sec. LINE -
21.27 - $\frac{1}{8}$ Post.

$2 \overline{) 75.85} \overline{) 37.93}$

37.93

40.00

2.07

set back 2.07

11
Land Examinations.....

Date.....

Examiner.....

Sec.

Tp.

R.

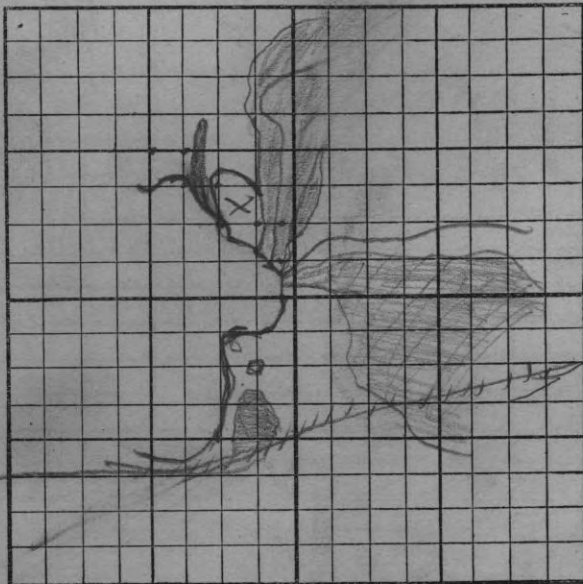

FORM 12 R

H. NIEDECKEN COMPANY, MFG. STATIONERS, MILWAUKEE

12

1st
 Land Examinations WIS-TRUST Co-MILWAUKEE
 Date JUNE-20-1930
 Examiner A. J. LITTLE SR.
 Sec. 15 Tp. 37 N. R. 7 E.

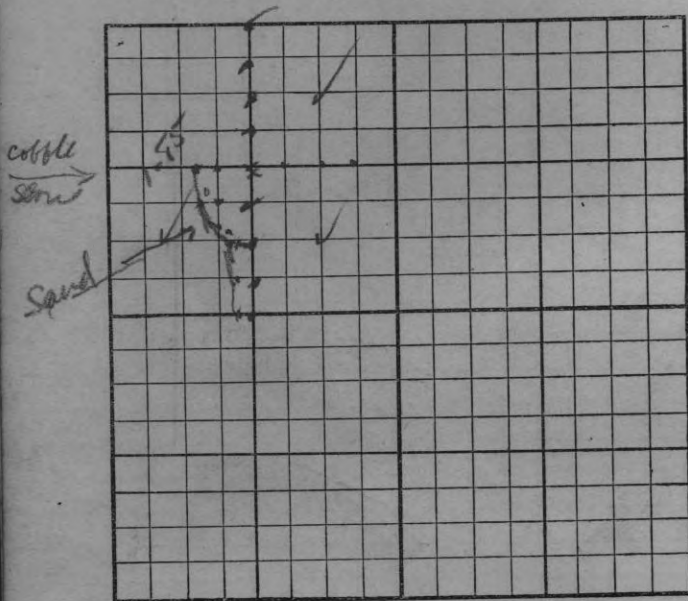

FORM 12 R

H. NIEDECKEN COMPANY, MFG. STATIONERS, MILWAUKEE

Gov-Ent-2-4 NE 1/4-NW 1/4.

1-85 to Castle on N-L
 at -2 tallies S - was 75 steps
 west of Road - at 2 tallies S
 was 125 steps W-Road

Land Examinations.....

Date.....

Examiner *A. J. Rustle*.....

Sec. *21* Tp. *37* R. *8*.....

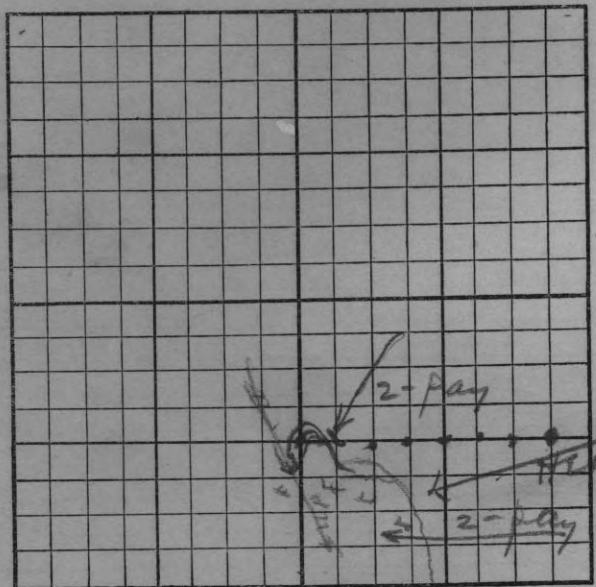

17

May 20th made reconnaissance survey

Land Examinations

Date ^{started} May - 21 - 31

Examiner W. A. H. H. H.

Sec. 9 Tp. 39 R. 11 E

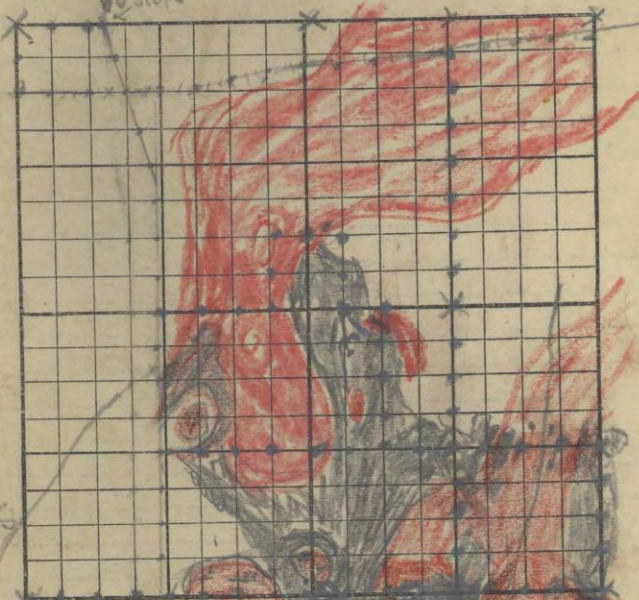

7000

FORM 12 R

H. M. BECKEN COMPANY, INC., STATIONERS, MILWAUKEE

W. A. H. H. H.

Road S 25° E

4 tally of 75 - S 25° W

S-5-tally's were made

S-edge of SW-SE - few *Hemlock* trees

S-edge of SE-SE - few trees scolded

5018
82
194

38
2.5
190
76
95.0

Land Examinations

Date 5-22 - started in ch.

Examiner W. A. & R. L.

Sec. 10 Tp. 37 R. 11 E

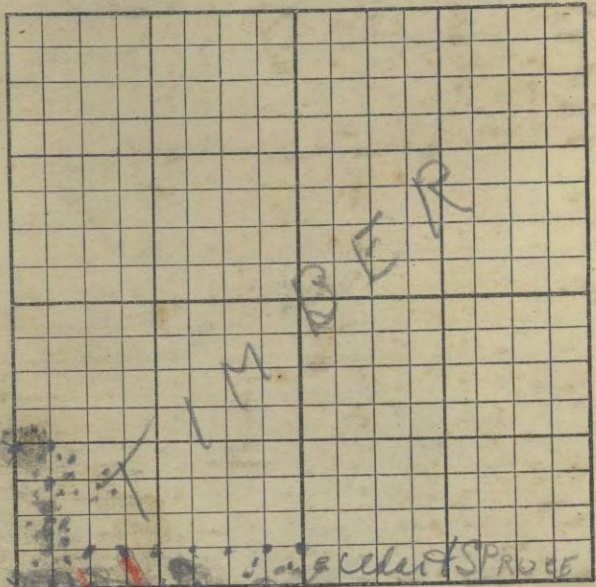

FORM 12 R

H. NIEDECKEN COMPANY, MFG. STATIONERS, MILWAUKEE

west side of SW-SW
damage to green timber very small
most all fire in old slashings

Land Examinations

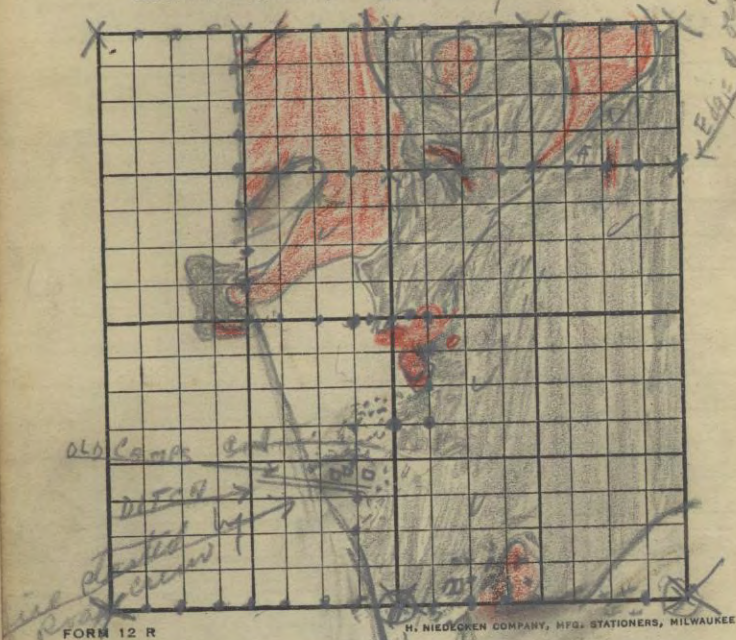
Date Started May 23-31Examiner Ryle & WaiteSec. 16 Tp. 37 R. 11

lands Phil claims dangerous up for

NE-NE

SE-NE

SW-NE

SE-NW

E $\frac{1}{2}$ -NE-SWall of the SE $\frac{1}{4}$

rec-16-37-11E

a few trees of Pulp SE cor of NE-NE +
damaged - NE cor of SW-NE

some pulp timber on E of W 48 line
between NE-NE, SE-NE. not damaged
No timber
S. line of 16-1 tally 115 steps long

some trees 16-1 tally 115 steps long

about 3000000

Land Examinations

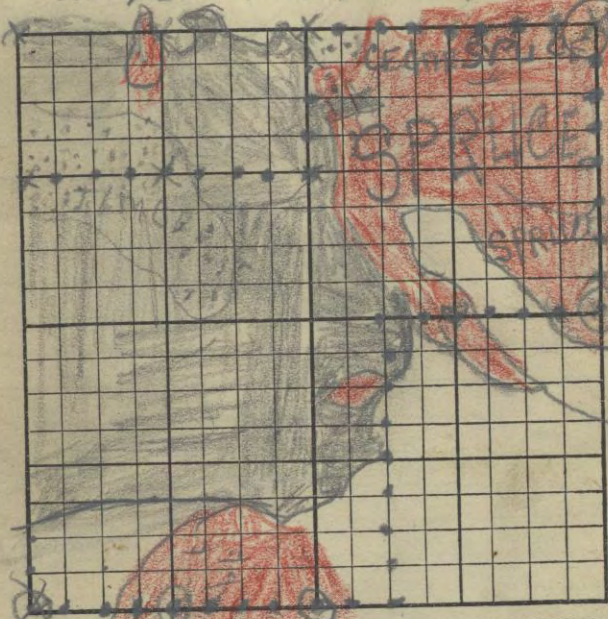
Date dated MAY 23-31Examiner Rytle + WarteSec. 15 Tp. 37 R. 11

FORM 12 R

M. NIEDECKEN COMPANY, MFG. STATIONERS, MILWAUKEE

Road - Phiel claims damage upon
 NW-NW } REC-15-37-11 E.
 SW-NW }

NW-NW - ground fire spotted
 in timber. Grace +
 no damage

SW-NW 11

about 350 acres burned
 near

Land Examinations

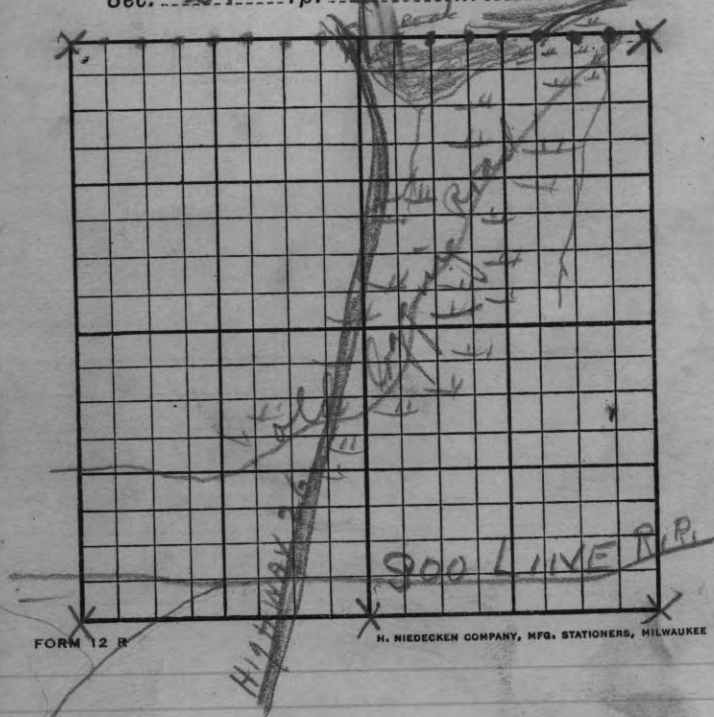
Date started May 25th 31Examiner Walter H. LytleSec. 21 Tp. 37 R. 11 ENE cor, post cut off piece with
iron marks on ground 6x6 postHamlock 16-51⁰E 9 steps

Put in new stake

15 acres

$$\begin{array}{r} 25 \\ 6 \\ \hline 15.0 \end{array}$$

Land Examinations

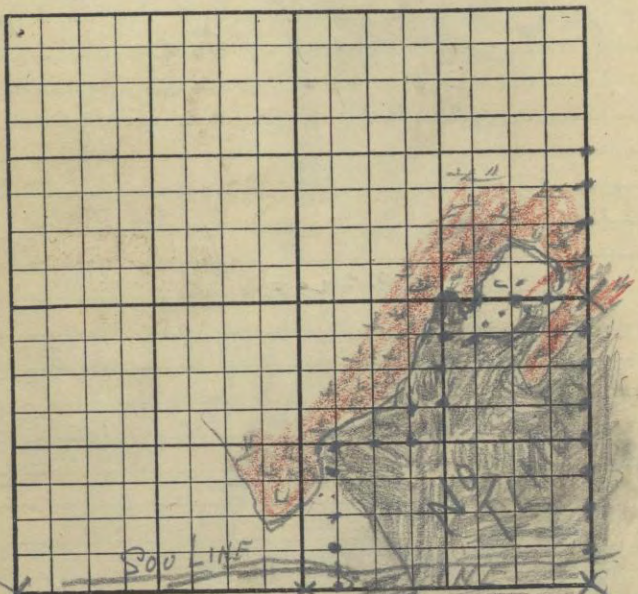
Date May 26th 1931Examiner Waite & LytleSec. 22 Tp. 37 R. 11E

FORM 12 R

H. NISBEEKER COMPANY, MFG. STATIONERS, MILWAUKEE

Been an old fire many
years ago burned over
East side of 22
no timber to damage
fire evidence shows it to
have come from the south
and south East

107 acres

$$\begin{array}{r} 35 \\ 25 \\ \hline 10 \\ 10 \\ \hline 20 \\ 20 \\ \hline 40 \end{array}$$

Land Examinations

Date MAY 27th 1931

Examiner Lytle & White

Sec. 23 Tp. 37 R. 11

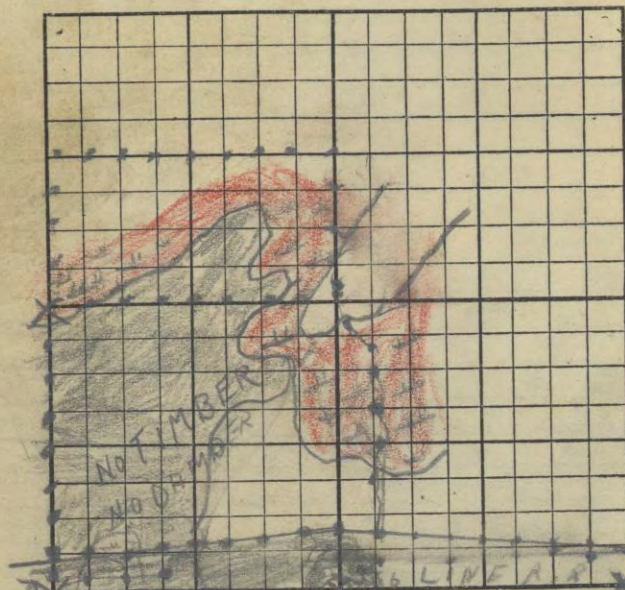

FORM 12 R

H. BIEDECKEN COMPANY, MFG. STATIONERS, MILWAUKEE

110 steps N 9 SEC, CN

26 25
 □ □
 Canyon

all high ground had been burned
 new grass ~~was~~ thin last fire - leaving
 nothing but brush to burn this time

44578

~~11450~~ 14

114

1111	51
1111	25
	<u>256</u>
	0.07
	<u>127.5</u>

250 acres

Land Examinations

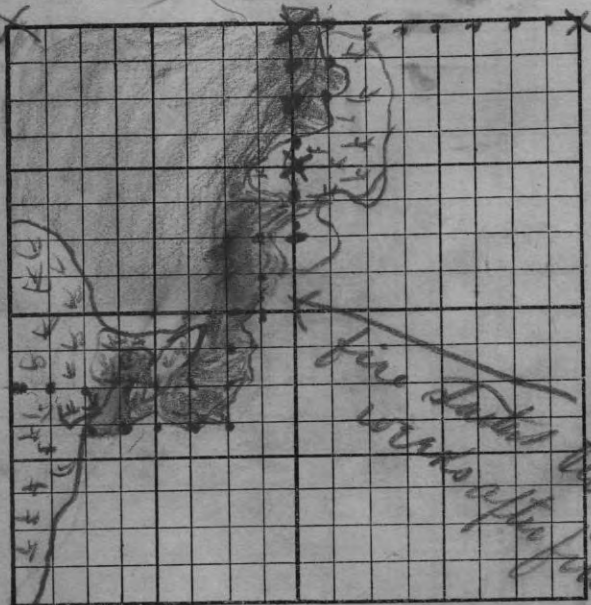
Date May 27-31 & June 1stExaminer Leslie H. W. ...Sec. 26 Tp. 37 R. 11

FORM 12 R

H. NIEDECKEN COMPANY, MFG. STATIONERS, MILWAUKEE

SE-NW - some old tie timbers
 on site not damaged
 at two or three years old
 12 pieces 8 ft long

SE-NW -

←
 ...

Land Examinations

Date

May 28-31 + June 2nd 81

Examiner

Kyrle Swartz

Sec. 27

Tp. 37

R. 11

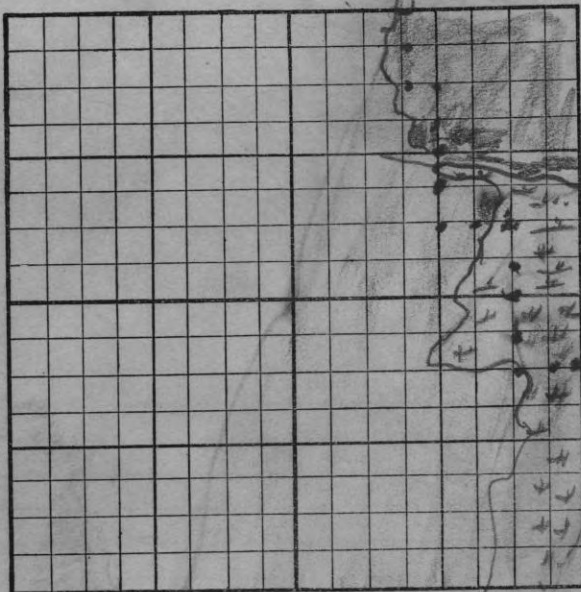

FORM 12 R

H. NIEDECKEN COMPANY, MFG. STATIONERS, MILWAUKEE

300 acres

Land Examinations

Date May 29 - 31 + June 3rd

Examiner Walter Klytle

Sec. 33 Tp. 37 R. 11

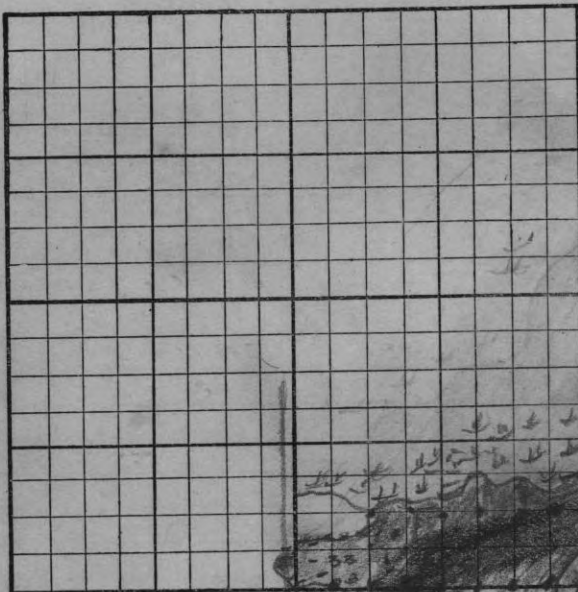

FORM 12 R

H. NIEDERMEYER & SONS - MFG. STATIONERS, MILWAUKEE

Highway
 2006
 evidence
 show started here

nothing but brush to
 burn - old burning

NW-NW - sec-21
 Heiman NE-NW - sec-2 } 31-11
 for gas + oil

Land Examinations

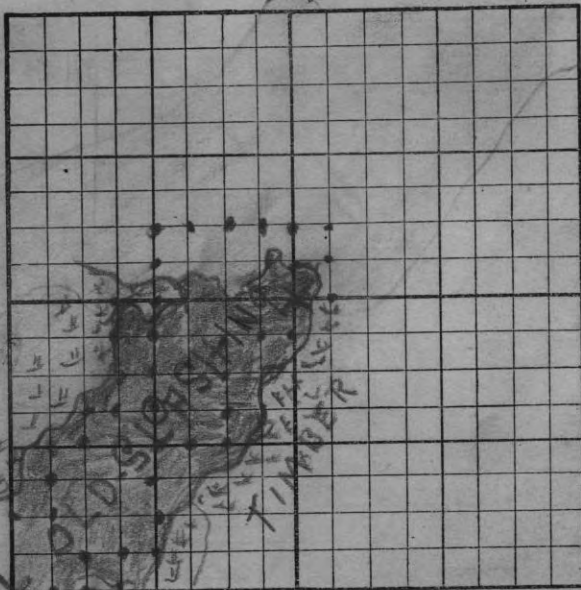
Date May 29th - June 3rd '21Examiner Walter HustleSec. 34 Tp. 37 R. 11

FORM 12 R

H. NIEDECKEN COMPANY, MFG. STATIONERS, MILWAUKEE

East $\frac{1}{2}$ of SW $\frac{1}{4}$ some
small trees damaged

2 10

1 00

3 00

1 00

2 00

1 00

1 00

3 00

3 00

3 00

3 00

10 50

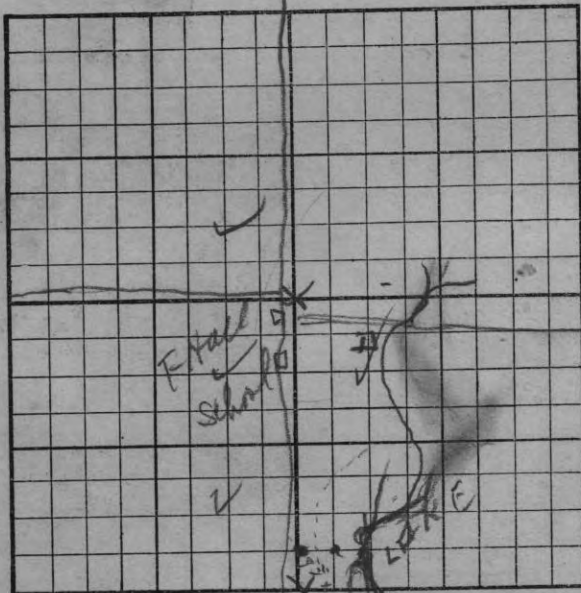
Land Examinations Mason-Mullen & HelenDate July 2 - 1931Examiner A. J. Lytle SrSec. 28 Tp. 43N R. 2-W

FORM 12 R

H. NIEDECKER COMPANY, MFG. STATIONERS, MILWAUKEE

Jordan Lake
 Emma Brodus

20 rds N on 1/4 line
 want E 1 tally 8 116 steps to Lake
 S-50 steps to edge of fire

Lake - below average
 dark water - dark bottom

4 birch trees 200 ft

37- Haulock average 18 in on stump

$$\begin{array}{r} 2 \overline{) 43560} \\ \underline{21780} \\ 21780 \\ \underline{3300} \\ 4 \text{ - ch} \end{array}$$

$$\begin{array}{r} 133 \\ 8 \overline{) 116} \\ \underline{8} \\ 36 \\ \underline{32} \\ 4 \end{array}$$

+7

$$\begin{array}{r} 4 \overline{) 43560} \\ \underline{10890} \end{array}$$

$$\begin{array}{r} 66 \\ 4 \\ \hline 264 \end{array}$$

$$\begin{array}{r} 264 \\ 70 \\ \hline 18480 \end{array}$$

$$\begin{array}{r} 55440 \\ 3 \\ \hline \end{array}$$

$$\begin{array}{r} 37 \\ 1850 \\ \hline 7250 \end{array}$$

41

Land Examinations

Vogel

Date

Sept 2 - 1931

Examiner

Sec. 19-20 Tp. 39 R. 9

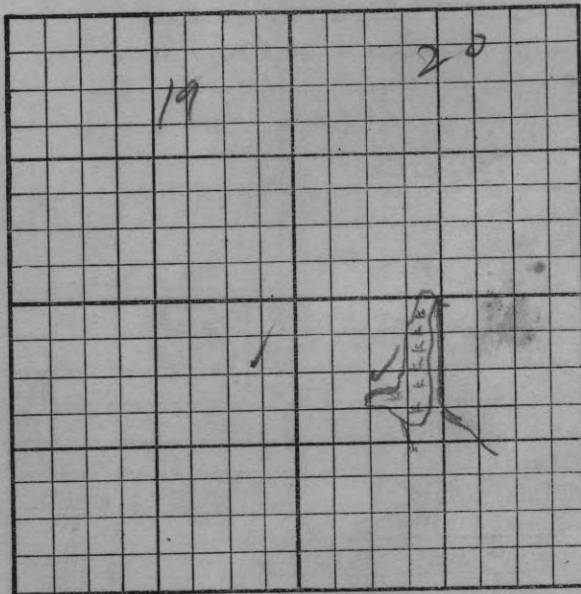

FORM 12 R

H. NIEDECKEN COMPANY, MFG. STATIONERS, MILWAUKEE

42

Land Examinations

Date

Examiner

Sec. 11

Tp. 37

R. 7

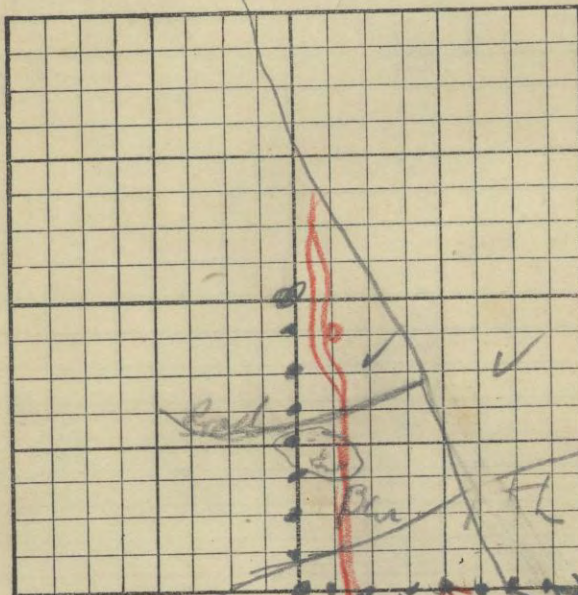

FORM 12 R

H. NIEBECKER COMPANY, PLO. STATIONERS, MILWAUKEE.

5- tallies to 75 steps
 from 1/4 post between
 sec 14-11 east to Road

3 paces here

Land Examinations.....

Date.....

Examiner.....

Sec. 14 Tp. 37 R. 7

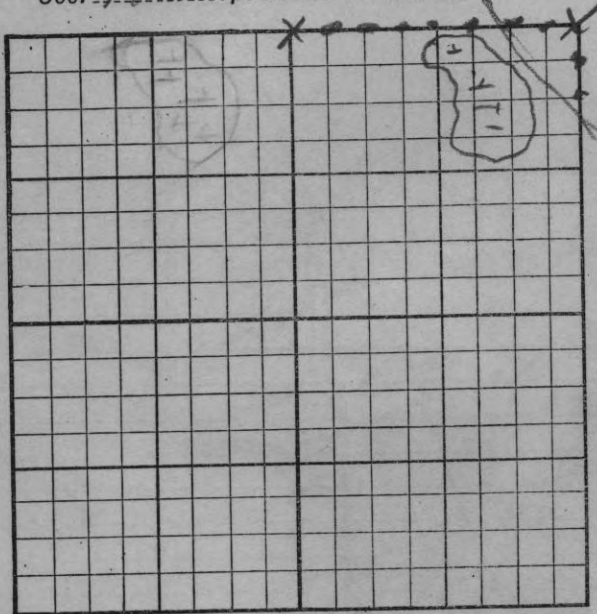

FORM 12 R

H. NIEDECKEN COMPANY, MFG. STATIONERS, MILWAUKEE

Land Examinations

Date

June 3-1932

Examiner

Milton Muller & Milton - Phil

Sec. 15

Tp. 37

R. 11

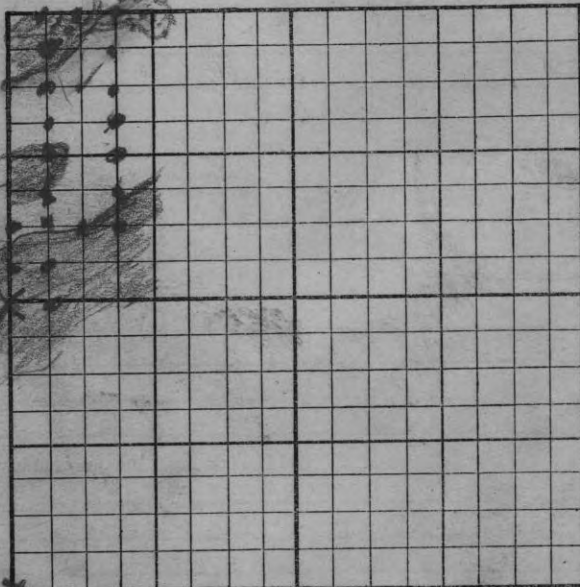

FORM 12 R

H. NIEDECKEN COMPANY, MFG. STATIONERS, MILWAUKEE

N-W; NW-SW-NW.

gp located at 9:00 P.M. at Rec Cor. between

15-16-21-22-

NW-NW

Birch - 2000

Maple - 2000

Hem - 1000

Birch TIES - 50

cordwood - 15

10 acres burned over 6/3-32

30 . green

SW-NW=

Birch 8000

Hem 2000

cordwood - 10

Birch TIES - 35

6/3, 32

25 acres burned over

15 acres green

Land Examinations June 3 1932

Date June 3 1932

Examiner Nelson-Muller Nelson - Phil

Sec. 16 Tp. 37 R. 17

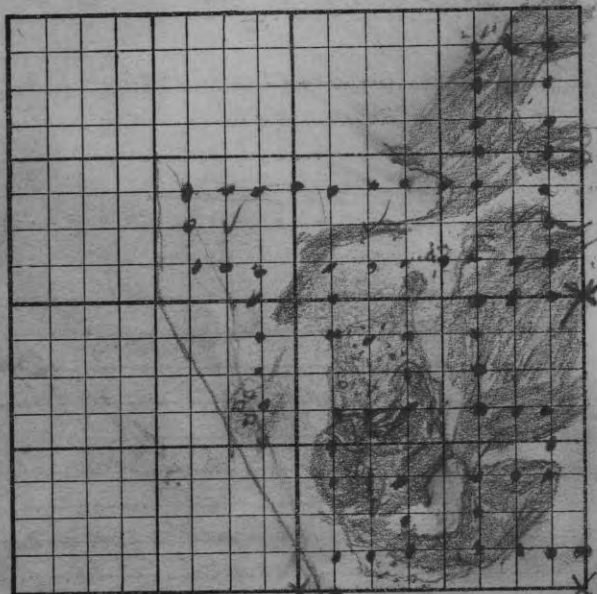

FORM 12 R

H. NIEDECKEN COMPANY, MFG. STATIONERS, MILWAUKEE

NE-NE - Birch - 20M - HEM - 5M - MAPLE 5M 30M
 6/4-32 Cordwood 30 - Maple Birch TIES 25

SE-NE - Birch 10M - MAPLE - 10M - HEM - 3M - Balsa 400
 6/4-32 1200M Cordwood - 20 - TIES - 25

SE-NW - No. Damage 6/4-32

E $\frac{1}{2}$ NE-SW $\frac{1}{4}$ Birch 3M 4M
 Hemlock - 1M
 Cord of wood - 10

-SE-SE - 41 logs - white Birch - 2M
 10 - Hem - 700ft.
 Birds 7000
 HEM - 2200 3 - cedar poles - 5-25
 Piles - 3-2585 Balsam pulp - 2 cdo.
 " - 1-3046 Birch - 9 - logs - 1-M
 " - 8-2585 Cordwood - 10 cdo.
 " Prot - 57 cedar pole - 6-30
 Balsam - 25 cdo " proto - 7
 Cd. Wood - 10 BIRCH - 45 trees 4M
 HEM - 1500ft
 9200 8 - Cedar poles - 5-25
 50 - Cd - Prot 6/3-32
 Balsam - 18

Birch 7000 HEM - 3000 - 10 - Cd. wood
 NE-SE - 6/3-32
 10M Balsam pulp 15 cdo.
 TIES 50 10 - Cd. Cordwood

SW-SE Birch - 10000 6/4-32
 HEM - 2000
 34M Black Ash - 2000 10A. Queen
 Maple Birch TIES 50 30A. Birch
 Cordwood - 15

NW-SE - Birch - 12M 6/4-32
 HEM - 5M 30 cdo. wood
 11M ELM - 2M 25 - TIES. Hardwood

SW-NE - Birch 3M - MAPLE 3M Hem 1M
 11M " "

Land Examinations

Date

Examiner

Sec.

Tp.

R.

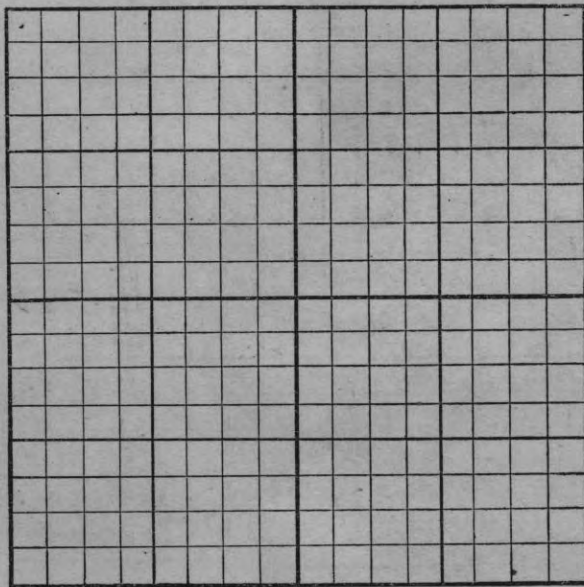

FORM 12 R

H. NIEDECKEN COMPANY, MFG. STATIONERS, MILWAUKEE

674 length
35 1/4 width

SE-SE

BIRCH	HEM	POLES	POSTS	PULP	PRIME	CL wood
						7 9200
						22 10
						10 14
						14 14
						14 7
						7 30
						30 23400
						4 40
						5 5
						10 10
						<u>108,200 M</u>

150 do-wood

4000
131,600

 135,600
57

50

50

25

25

25

50

35

260

35
260 lbs

Land Examinations

Date

Examiner

Sec.

Tp.

R.

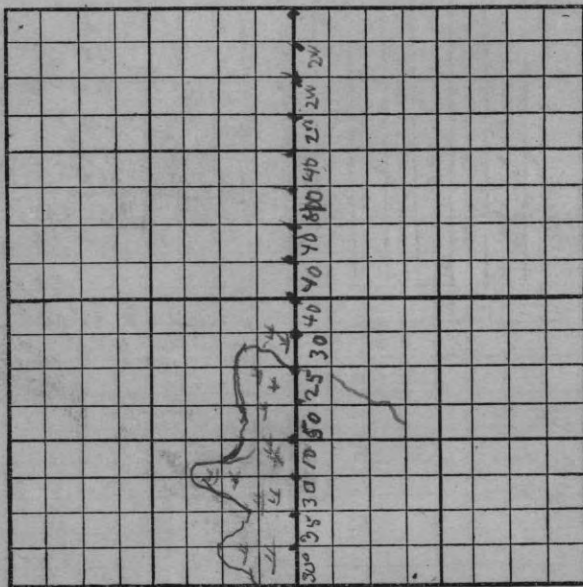

FORM 12 R

H. NIEDECKEN COMPANY, MFG. STATIONERS, MILWAUKEE

302E

REV. 16

SE-SE

Land Examinations

Date

Examiner

Sec. 18 Tp. 34 R. 10

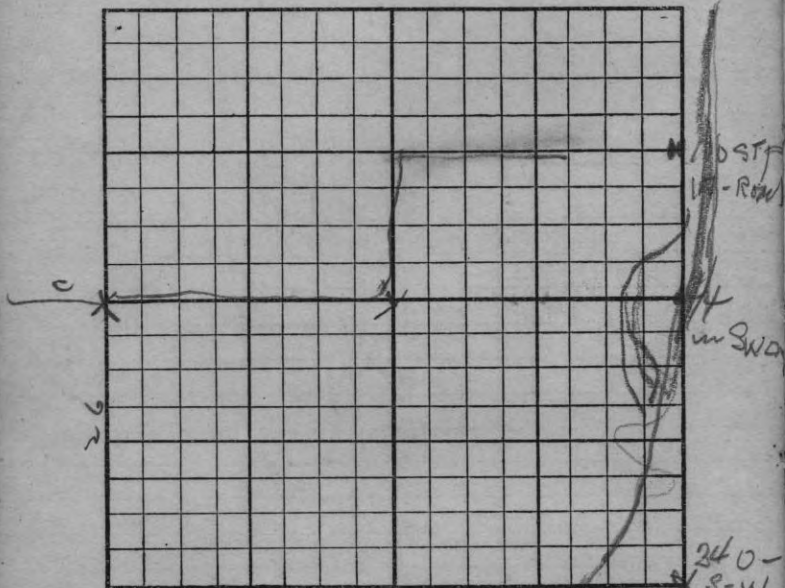

FORM 12 R

H. NIEDECKEN COMPANY, MEG. STATIONERS, MILWAUKEE

$$\begin{array}{r|l} 12 & 7.9.0 \\ \hline & 72 \\ \hline & 70 \end{array} \bigg| 6.5$$

$$\begin{array}{r} 7.9 \\ \hline 11 \\ \hline 7.9 \\ \hline 7.9 \\ \hline 12 & 86.9 \\ & 844 \\ \hline & 29 \\ & 24 \\ \hline & 5 \end{array} \bigg| 7.2.5$$

Land Examinations

Date

Examiner

Sec.

Tp.

R.

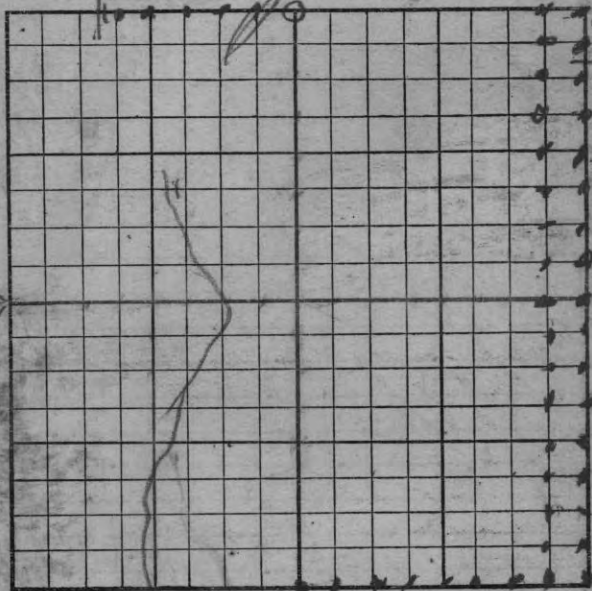

FORM 12 R

H. NIEDECKEN COMPANY, MFG. STATIONERS, MILWAUKEE

Jim Vefik

N $\frac{1}{2}$ -SE-31-35-10S $\frac{1}{2}$ -SE-31-State & County

Was. Deacons Hospital 58
 E.W. White & Thos White wife
 S $\frac{1}{2}$ -SW-32

Ben Alchaffan - Tomstark

{ N $\frac{1}{2}$ -SW
 { SE-NW

Pain Str. G. Ashkrah

SE-NW

N $\frac{1}{2}$ -NW - Harvey Whittles

{ N $\frac{1}{4}$
 { NE-SE J.A. Yarden

NW-SE } State Bank
 S $\frac{1}{2}$ -SE } Acosta Falls, W.

Land Examinations

Date

Examiner

Sec. 12 Tp. 34N R. 9E

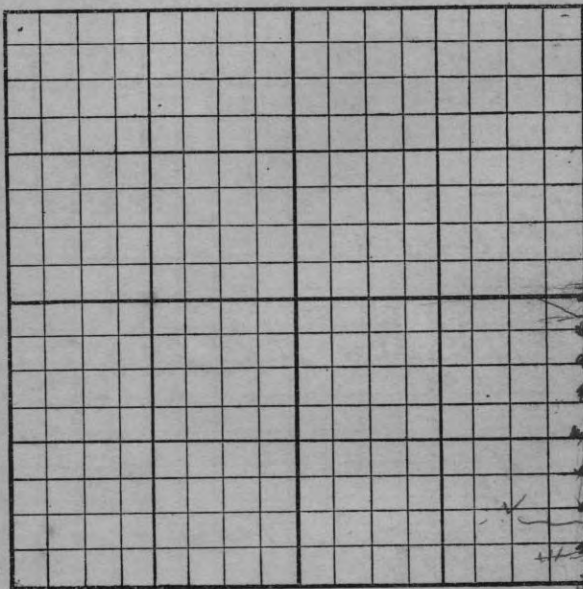

FORM 12 R

H. NIEDECKEN COMPANY, MFG. STATIONERS, MILWAUKEE

1/4 Pt between 12-7 on Range line between
 Ranges 9+10
 Cedar 10 N 60 W 20
 " 8 S 30 E 10

17

sec-crs between 12-13-7-18 on Range line
 between Ranges 9+10-

Hem 8 S 10 E 31

" 9 S 20 W 25

" 7 N 62 W 17

" 7 N 70 E 10

1/4 cr between sec. 12+13 - 3.4-9
 Spruce 8 S 35 W 16
 Cedar 4 S 25 E 13

Sec-crs on Range line between sec: 12+6-7

Pine 10 S 10 W 16

Aspen 9 N 80 W 18

PIKE 12 N 80 E 8

ASPEN 9 S 40 E 12

61

Land Examinations EEW 915
 Date 2-7-34
 Examiner A. J. Hill
 Sec. 7 Tp. 34 R. 10E

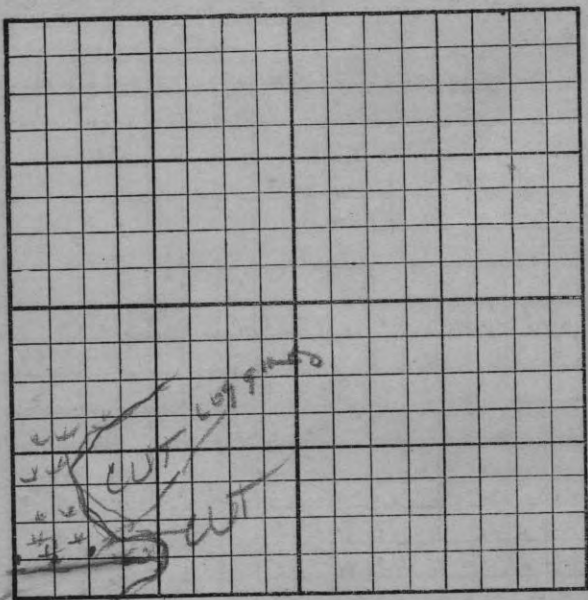

FORM 12 R

H. NIEDECKEN COMPANY, MFG. STATIONERS, MILWAUKEE

Poles	Pat	Pulp 62
40	150	10
60	75	20
150	1200	120
70	<u>1425</u>	<u>150</u>
<u>320</u>		

Land Examinations

Date

Examiner

A. J. LITTLE

Sec.

1

Tp.

36

R.

4 E

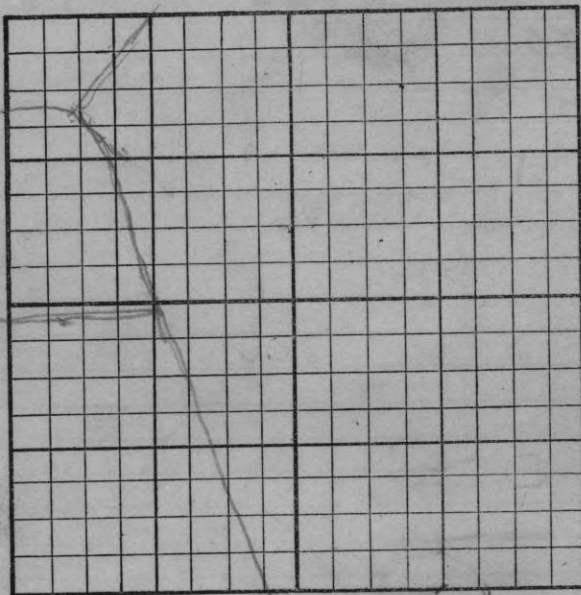

FORM 12 R

H. NIEDECKEN COMPANY, MFG. STATIONERS, MILWAUKEE

3 1/2 A
4 1/2 A

Land Examinations.....

Date.....

Examiner.....

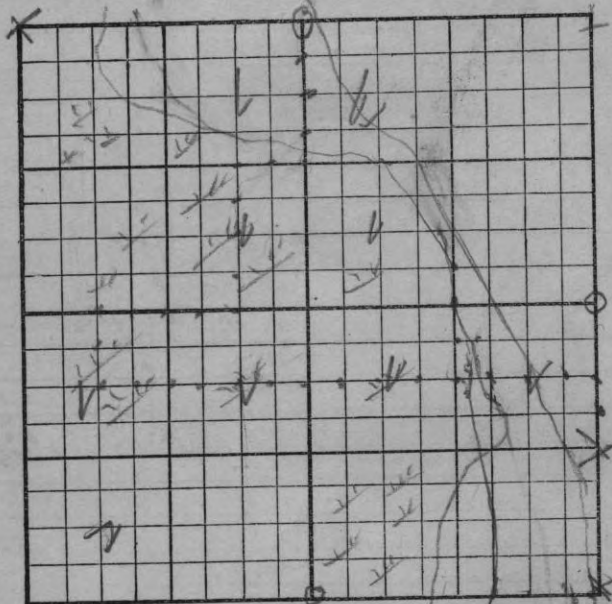
Sec. 20 Tp. 33^N R. 10^E

FORM 12 R

H. NIEDECKEN COMPANY, MFG. STATIONERS, MILWAUKEE

NE $\frac{1}{4}$ - SE $\frac{1}{4}$ - scattered Culleralt
 matas hemlock, yellow Birch
 & maples - SW of Cedar sp. ths -
 scattered - some matas sp. + bal -
 some matas ash.

Land Examinations FCW-91-S
 Date 2/9-1936
 Examiner A. J. LITTLE - ENGR.
 Sec. 3 Tp. 34 R. 12

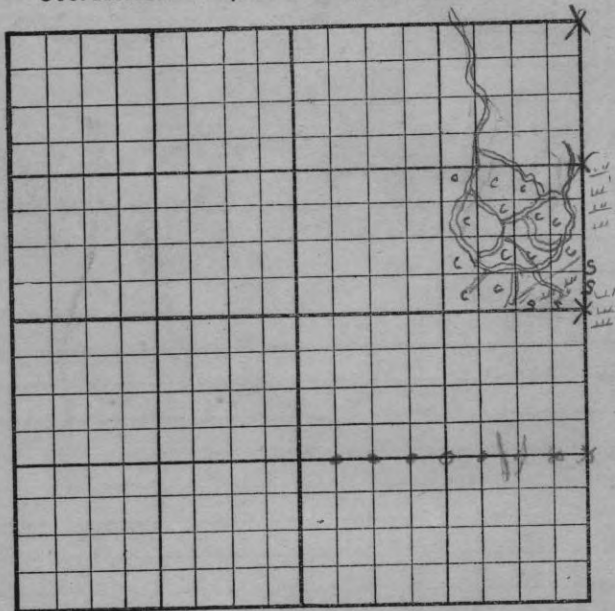

FORM 12 R

H. NIEDECKEN COMPANY, MFG. STATIONERS, MILWAUKEE

350-
 93-6
 605- Camp
 614-32

Land Examinations F.R.W.Date 4/30-1936Examiner A.J. LITTLE + James RobertsSec. 21 Tp. 33N R. 11E

LANGLADE-COUNTY WIS

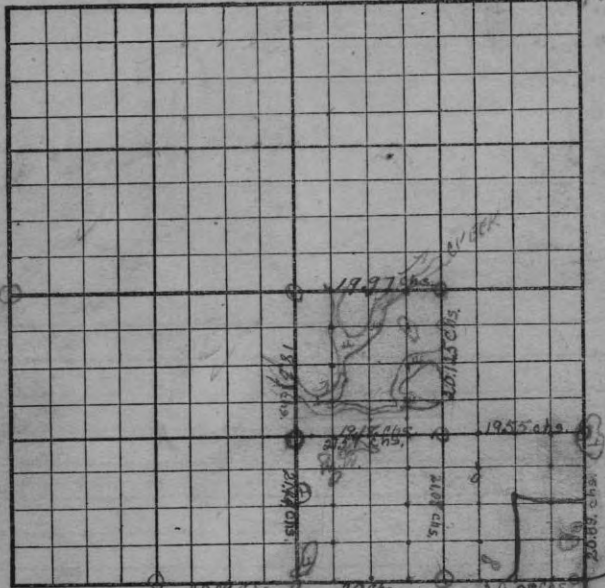

FORM 12 R

H. NIEDECKEN COMPANY, MFG. STATIONERS, MILWAUKEE

N.W.-SE:

1.69 chs short on W-side

12.5 Lks Long " E "

S.W.-SE

177 chs Long on W-side

1.08 " Long " E "

SE-SE

.69 Lks Long on E-side

1.08 chs

.7 Lks

" W "

" S "

Land Examinations.....

Date.....

Examiner.....

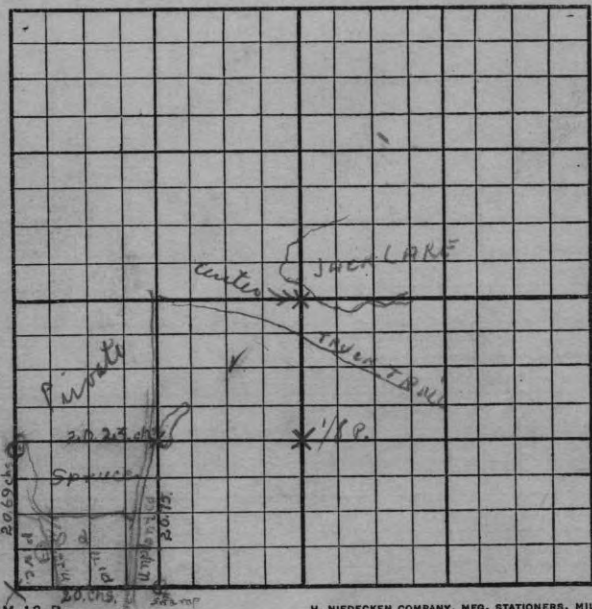
Sec. 22 Tp. 33N R. 11E

FORM 12 R

H. NIEDECKEN COMPANY, MFG. STATIONERS, MILWAUKEE

NE-SW found an old 1/8 P. at south of the center
 " the center of sec-22 - old stake lying down
 found the point of stake in ground

SW-SW

NE-SW - starting at 1/16 SW cor. of the
 NE-SW - Var 30° E 20.41 - full N
 3 1/8 P. on N + S 1/4 line - 27 1/2 dls

Land Examinations

Date

Examiner

S.W. 1/4 Sec. 18 Tp. 32 R. 13

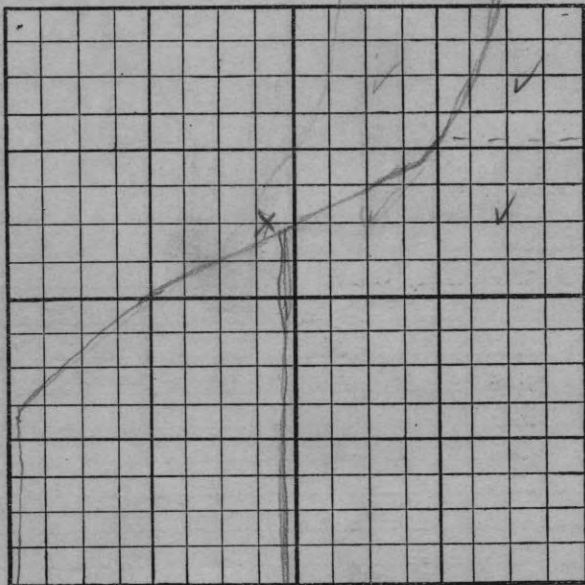

FORM 12 R

H. NIEDECKEN COMPANY, MFG. STATIONERS, MILWAUKEE

Land Examinations.....

Date.....

Examiner.....

Sec. 4 Tp. 33 R. 11 E

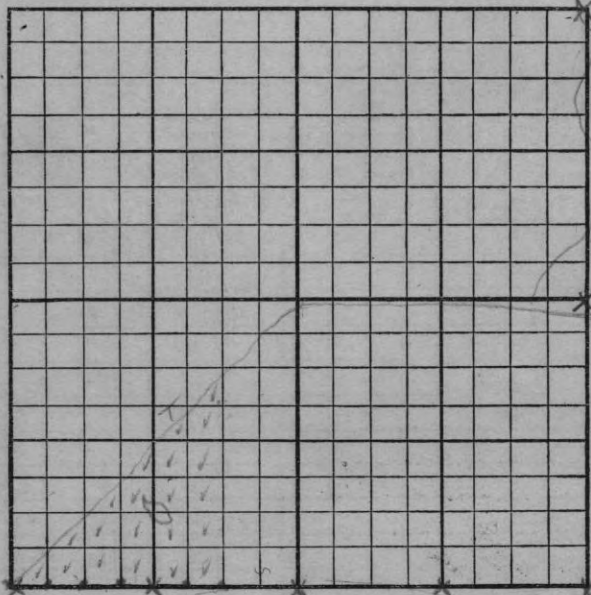

FORM 12 R

H. NIEDECKEN COMPANY, MFG. STATIONERS, MILWAUKEE

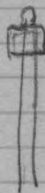

Land Examinations -----

Date -----

Examiner -----

Sec. ----- Tp. ----- R. -----

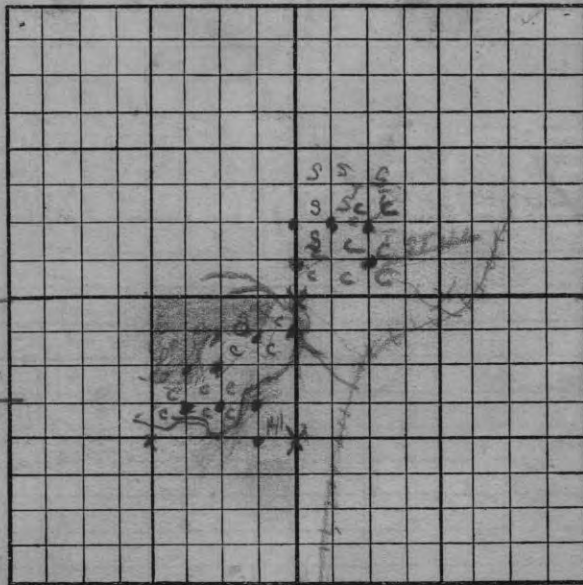

Poles.
20' 25'
29 5'

FORM 12 R

H. NIEDECKEN COMPANY, MFG. STATIONERS, MILWAUKEE

Post	9'	10'	12'	4'	Wood
20	64	67	32	44	10 Cord
75	80		51	50	20
70	207	190	182	94	20
175	128	86	62	14	10
80	20	72	80	108	6
20		90	80	115	6
355	60	170	115	96	6
	589	3	140	862	
	140	70	13.50		
	699	25	13.00		
		3	12.10		
		84			
		14			
		406			
		158.40			

W.P. Pine	HEM	HEM	HEM	HEM	CIRCH	BIRCH	MAPLE	MAPLE	ASH	CEDAR	SPRUCE	BASSW
84	16	76	3	10	86	7	7	7	7	7	7	11
18	22	84	4	6	88	3	2	2	2	2	2	18
30	4	77	5	10	88	4	8	8	8	8	8	14
18	12	88	6	8	88	7	10	10	10	10	10	10
4	7	84	3	16	88	7	12	12	12	12	12	6
3	7	84	2	16	88	7	16	16	16	16	16	3
18	4	84	2	16	88	7	24	24	24	24	24	11
9	3	84	2	16	88	7	18	18	18	18	18	3
2	4	84	2	16	88	7	12	12	12	12	12	3
40	4	84	2	16	88	7	16	16	16	16	16	3
18	4	84	2	16	88	7	24	24	24	24	24	3
5	4	84	2	16	88	7	18	18	18	18	18	3
49	4	84	2	16	88	7	14	14	14	14	14	3
50	4	84	2	16	88	7	3	3	3	3	3	3
46	4	84	2	16	88	7	3	3	3	3	3	3
55	4	84	2	16	88	7	3	3	3	3	3	3
59	4	84	2	16	88	7	3	3	3	3	3	3
10	4	84	2	16	88	7	3	3	3	3	3	3
20	4	84	2	16	88	7	3	3	3	3	3	3
30	4	84	2	16	88	7	3	3	3	3	3	3
40	4	84	2	16	88	7	3	3	3	3	3	3
50	4	84	2	16	88	7	3	3	3	3	3	3
60	4	84	2	16	88	7	3	3	3	3	3	3
70	4	84	2	16	88	7	3	3	3	3	3	3
80	4	84	2	16	88	7	3	3	3	3	3	3
90	4	84	2	16	88	7	3	3	3	3	3	3
100	4	84	2	16	88	7	3	3	3	3	3	3
110	4	84	2	16	88	7	3	3	3	3	3	3
120	4	84	2	16	88	7	3	3	3	3	3	3
130	4	84	2	16	88	7	3	3	3	3	3	3
140	4	84	2	16	88	7	3	3	3	3	3	3
150	4	84	2	16	88	7	3	3	3	3	3	3
160	4	84	2	16	88	7	3	3	3	3	3	3
170	4	84	2	16	88	7	3	3	3	3	3	3
180	4	84	2	16	88	7	3	3	3	3	3	3
190	4	84	2	16	88	7	3	3	3	3	3	3
200	4	84	2	16	88	7	3	3	3	3	3	3
210	4	84	2	16	88	7	3	3	3	3	3	3
220	4	84	2	16	88	7	3	3	3	3	3	3
230	4	84	2	16	88	7	3	3	3	3	3	3
240	4	84	2	16	88	7	3	3	3	3	3	3
250	4	84	2	16	88	7	3	3	3	3	3	3
260	4	84	2	16	88	7	3	3	3	3	3	3
270	4	84	2	16	88	7	3	3	3	3	3	3
280	4	84	2	16	88	7	3	3	3	3	3	3
290	4	84	2	16	88	7	3	3	3	3	3	3
300	4	84	2	16	88	7	3	3	3	3	3	3

Logs to Truck
16
37
56
41
55
7

TOTAL 17.362

210

Land Examinations

Date

Examiner

Sec. 36 Tp. 34 R. 11

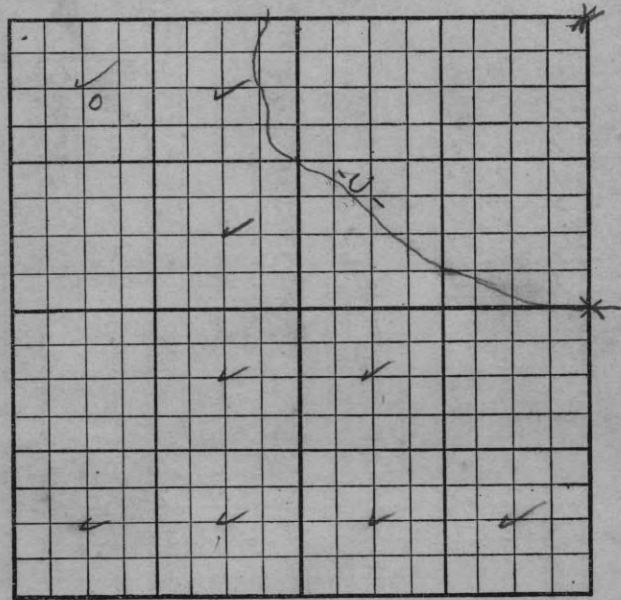

FORM 12 R

H. NIEDECKEN COMPANY, MFG. STATIONERS, MILWAUKEE

Land Examinations.....

Date.....

Examiner.....

Sec. 25 Tp. 34 R. 11 E

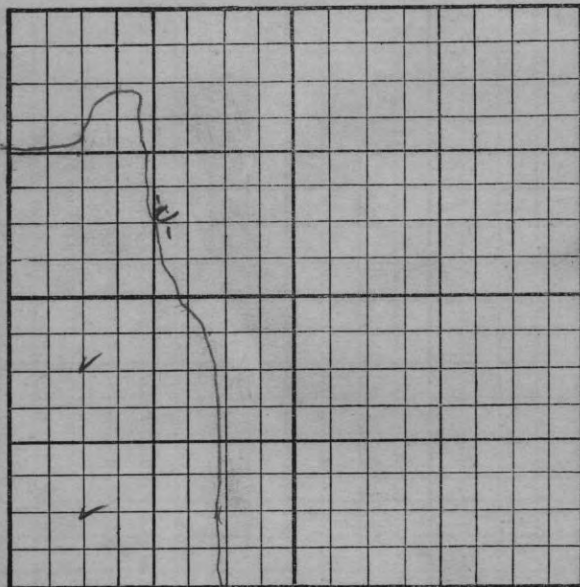

Land Examinations

Date

Examiner

Sec. 35 Tp. 34 R. 11 E

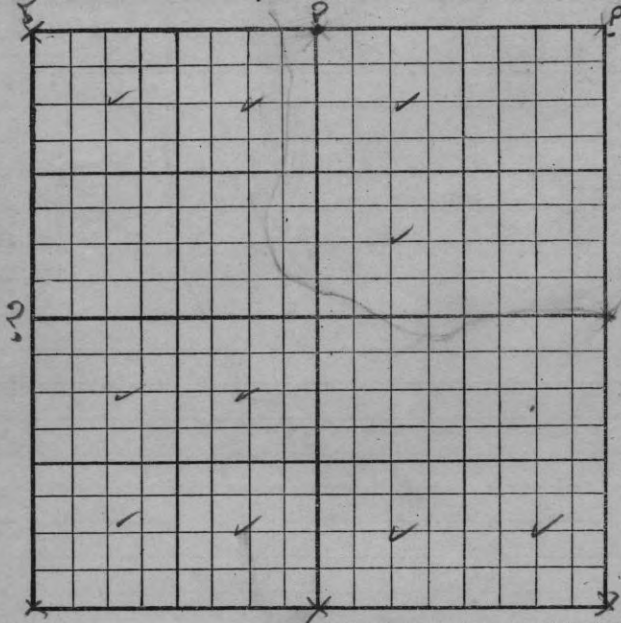

FORM 12 R

H. NIEDECKEN COMPANY, MFG. STATIONERS, MILWAUKEE

Land Examinations

Date

Examiner

Sec. 31 Tp. 34 R. 12

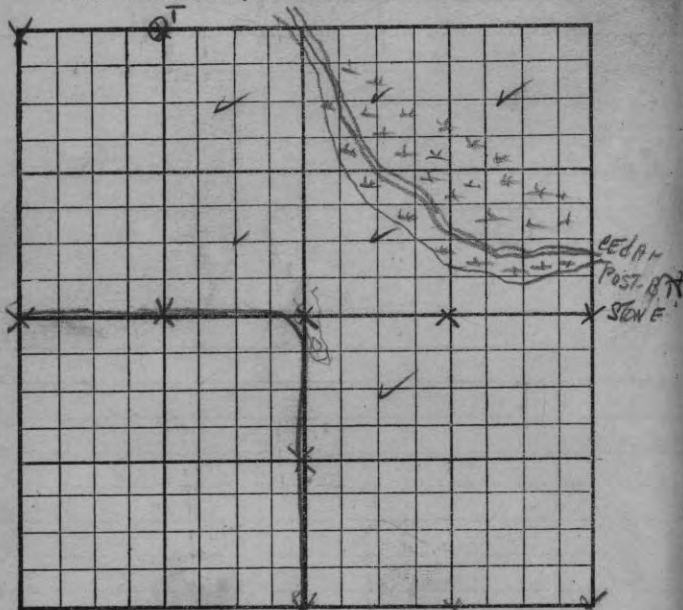

FORM 12 R

H. NIEDECKEN COMPANY, MFG. STATIONERS, MILWAUKEE

$$\begin{array}{r} 4.55 / 190000 \quad 4569 \\ \underline{16832} \end{array}$$

$$\begin{array}{r} 2368.0 \\ \underline{20790} \\ 28900 \\ \underline{24948} \\ 39520 \\ \underline{37422} \end{array}$$

$$2.35.15$$

$$\begin{array}{r} 3.00 \\ \underline{2.35} \end{array}$$

$$2 / 5.35$$

$$2 / 67.5$$

$$30 \frac{1}{2}$$

33.12

315

20.61

16610

315

5.73

331.2

#0300

.36

9936

6183

3438

10,433.30 6492.15 1719

105031

2141.23

20.615

41.

206280

205

128

125

241.23

20.61 1/2

.05031

510

60

41

9

116.80

3,018.60

.65

4207

8,193,400

5.73

.1447

4207

1.43

60

39869

1719

1,6820

37863

2292

5.73

20,0510

573

1.30

16828

8,1939

17190

32320

41

573

29429

64490

153

.03158

41.23 130,010.00

41.23 6,4490

12389

4123

63110

3

231260

4128

2135

20615

21870

21525

16450

20615

2167.0

492

12550

12369

Land Examinations Subdivision - Survey
 Date May 4-5-6-8-1938
 Examiner A.J. LITTLE - Eng - 915 - Elkhart, W.
 Sec. 28 Tp. 34 N R. 12 E

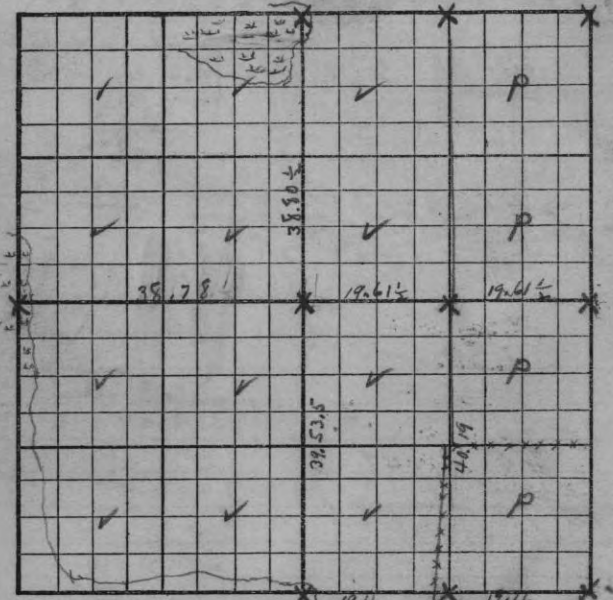

FORM 12 R

H. NIEDECKEN COMPANY, MFG. STATIONERS, MILWAUKEE

19.615		19.615
<u>78.005</u>	78.01	
38.23	38.23	39.230
<u>39.775</u>	39.78	
38.23		
<u>78.005</u>	78.01	
	39.23	
	<u>38.78</u>	
		.45

37.535		
<u>35.805</u>		
78.0	39.98	
	<u>38.23</u>	

78.340		
<u>38.805</u>		
39.535		
<u>38.505</u>		
78.340		

Land Examinations

Date

Examiner

Sec. 32 Tp. 734 N R. 10 E

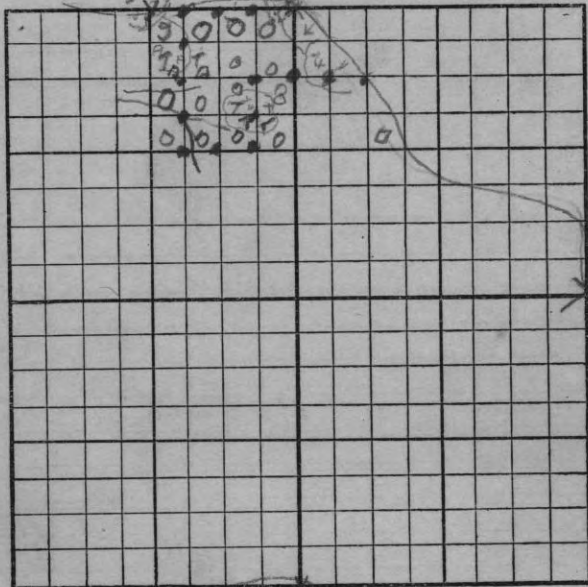

FORM 12 R

H. NIEDECKEN COMPANY, MFG. STATIONERS, MILWAUKEE

NE-NW-

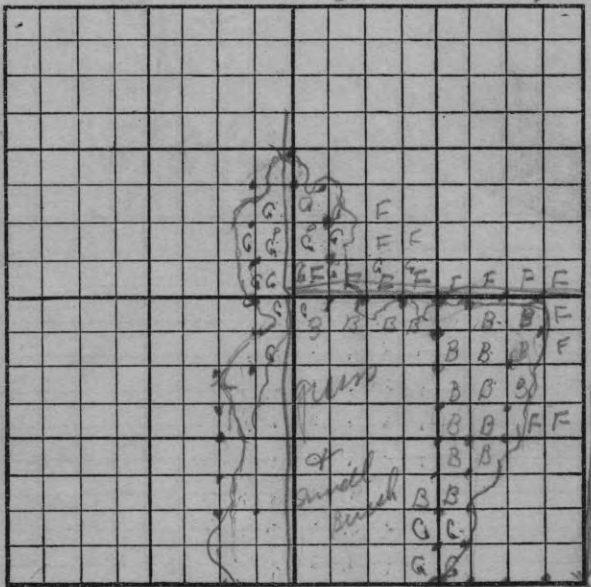
Land Examinations W-C-D-Date 5/1st - 1939Examiner A. J. LITTLE - Eng - 91-SSec. 12 Tp. 35N R. 11E
ONEIDA Co, WIS

FORM 12 R

H. NIEDECKEN COMPANY, MFG. STATIONERS, MILWAUKEE

about 10 acres all told of
scattered small maple + Birch
but no damage done from fire

Balance open stump + brush
pasture

$$\begin{array}{r} 52 \\ 18 \\ \hline 70 \end{array}$$

$$\begin{array}{r} 26 \\ 70 \\ \hline 196.0 \end{array}$$

$$\begin{array}{r} 9 \\ 62 \end{array}$$

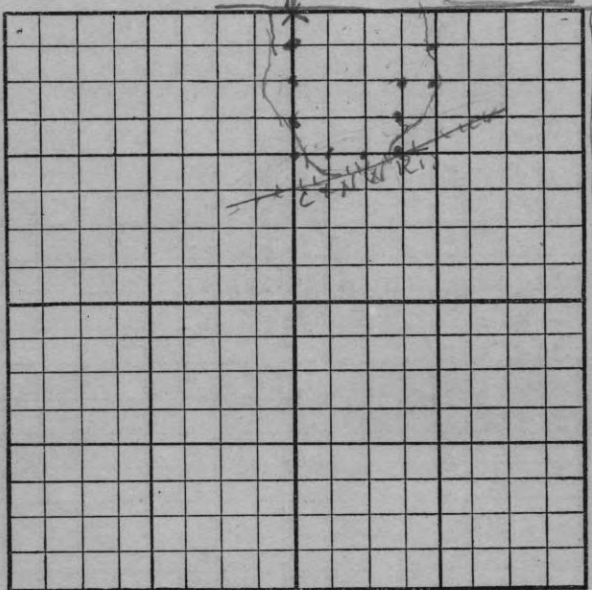
Land Examinations W-C-13Date May 12 1935Examiner A. LITTLESec. 13 Tp. 32N R. 11E

FORM 12 R

H. NIEDECKEN COMPANY, MFG. STATIONERS, MILWAUKEE.

Stumps, Brush & grass
no damage from fire

$$\begin{array}{r} 25 \\ 16 \\ \hline 130 \\ 25 \\ \hline 380 \end{array}$$

$$\begin{array}{r} 25 \\ 17 \\ \hline 175 \\ 25 \\ \hline 425 \\ 1730 \\ \hline 2155 \end{array}$$

Land Examinations MRS. ALEX McREADate AUG-16-1943Examiner A. J. LITTLESec. 8 Tp. 36 R. 9