

CERTIFIED LAND CORNER RESTORATION

Index No. **C-21**

State of Wisconsin } ss.
 County of Oneida

I Phillip T. Hansen, do hereby certify that on the 21st day of May, 1976, I found evidence of the quarter corner of Section 1 and 2 Township 35 North, Range 10 East, Fourth Principal Meridian, as described hereon; and that from this evidence I established a new monument and accessories as described hereon to perpetuate the original location of this corner.

Resident witnesses:
 Glen Barker
 Jim Clafflin
 Herb Wagoner

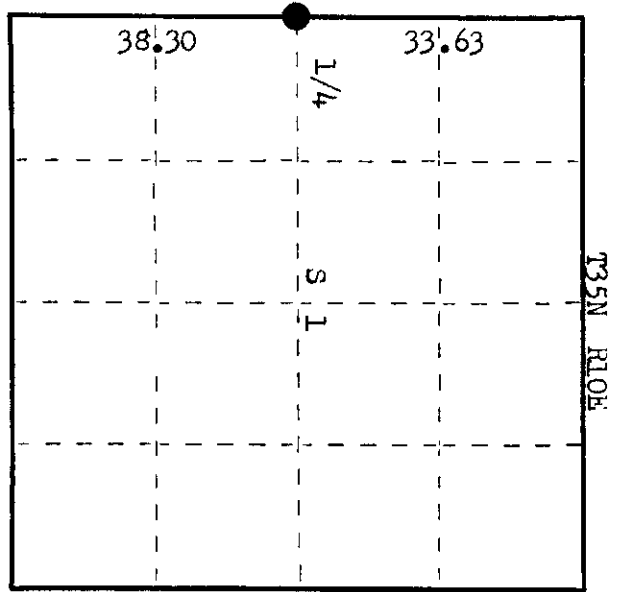
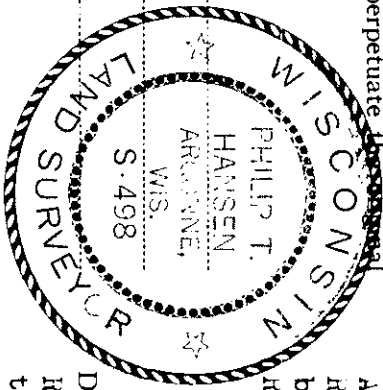

○ = Corner monument restored.

History of original corner establishment: Original Corner established by James L. Nowlin, Deputy Surveyor, in 1865, from which white Pine 11" bears N 20° W 15 lks and white Pine 10" bears N 51° W 4 lks.
 Corner recovered by B.F. Dorr, County Surveyor, in 1896, at which time he found the original trees. He marked NBT - white Pine N 8° W 7 lks.
 Corner recovered by H.C. Lawrence, Registered Land Surveyor. Found remains of Dorr's post which agreed with his calls to recovered white Pine N 8° W 7 lks.
 Set new post and marked BTS - Oak 10" S 13° W 26 1/2 lks.
 Sugar 9" N 68° W 28 lks.

Description of corner evidence found:
 Recovered 4" cedar post, squared and scribed 1/4 S1, 1/4 S2. Post was in poor condition.
 Also recovered Ripco's 2 1/2" iron pipe with aluminum cap stamped.
 Recovered original W. Pine 11" N 20° W 15 lks, now a decayed stump but scribe marks still visible.
 Recovered H.C. Lawrence's BT - Maple 10" (14") N 72 1/2° W 16 lks, scribed 1/4 S2.
 White Pine 16" (18") S 38° W 20 lks, scribed 1/4 NBT.

Description of monument and accessories I established to perpetuate the original location of this corner.
 Removed pipe and post from ground and reset Ripco's monument in post hole, adjusted it to fit calls to BTS.
 Monument projects 12" above ground.
 Built rock cairn around base of monument.
 Marked NBT - Maple 12" N 84° 37 lks, scribed 1/4 BT.

3510022000

Dated at Rhinelander, Wis., this 5th day of August, 1976

Signature *Phillip T. Hansen* Title Registered Land Surveyor Registration No. S-498
 (County Surveyor, Registered Land Surveyor, or other duly authorized official)
 Office of Register of Deeds, County of Oneida
 Instrument was filed in this office for record on the 21st day of May, 1976 at 1:00 o'clock P.M.
 I hereby certify that the within instrument was filed in this office for record on the 21st day of May, 1976

Doree Marge Kuehn
 (Register of Deeds)

By Deputy