

CERTIFIED LAND CORNER RESTORATION

Index No. V-23

State of Wisconsin }
County of Oneida } ss.

I Phillip T. Hansen, do hereby certify that on the 5th day of April, 1976, I found evidence of the 1/4 corner of Sec. 25 and 36 Township 35 North, Range 10 East, Fourth Principal Meridian, as described hereon and that from this evidence I established a new monument and accessories as described hereon to perpetuate the original location of this corner.

Resident witnesses:

- Glen Barker
- Jim Craftin
- Herb Wagner

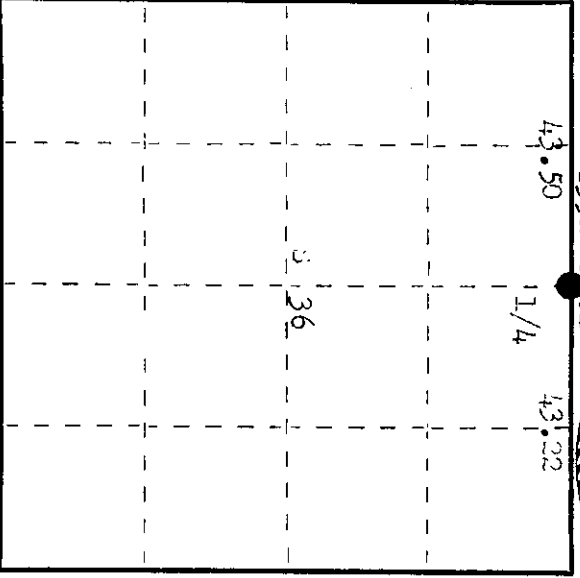
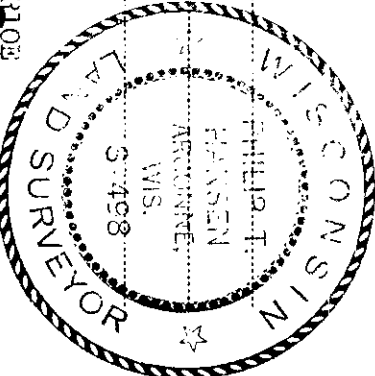

○ = Corner monument restored.

History of original corner establishment: Original corner established by James L. Nowlin, Deputy Surveyor, in 1865, from which Cedar 12" bears S 230° E 20 lks and Birch 11" bears N 46° W 18 lks.

H.C. Lawrence, Registered Land Surveyor, recovered a wooden post lying down in the grass and found a pile of stone in the center of which he found an old joint. The origin of this corner is questionable, thought to be D.H. Vaughan's, but may have been H.F. Dorr's corner. No bearing trees were visible. Lawrence set new 4" post. Set lone bearing tree, Sugar 14" N 65 1/2° E 233 lks. Burnt cedar stump 14" S 46° W 141 lks, sets 3.63 chains west of CTH "G" corner.

Description of corner evidence found:
Could not find any evidence of H.C. Lawrence's post. Recovered sugar BT, scribed 325, S 65° 30' W 2.33 chains. Recovered old burnt cedar stump at S 50° W 1.312 chains. Our measurement to CTH "G" corner is 2.63 chs. Believed Lawrence had mistaken pointing to cedar stump. 1.31 chains checks out with other calls. Area appears to have been landscaped. A mobile home now bears N 27° W 105 lks. to SW corner.

Description of monument and accessories I established to perpetuate the original location of this corner.

Set 2" iron pipe with brass cap for corner. Cap stamped. BT - sugar 10" S 27° W 125.3 lks, scribed 1/4 BT. W. Birch 8" S 43° W 104 lks, scribed 1/4 BT. SE Corner mobile home N 27° W 105 lks. Monument and BTs painted blue.

3498
T35N R10E
1/4 S 1 25
36
CPI - 1976

Dated at Shinelander, Wis., this 07th day of JULY, 1975.

Signature: Phillip T. Hansen Title: Registered Land Surveyor Registration No. 3498
(County Surveyor, Registered Land Surveyor, or other duly authorized official)

Office of Register of Deeds, County of Oneida. I hereby certify that the within instrument was filed in this office for record on the 23rd day of July, 1976 at 100 o'clock P. M.

Signature: Dorice Wagner
(Register of Deeds)

By: _____ Deputy

0200521035