

CERTIFIED LAND CORNER RESTORATION

Index No. B-2

State of Wisconsin

County of Oneida } ss.

History of original corner establishment:
No records of any previous survey.

I Philip T. Hansen, do hereby certify that on the 19th day of April, 1979, I ~~found~~ ~~restored~~ ~~the~~ ~~corner~~ of ~~the~~ NW 1/16 corner of Section 6 T35N R11E Township 35, North, Range 11 East, Fourth Principal Meridian, as described hereon; and that from this evidence I established a new monument and accessories as described hereon to perpetuate the original location of this corner.

Resident witnesses:
Glen Barker
Jim Clafflin
Herb Wagoner

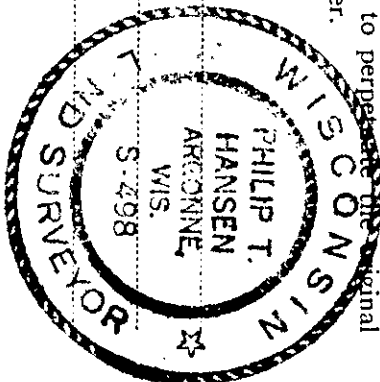

Description of corner evidence found:

No evidence of any corner recovered.

Corner established by traverse and computation. Computed distance from W 1/16 between Sections 31 and 6 to WC 1/16 corner of Section 6 is 2465.243 feet at bearing S 1° 49' 30" W. Computed location of the NW 1/16 is S 1° 49' 30" W 1064.46' of W 1/16 and N 1° 49' 30" E 1400.983 feet from WC 1/16.

Description of monument and accessories I established to perpetuate the original location of this corner.

Set a 1-1/2" iron pipe with 2" brass cap projecting 12" - stamped:

Marked NPT's -
Maple 6" S67° W 17.0 feet, scribed 1/16 BT. S498
Maple 6" N23° E 3.40', scribed 1/16 BT. T35N R11E
NW 1/16 S+6
CPI-1979

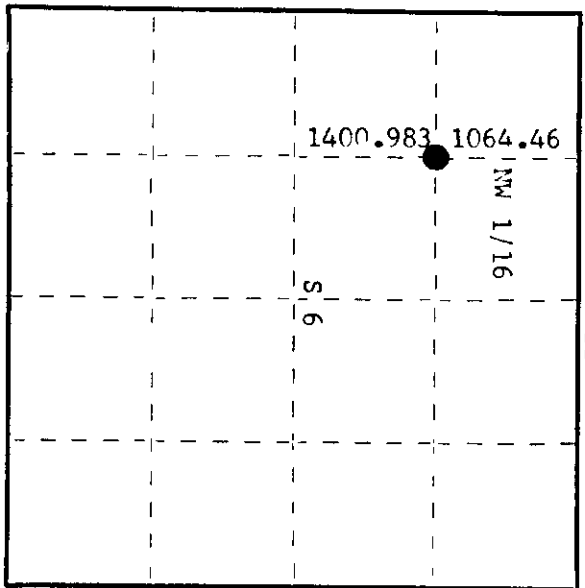

O = Corner monument restored.

Dated at Rhinelander, Wis., this 30th day of April, 1979

Signature Philip Hansen Title Registered Land Surveyor Registration No. S-498
(County Surveyor, Registered Land Surveyor, or other duly authorized official)

Office of Register of Deeds, County of Oneida. I hereby certify that the within instrument was filed in this office for record on the 21st day of May, 1979 at 2:00 o'clock P. M.

Signature Dorcas Bergey Kuehn
(Register of Deeds)

By: _____ Deputy

3511063030