

CERTIFIED LAND CORNER RESTORATION

Index No. **Q-5**

State of Wisconsin

County of Oneida } ss.

I Phillip T. Hansen do hereby certify that on the 12th day of August, 1975, I found evidence of the S-1/16 corner of Sections 19 and 20

Township 35 North, Range 11 East, Fourth Principal Meridian,

as described hereon; and that from this evidence I established a new monument and accessories as described hereon to perpetuate the original location of this corner.

Resident witnesses:

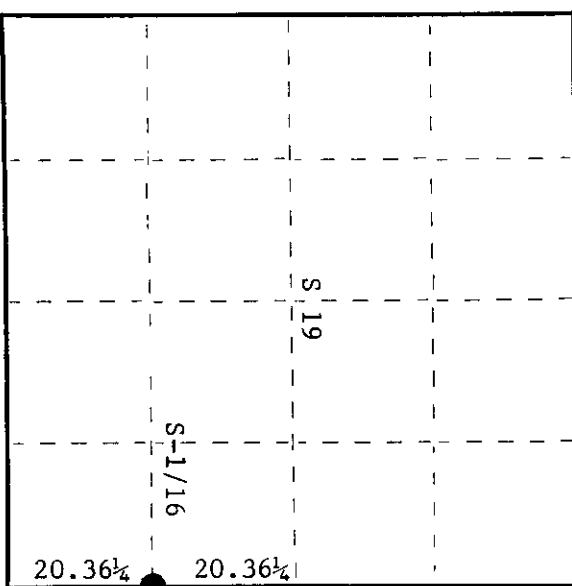
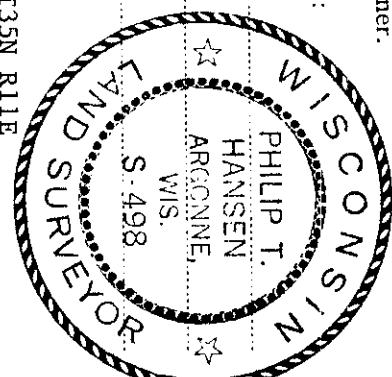

○ = Corner monument restored.

History of original corner establishment: Corner established by H.C. Lawrence, Registered Land Surveyor, in 1953. Established 1/4 post equidistant between section corners at 40.72 1/2". This was 2 1/2 links north and 15 links east of an iron pipe of unknown origin. Tied corner to jack pine 5" N59°W 1.28 chains and tamarack 5" S83°W 1.50 chains. Set S-1/16 post at 61.09 chains south of NE corner, equidistant between 1/4 corner and SW corner. No trees available for BT's.

Description of corner evidence found:

Recovered 4" cedar post, squared and scribed S-1/16 S19, S-1/16 S20 in poor condition.  
No BT's recovered.

Description of monument and accessories I established to perpetuate the original location of this corner.  
Replaced 4" cedar post with 1-1/2" O.D. iron pipe with 2" brass cap stamped -

NBT's - Tamarack 5"	N26°E 84.9 links scribed 1/16 BT	S498
Tamarack 6"	N58°W 50.9 links scribed 1/16 BT	T35N R11E
		S19 S20
		S-1/16

CPI-1975

Dated at Rhinelander, Wis., this 8th day of September, 1975.

Signature: *Phillip T. Hansen* Title: Registered Land Surveyor Registration No. S-498  
(County Surveyor, Registered Land Surveyor, or other duly authorized official)

Office of Register of Deeds, County of Oneida  
Instrument was filed in this office for record on the 14th day of October, 1975  
at 2:00 o'clock P.M.

*Donis George Kuhn*  
(Register of Deeds)

By: \_\_\_\_\_ Deputy

3511191000