

CERTIFIED LAND CORNER RESTORATION

Index No. **P-9**

State of Wisconsin } ss.
 County of Oneida

History of original corner establishment:
 Original corner established by Wm. E. Dougherty, Deputy Surveyor, in 1859 from which tamarack 10" bears S 32° W, 9 links and tamarack 16" bears S 14° E, 24 links.

I, Phillip T. Hansen, do hereby certify that on the 9th day of June, 19 78, I ~~restored~~ ^{established} the Quarter corner of Section 20 & 21 Township 35 North, Range 11 East, Fourth Principal Meridian,

as described hereon; and that from this evidence I established a new monument and accessories as described hereon to perpetuate the original location of this corner.

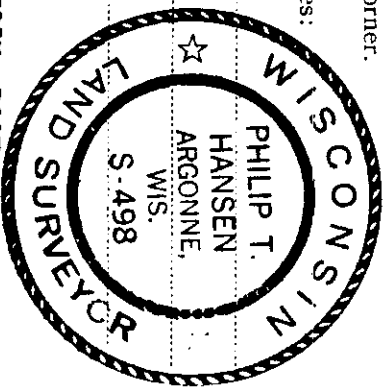

Resident witnesses:
 Glen Barker
 Jim Claflin
 Herb Wagoner

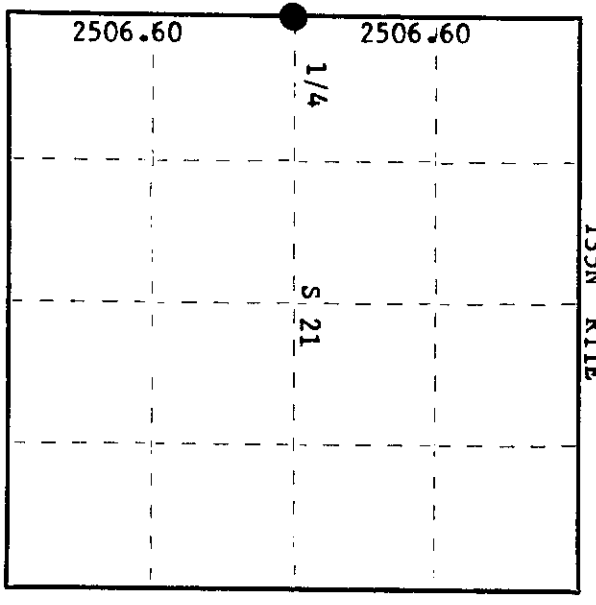

○ = Corner monument restored.

Description of corner evidence found:

No evidence of any corner recovered.
 Ran traverse from section corner 16, 17, 20 & 21 to section corner 20, 21, 28, & 29. Computed distance 1° S 5013.20 feet at bearing S 1° 04' 43" E.
 Set 1/4 corner intermediate at distance 2506.60 feet.

Description of monument and accessories I established to perpetuate the original location of this corner.

Set a 2 1/2" Bernitsen A-1 Federal Monument, aluminum with magnet installed in cap and base. Cap stamped:

Monument projects 10" above ground.
 Marked NBT's -
 White Birch 10" N 4° W, 10.08 feet T35N R11E
 White Birch 7" S 70° E, 25.95 feet 1/4 20+21
 White Birch 10" S 18° E, 22.65 feet
 White Birch 6" S 32° W, 34.87 feet S498 1978

Dated at Rhineland, Wis., this 10th day of July, 19 78

Signature Phillip T. Hansen Title Registered Land Surveyor Registration No. S-498
 (County Surveyor, Registered Land Surveyor, or other duly authorized official)
 Office of Register of Deeds, County of Oneida
 Instrument was filed in this office for record on the 17th day of July, 19 78
 at 10:00 o'clock A. M. I hereby certify that the within

By Doris Savage Tuerha Deputy
 (Register of Deeds)

3511202000