

CERTIFIED LAND CORNER RESTORATION

Index No. V-14

State of Wisconsin }
County of Oneida } ss.

I Phillip T. Hansen, do hereby
certify that on the 21st day
of February, 1979, I ~~found~~
~~restored~~ restored the W 1/16
corner of Sections 27 and 34
Township 35, North, Range
11 East, Fourth Principal Meridian,
as described hereon; and that from this evidence
I established a new monument and accessories
as described hereon to perpetuate the original
location of this corner.

Resident witnesses:

Glen Barker

Jim Clafflin

Herb Wagoner

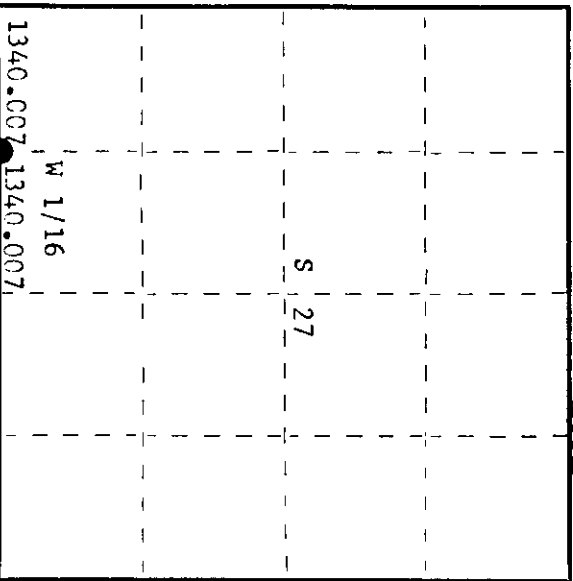
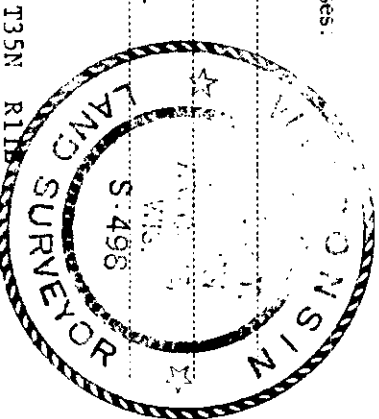

○ = Corner monument restored.

History of original corner establishment:

No records on any previous survey.

Description of corner evidence found:

No evidence of any corner recovered.

Corner established by traverse and computation.

Ran traverse from section corners 27, 28, 33 and 34 to 1/4 corner section 27 and 34.

Computed distance is 2680.014 feet at bearing S 87° 25' 55" E.

Set W 1/16 at 1340.007 feet intermediate.

Description of monument and accessories I established to perpetuate the original location of this corner.

Set 1 1/2" iron pipe with 2" brass cap, stamped:

Monument projects 18" above ground.

Marked NBT's -

Tamarack 4" S61°E 10.15 feet

Tamarack 4" N15°W 25.31 feet

both scribed 1/4 BT.

S498
T35N R11E
S 27
W 1/16 S+34
GTI-1979

Dated at Rhineland, Wis., this 28th day of February, 1979

Signature: Phillip T. Hansen Title: Registered Land Surveyor Registration No. S-498
(County Surveyor, Registered Land Surveyor, or other duly authorized official)

Office of Register of Deeds, County of Oneida, I hereby certify that the within
instrument was filed in this office for record on the 13th day of March, 1979
at 1:30 o'clock P. M.

Anna Vernege Kuehn
(Register of Deeds)

By: _____ Deputy

3511270030