

CERTIFIED LAND CORNER RESTORATION

Index No. **V-8**

State of Wisconsin

County of Oneida } ss.

I, Phillip T. Hansen, do hereby certify that on the 2nd day of August, 1978, I ~~found~~ established the E 1/16 corner of Section 29 & 32 Township 35, North, Range 11 East, Fourth Principal Meridian,

as described hereon; and that from this evidence I established a new monument and accessories as described hereon to perpetuate the original location of this corner.

Resident witnesses:

Jim Claflin

Herb Wagoner

John Masbaum

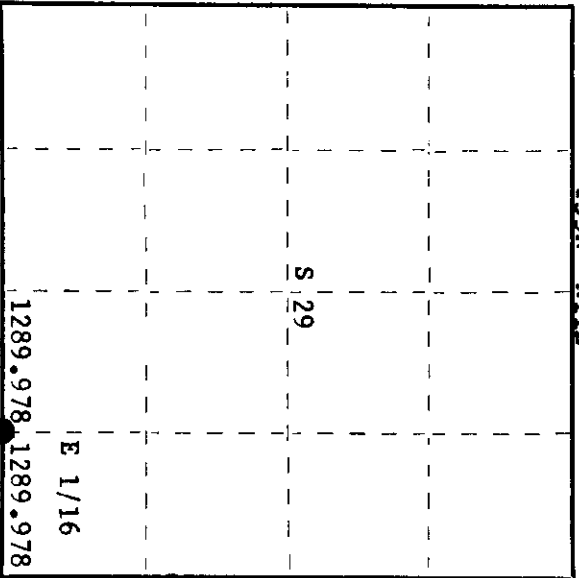
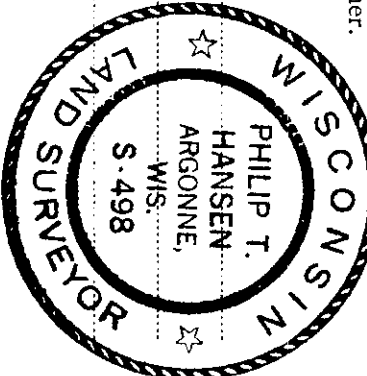

○ = Corner monument restored.

History of original corner establishment:  
**No records available on any previous survey.**

Description of corner evidence found:  
**No evidence of any corner recovered. Corner established by traverse and computation. Ran traverse from previously established 1/4 corner to section corner S 28, 29, 32 & 33. Computed distance 2579.956 feet at bearing S 88° 38' 57" E. Set E 1/16 at 1289.978 feet intermediate.**

Description of monument and accessories I established to perpetuate the original location of this corner.  
**Set 1 1/2" iron pipe with 2" brass cap projecting 24" above ground. Cap stamped:**

**Marked NBR's - Sugar 8" S12°E 3.68 feet  
Sugar 6" N27°W 7.12 feet**

**S498  
T35N R11E  
E 1/16 S+29  
CPI-1978**

Dated at Rhinelander, Wis., this 7th day of August, 1978

Signature: Phillip T. Hansen, Title, Registered Land Surveyor, Registration No. S-498  
(County Surveyor, Registered Land Surveyor, or other duly authorized official)

Office of Register of Deeds, County of Oneida,  
instrument was filed in this office for record on the 21st day of August, 1978  
at 100 o'clock P. M.

Dennis George Fuchs  
(Register of Deeds)

By: \_\_\_\_\_ Deputy

01000290010