

CERTIFIED LAND CORNER RESTORATION

Index No. U-6

State of Wisconsin }  
 County of Oneida } ss.

I, Philip T. Hansen, do hereby  
 certify that on the 27th day  
 established July, 19 78, I ~~have~~  
~~examined~~ the SW 1/16  
 corner of Section 29  
 Township 35, North, Range  
11 East, Fourth Principal Meridian,

as described hereon; and that from this evidence  
 I established a new monument and accessories  
 as described hereon to perpetuate the original  
 location of this corner.

Resident witnesses:  
Glen Barker  
Jim Claflin  
Herb Wagoner

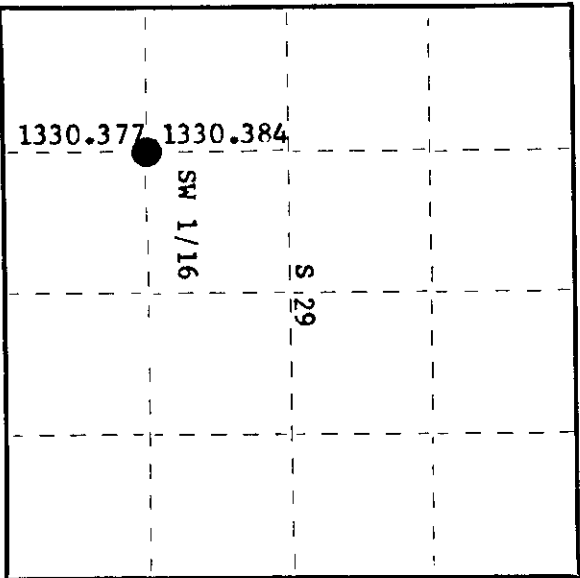
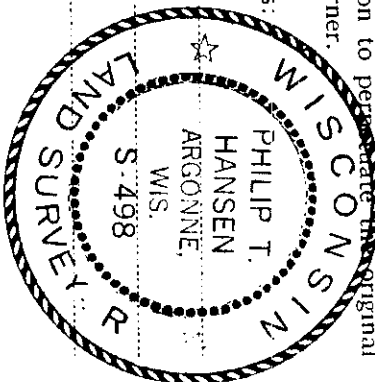

○ = Corner monument restored.

History of original corner establishment:  
 No records available of any previous survey.

Description of corner evidence found:

No evidence recovered. Corner established by traverse and computation. Computed the distance 2660.761 feet and bearing N 1° 06' 03" E between previously established W 1/16 corner and WC 1/16 corner. Computed distance of SW 1/16 to 1330.377 feet N 1° 06' 03" E of W 1/16 and 1330.384 feet S 1° 06' 03" W of WC 1/16.

Description of monument and accessories I established to perpetuate the original location of this corner.

Set 1 1/2" iron pipe with 2" brass cap, projecting 24", stamped:

Marked NBT's - White Spruce 6" S22°W 27.75 feet  
 White Birch 5" N29°E 17.31 feet, scribed 1/16 BT.

S498  
 T35N R11E  
 SW 1/16 S 29  
 CPT-1978

Dated at Rhinelander, Wis., this 7th day of August, 19 78.

Signature Philip T. Hansen Title Registered Land Surveyor Registration No. S-498  
 (County Surveyor, Registered Land Surveyor, or other duly authorized official)

Office of Register of Deeds, County of Oneida  
 instrument was filed in this office for record on the 18th day of September, 19 78  
 at 12 o'clock P. M.

Donis Lenage Kuehn  
 (Register of Deeds)

By \_\_\_\_\_ Deputy

3511291030