

CERTIFIED LAND CORNER RESTORATION

Index No. **7-6**

State of Wisconsin

County of Oneida } ss.

I, Phillip T. Hansen, do hereby certify that on the 16th day of August, 1978, I ~~restored~~ established the WC 1/16 corner of Section 29 Township 35, North, Range 11 East, Fourth Principal Meridian.

I established a new monument and accessories as described hereon; and that from this evidence as described hereon to perpetuate the original location of this corner.

Resident witnesses:

Glen Barker

Jim Clafflin

Herb Wagoner

John Masbaum

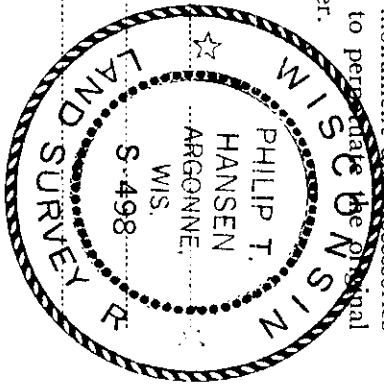

History of original corner establishment:
No records of any previous survey.

Description of corner evidence found:

No evidence of any corner recovered.
Corner established by traverse and computation. Ran traverse from previously recovered N 1/4 corner to S 1/4 corner and from W 1/4 corner to E 1/4 corner to establish the C 1/4 corner. C 1/4 corner computed and set at S 89° 49' 26" E 2640.394 feet of W 1/4 corner. WC 1/16 corner set at 1320.197 feet intermediate.

Description of monument and accessories I established to perpetuate the original location of this corner.

Set 1 1/2" iron pipe with 2" brass cap, projecting 24", stamped:

Marked NBT's -
Sugar 8" S83°E 15.69 feet S498
Sugar 5" S34°W 9.90 feet, scribed 1/16 BT. T35N R11E
WC 1/16 S__29
CPI-1978

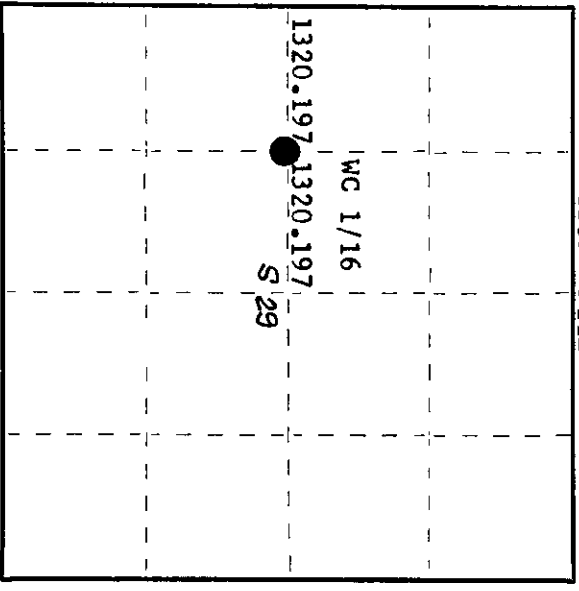

○ = Corner monument restored.

Dated at Rhineland, Wis., this 21st day of August, 1978.

Signature Phillip T. Hansen Title Registered Land Surveyor Registration No. S-498
(County Surveyor, Registered Land Surveyor, or other duly authorized official)

Office of Register of Deeds, County of Oneida, I hereby certify that the within instrument was filed in this office for record on the 18th day of September, 1978 at 1:00 o'clock P. M.

Doris Leazer Fisher
(Register of Deeds)

By _____ Deputy

3511292030