

This form is intended to fulfill the requirements of Chapter A-E7.08 (3)(a) thru (l) U.S. Public Land Survey Monument Location Record, Wisconsin Administrative Code. Use the reverse side of form for continuation.

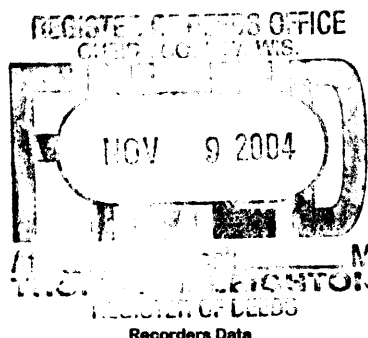

**U.S. PUBLIC LAND SURVEY MONUMENT LOCATION RECORD**

USPLS CORNER: WEST 1/4 SECTION: 18 TOWNSHIP: 36 NORTH RANGE: 7 east  
 NAME OF WATERWAY FOR M.C. CORNER : N/A SECTION LINE: N/A  
 (CITY)(VILLAGE)(TOWN) OF: WOODBORO COUNTY OF: ONEIDA

Description of monument found or placed and all other evidence used as the basis for monument location; including monuments and measurements required if the corner location was reestablished by lost corner proportionate methods. Also indicate name of the original surveyor, original survey date and the corner monument, bearing trees, witness or other reference monuments established, including measured bearing and distance ties, from available survey records.

Found and accepted an older stable and plumb 2" dia. galvanized iron pipe with stamped brass cap 30" up in a cairn of rocks at grade; also found a standard white poly "T" marker post 6" NE. No older BTs readily observed nearby with distinctive markings. Corner falls on South edge of an open 30'+/- wide by 80'+/- long East/West swale.

In August 1860, Alfred Millard/GLO set a wood post as original corner and noted OBTs: a 24" Pw at N89°W 1.25 links (chains?) and a 30" Pw N10°W 2.79 links (chains?); all now obliterated beyond recovery purposes.

In October 1937, V.M. Maine found point of original GLO corner post, original GLO 30" Pw OBT N10°W 2.79 chains and original GLO 24" Pw OBT N89°W 1.25 chains down and burned; he also noted that he set a brass capped "official corner" monument, normally a 2" dia. galvanized iron pipe, at the GLO corner location and new BTs: an 8" Ob S38°E .305 chains and a 22" Pw S64°W 1.625 chains, both of which I could not verify with certainty.

This corner previously located by GPS control survey at 291605 dE UTM and 5053800 dN UTM per Oneida County survey records.

This recovery completed 09/23/04; there were no direct witnesses.

Plan view map of monument location with bearing and distance ties to a minimum of four(4) described witness or reference monuments of concrete, natural stone, iron, live bearing trees or equivalent material. If applicable, also show a minimum of two(2) bearing and distance ties to any other monument found and not accepted; including the bearing and distance from the accepted monument.

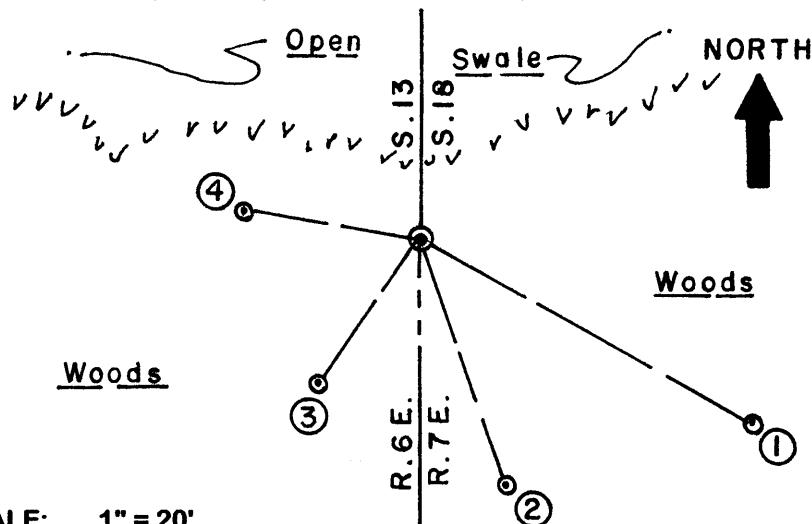

**WITNESS MONUMENT TIES:**

- ① New 10" West trunk of twin Mr BT S61°E 39.37'.
- ② New 16" West trunk of triple Mr BT S2 0°E 27.56'.
- ③ New 14" Mr BT S34°W 18.37'.
- ④ New 7.5" Mr BT N81°W 18.44' to PK/W in left face.

I flagged monument, T post, BTs and a line West about 250' to old North/South woods road with blaze orange tape.

SCALE: 1" = 20'

Unless otherwise indicated, all bearing tree ties are to a .25" dia. by 2.5" long PK nail with a 1.25" dia. steel washer driven into unblazed right face and a .25" dia. by 2.5" long PK nail with a 2" dia. steel washer stamped BT is also driven into unblazed face of bearing tree at DBH; the basis for measured bearings is by compass to nearest degree and all tie distances are measured horizontal by steel tape corrected to nearest 1/100th feet at standard temperature of 68° F.

RLS SEAL:



**LAND SURVEYOR CERTIFICATE:**

I, William C. Rohde, hereby certify that I am duly licensed as a Professional Land Surveyor in the State of Wisconsin; that this USPLS monument location was determined by me and/or under my direct supervision and control; and that this U.S. Public Land Survey Monument Location Record is true and correct to the best of my knowledge and belief.

Signed: *William C. Rohde*  
 William C. Rohde RLS 841

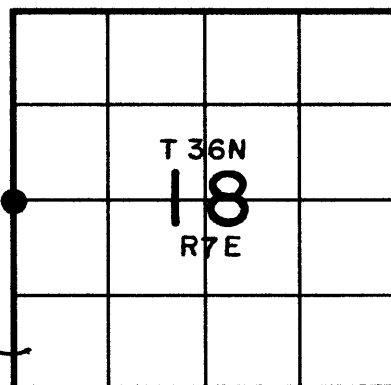

SECTION LOCATION MAP  
 INDEX NO. L 25

36 06 13 20 00