

CERTIFIED LAND CORNER RESTORATION

Index No. L-4

State of Wisconsin } ss.
 County of Oneida }

History of original corner establishment:
 No evidence of any previous corner.

I Glen Barker 27th, do hereby
 certify that on the January, 1984, ~~1984~~ day
 of EC 1/16, ~~1984~~ Estab.
~~corner of~~ Section 18
 Township 36, North, Range
6 East, Fourth Principal Meridian,
 as described hereon; and that from this evidence
 I established a new monument and accessories
 as described hereon to perpetuate the original
 location of this corner.

Description of corner evidence found:
 Total distance from 1/4 corner between sections 17 & 18 to C 1/4 Section 18 is 2619.14'.
 Set EC 1/16 1309.57' intermediate.

Resident witnesses:

J. Clafflin - R
H. Wagoner

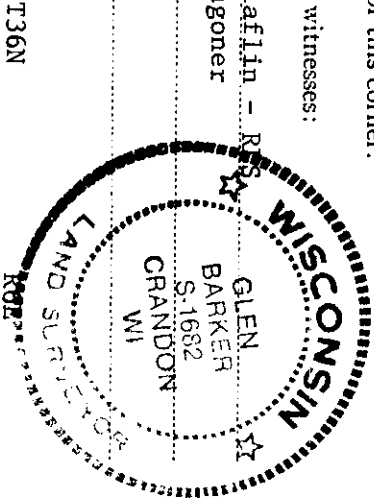

Description of monument and accessories I established to perpetuate the original location of this corner.
 Set a 1" iron pipe with 2" diameter alloy cap stamped:
 Monument projects 18" above ground.
 Marked NBTs
 Maple 7" S17W 20.72' EC 1/16 S 18
 Maple 10" N63E 27.98' T36N R6E
 Scribbled 1/16 - BT CPI - 1984

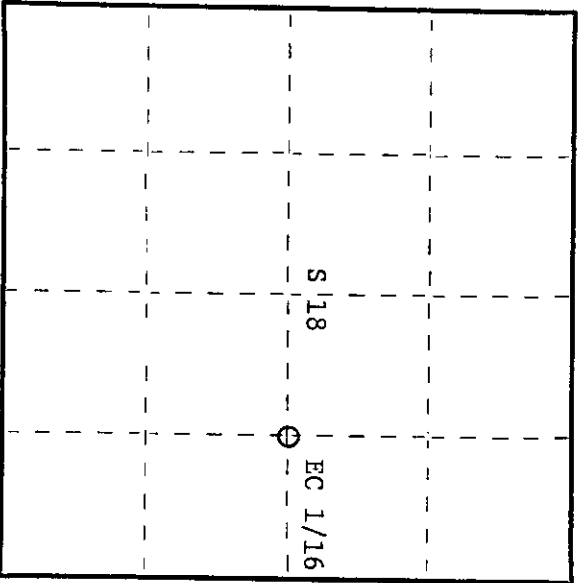

○ = Corner monument restored.

Dated at Rhinelander, Wis., this 20th day of February, 19 84.

Signature Glen Barker Title Registered Land Surveyor Registration No. S1682
 (County Surveyor, Registered Land Surveyor, or other duly authorized official)

Office of Register of Deeds, County of Oneida, I hereby certify that the within
 instrument was filed in this office for record on the 23rd day of May, 19 84
 at 11:00 o'clock A. M.

Doree Savage Fuchs
 (Register of Deeds)

By: _____ Deputy

3606182010