

This form is intended to fulfill the requirements of Chapter A-E 7.08 (3)(a) thru (l) U.S. Public Land Survey Monument Location Record, Wisconsin Administrative Code. Use the reverse side of form for continuation.

U.S. PUBLIC LAND SURVEY MONUMENT LOCATION RECORD

Recorders Data

USPLS CORNER: WEST 1/4 SECTION: 25 TOWNSHIP: 36 NORTH RANGE: 06 EAST

NAME OF WATERWAY FOR M.C. CORNER: N/A SECTION LINE: N/A

(CITY)(VILLAGE)(TOWN) OF: NOKOMIS COUNTY OF: ONEIDA

Description of monument found or placed and all other evidence used as the basis for monument location; including monuments and related measurements required if the corner location was reestablished by lost corner proportionate methods. Also indicate name of original surveyor, original survey date and the corner monument, bearing trees, witness or other reference monuments established; including measured bearing and distance ties, from available records.

Found and accepted an older 2.5" O.D. galvanized iron pipe monument with stamped brass cap 30" above grade; 1 left in place as plumb and stable for new ties. Corner falls 2" North of an old wood fence corner post, with fences leading West and South, and about 16' West of center of an existing unimproved woods road running North/South. Blue painted timber lines also run North and South of the corner.

In October 1862, Joseph Jenkins/GLO, set a wood post as the original corner and marked new OBTs: A 6"Pj S44°W 12 links and an 8"Pj S67°E 22 links, all of which are now obliterated.

In September 1937, V.M. Maine/Oneida County Surveyor, noted he found original GLO 1/4 post, which he also verified from the stub of original SE Pj OBT, and he replaced the post location with an "official corner"(normally a brass capped 2" dia. galvanized iron pipe) and marked new BTs: a 12" Pj S55°W 1.215 chains and a 10"Pj N64°W 1.136 chains; both now obliterated beyond corner recovery purposes.

In November 1978, Wisconsin DOT indicates a 2" dia. iron pipe with brass cap at this corner per their Right-of-Way Plat for Highway 51 Relocation Project 1173-4-21, filed in Oneida County survey records.

This recovery completed May 9, 2000; there were no direct witnesses. The corner is accessible via old woods road leading North from Lake Nokomis Road about 1/2 mile.

Plan view map of monument location with bearing and distance ties to a minimum of four(4) described witness or reference monuments of concrete, natural stone, iron, live bearing trees or equivalent material. If applicable, also show a minimum of two(2) bearing and distance ties to any other monument found and not accepted; including the bearing and distance from the accepted monument.

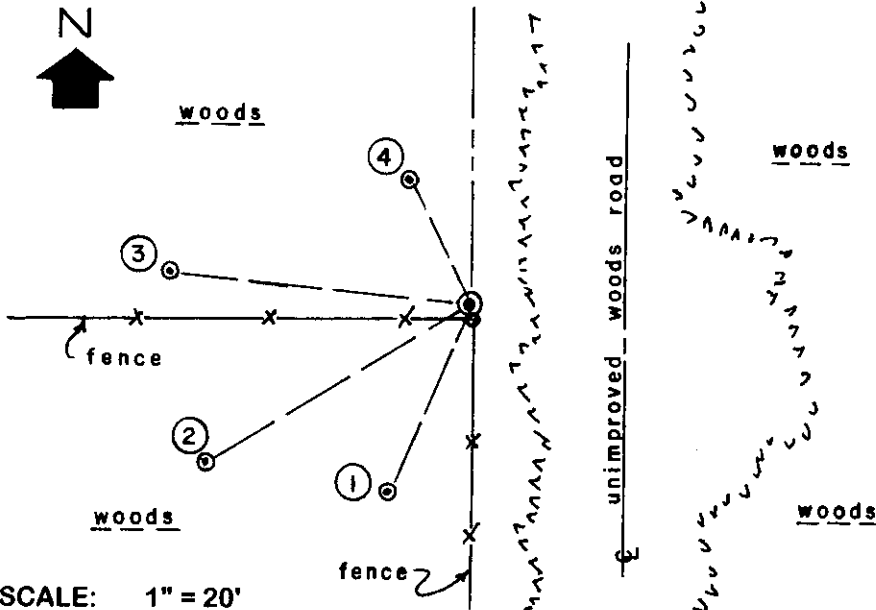

WITNESS MONUMENT TIES:

- ① New BT East 8" Mr of 4 Mr with probable old blaze scars on NE face, S23°W 21.67'.
- ② New BT North 10" Mr of 5 Mr S58°W 32.05'.
- ③ New BT North 8" Mr of 5 Mr with probable old blaze scar on East face N84°W 31.20'.
- ④ New BT East 6" Mr of 2 Mr N26°W 14.46'.

I set a standard white poly "T" marker post 18" East of corner monument and flagged the monument and all BTs with blaze orange tape.

SCALE: 1" = 20'

Unless otherwise indicated, all bearing tree ties are to a .25" dia. by 2.5" long PK nail with a 1.25" dia. steel washer driven into unblazed right face and a .25" dia. by 2.5" long PK nail with a 2" dia. steel washer stamped BT is also driven into unblazed face of bearing tree at DBH; the basis for measured bearings is by compass to nearest degree and all tie distances are measured horizontal by steel tape corrected to nearest 1/100th feet at standard temperature of 68° F.

RLS SEAL:

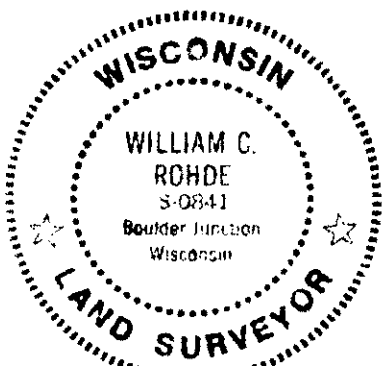

LAND SURVEYOR CERTIFICATE:

I, William C. Rohde, hereby certify that I am duly licensed as a Professional Land Surveyor in the State of Wisconsin; that this USPLS monument location was determined by me and/or under my direct supervision and control; and that this U.S. Public Land Survey Monument Location Record is true and correct to the best of my knowledge and belief.

Signed: *William C. Rohde*
William C. Rohde RLS 841

