

U.S. PUBLIC LAND SURVEY MONUMENT RECORD

Note: This form is intended and designed to fulfill all requirements of Wisconsin Administrative Code, Chapter A-E 7.08 U.S. Public Land Survey Monument Record (3) (a) (b) (c) (d) (e) (f) (g) (h) (i). An additional sheet may be added if necessary to conform with said requirements.

(a) Corner location: Township 36 North
 Range 7 East/West

Town/City/Village Woodboro

County Oneida

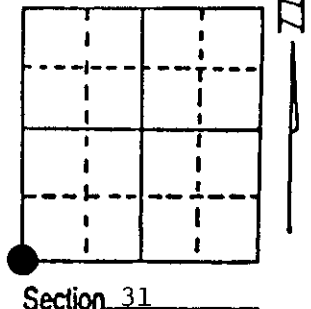

(b) (f) (g) (h) Description of monument found at this corner and if it was accepted, state all evidence (material, testimonial, occupational, plats, records, other monuments) used as a basis for accepting. If not accepted or if nothing was found, state evidence used as basis for establishing location. If reestablished through lost corner proportionate methods, indicate all monuments, distances and directions used to establish. Indicate type of monument found or set and sign post.

8/31/1860 - Alfred Millard established this corner at 80.30 chains and set a wood post with four BTs:
 14" White Pine, N74°E, 50 links 10" Spruce Pine, S74°W, 35 links
 10" Yellow Pine, S22°E, 39 links 12" Yellow Pine, N50°W, 17 links
 1/15/1989 - Milo E. Stefan found 4" x 4" x 4' scribed cedar post by Owens-Illinois 12-15 years ago. 1" iron pipe at base of cedar post. Remains of original BTs all here but do not correspond to where iron pipe and cedar post are placed.
 4/16/89 - I returned to thoroughly search this corner area when ground was free of snow and thawed out. Upon completion of my search and to the best of my ability, I restored this corner from the two strongest calls - from the two Red Pine BTs.
 SEE REVERSE SIDE OF FORM -

(c) (d) (e) Plan view of corner with ties to at least 4 witness monuments. If in disagreement with previously established corner, show the distances between the two corners and also indicate the ties to the disputed corner.

1. County aluminum monument
2. 20" Red Pine, N40°E, 63.60'
3. 3" Red Oak, S67°E, 41.01'
4. 3" Red Oak, S58°W, 19.01'
5. 24" White Pine, N31°W, 106.00'
6. Original Red Pine stump, blaze plain, N50°W, 11.2'
7. Original Red Pine stump, tipped out of stump hole. Axe marks and blaze plain S23°E, 23.8' (orig = 25.74')
8. Original White Pine, N74°E, 33.0' Stump rotted to ground line. 27.4' from monumented position.
9. Original Spruce Pine, S74°W, 23.1'. Stump rotted to ground line. 27.4' from monumented position.
10. Plastic sign post next to monument on east side.

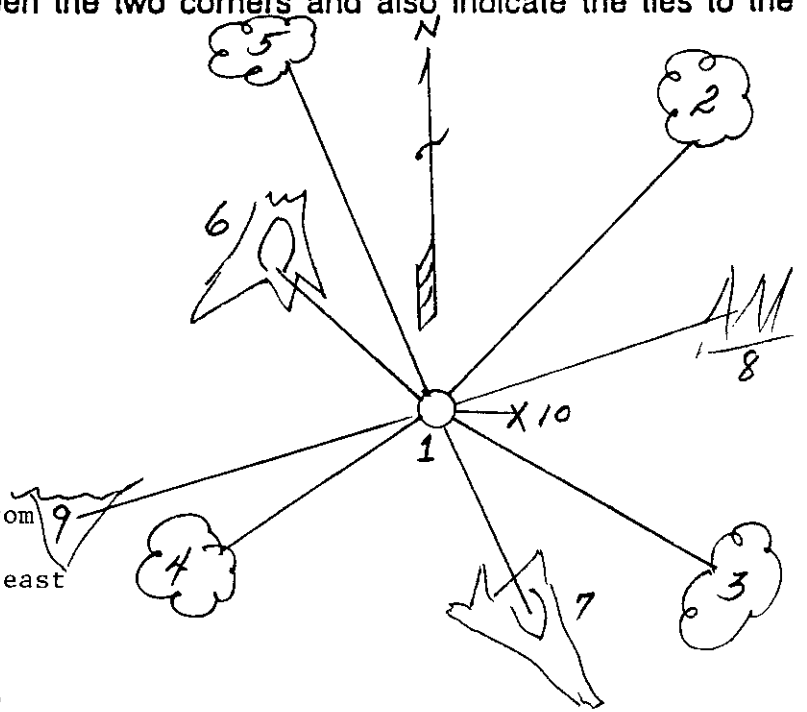

Distance to nail in side of BTs
 Scribed "BT" in stump blaze of each BT

(i) I, Milo E. Stefan
 (type or print name) certify that the corner location on this record was determined by me or under my direction and control and that this U.S. Public Land Survey Monument Record is correct and complete to the best of my knowledge and belief.

Milo E. Stefan
 Signature

April 18, 1989
 Date



Index No. 2-1

3606360000