

# U.S. PUBLIC LAND SURVEY MONUMENT RECORD

Note: This form is intended and designed to fulfill all requirements of Wisconsin Administrative Code, Chapter A-E 7.08 U.S. Public Land Survey Monument Record (3) (a) (b) (c) (d) (e) (f) (g) (h) (i). An additional sheet may be added if necessary to conform with said requirements.

(a) Corner location: Township 36 North  
 Range 7 East/West  
 Town/City/Village WOODBORO  
 County ONEIDA

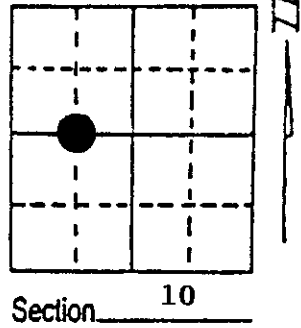

(b) (f) (g) (h) Description of monument found at this corner and if it was accepted, state all evidence (material, testimonial, occupational, plats, records, other monuments) used as a basis for accepting. If not accepted or if nothing was found, state evidence used as basis for establishing location. If reestablished through lost corner proportionate methods, indicate all monuments, distances and directions used to establish. Indicate type of monument found or set and sign post.

--Sept. 10, 1893 B.F. Dorr, Oneida County Surveyor, indicates in his survey notes that he established the 1/8 corner west of the C1/4 corner and witnessed the corner with a 12" sugar N70½E 31 links.

--July 28, 1937 V. Maine, Oneida County Surveyor, indicates in his survey notes that he recovered Dorr's 1/8 corner and Dorr's Sugar witness tree which is down with marks plain. Maine set a Ash stake and made new Bearing Trees, a Soft Maple 11"N17½E .53½ (35.31') and a Hemlock 14" N86°E .87 (56.76').

--October 6, 1989 Michael Romportl, Oneida County Cartographer/Surveyor and Richard Rollman, Oneida County Forest Administrator visited this corner to verify that the iron pipe now marking this corner is the same location of that established by Dorr and recovered by Maine. At the location we found a 2½" capped iron pipe protruding 2½' above grade and leaning southwesterly supported by Maine's Hemlock B.T. now a decaying stump and trunk lying on the ground with scribing plain on underside of trunk, measured to the stump S88° 58.4'. Also found Maine's Maple standing now 24" diameter with a seam and scar visible near base of tree, measured to a spike set in East side of tree

(c) (d) (e) Plan view of corner with ties to at least 4 witness monuments. If in disagreement with previously established corner, show the distances between the two corners and also indicate the ties to the disputed corner.

--Bearing taken to trees with hand held compass.  
 --Distances measured to nails set in sides of trees near base.  
 --No scale.

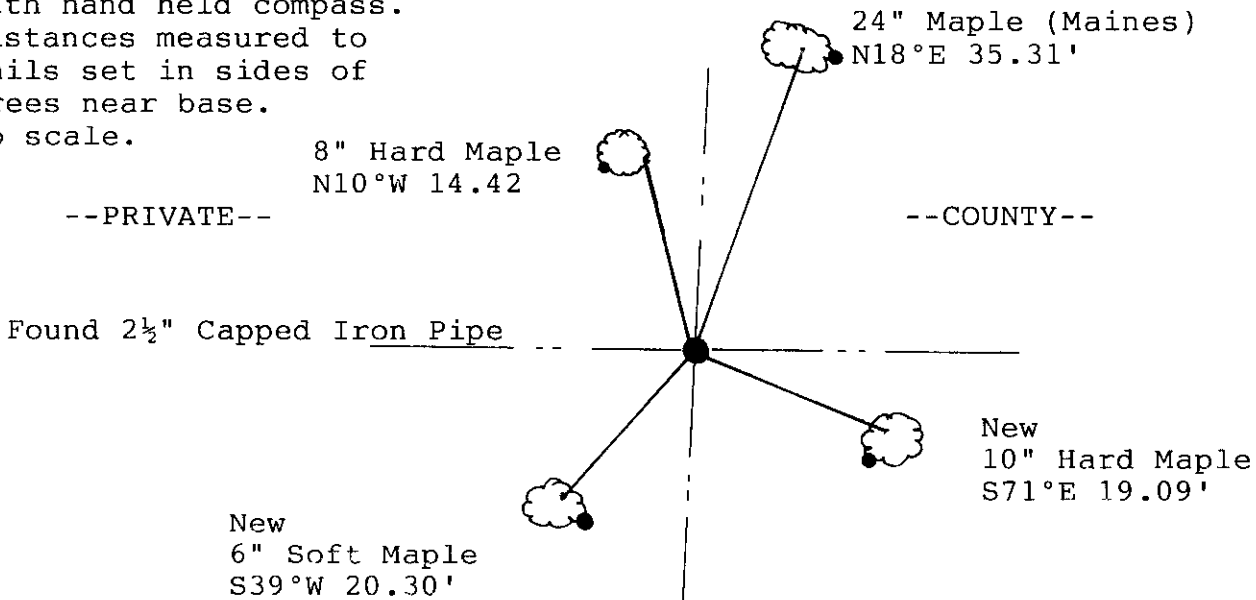

--PRIVATE--

--COUNTY--

--COUNTY--

(i) I, Michael J. Romportl  
 (type or print name) certify that the corner location on this record was determined by me or under my direction and control and that this U.S. Public Land Survey Monument Record is correct and complete to the best of my knowledge and belief.

Michael J. Romportl Signature      10/23/89 Date

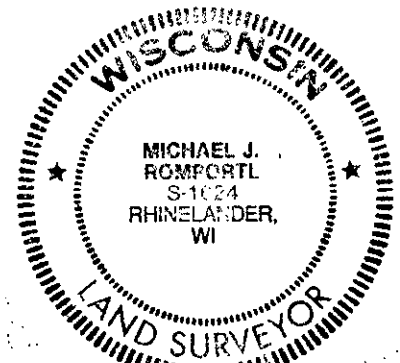

Index No. 5-14

3607102030

Stock No. 26273

center N18°E 35.31'. The iron pipe found is of the same type that was set by Maine during his term as County Surveyor.

I conclude that this corner location is very close to the same location established by Dorr and recovered by Maine and I further witnessed the corner as shown in the sketch on the reverse side to preserve the corner location.

Mr. Rollman then pointed out to me several trees and stumps which have been cut, the nearest which are located 300' Easterly of the above mentioned corner. He also stated that this was the corner that his crew used to mark a line North to the 1/8 corner west of the N½ of Section 10, said line being between private and county owned lands.

3607102030