

U.S. PUBLIC LAND SURVEY MONUMENT RECORD

Note: This form is intended and designed to fulfill all requirements of Wisconsin Administrative Code, Chapter A-E 7.08 U.S. Public Land Survey Monument Record (3) (a) (b) (c) (d) (e) (f) (g) (h) (i). An additional sheet may be added if necessary to conform with said requirements.

(a) Corner location: Township 36 North
 Range 7 East/West

Town/City/Village Woodboro
 County Oneida

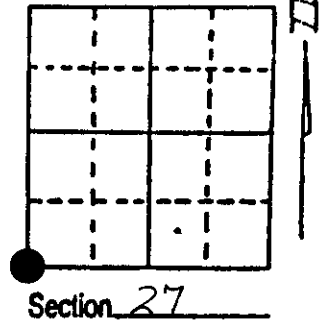

(b) (f) (g) (h) Description of monument found at this corner and if it was accepted, state all evidence (material, testimonial, occupational, plats, records, other monuments) used as a basis for accepting. If not accepted or if nothing was found, state evidence used as basis for establishing location. If reestablished through lost corner proportionate methods, indicate all monuments, distances and directions used to establish. Indicate type of monument found or set and sign post.

November, 1862, Joseph Jenkins set a wood post: Y.Pine 12" S19W, 100lks., Y.Pine 10" N10E, 430lks., no other tree near.

6-20-37, Maine set an Official Corner: Y.Pine Stp. 10" S19W, 1.00.

5-17-89, I found and accepted a 2½" dia, brass capped iron pipe: found nail in Balsam 9" N61W, 11.36', found nail in Balsam 9" N30E, 9.53', found nail in Maple 6" S32E, 27.86', found nail in W.Birch 4" S27W, 15.14', set plastic survey marker sign N16E, 1.5'.

(c) (d) (e) Plan view of corner with ties to at least 4 witness monuments. If in disagreement with previously established corner, show the distances between the two corners and also indicate the ties to the disputed corner.

Distances to nail in side of tree

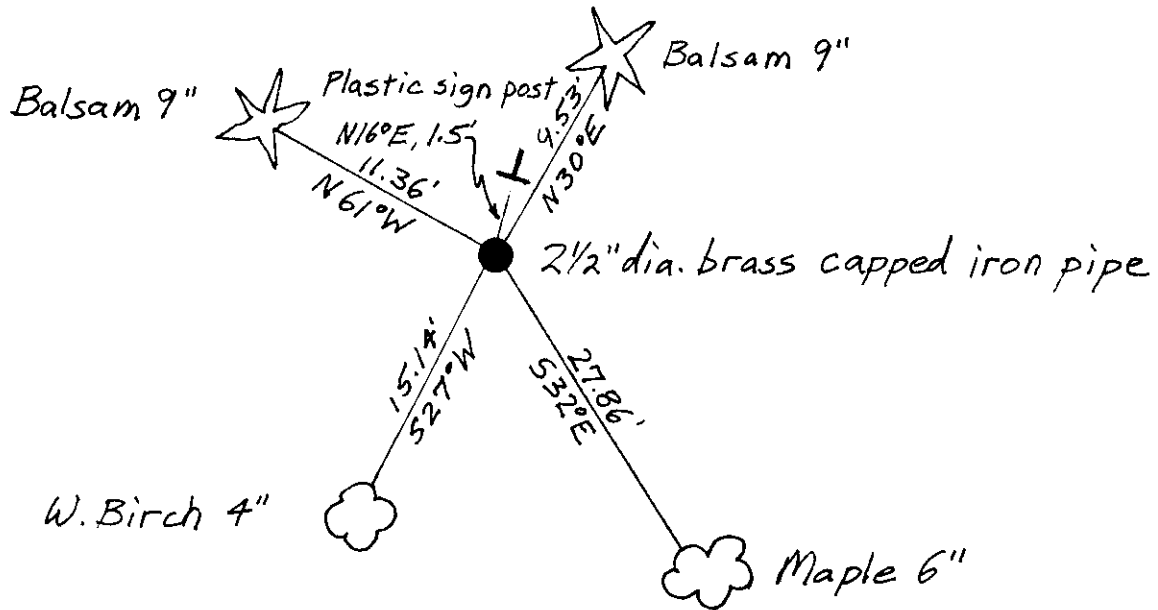

(i) I, JEFFREY W. AUSTIN S-1885
 (type or print name) certify that the corner location on this record was determined by me or under my direction and control and that this U.S. Public Land Survey Monument Record is correct and complete to the best of my knowledge and belief.

Signature [Handwritten Signature] Date JUNE 30, 1989



Index No. V-13

3607280000