

**U.S. PUBLIC LAND SURVEY MONUMENT RECORD**

Note: This form is intended and designed to fulfill all requirements of Wisconsin Administrative Code, Chapter A-8 7.08 U.S. Public Land Survey Monument Record (3)(a)(b)(c)(d)(e)(f)(g)(h)(i). An additional sheet may be added if necessary to conform with said requirements.

(a) CORNER LOCATION: State PLANE Coordinates  
S 1/4 corner of Sec. 6 X 169312.760  
 Township 36 North Y 2116980.094  
 Range 9 East Datum Base NAD 83, (91)  
 Town/City Rhinelanders County of Oneida

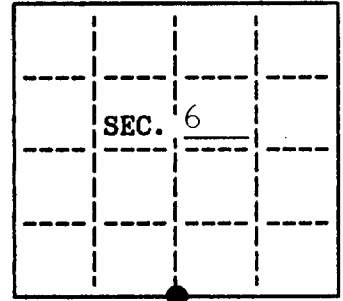

(b) HISTORY OF ORIGINAL CORNER ESTABLISHMENT

Original Surveyor: W.E. Dougherty  
 Date of Survey: Commenced July 30, 1863  
 Completed Aug. 11, 1863

Original B.T.'S

Birch 10" N 31 E 29 lks.  
 W.Pine 20" N 86 W 128 lks.

(b)(f)(g)(h) Description of monument found at this corner and if it was accepted, state all evidence (material, testimonial, occupational, plats, records, other monuments) used as a basis for accepting. If not accepted or if nothing was found, state evidence used as basis for establishing location. If reestablished through lost corner proportionate methods, indicate all monuments, distances and directions used to establish. Indicate type of monument and sign post found or set.

- Dec. 1938 - V.M. Maine Co. surveyor found 2" iron pipe calls it original corner. 6" elm N 61° E 28 1/2' 10" s. maple S 47° W 29 1/2'
- Apri 1981 - William Immich found iron pipe. (no size mentioned)
- June 1992 - William Bandow found 1 1/2" iron pipe.
- Nov. 2003 - Russell F. Brown found 1" iron pipe. Made new Bt's as shown below. Found remains of Maine's Bt's, now rotted stumps. Distances check good. I set O.C.M. over iron pipe which was under water ±3'. Corner has a 1" iron pipe along side with a "T" fitting on top. Set white post 0.50' north. Established G.P.S. coordinates on corner from harn base station in Nicolet College field. Readings were direct.

(c)(d)(e) Plan view of corner with ties to at least 4 witness monuments. If in disagreement with previously established corner, show the distances between the two corners and also indicate the ties to the disputed.

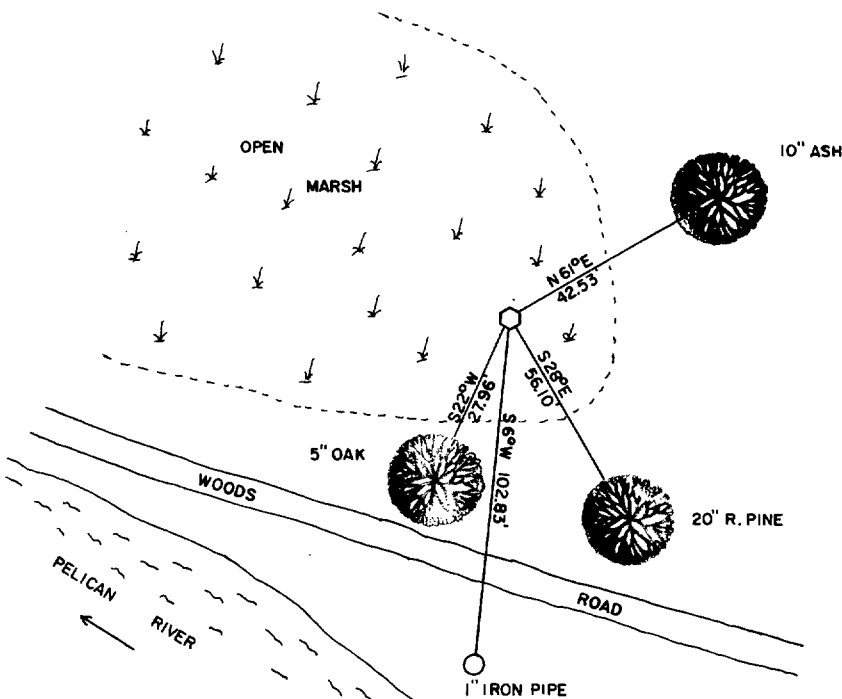

BEARINGS TAKEN WITH HANDHELD COMPASS.  
 DISTANCES TO SPIKE SET IN SIDE OF TREE.  
 NO SCALE

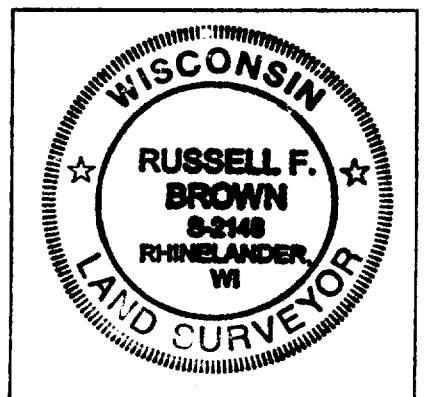

INDEX NO.

EW

(i) I, RUSSELL F. BROWN hereby certify that the corner location on this record was determined by me or under my direction and control and that this U.S. Public Land Survey Monument Record is correct and complete to the best of my knowledge and belief.

Russell F. Brown 11/20/03  
 Signature Date

3609060020