

CERTIFIED LAND CORNER RESTORATION

Index No. **D-17**

State of Wisconsin } ss.
 County of Oneida

I Philip T. Hansen, do hereby certify that on the 14th day of August, 1975, I found evidence of the S-1/16 corner of Sections 2 and 3 Township 36, North, Range 10 East, Fourth Principal Meridian, as described hereon; and that from this evidence I established a new monument and accessories as described hereon to perpetuate the original location of this corner.

Resident witnesses:

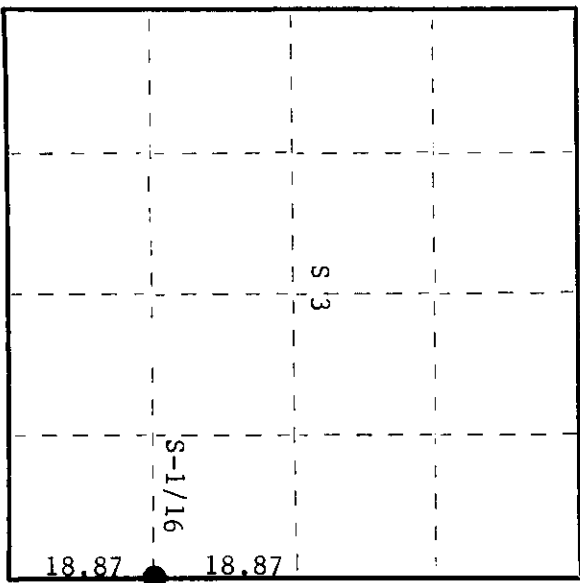
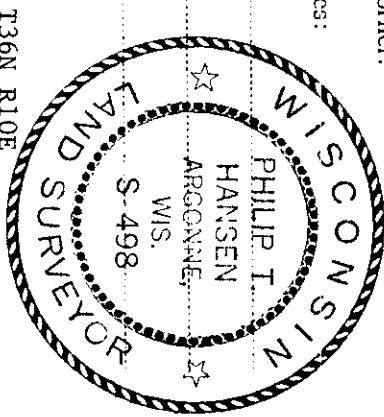

○ = Corner monument restored.

History of original corner establishment: Original corner established by B.F. Dorr, County Surveyor, in 1897, from which tamarack 10" bears N72°W 24-3/4 links.

Corner recovered by H.C. Lawrence, Registered Land Surveyor, in 1950. Recovered Dorr's S-1/16 corner at 57.28 chains south 11°20' East of section corner, 160 links east of his random line. Recovered Dorr's tamarack 10" N72°W 24-3/4 links, now a stump but scribing visible.

Set new cedar post and marked NBT - Tamarack 7' S14°W 12-1/2 links.

Description of corner evidence found:

Recovered Lawrence's 3" cedar post, squared and scribed S-1/16 S2; S-1/16 S3 in poor condition; also recovered an old cedar point buried in muck.

Recovered tamarack 10" N72°W 24.75 links now a decayed stump.
 tamarack 7" S14°W (S18°W) 12.5 links scribed S-1/16 NBT.

Description of monument and accessories I established to perpetuate the original location of this corner.
 Replaced 3" cedar post with 1-1/2" O.D. iron pipe with 2" brass cap stamped -

NBT - Black spruce 8" S85°W 27.3 links scribed 1/16 BT. S498
 Black spruce 7" S87°E 21.2 links scribed 1/16 BT. T36N R10E

S3 | S2
 S-1/16 ———
 GPI-1975

Dated at Rhineland, Wis., this 9th day of September, 1975

Signature Philip T. Hansen Title Registered Land Surveyor Registration No. S-498
 (County Surveyor, Registered Land Surveyor, or other duly authorized official)

Office of Register of Deeds, County of Oneida I hereby certify that the within instrument was filed in this office for record on the 14th day of October, 1975 at 2:00 o'clock P. M.

Doris George Finkbe
 (Register of Deeds)

By _____ Deputy

3610 031000