

CERTIFIED LAND CORNER RESTORATION Supplement to N-4

Index No. N-4

State of Wisconsin

County of Oneida } ss.

I Phillip T. Hansen, do hereby certify that on the 27th day of July, 1979, I ~~re-established~~ re-established the E 1/16 corner of Sections 18 and 19 Township 36, North, Range 10 East, Fourth Principal Meridian, as described hereon; and that from this evidence I established a new monument and accessories as described hereon to perpetuate the original location of this corner.

Resident witnesses:
 Glen Barker
 Jim Clafflin
 Herb Wagoner

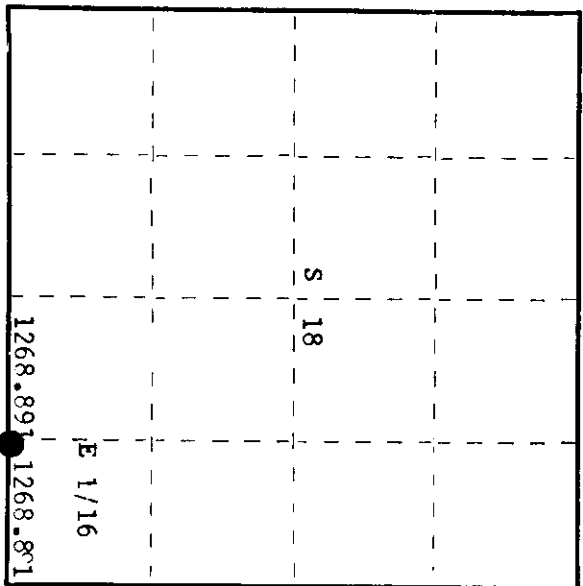
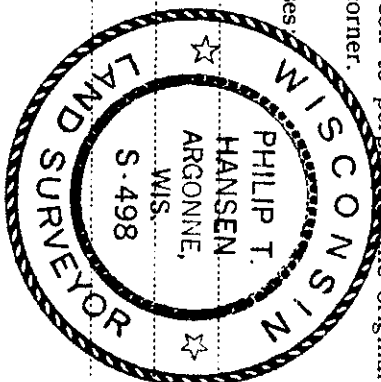

O = Corner monument restored.

History of original corner establishment:

Corner established by D.H. Vaughan, County surveyor, in 1915. Corner recovered by H.C. Lawrence, Registered Land Surveyor, in 1953. Marked Spruce Pine 14" N 66-1/2° W 34 links; Spruce Pine 10" N6°W 20-1/2 links. Recovered Lawrence's 4" cedar post and OBT's in poor condition. I replaced Lawrence's post with 1-1/2" iron pipe with 2" brass cap in 1976.

Description of corner evidence found:

In order to subdivide section 19 it was necessary to check corners by traverse and computation. Ran traverse west from section corner 17, 18, 19 and 20 to 1/4 corner between sections 18 and 19. Computed distance is 2537.783 feet at bearing S 77° 56' 19" W. Set F 1/16 at 1268.891 feet intermediate at which point our previously established corner set by Vaughan and Lawrence bears S22°E 3.00 feet. The new location was accepted for the corner.

Description of monument and accessories I established to perpetuate the original location of this corner.

Reset 1-1/2" iron pipe with 2" brass cap in correct location. Cap stamped:
 Measured new ties to old BT's
 J.Pine 10" N2°E 10.90', scribed E 1/16 S18
 J.Pine 18" N60°W 20.25', scribed E 1/16 S19

S498
 T36N R10E
 E 1/16 S 18
 S 19
 CPT-1977

Dated at Rhinelander, Wis., this 31st day of July, 1979

Signature Phillip T. Hansen Title Registered Land Surveyor Registration No. S-498
 County Surveyor, Registered Land Surveyor, or other duly authorized official

Office of Register of Deeds, County of Oneida, I hereby certify that the within instrument was filed in this office for record on the 7th day of August, 1979 at 10 o'clock P. M.

Doris Wages Kuehn
 (Register of Deeds)

By: _____ Deputy

3610180010

CERTIFIED LAND CORNER RESTORATION

Index No. **N-4**

State of Wisconsin

County of **Oneida** } ss.

I **Phillip T. Hansen**, do hereby

certify that on the **31st** day of **December**, 1976, I found

evidence of the **E 1/16** corner of **Section 18 - 19**

Township **36**, North, Range **10 East**, Fourth Principal Meridian,

as described hereon; and that from this evidence I established a new monument and accessories as described hereon to perpetuate the original location of this corner.

Resident witnesses:

Glen Barker

Jim Clarlin

Herb Wagoner

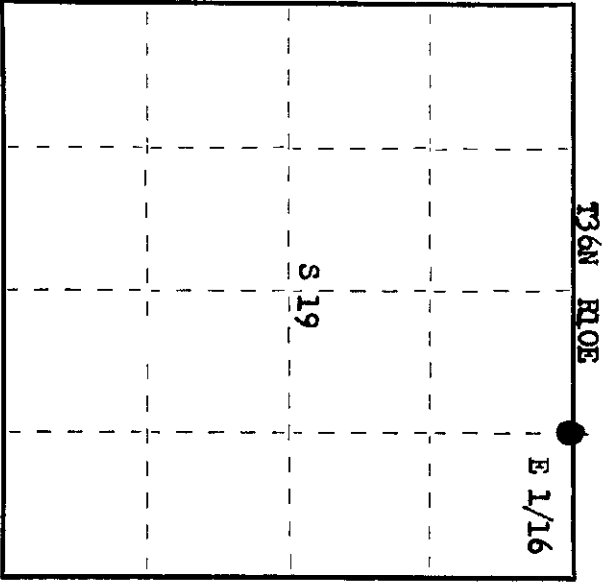
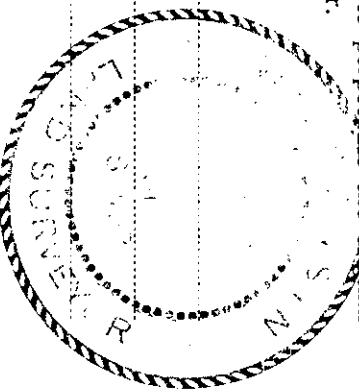

○ = Corner monument restored.

History of original corner establishment:

Corner established by D.H. Vaughan, County Surveyor, in 1915.

Corner recovered by H.C. Lawrence, Registered Land Surveyor, in 1953. Set a new 4" cedar post and marked MBTs - Spruce Pine 14" N 66 1/2° W 34 links, Spruce Pine 10" N 6° W 20 1/2 links.

Description of corner evidence found:

Recovered 4" cedar post, squared and scribed E 1/16 S18, E 1/16 S19, in poor condition.

Recovered OBT - Spruce Pine (Jack) 14" N 66 1/2° W (N 62° W) 34 links, scribed E 1/16 S18. Spruce Pine (Jack) 10" N 6° W 20.5 links, scribed E 1/16 S18.

Description of monument and accessories I established to perpetuate the original location of this corner.

Replaced Lawrence's cedar post with 1 1/2" OD iron pipe with 2" brass cap, stamped:

No additional accessories established.

Corner sets approximately 3 chains south of Old Highway 8 and 2 chains west of north branch of Pelican River.

S498
T36N R10E
E 1/16 S 1/18
S 1/19
CPI-1977

Dated at **Rhinelander**, Wis., this **24th** day of **January**, 19**77**.

Signature **Phillip T. Hansen** Title **Registered Land Surveyor** Registration No. **S-498**
(County Surveyor, Registered Land Surveyor, or other duly authorized official)

Office of Register of Deeds, County of **Oneida**
Instrument was filed in this office for record on the **24th** day of **February**, 19**77**
at **1:00** o'clock **P.**M.

Signature **Dorice Theresa Kuehn**
(Register of Deeds)

By: _____ Deputy

3610180010