

CERTIFIED LAND CORNER RESTORATION

Index No. 0-8

State of Wisconsin

County of Oneida } ss.

I Phillip T. Hansen, do hereby certify that on the 19th day of June, 1979, I found ~~some marks at the~~ corner of the Section 20

Township 36, North, Range 10 East, Fourth Principal Meridian,

as described hereon; and that from this evidence I established a new monument and accessories as described hereon to perpetuate the original location of this corner.

Resident witnesses:

Glen Barker

Jim Claflin

Herb Wagoner

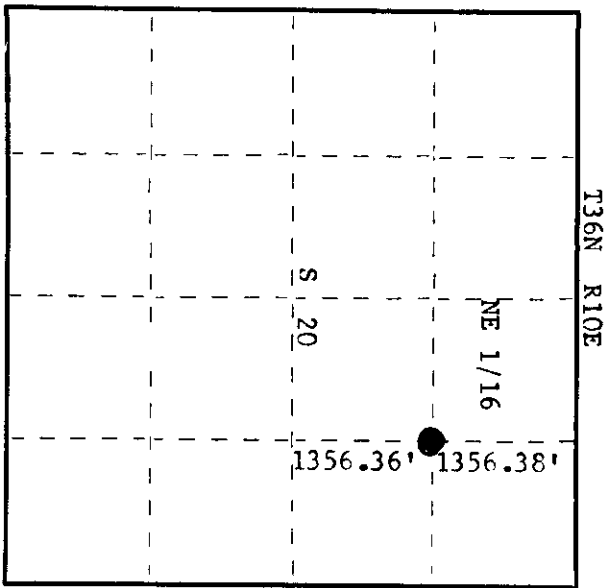
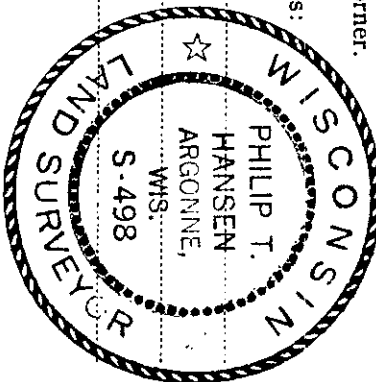

O = Corner monument restored.

History of original corner establishment:

No records of any previous survey.

Description of corner evidence found:

No evidence of any corner recovered. Corner established by traverse and computation. Ran traverse from previously established E 1/16 corner between 17 and 20 to EC 1/16 corner of section 20. Computed distance is 2712.74' at bearing S 1° 36' 59" W. Computed location of NE 1/16 corner is 1356.38' S 1° 36' 59" W of E 1/16 and 1356.36' N 1° 36' 59" E of EC 1/16.

Description of monument and accessories I established to perpetuate the original location of this corner.

Set 1-1/2" iron pipe with 2" brass cap for NE 1/16. Monument projects 12" above ground, cap stamped:

Marked NBT's -
Maple 10" S28°W 20.75' scribed 1/16 BT. S498 T36N R10E
B. Spruce 6" N8°E 37.00 scribed 1/16 BT. NE 1/16 S 1/20
CPI-1979

Dated at Rhinelander, Wis., this 26th day of June, 1979

Signature Phillip T. Hansen Title Registered Land Surveyor Registration No. S-498
(County Surveyor, Registered Land Surveyor, or other duly authorized official)

Office of Register of Deeds, County of Oneida, I hereby certify that the within instrument was filed in this office for record on the 19th day of August, 1979 at 100 o'clock P. M.

Signature Doris Wagoner
(Register of Deeds)

By Doris Wagoner Deputy

3610203010