

CERTIFIED LAND CORNER RESTORATION

Index No. U-16

State of Wisconsin }
County of Oneida } ss.

History of original corner establishment:
No record of any previous survey.

I Phillip T. Hansen do hereby
certify that on the 27th day
of July, 19 79, I found
~~restored~~ the SE 1/16
corner of Section 27

Township 36, North, Range
10 East, Fourth Principal Meridian,

as described hereon; and that from this evidence
I established a new monument and accessories
as described hereon to perpetuate the original
location of this corner.

Resident witnesses:

Glen Barker

Jim Claflin

Herb Wagoner

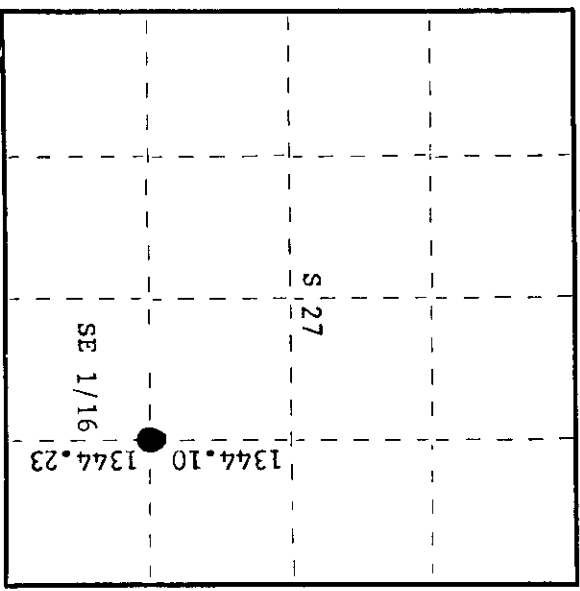
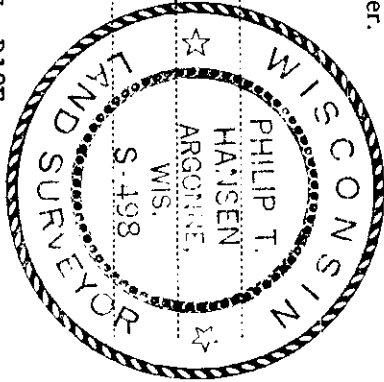

○ = Corner monument restored.

Description of corner evidence found:

No evidence of any corner recovered.

Corner established by traverse and computation. The computed line between the E 1/16
corner between sections 27 and 34 to the EC 1/16 is 2688.325 feet at bearing N 1° 54' 40" W.
Computed location of SE 1/16 is 1344.23' N 1° 54' 40" W of the E 1/16 corner and 1344.10'
S 1° 54' 40" E of EC 1/16.

Description of monument and accessories I established to perpetuate the original location of this corner.

Set 1-1/2" iron pipe with 2" brass cap - stamped:
Monument projects 18" above ground.

Marked NBT's -

Sugar 8" N84°W 9.80 feet, scribed 1/16 BT

Maple 6" S32°E 21.00 feet, scribed 1/16 BT

S498
T36N R10E
SE 1/16 S 27
CPI-1979

Dated at Rhinelander, Wis., this 31st day of July, 19 79

Signature Phillip T. Hansen Title Registered Land Surveyor Registration No. S-498
(County Surveyor, Registered Land Surveyor, or other duly authorized official)

Office of Register of Deeds, County of Oneida
at 100 o'clock P M. I hereby certify that the within
instrument was filed in this office for record on the 17th day of August, 19 79

Donna Deane Kuehn
(Register of Deeds)

By _____ Deputy

3610271010