

CERTIFIED LAND CORNER RESTORATION

Index No. **S 5**

State of Wisconsin

County of Oneida } ss.

I Philip T. Hansen, do hereby certify that on the 12th day of September, 1975, I found evidence of the N-1/16 corner of Sections 29 and 30 Township 36 North, Range 10E, Fourth Principal Meridian, as described hereon; and that from this evidence I established a new monument and accessories as described hereon to perpetuate the original location of this corner.

Resident witnesses:

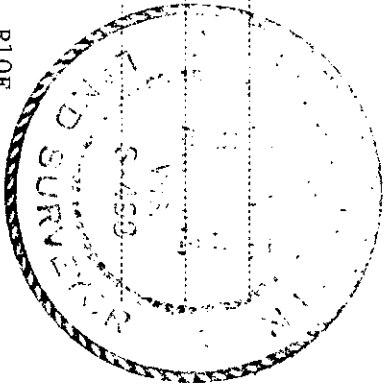

History of original corner establishment:
 Corner restored by H.C. Lawrence, Registered Land Surveyor, during his retracement survey. Recovered D.H. Vaughan's post established in 1897 from which he set BT's - tamarack 9" N88° 47 links and tamarack 7" S72-1/2°E 54-1/2 links. Lawrence set new post and marked BT's - Norway pine 16" S83°E 92-1/2 links and W. pine 12" S18°E 87-1/2 links.

Description of corner evidence found:
 Recovered 4" cedar post, squared and scribed N-1/16 S29, N-1/16 S30 in poor condition. Also an old cedar point buried in muck beside the post.

Recovered W. pine 12" (13") S18°E 87.5 links Scribed 1/16 BT
 Red pine 16" (18") S83°E 92.5 links Scribed N-1/16 BT

Description of monument and accessories I established to perpetuate the original location of this corner.
 Replaced 4" cedar post with 1-1/2" OD iron pipe with 2" brass cap stamped -

No new BT's established.

S498
 T36N R10E
 N-1/16 S30 S29
 CPT-1975

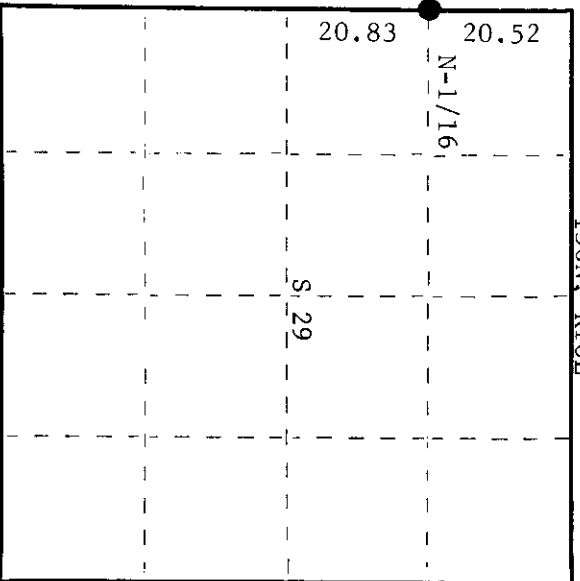

○ = Corner monument restored.

Dated at Rhinelander Wis., this 13th day of September, 1975

Signature: *Philip T. Hansen* Title: Registered Land Surveyor Registration No. S-498
 (County Surveyor, Registered Land Surveyor, or other duly authorized official)

Office of Register of Deeds, County of Oneida
 Instrument was filed in this office for record on the 17th day of November, 1975
 at 10:20 o'clock A.M. I hereby certify that the within

Karen Leverage Kuehn
 (Register of Deeds)

By: Deputy