

U.S. PUBLIC LAND SURVEY MONUMENT RECORD

Note: This form is intended and designed to fulfill all requirements of Wisconsin Administrative Code, Chapter A-E 7.08 U.S. Public Land Survey Monument Record (3)(a-i).

(a) CORNER LOCATION
 Cor. of Secs. 3, 4, 33 & 34
 Township 35 & 36 North
 Range 10 East of the 4th P.M.
 Town of Pelican, Monico & Schoepke
 County of Oneida

WISCORS - Oneida County
 N: 134,439.15 USft
 E: 308,830.91 USft
 Datum: NAD 83(2011)
 GNSS Method: RTN - Direct
 GNSS Control: WISCORS VRS

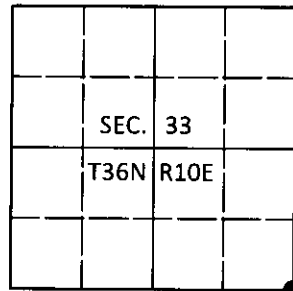

(b) HISTORY OF ORIGINAL CORNER ESTABLISHMENT

Original Surveyor: H.C. Fellows

Original Accessories:

Date of Survey Commenced: June, 1859
 Completed: July, 1859

Pine 16" N85°W, 85 lks.
 Aspen 15" N33°E, 75 lks.
 Birch 5" S30°E, 17 lks.
 Spruce 6" S45°W, 65 lks.

(b)(f)(g)(h) Description of monument found at this corner and if it was accepted, state all evidence (material, testimonial, occupational, plats, records, other monuments) used as a basis for accepting. If not accepted or if nothing was found, state evidence used as basis for establishing location. If re-established through lost corner proportionate methods, indicate all monuments, distances and directions used to establish. Indicate type of monument and sign post found or set.

Consolidated Papers (CPI) Retracement Survey: Set a new post witnessed by the GLO pine stump. CPI marked the following new trees: n. pine 12 S75°W, 26-1/2 and n. pine 13 S22°E, 26-1/2.

August 19, 2018: I found and accepted a 2-1/2" diam. aluminum pipe with a 3-1/4" diam. Oneida Co. aluminum cap projecting 14" above a collar of stone. The monument is quite unstable and appears to be sitting on bedrock. I found the GLO pine stump with no marks at record bearing and distance. I found the following CPI trees: red pine snag 20" S21°E, 26.5 lks. and red pine snag 18" S79°W, 26.5 lks. I found or established accessories as shown below. I set a white vinyl sign post bearing Northeast, 2 ft.

The coordinate value shown has been verified by at least one of the following methods: 1) comparison to a previously GPS determined published value; 2) the value is the average of two or more GPS observations at a markedly different time; 3) one or more distances were measured back to the GPS observed corner from temporary GPS observed offset locations.

(c)(d)(e) Plan view of corner with ties to at least 4 witness monuments. If in disagreement with previously established corner, show the distances between the two corners and also indicate the ties to the disputed.

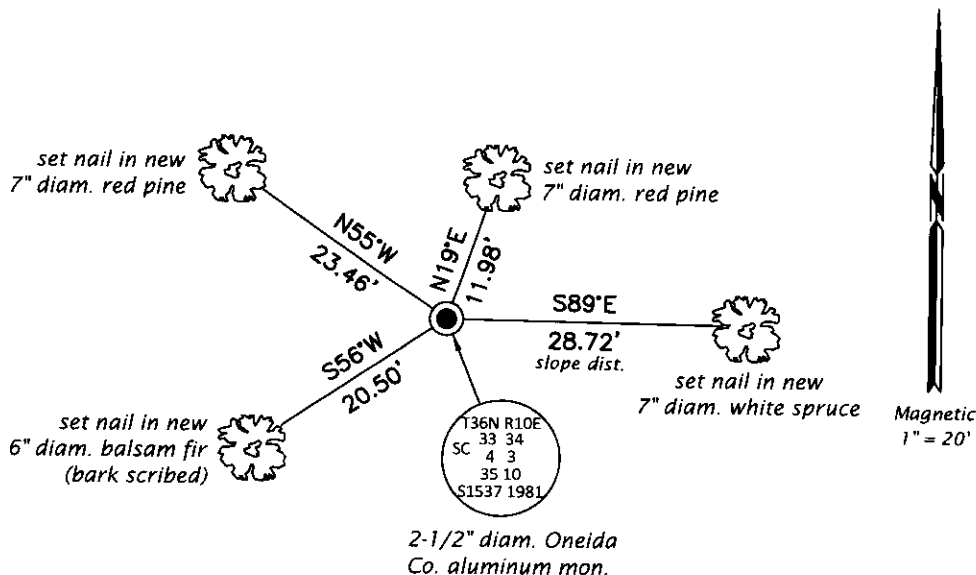

REGISTER OF DEEDS OFFICE
 ONEIDA COUNTY
 FILED

SEP 10 2018

KYLE J. FRANSON
 REGISTER OF DEEDS

(i) I, Jeffrey W. Austin, Professional Land Surveyor No. S-1885, hereby certify that the corner location on this record was determined by me or under my direction and control and that this U.S. Public Land Survey Monument Record is correct and complete to the best of my knowledge and belief.

[Handwritten Signature]
 Signature

SEP. 5, 2018
 Date