

CERTIFIED LAND CORNER RESTORATION

Index No. **D-13**

State of Wisconsin

County of Oneida } ss.

I, Philip T. Hansen, do hereby certify that on the 20th day of January, 1975, I found evidence of the S-1/16 corner of Sections 3 and 4 Township 36 North, Range 11 East, Fourth Principal Meridian, as described hereon; and that from this evidence I established a new monument and accessories as described hereon to perpetuate the original location of this corner.

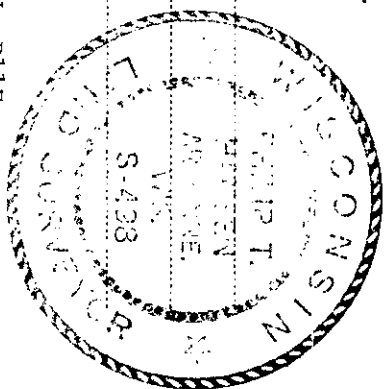

Resident witnesses:

T36N, R11E

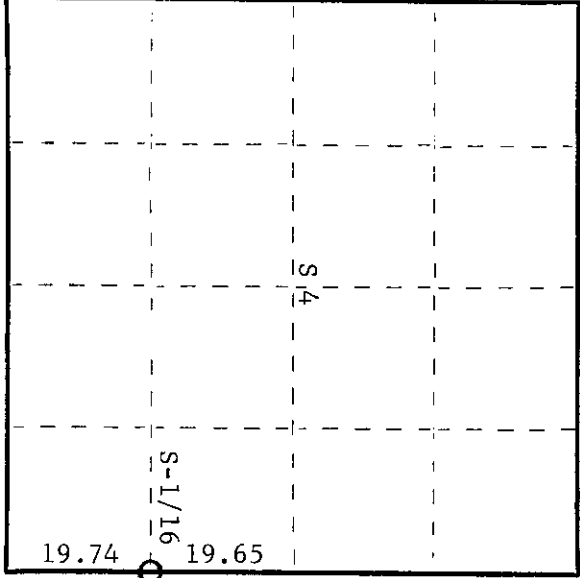

○ = Corner monument restored.

History of original corner establishment:

Corner established by D.H. Vaughan in 1906.  
Recovered by H.C. Lawrence, Registered Land Surveyor, in 1947. Set new post. No record of BT's set.  
Recovered by H.C. Lawrence in 1952. Set 4" cedar post, squared and scribed S-1/16 S3, S-1/16 S4.

Description of corner evidence found:

Recovered H.C. Lawrence's 4" cedar post, squared and scribed S-1/16 S3, S-1/16 S4 in poor condition. Also recovered Vaughan's cedar post, very rotten, lying beside other stake.

Recovered old BT's - Hemlock 8" S79°E 20.5 links dead but scribes visible  
Cedar 12" N25°W 24.6 links scribed S4 NBT  
Hemlock 10" N45E 13.5 links scribed BT

Description of monument and accessories I established to perpetuate the original location of this corner.  
Set new 1-1/4" O.D. x 5' galvanized iron pipe with 2" brass cap stamped -

NBT - Cedar 12" S35°W 64 links scribed 1/16 BT S498  
T36N, R11E

CPI-1975

Dated at Rhinelander, Wis., this \_\_\_\_\_ day of \_\_\_\_\_, 19\_\_\_\_

Signature *Philip T. Hansen* Title Registered Land Surveyor Registration No. S-498  
(County Surveyor, Registered Land Surveyor, or other duly authorized official)  
Office of Register of Deeds, County of Oneida  
Instrument was filed in this office for record on the 1st day of October, 1975  
at 3:00 o'clock P.M.

*Doris Verage Fuchs*  
(Register of Deeds)

By \_\_\_\_\_ Deputy

000401102