

CERTIFIED LAND CORNER RESTORATION

Index No. J-2

State of Wisconsin }
 County of Oneida } ss.

I Philip T. Hansen, do hereby certify that on the 3rd day of August, 1979, I found evidence of the W 1/16 corner of Sections 7 and 18 Township 36, North, Range 11 East, Fourth Principal Meridian, as described hereon; and that from this evidence I established a new monument and accessories as described hereon to perpetuate the original location of this corner.

Resident witnesses.

Glen Barker
 Jim Claffin
 Herb Wagoner

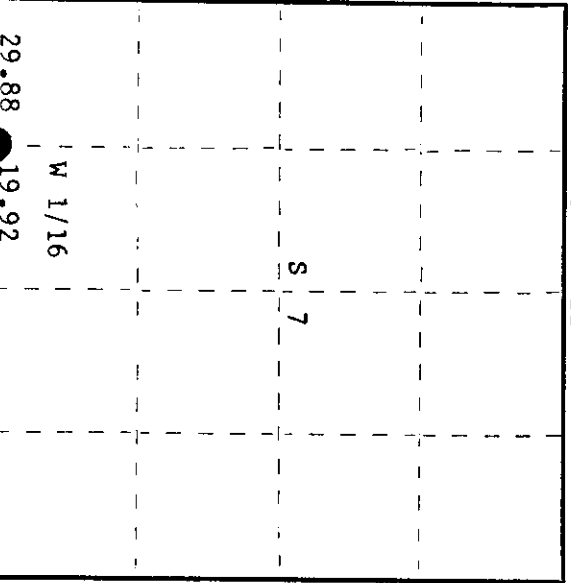
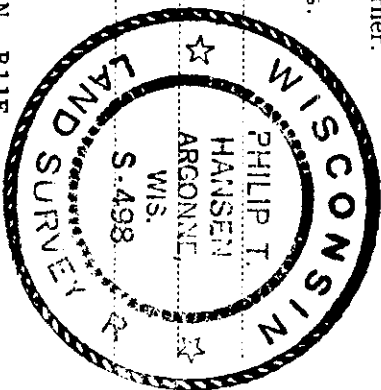

○ = Corner monument restored.

History of original corner establishment:

This corner set by D.H. Vaughan, Registered Land Surveyor, in 1905. Marked Sugar 13" N 87-3/4° W, 28 links.
 Corner re-established by H.C. Lawrence, Registered Land Surveyor, in 1951. Ran random line west from recovered (Vaughan's 1/4) corner, west (magnetic) 49.80 chains to close out 2.65 chains north of section corner. Corrected bearing of line S 86° 57' W. Set a 6" cedar post for W 1/16, 1.06 chains south of 19.92 chains west of 1/4 corner. Found stump of old sugar 13" 28 links, but due to rotted condition and deep snow was unable to find evidence of marks on it. Marked NBT - Sugar 10" N35°W 35 links; Sugar 5" S34°E 34 links.

Description of corner evidence found:
 Recovered 6" cedar, squared and scribed W 1/16 S7, W 1/16 S18, standing in fair condition, with rock cairn around base.

Recovered OBT's - Sugar 10" (12") N35°W 25 links, scribing grown over.
 Sugar 5" (8") S34°E 34 links, scribing grown over.

Description of monument and accessories I established to perpetuate the original location of this corner.
 Replaced 6" cedar post with 1-1/2" iron pipe with 2" brass cap, stamped:
 Monument projects 24".
 Replaced rock cairn around base.
 NBT - Sugar 6" N87°E, 8.9 links, scribed 1/16 BT.

S498
 T36N R11E
 W 1/16 S 7
 S 18
 CPI-1979

Dated at Rhineland, Wis., this 26th day of December, 1979.

Signature Philip T. Hansen Title Registered Land Surveyor Registration No. S-498
County Surveyor, Registered Land Surveyor, or other duly authorized official

Office of Register of Deeds, County of Oneida
 Instrument was filed in this office for record on the 14th day of January, 1980
 at 1:30 o'clock P. M.

Terri George Kuehn
(Register of Deeds)

By: _____ Deputy